

ITEM	QTY	PART NUMBER	BOM	DESCRIPTION
1	2	F_FOUND_49FT		FOUNDATION LAYOUT 49FT SHARING
2	2	F_PILLAR_ASSY		FOUNDATION PILLAR SINGLE
3	6	F_CHANNEL_F-1		CHANNEL 2"x4"
4	4	F_CHANNEL_F-2		CHANNEL 2"x4"
6	2	F_CHANNEL_F-4		CHANNEL 2"x4"
7	1	F_CHICKADEE_HOLE_LAYOUT		EXCAVATION DIMENSIONS
8	1	F_CHICKADEE_CONCRETE		CONCRETE VOLUMETRIC CAST

ZONE	REV	DESCRIPTION	ENG	DATE
	1	INITIAL RELEASE		2/20/2022
	2	UPDATED FOUNDATION WITH CONCRETE INFORMATION		3/11/2022

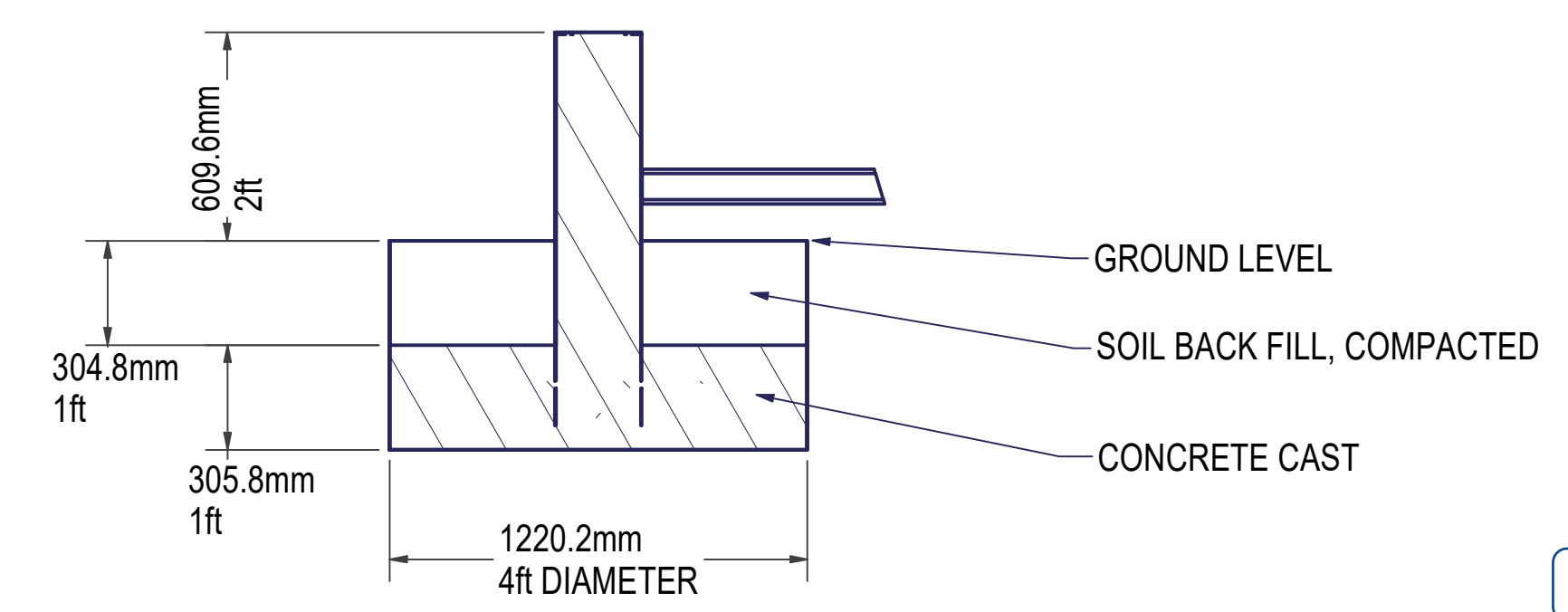
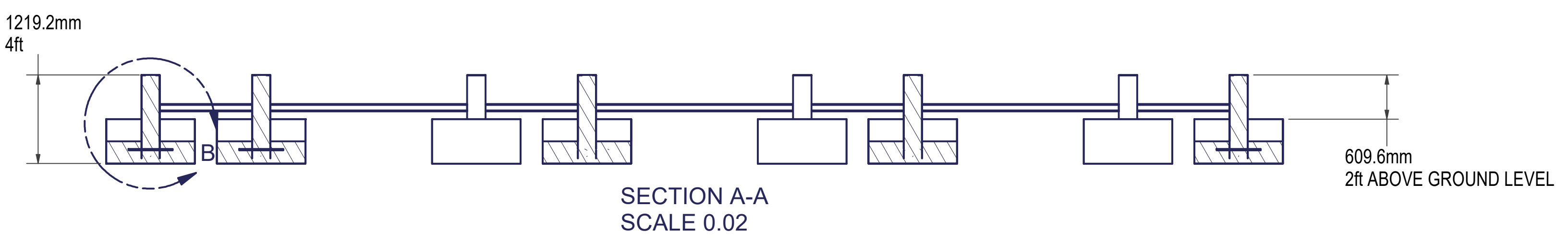
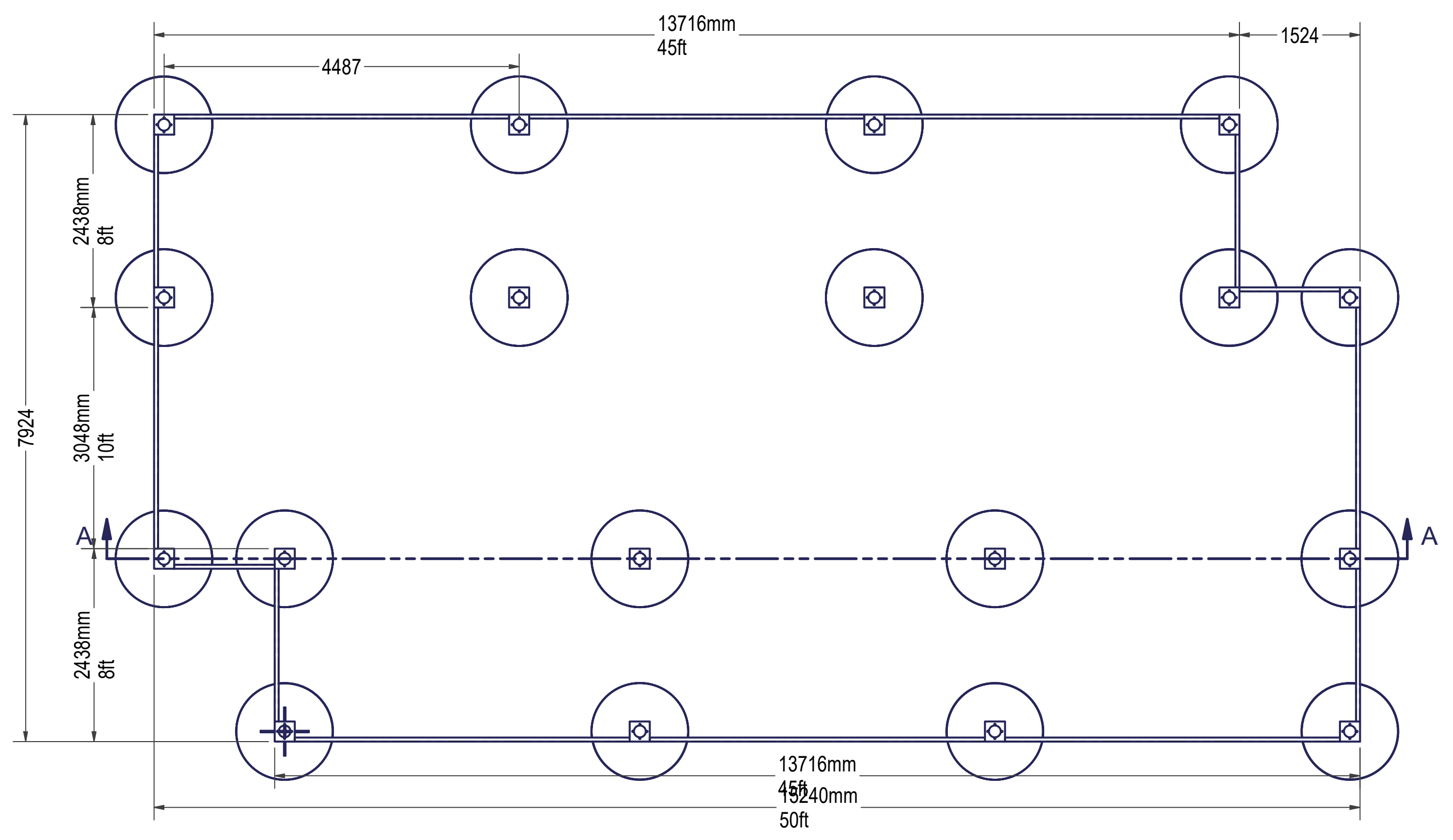
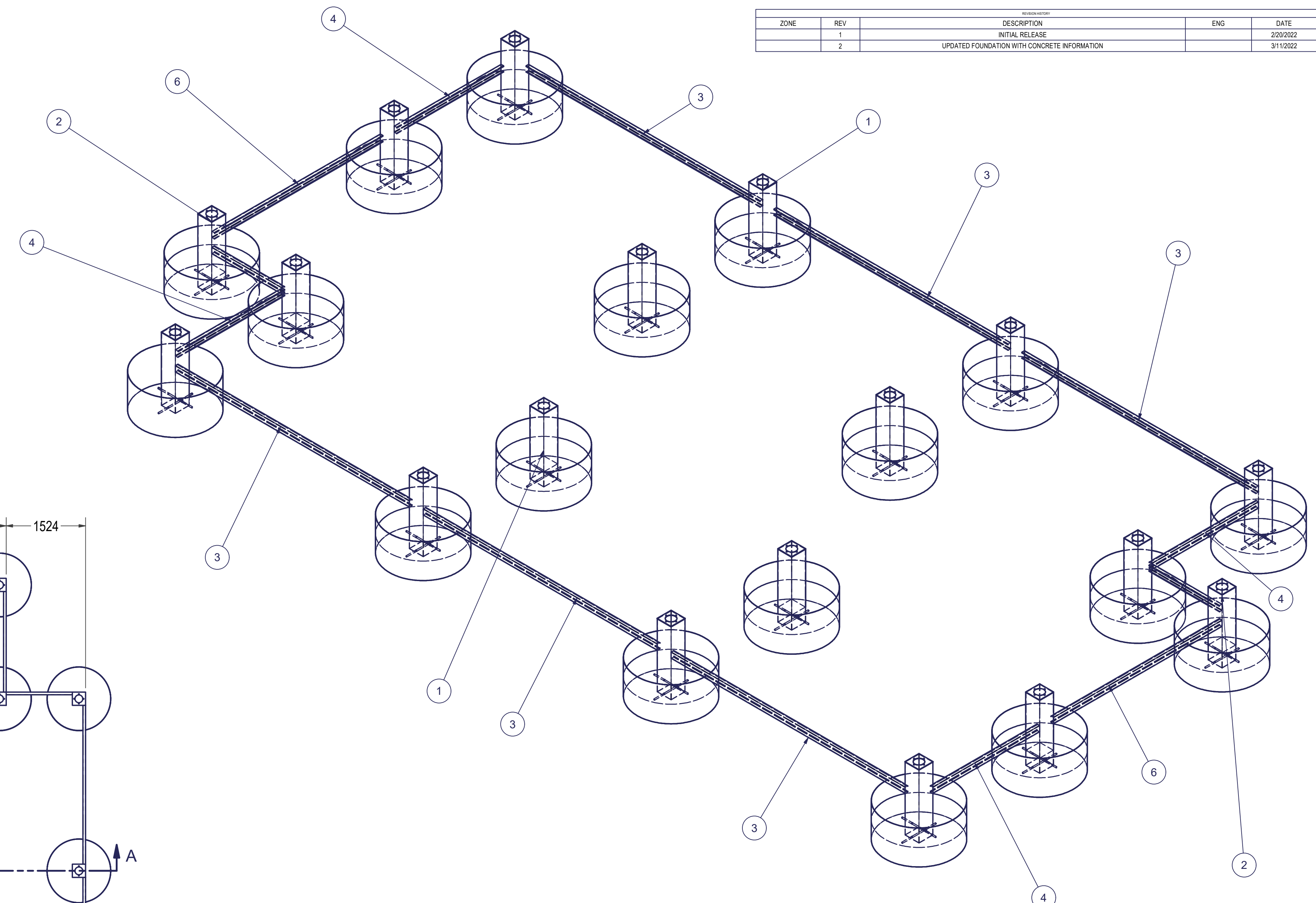

DocuSigned by:
Robert L. Pennington
 3/13/2022

ROBERT L. PENNINGTON
 PROFESSIONAL ENGINEER
 28045
 NORTH CAROLINA

Robert L. Pennington PE
 7629 Mallow Road
 Wilmington, NC 28411
 Email: robert@RLPPE.com
 Phone: 910-520-0278

ORIGINAL SCALE UNLESS OTHERWISE STATED	
COPYRIGHT This drawing and any information or descriptive matters contained therein are the copyright property of SELF SUSTAINABLE SOLUTIONS. Neither the whole nor any extract may be disclosed, loaned, copied, or used for manufacturing or tendering purposes without their written consent.	
MATERIAL	
THICK	
MASS	N/A
VENDOR	INTEGRATOR
STOCK #	
DRAWN	Dirk Genis
DATE	2/20/2022
TITLE FOUNDATION LAYOUT CHICKADEE	

FLAT PATTERN GEOMETRY IS GOVERNED BY DXF WITH THE EXPECTED TOLERANCE OF +/- 0.15mm ON ALL DXF CUTS		THIS PRINT IS SHARED ON A CONFIDENTIAL BASIS SUBJECT TO RETURN UPON DEMAND BY SSS AND NOTHING HEREIN MAY BE REPRODUCED, USED OR DISCLOSED IN WHOLE OR IN PART WITHOUT THE PRIOR WRITTEN PERMISSION OF OSPRES.		UNLESS OTHERWISE SPECIFIED DIMENSIONS ARE IN MILLIMETERS		REMOVE ALL SHARP EDGES AND BURRS	
GENERAL TOLERANCES LINEAR DIMENSIONS		ALL OTHER FEATURES		DIMENSION TOLERANCES ARE GOVERNED BY		DIN ISO 2768-mK	
LINEAR	ANGULAR	POSITION	FORM	FINISH	TEXT	DRILL	THREAD
0.5	±0.1	±0.1	±0.2	±0.3	±0.8	±1.2	±2.0

DRAWING NUMBER
F_ CHICKADEE LAYOUT
 SHEET 1 OF 10 SIZE: B REVISION: 2

BOM			
ITEM	QTY	PART NUMBER	DESCRIPTION
1	8	F_PILLAR ASSY	FOUNDATION PILLAR SINGLE

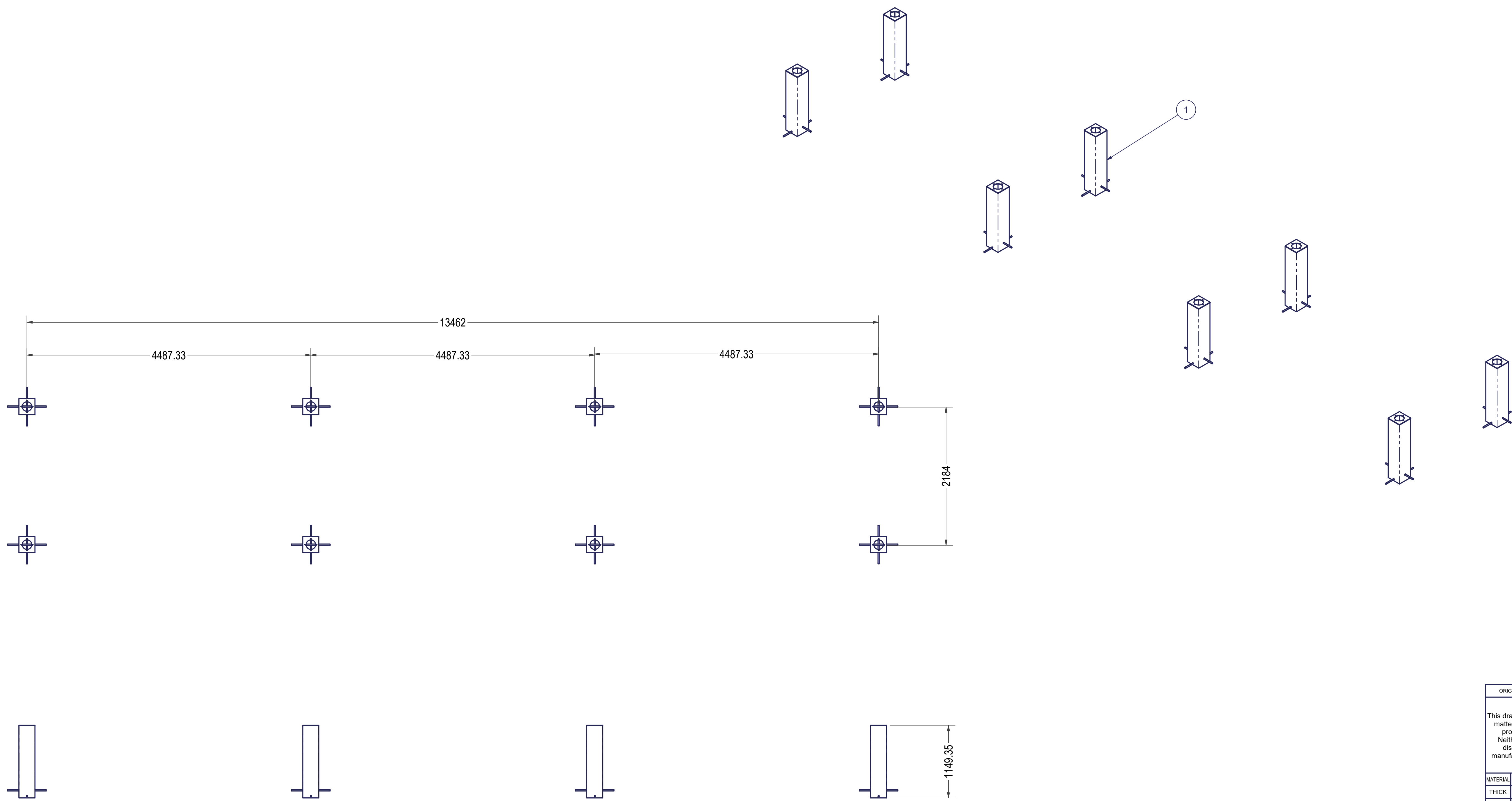

DocuSigned by:
 Robert L. Pennington
 0044399330F452
 3/13/2022

NORTH CAROLINA
 PROFESSIONAL SEAL
 25045
 ENGINEER
 ROBERT L. PENNINGTON

Robert L. Pennington PE
 7629 Mallow Road
 Wilmington, NC 28411
 Email: robert@RLPPE.com
 Phone: 910-520-0278

ORIGINAL SCALE	UNLESS OTHERWISE STATED
COPYRIGHT	
This drawing and any information or descriptive matters contained therein are the copyright property of OSPREA LOGISTICS Ltd. Neither the whole nor any extract may be disclosed, loaned, copied, or used for manufacturing or tendering purposes without their written consent.	
MATERIAL	
THICK	
MASS	N/A
FINISH	NONE
ENGINEER	Dirk Genis
DRAWN	Dirk Genis
DATE	2/20/2022



FLAT PATTERN GEOMETRY IS GOVERNED BY DXF WITH THE EXPECTED TOLERANCE OF +/- 0.15mm ON ALL DXF CUTS		This print is shared on a confidential basis subject to return upon demand by Osprea and nothing hereon may be reproduced, used or disclosed in whole or in part without the prior written permission of Osprea.		UNLESS OTHERWISE SPECIFIED DIMENSIONS ARE IN MILLIMETERS GENERAL TOLERANCES LINEAR DIMENSIONS ALL OTHER FEATURE DIMENSION TOLERANCES ARE GOVERNED BY DIN ISO 2768-mK		REMOVE ALL SHARP EDGES AND BURRS		THIRD ANGLE PROJECTION		DRAWING NUMBER F_FOUND_40FT	
LINEAR	0.5	3	8	30	120	400	1000	2000		SHEET 2 OF 10	SIZE: B
	±0.1	±0.2	±0.3	±0.5	±0.8	±1.2	±2.0				REVISION: 2

TITLE
 FOUNDATION LAYOUT 40FT, SHARING

ITEM	QTY	PART NUMBER	DESCRIPTION
1	1	PLATE BASE FOUNDATION	BASE PLATE
2	1	TUBE PILLAR	TUBE PILLAR
3	2	REBAR PILLAR SECTION	RUBAR #6 (0.75", 19MM)

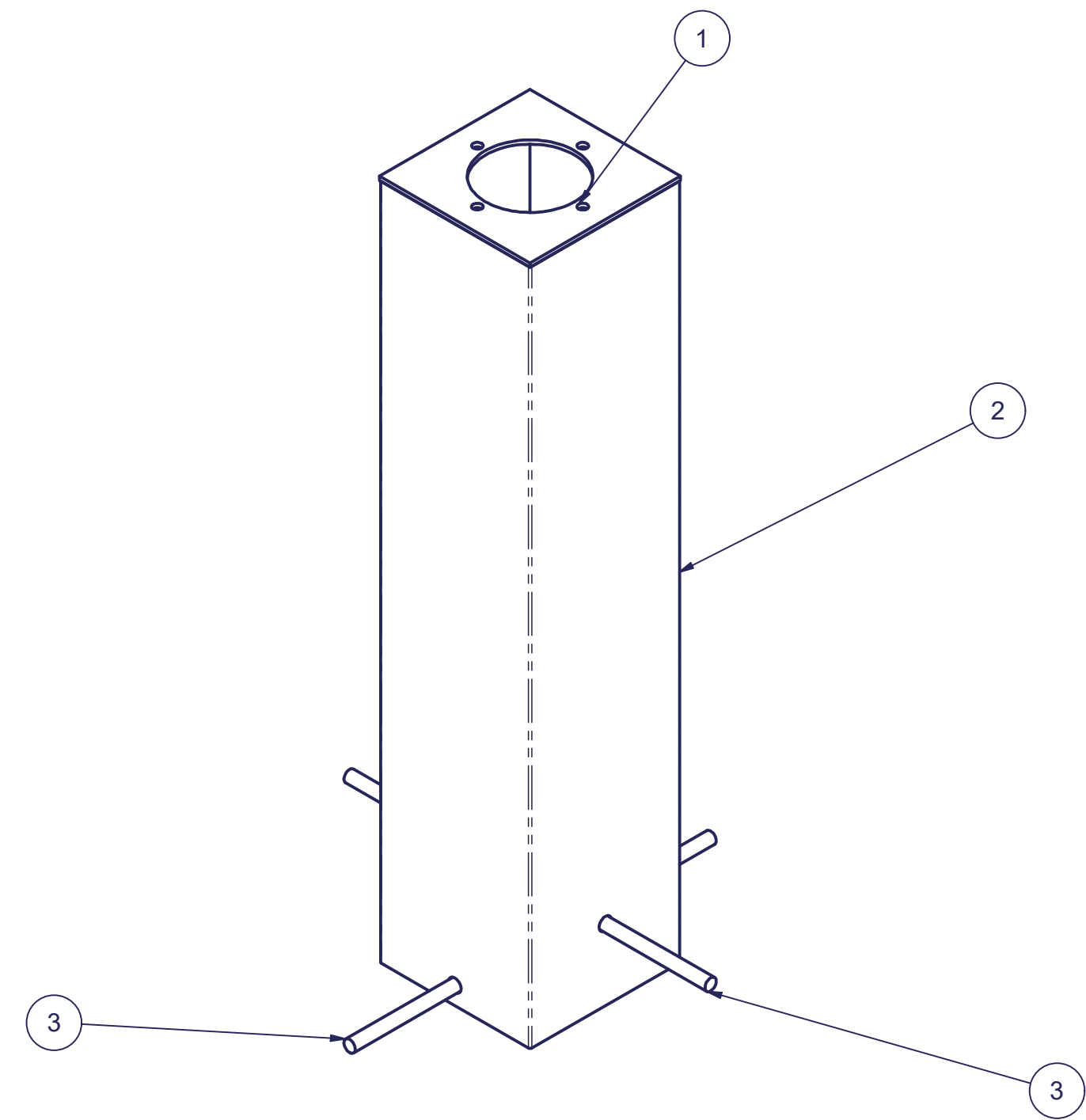
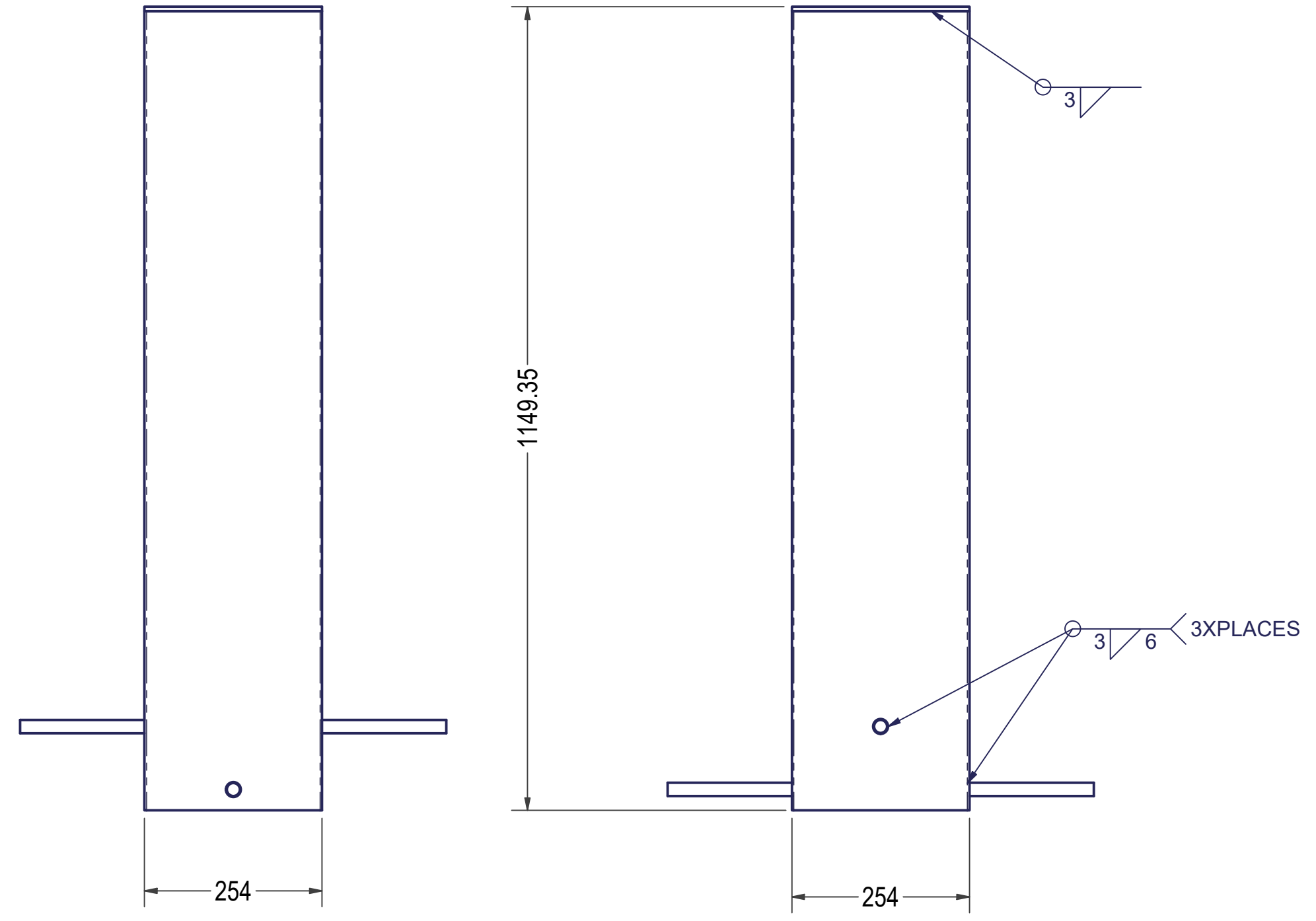
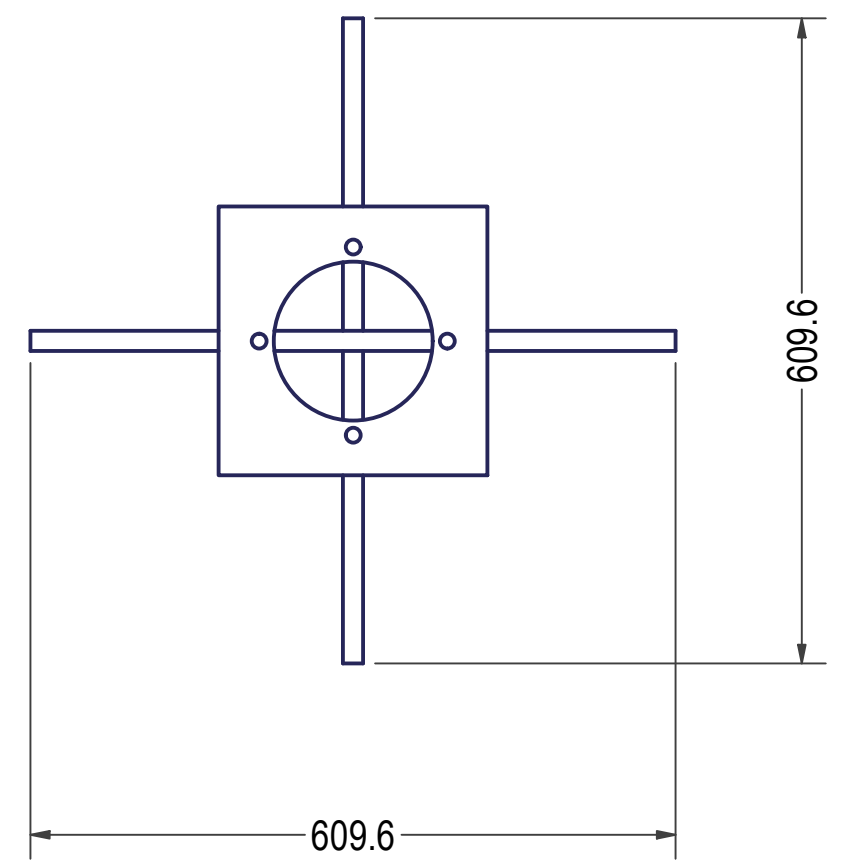

DocuSigned by:
Robert L. Pennington
0064390335DF452
3/13/2022

Robert L. Pennington PE
7629 Mallow Road
Wilmington, NC 28411
Email: robert@RLPPE.com
Phone: 910-520-0278

ORIGINAL SCALE	UNLESS OTHERWISE STATED
COPYRIGHT	
This drawing and any information or descriptive matters contained therein are the copyright property of OSPREA LOGISTICS Ltd. Neither the whole nor any extract may be disclosed, loaned, copied, or used for manufacturing or tendering purposes without their written consent.	
MATERIAL	
THICK	
MASS	N/A
FINISH	NONE
ENGINEER	Dirk Genis
DRAWN	Dirk Genis
DATE	2/20/2022



TITLE
FOUNDATION PILLAR SINGLE

FLAT PATTERN GEOMETRY IS GOVERNED BY DXF WITH THE EXPECTED TOLERANCE OF +/- 0.15mm ON ALL DXF CUTS	This print is shared on a confidential basis subject to return upon demand by Osprea and nothing hereon may be reproduced, used or disclosed in whole or in part without the prior written permission of Osprea.	UNLESS OTHERWISE SPECIFIED DIMENSIONS ARE IN MILLIMETERS		REMOVE ALL SHARP EDGES AND BURRS	
		GENERAL TOLERANCES LINEAR DIMENSIONS	DIMENSION TOLERANCES ARE GOVERNED BY DIN ISO 2768-mK		
LINEAR TO : 0.5 TO : 3 TO : 6 TO : 30 TO : 60 TO : 120 TO : 240 TO : 480 TO : 960 TO : 1920	ALL OTHER FEATURES DIMENSION TOLERANCES ARE GOVERNED BY DIN ISO 2768-mK	THIRD ANGLE PROJECTION	SHEET 3 OF 10	SIZE B	REVISION 2

DRAWING NUMBER F_PILLAR ASSY
--

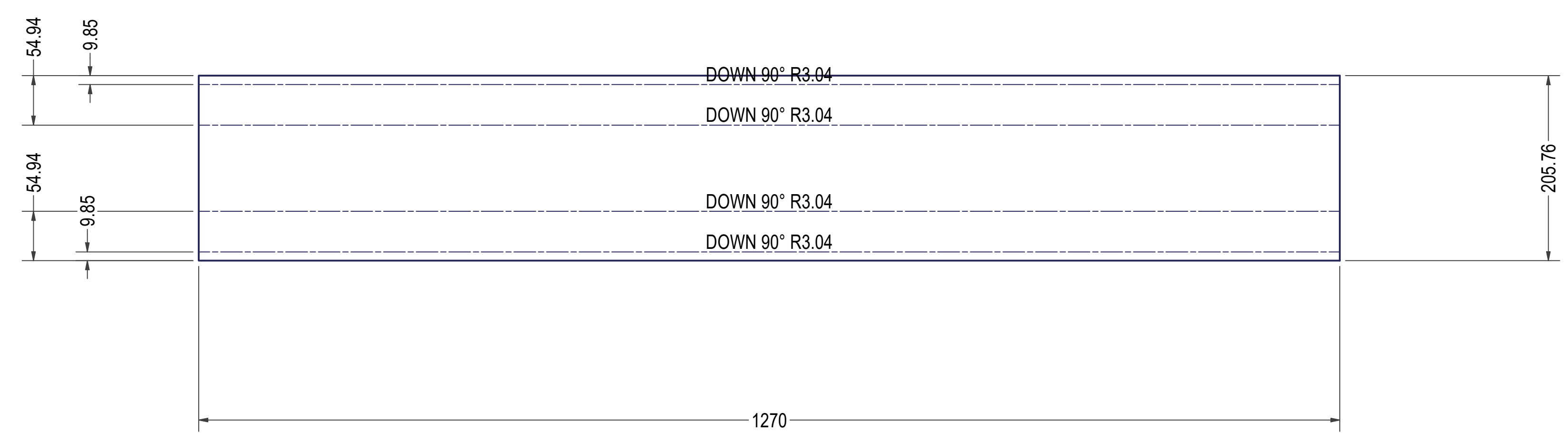
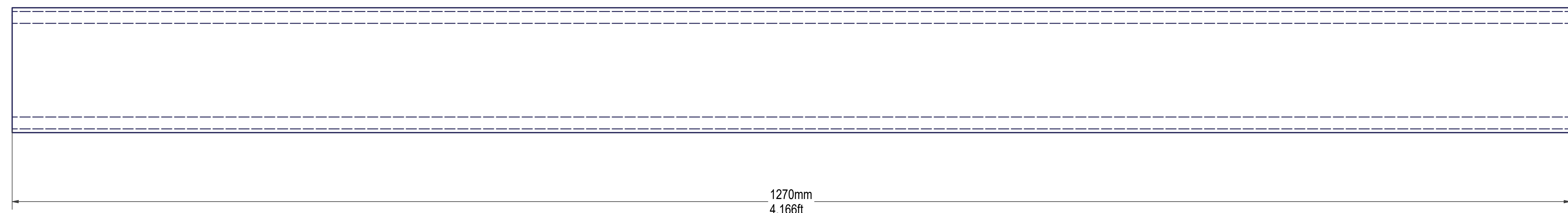
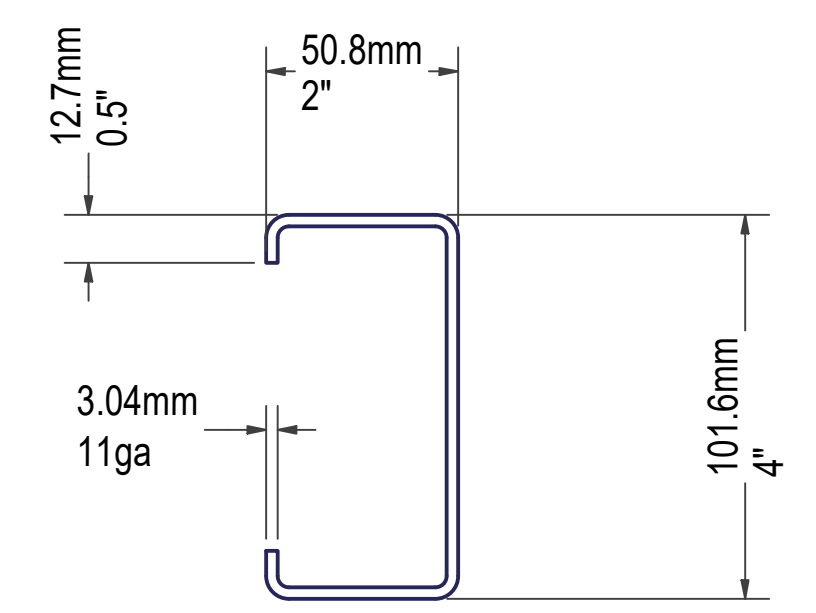
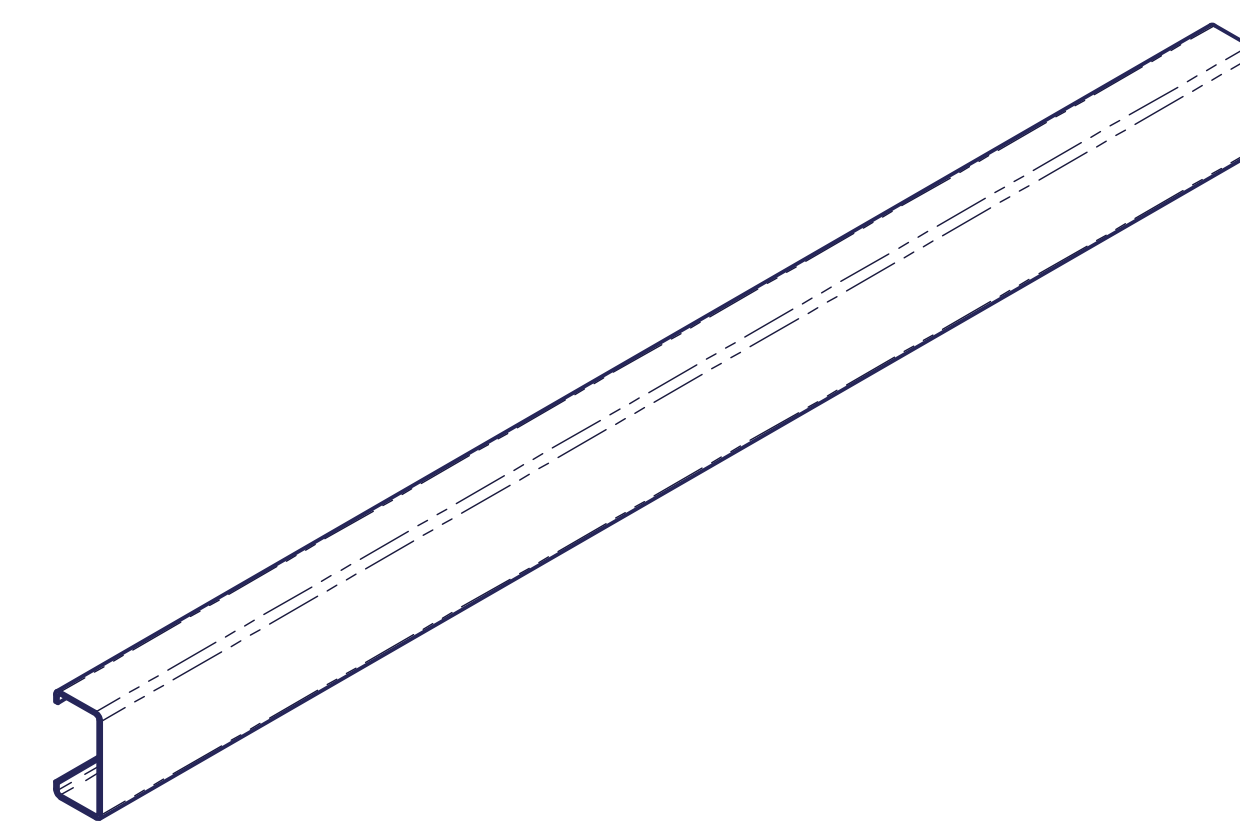

DXF FILE: CHANNEL F-3_1

DocuSigned by:
 Robert L. Pennington
 0D64399335DF452
 3/13/2022

ROBERT L. PENNINGTON
 PROFESSIONAL ENGINEER
 SEAL
 2804 B
 NORTH CAROLINA
 PROFESSIONAL ENGINEERING BOARD

Robert L. Pennington PE
 7629 Mallow Road
 Wilmington, NC 28411
 Email: robert@RLPPE.com
 Phone: 910-520-0278

ORIGINAL SCALE	UNLESS OTHERWISE STATED
COPYRIGHT	
This drawing and any information or descriptive matters contained therein are the copyright property of OSPREA LOGISTICS Ltd. Neither the whole nor any extract may be disclosed, loaned, copied, or used for manufacturing or tendering purposes without their written consent.	
MATERIAL	Steel ASTM A1011 CS Type B
THICK	3.038 mm
MASS	N/A
FINISH	NONE
ENGINEER	Dirk Genis
DRAWN	Dirk Genis
DATE	2/20/2022



TITLE
CHANNEL 2"x4"

FLAT PATTERN GEOMETRY IS GOVERNED BY DXF WITH THE EXPECTED TOLERANCE OF +/- 0.15mm ON ALL DXF CUTS	This print is shared on a confidential basis subject to return upon demand by Osprea and nothing hereon may be reproduced, used or disclosed in whole or in part without the prior written permission of Osprea.	UNLESS OTHERWISE SPECIFIED DIMENSIONS ARE IN MILLIMETERS		REMOVE ALL SHARP EDGES AND BURRS	
		GENERAL TOLERANCES LINEAR DIMENSIONS ALL OTHER FEATURES DIMENSION TOLERANCES ARE GOVERNED BY DIN ISO 2768-mK			
LINEAR TO : 0.5 TO : 3 TO : 6 TO : 12 TO : 30 TO : 60 TO : 120 TO : 240 TO : 480 TO : 960 TO : 1920	TOLERANCE ±0.1 ±0.2 ±0.3 ±0.5 ±0.8 ±1.2 ±2.0	THIRD ANGLE PROJECTION	SHEET 4 OF 10	SIZE B	REVISION 2

DRAWING NUMBER
F_CHANNEL F-3

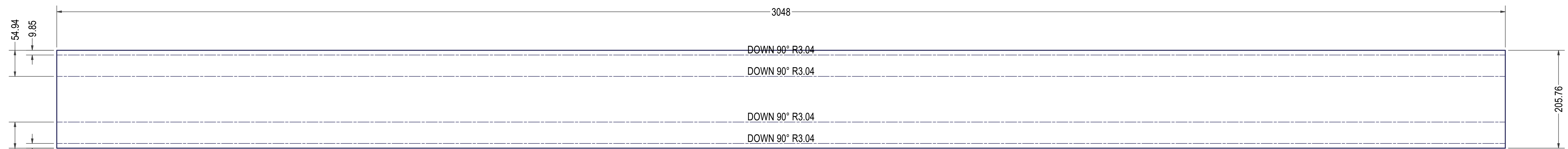
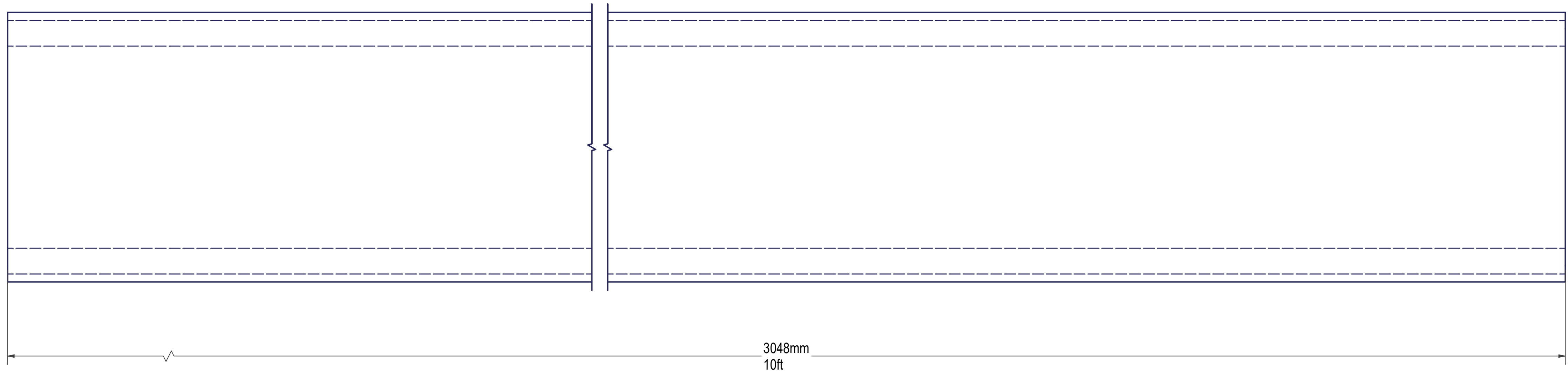
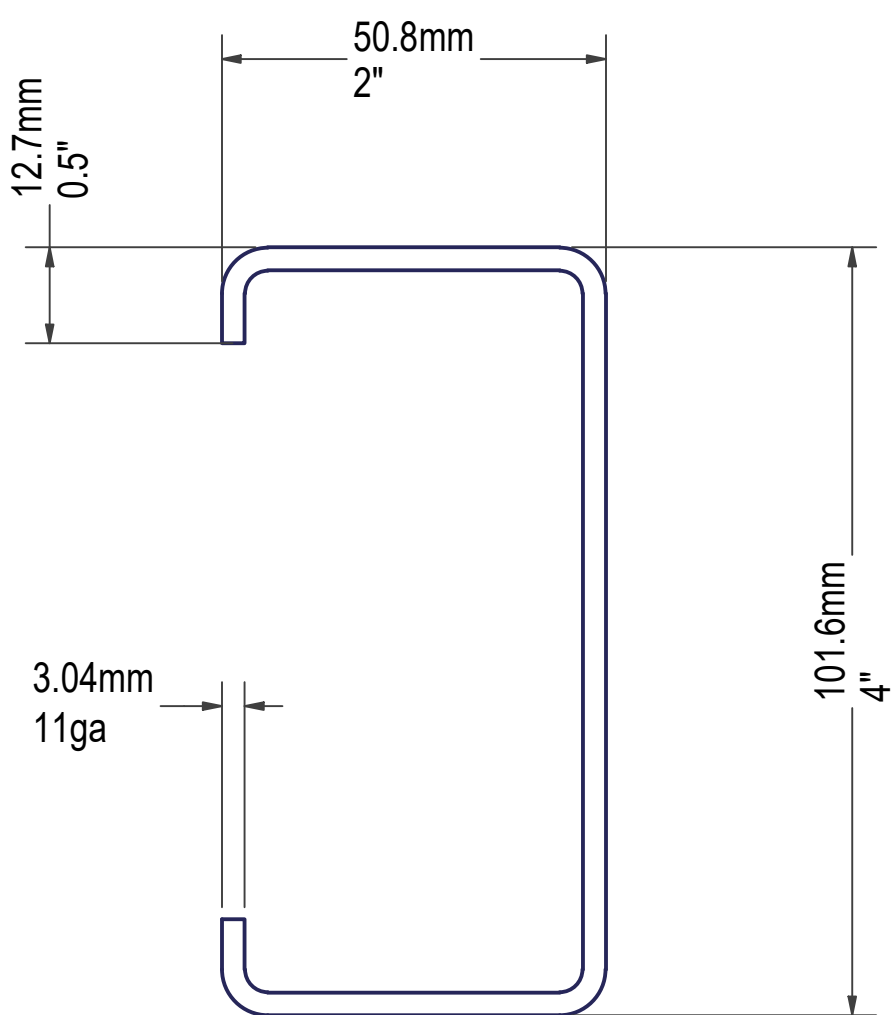

DXF FILE: CHANNEL F-4_1

DocuSigned by:
Robert L. Pennington
 00843993350F452
 3/13/2022

Robert L. Pennington PE
 7629 Mallow Road
 Wilmington, NC 28411
 Email: robert@RLPPE.com
 Phone: 910-520-0278

ORIGINAL SCALE	UNLESS OTHERWISE STATED
COPYRIGHT	
This drawing and any information or descriptive matters contained therein are the copyright property of OSPREA LOGISTICS Ltd. Neither the whole nor any extract may be disclosed, loaned, copied, or used for manufacturing or tendering purposes without their written consent.	
MATERIAL	Steel ASTM A1011 CS Type B
THICK	3.038 mm
MASS	N/A
FINISH	NONE
ENGINEER	Dirk Genis
DRAWN	Dirk Genis
DATE	2/20/2022



TITLE
CHANNEL 2"x4"

FLAT PATTERN GEOMETRY IS GOVERNED BY DXF WITH THE EXPECTED TOLERANCE OF +/- 0.15mm ON ALL DXF CUTS This print is shared on a confidential basis subject to return upon demand by Osprea and nothing hereon may be reproduced, used or disclosed in whole or in part without the prior written permission of Osprea.	UNLESS OTHERWISE SPECIFIED DIMENSIONS ARE IN MILLIMETERS GENERAL TOLERANCES LINEAR DIMENSIONS: ALL OTHER FEATURE DIMENSION TOLERANCES ARE GOVERNED BY DIN ISO 2768-mK REMOVE ALL SHARP EDGES AND BURRS THIRD ANGLE PROJECTION	DRAWING NUMBER F_CHANNEL F-4
		SHEET 5 OF 10 SIZE: B REVISION: 2

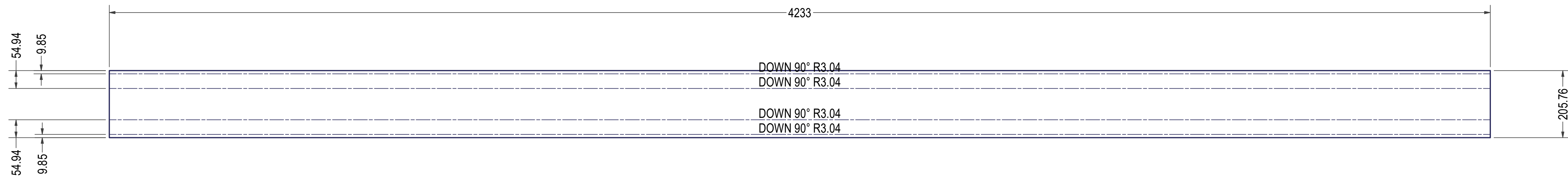
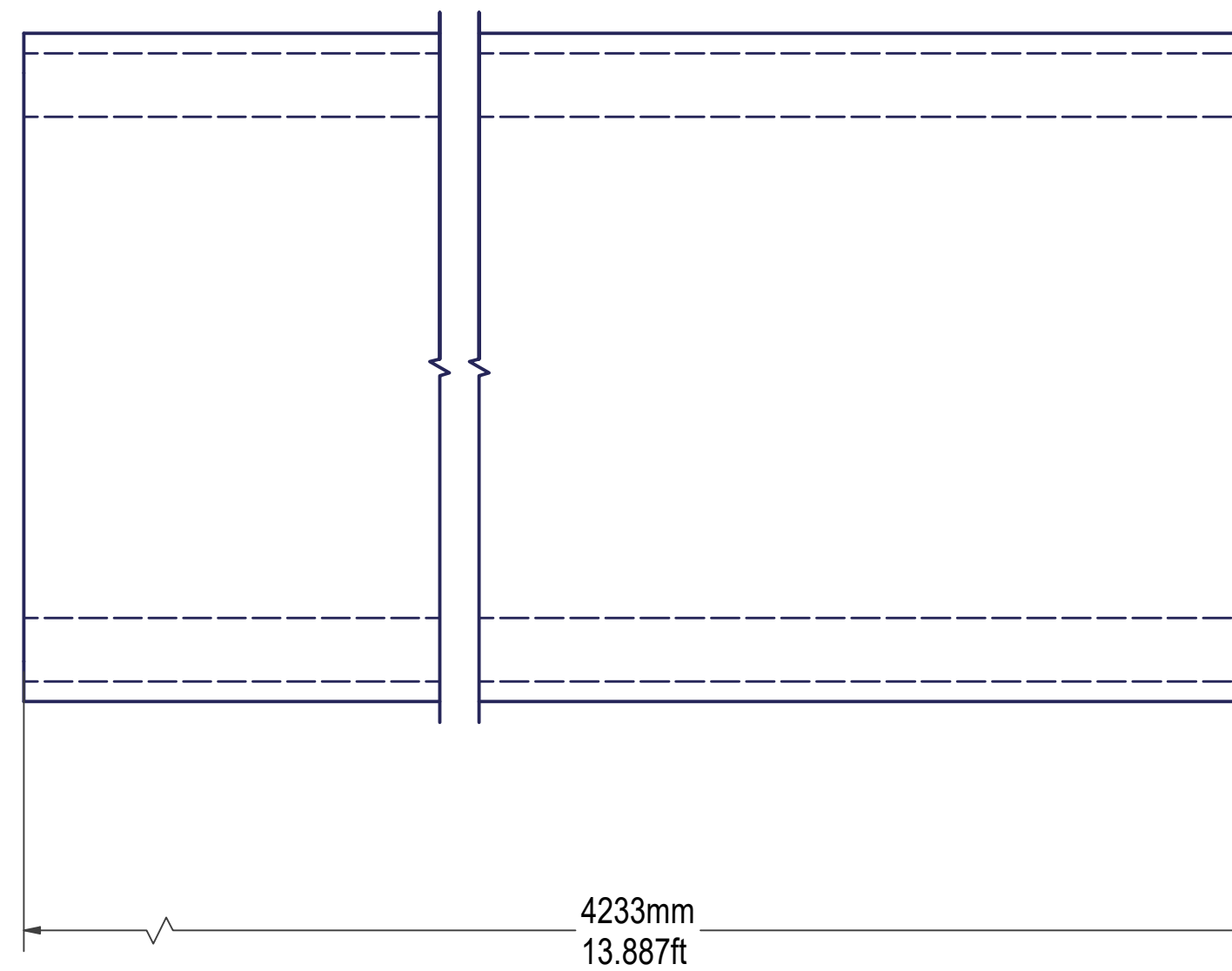
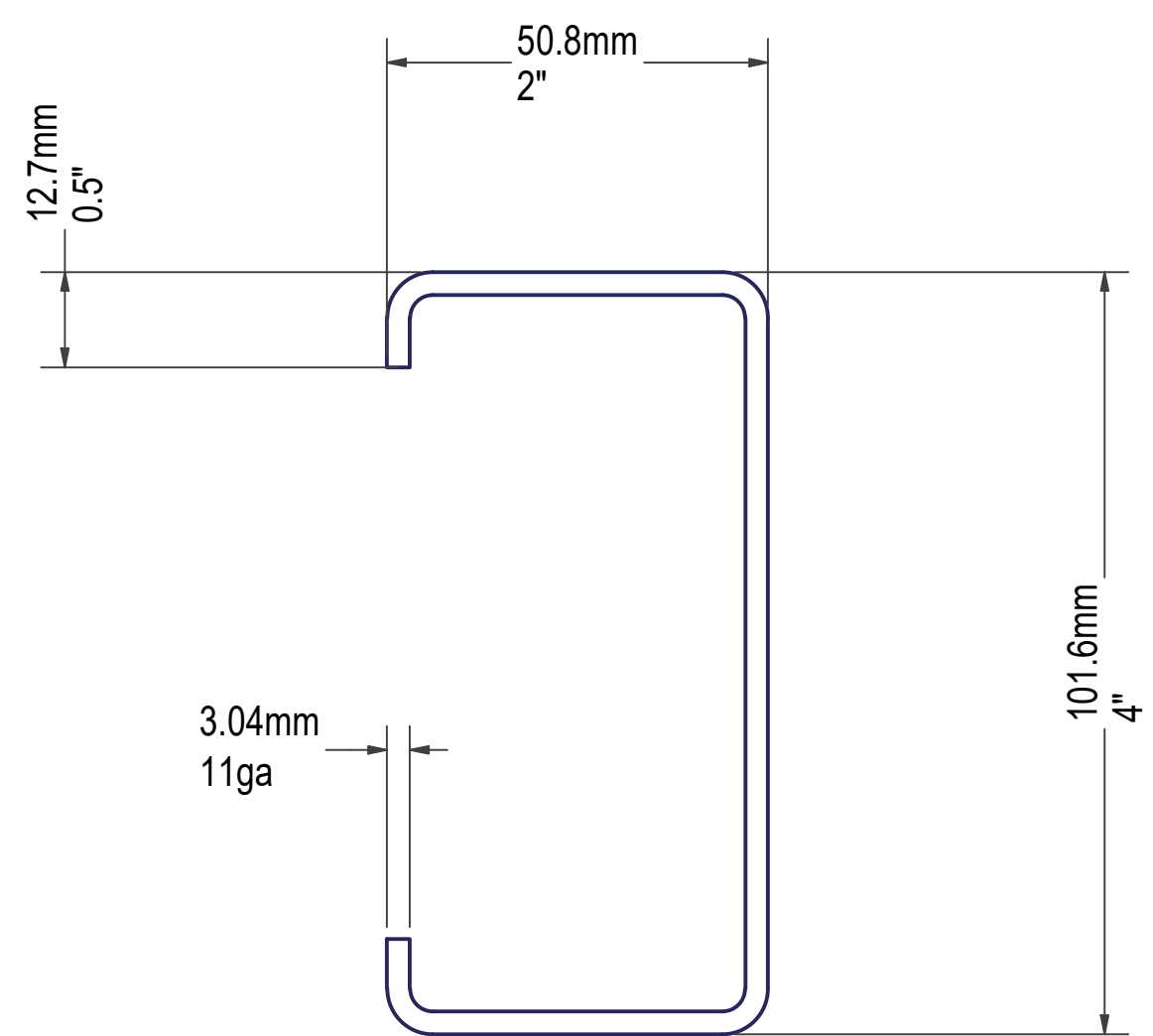

DXF FILE: CHANNEL F-1_1

DocuSigned by
Robert L. Pennington
 0064399335CF452
 3/13/2022

ROBERT L. PENNINGTON
 PROFESSIONAL ENGINEER
 SEAL 25045
 NORTH CAROLINA

Robert L. Pennington PE
 7629 Mallow Road
 Wilmington, NC 28411
 Email: robert@RLPPE.com
 Phone: 910-520-0278

ORIGINAL SCALE	UNLESS OTHERWISE STATED
COPYRIGHT	
This drawing and any information or descriptive matters contained therein are the copyright property of OSPREA LOGISTICS Ltd. Neither the whole nor any extract may be disclosed, loaned, copied, or used for manufacturing or tendering purposes without their written consent.	
MATERIAL	Steel ASTM A1011 CS Type B
THICK	3.038 mm
MASS	N/A
FINISH	NONE
ENGINEER	Dirk Genis
DRAWN	Dirk Genis
DATE	2/20/2022



TITLE
CHANNEL 2"x4"

FLAT PATTERN GEOMETRY IS GOVERNED BY DXF WITH THE EXPECTED TOLERANCE OF +/- 0.15mm ON ALL DXF CUTS	This print is shared on a confidential basis subject to return upon demand by Osprea and nothing hereon may be reproduced, used or disclosed in whole or in part without the prior written permission of Osprea.	UNLESS OTHERWISE SPECIFIED DIMENSIONS ARE IN MILLIMETERS		REMOVE ALL SHARP EDGES AND BURRS
		GENERAL TOLERANCES LINEAR DIMENSIONS ALL OTHER FEATURE DIMENSION TOLERANCES ARE GOVERNED BY DIN ISO 2768-mK		
LINEAR: 0.5 TO 3 ±0.1, 3 TO 6 ±0.15, 6 TO 12 ±0.2, 12 TO 30 ±0.3, 30 TO 120 ±0.5, 120 TO 400 ±0.8, 400 TO 1000 ±1.2, 1000 TO 2000 ±2.0, 2000 TO 4000 ±3.0		THIRD ANGLE PROJECTION		DRAWING NUMBER F_CHANNEL F-1
		SHEET 6 OF 10		SIZE: B REVISION: 2

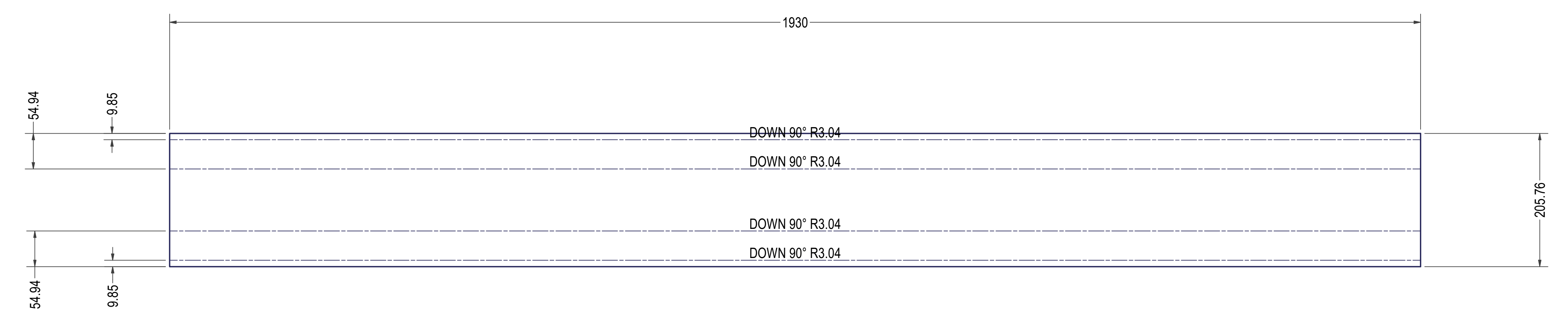
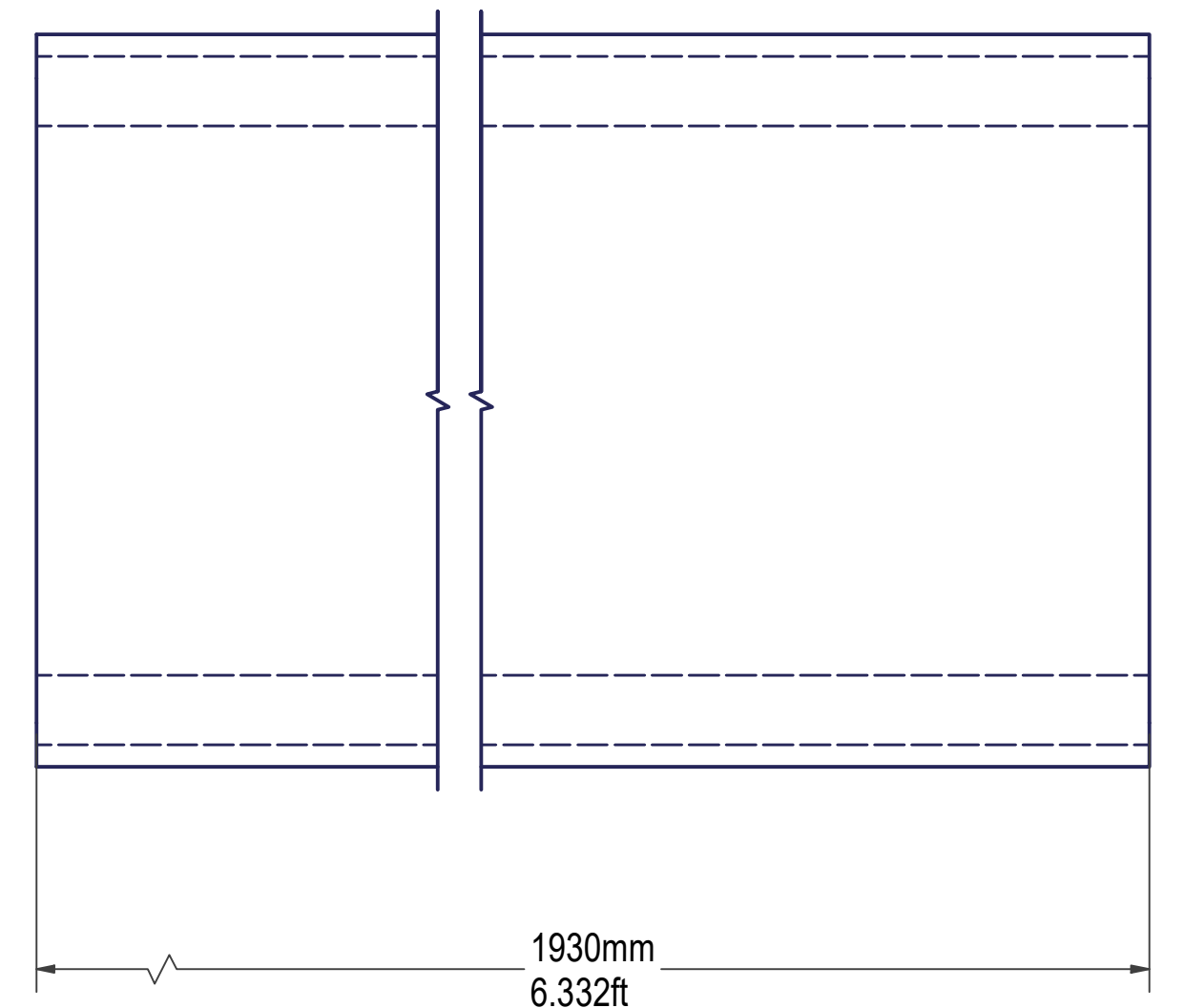
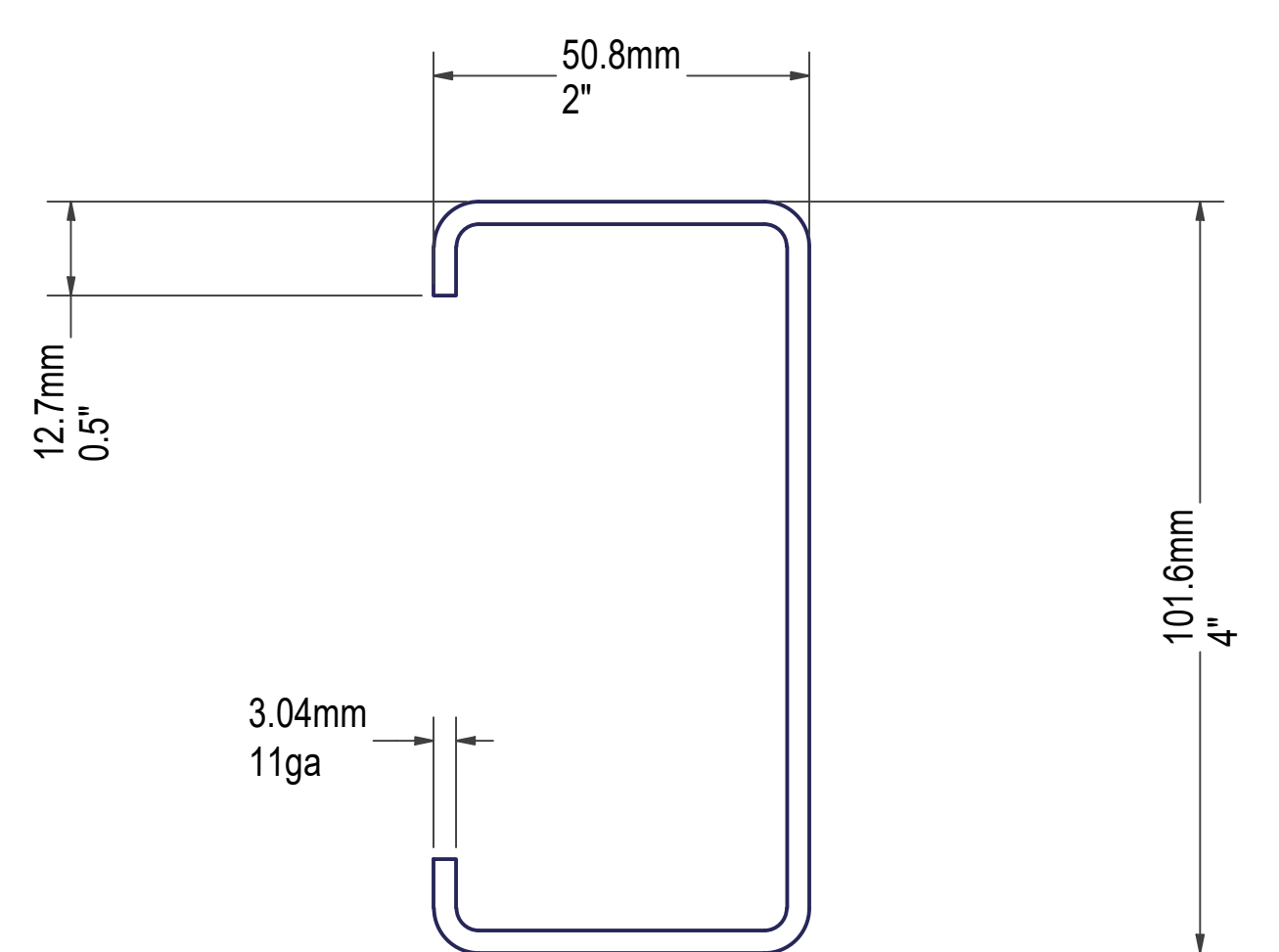

DXF FILE: CHANNEL F-2_1



DocuSigned by:
Robert L. Pennington
3/13/2022
Robert L. Pennington PE
7629 Mallow Road
Wilmington, NC 28411
Email: robert@RLPPE.com
Phone: 910-520-0278

ORIGINAL SCALE	UNLESS OTHERWISE STATED
COPYRIGHT	
This drawing and any information or descriptive matters contained therein are the copyright property of OSPREA LOGISTICS Ltd. Neither the whole nor any extract may be disclosed, loaned, copied, or used for manufacturing or tendering purposes without their written consent.	
MATERIAL	Steel ASTM A1011 CS Type B
THICK	3.038 mm
MASS	N/A
FINISH	NONE
ENGINEER	Dirk Genis
DRAWN	Dirk Genis
DATE	2/20/2022



TITLE
CHANNEL 2"x4"

FLAT PATTERN GEOMETRY IS GOVERNED BY DXF WITH THE EXPECTED TOLERANCE OF +/- 0.15mm ON ALL DXF CUTS	This print is shared on a confidential basis subject to return upon demand by Osprea and nothing hereon may be reproduced, used or disclosed in whole or in part without the prior written permission of Osprea.	UNLESS OTHERWISE SPECIFIED DIMENSIONS ARE IN MILLIMETERS		REMOVE ALL SHARP EDGES AND BURRS	THIRD ANGLE PROJECTION	DRAWING NUMBER F_CHANNEL F-2
		GENERAL TOLERANCES LINEAR DIMENSIONS ALL OTHER FEATURE DIMENSION TOLERANCES ARE GOVERNED BY DIN ISO 2768-mK	SHEET 7 OF 10			

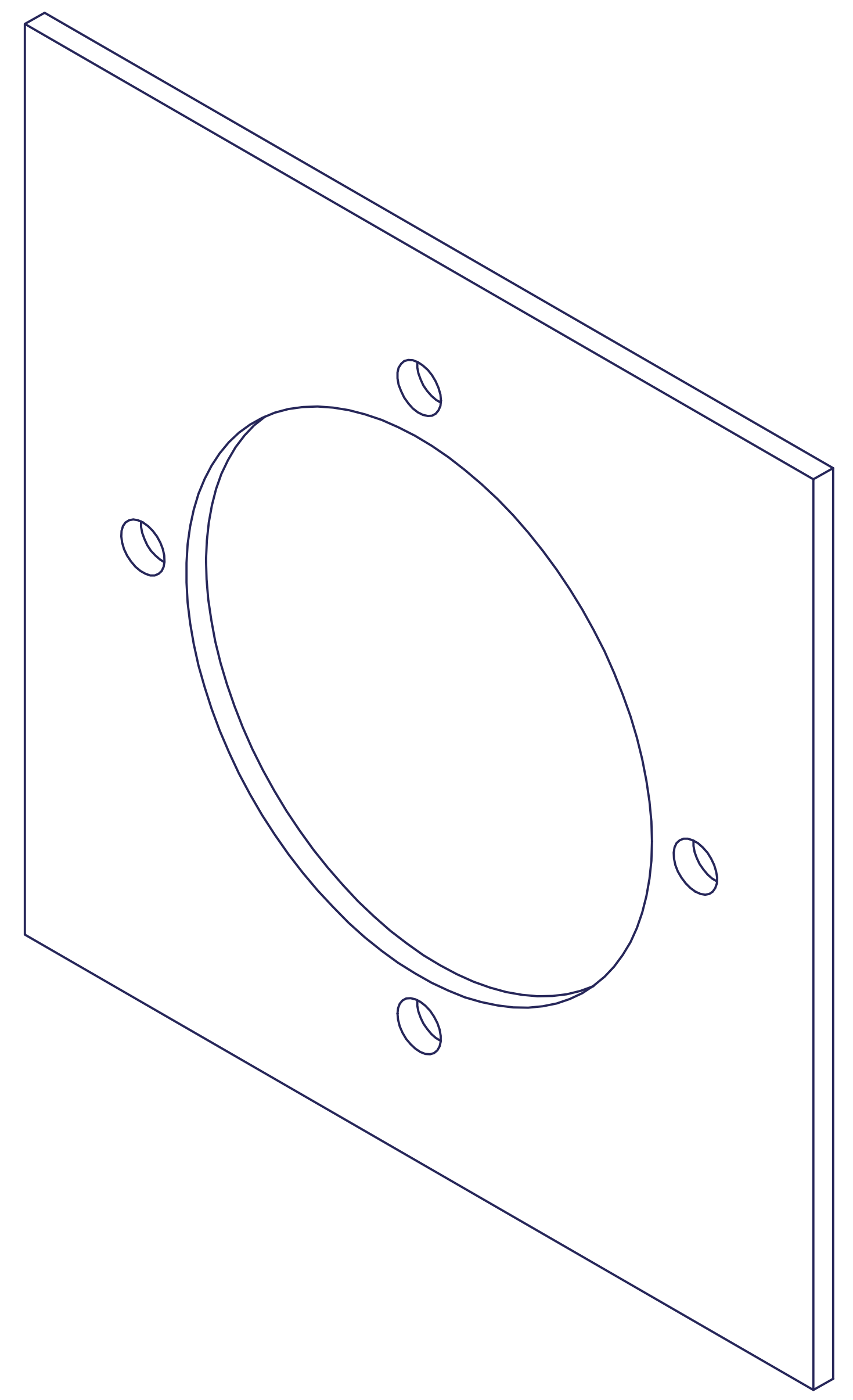
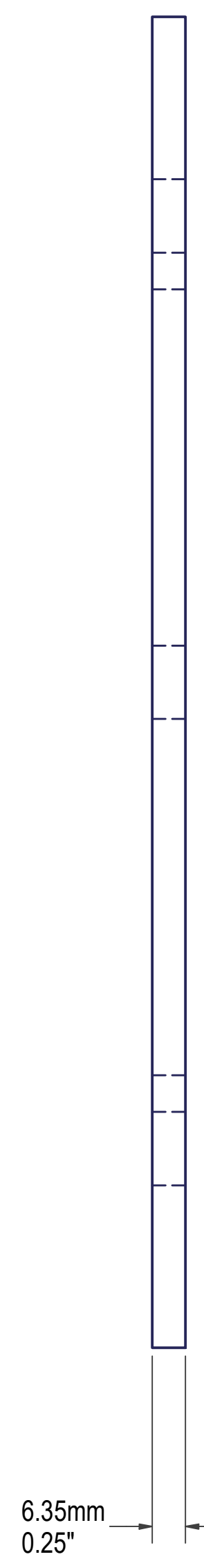
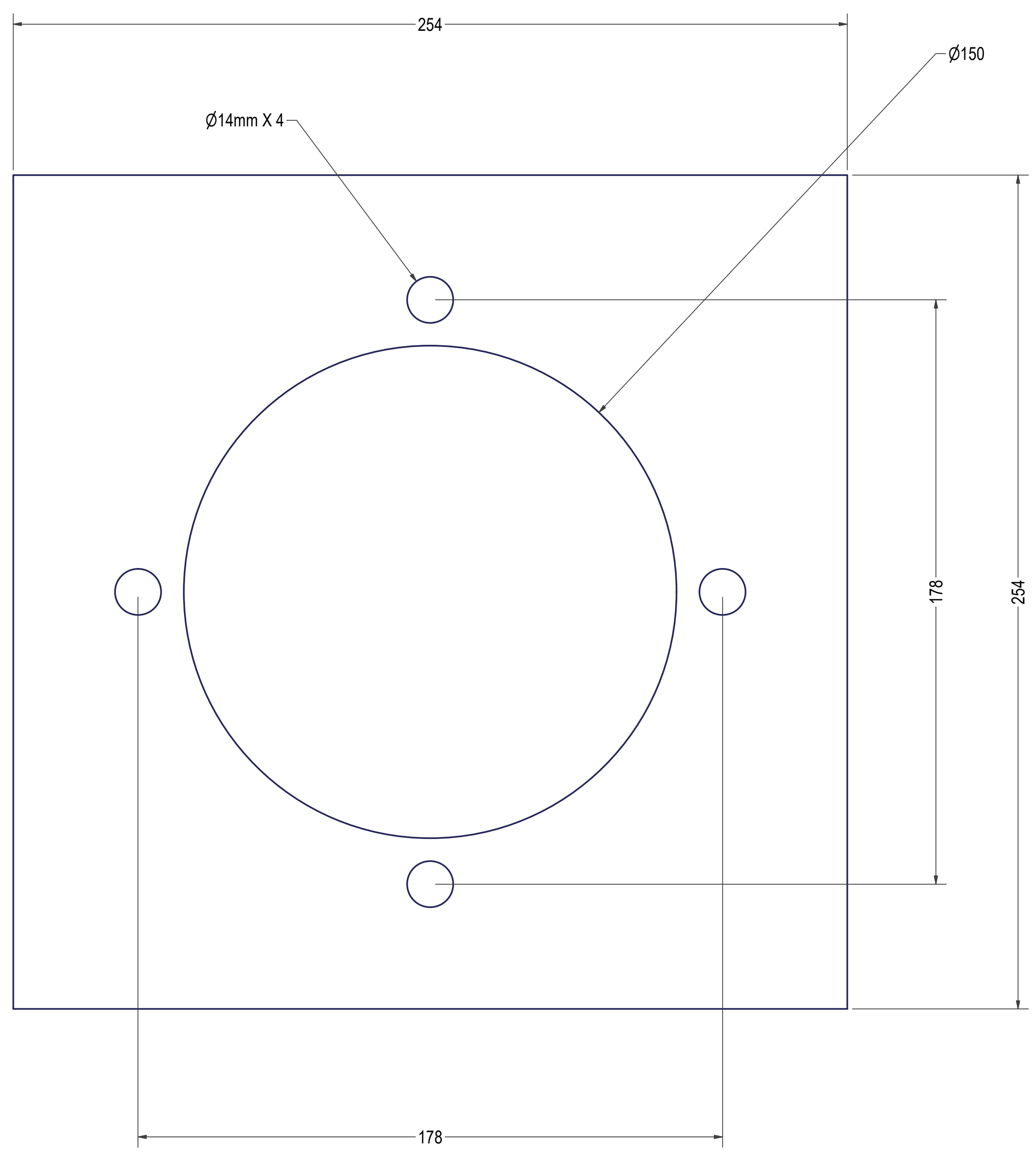

DXF FILE: PLATE BASE FOUNDATION_1

ORIGINAL SCALE	UNLESS OTHERWISE STATED
COPYRIGHT	
This drawing and any information or descriptive matters contained therein are the copyright property of OSPREA LOGISTICS Ltd. Neither the whole nor any extract may be disclosed, loaned, copied, or used for manufacturing or tendering purposes without their written consent.	
MATERIAL	Steel ASTM A36
THICK	
MASS	N/A
FINISH	NONE
ENGINEER	Dirk Genis
DRAWN	Dirk Genis
DATE	2/20/2022

DocuSigned by:
Robert L. Pennington
026439933502F452
 3/13/2022

ROBERT L. PENNINGTON
 PROFESSIONAL ENGINEER
 NORTH CAROLINA
 SEAL
 25045

Robert L. Pennington PE
 7629 Mallow Road
 Wilmington, NC 28411
 Email: robert@RLPPE.com
 Phone: 910-520-0278



FLAT PATTERN GEOMETRY IS GOVERNED BY DXF WITH THE EXPECTED TOLERANCE OF +/- 0.15mm ON ALL DXF CUTS	This print is shared on a confidential basis subject to return upon demand by Osprea and nothing hereon may be reproduced, used or disclosed in whole or in part without the prior written permission of Osprea.	UNLESS OTHERWISE SPECIFIED DIMENSIONS ARE IN MILLIMETERS		REMOVE ALL SHARP EDGES AND BURRS
		GENERAL TOLERANCES LINEAR DIMENSIONS ALL OTHER FEATURE DIMENSION TOLERANCES ARE GOVERNED BY DIN ISO 2768-mK	THIRD ANGLE PROJECTION	
DRAWING NUMBER: PLATE BASE FOUNDATION		SHEET 6 OF 10		REVISION 2

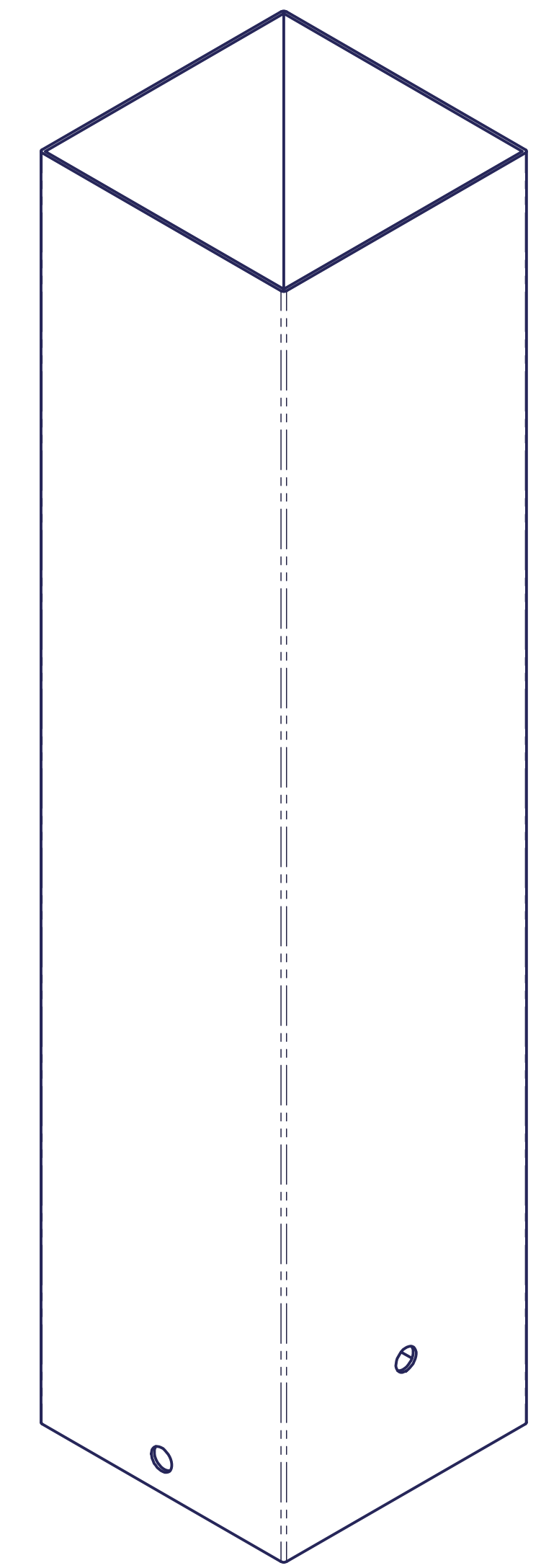
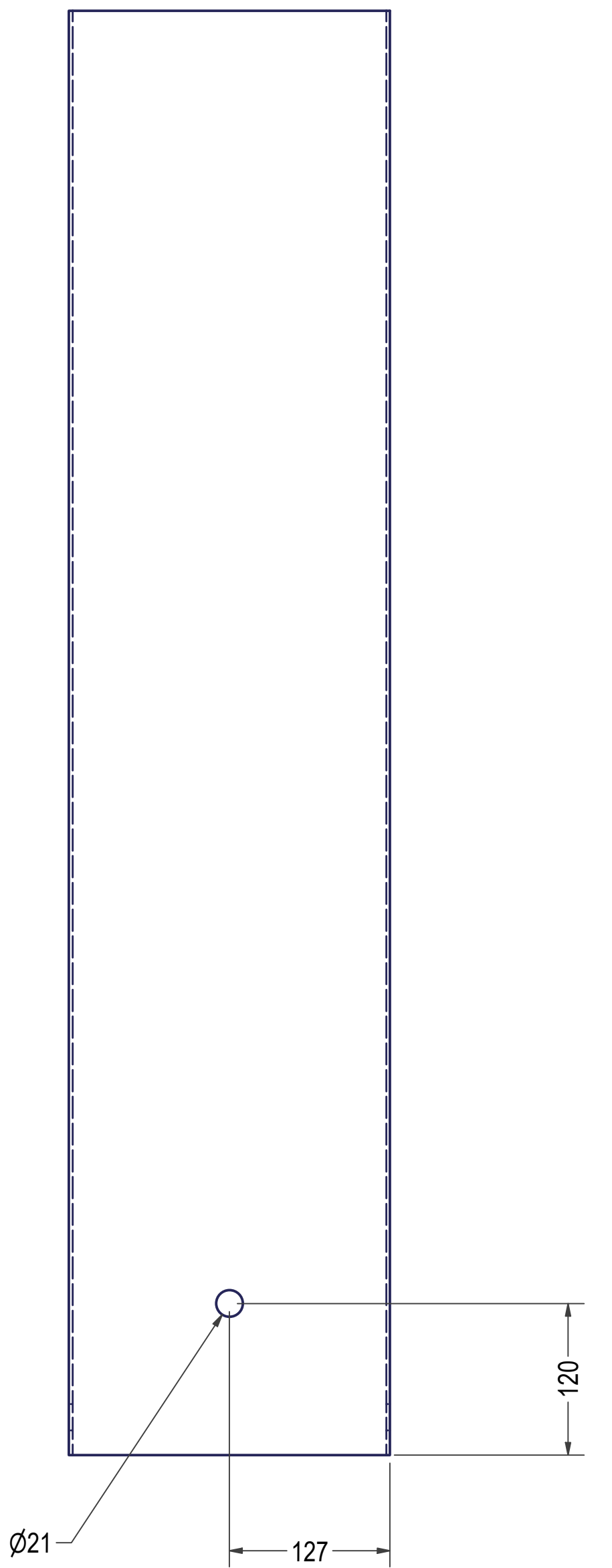
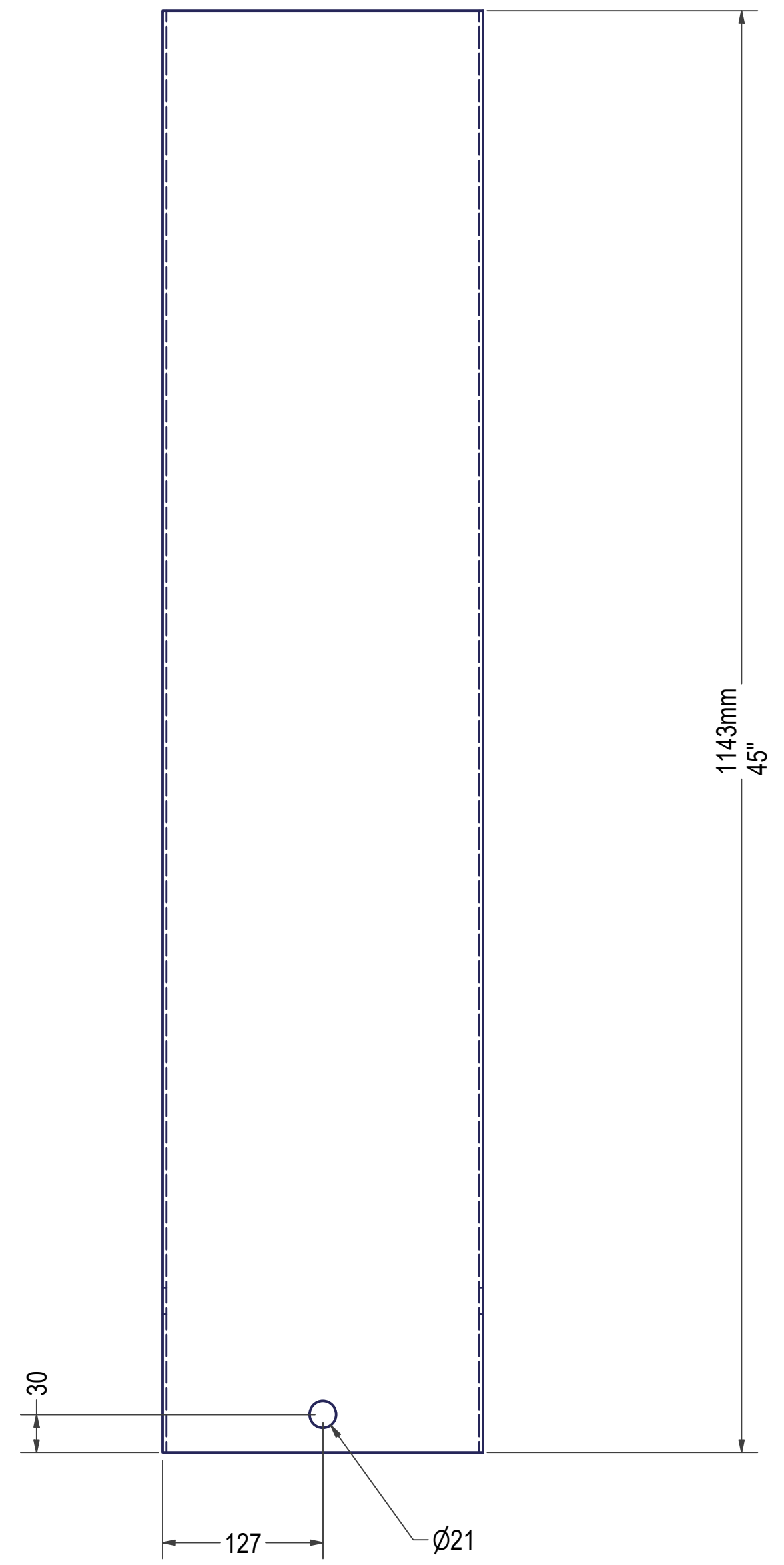
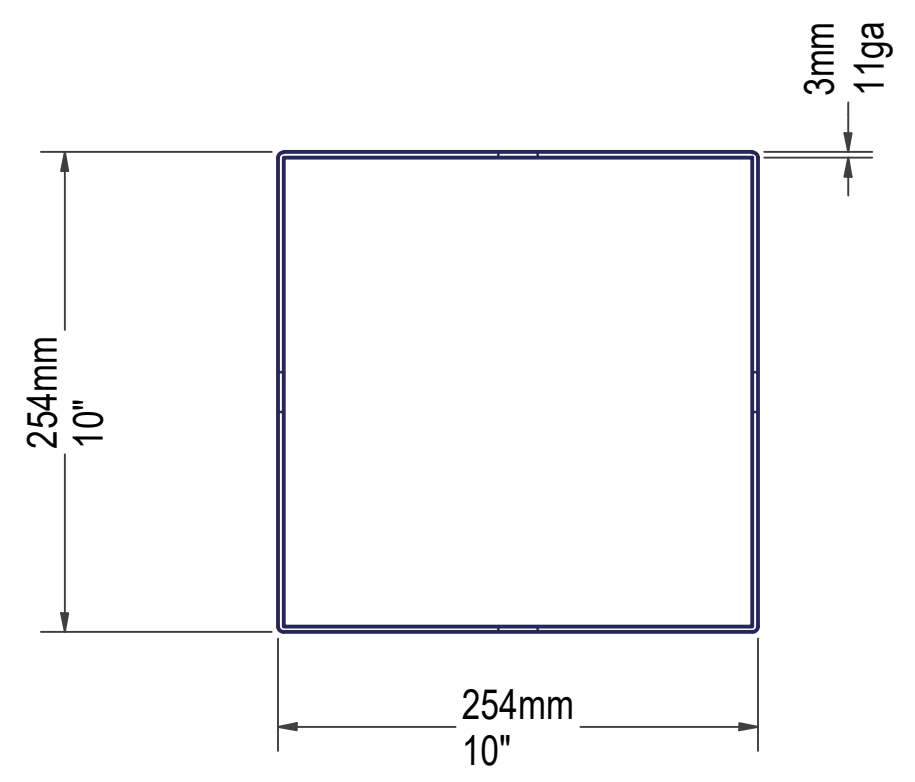

DocuSigned by:
Robert L Pennington
0064993350F452
3/13/2022

NORTH CAROLINA PROFESSIONAL SEAL 25045
ENGINEER
ROBERT L. PENNINGTON

Robert L. Pennington PE
7629 Mallow Road
Wilmington, NC 28411
Email: robert@RLPPE.com
Phone: 910-520-0278

ORIGINAL SCALE	UNLESS OTHERWISE STATED
COPYRIGHT	
This drawing and any information or descriptive matters contained therein are the copyright property of OSPREA LOGISTICS Ltd. Neither the whole nor any extract may be disclosed, loaned, copied, or used for manufacturing or tendering purposes without their written consent.	
MATERIAL	Steel ASTM A500 GR B STRUCTURAL
THICK	
MASS	26.923 kg
FINISH	NONE
ENGINEER	Dirk Genis
DRAWN	Dirk Genis
DATE	2/20/2022



FLAT PATTERN GEOMETRY IS GOVERNED BY DXF WITH THE EXPECTED TOLERANCE OF +/- 0.15mm ON ALL DXF CUTS <small>This print is shared on a confidential basis subject to return upon demand by Osprea and nothing herein may be reproduced, used or disclosed in whole or in part without the prior written permission of Osprea.</small>	UNLESS OTHERWISE SPECIFIED DIMENSIONS ARE IN MILLIMETERS GENERAL TOLERANCES LINEAR DIMENSIONS <small>ALL OTHER FEATURE DIMENSION TOLERANCES ARE GOVERNED BY DIN ISO 2768-mK</small>		REMOVE ALL SHARP EDGES AND BURRS THIRD ANGLE PROJECTION SHEET 9 OF 10 SIZE B REVISION 2																												
	<table border="1"> <tr> <th>LINEAR</th> <th>0.5</th> <th>3</th> <th>6</th> <th>12</th> <th>25</th> <th>40</th> <th>100</th> <th>200</th> </tr> <tr> <td>TO</td> <td>±0.1</td> <td>±0.2</td> <td>±0.3</td> <td>±0.5</td> <td>±0.8</td> <td>±1.2</td> <td>±2.0</td> <td></td> </tr> </table>	LINEAR		0.5	3	6	12	25	40	100	200	TO	±0.1	±0.2	±0.3	±0.5	±0.8	±1.2	±2.0		<table border="1"> <tr> <th>ANGULAR</th> <th>0.5</th> <th>10</th> <th>30</th> <th>60</th> </tr> <tr> <td>TO</td> <td>±0.5</td> <td>±1.0</td> <td>±2.0</td> <td>±4.0</td> </tr> </table>	ANGULAR	0.5	10	30	60	TO	±0.5	±1.0	±2.0	±4.0
	LINEAR	0.5		3	6	12	25	40	100	200																					
TO	±0.1	±0.2	±0.3	±0.5	±0.8	±1.2	±2.0																								
ANGULAR	0.5	10	30	60																											
TO	±0.5	±1.0	±2.0	±4.0																											
TITLE TUBE PILLAR		DRAWING NUMBER TUBE PILLAR																													

