

VICINITY MAP
Not To Scale

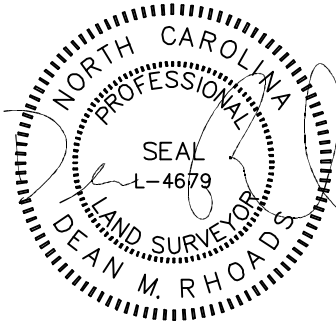

IMPERVIOUS SURFACE AREA	
DESCRIPTION	AREA
HOUSE w/ PORCH	2,431 S.F.
SC PORCH/HVAC	129 S.F.
DRIVEWAY & WALKS	1,139 S.F.
TOTAL (PROPOSED)=	3,699 S.F.
*TOTAL (ALLOWED)=	5,300 S.F.

*PB 2021, PG 567

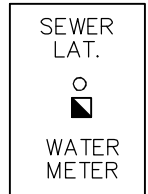
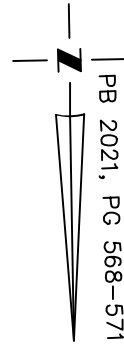

SETBACKS: (PB 2021, PG 567-571)

FRONT - 35'
REAR - 20'
SIDE - 10'
CORNER SIDE - 10'

N/F
JAMES C. TUTOR
DEBRA D. TUTOR
DB 3481, PG 503

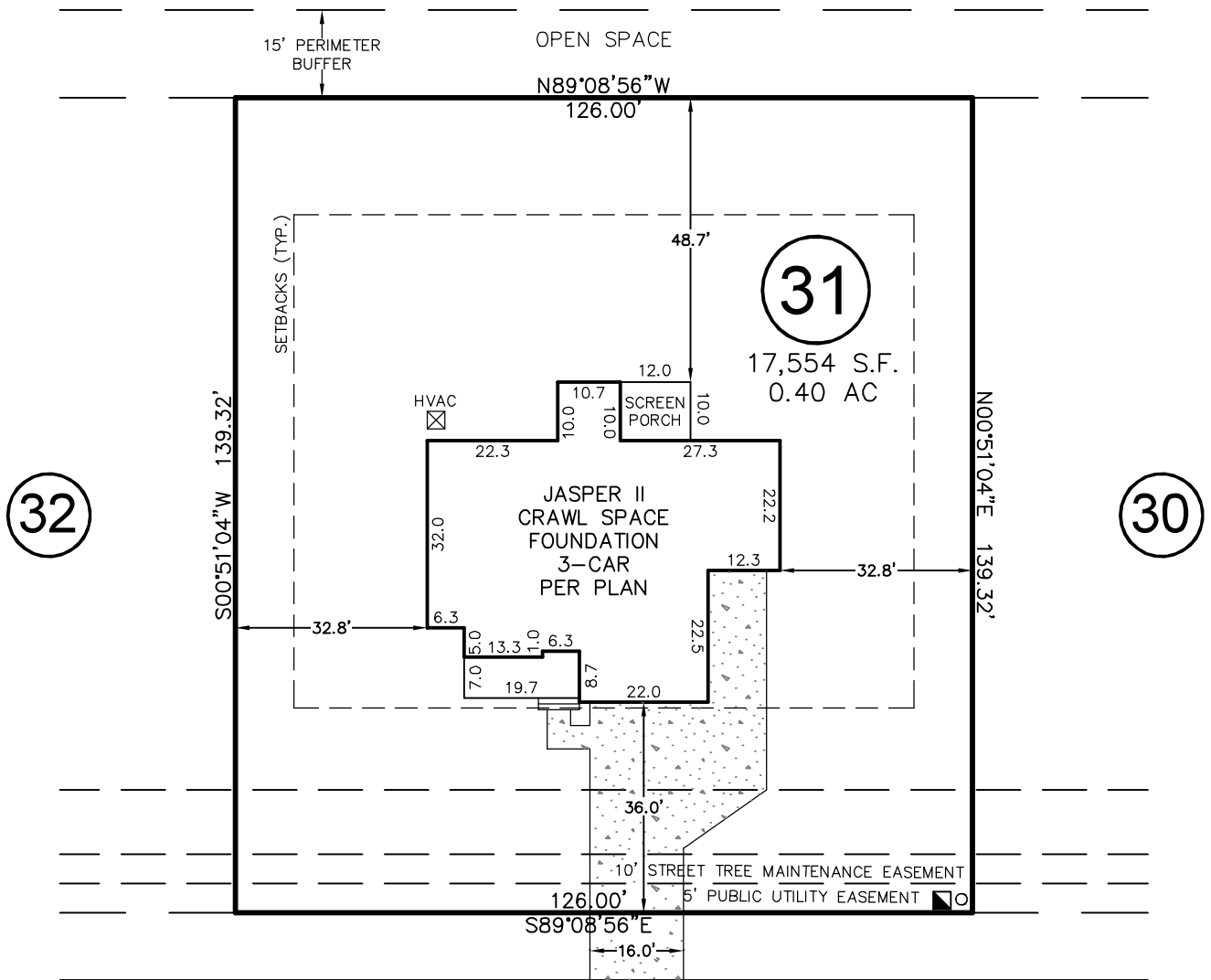

LAMBERT LANE
50' PUBLIC R/W & UTILITY EASEMENT

THIS PROPERTY MAY BE SUBJECT TO ANY AND ALL APPLICABLE DEED RESTRICTIONS, EASEMENTS, RIGHT-OF-WAY, UTILITIES AND RESTRICTIVE COVENANTS WHICH MAY BE OF RECORD OR IMPLIED

THIS DRAWING DOES NOT REFLECT AS-BUILT INFORMATION

PRELIMINARY PLAT
NOT FOR RECORDATION, CONVEYANCES, OR SALES.

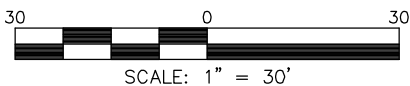

HOUSE LOCATION PLOT PLAN

FOR
#481 LAMBERT LANE
LOT 31, PURFOY PLACE SUBDIVISION
Hector's Creek Township, Harnett County, North Carolina
PROPERTY OF: GEMSTONE HOMES
MAP BOOK 2021 PAGE 568-571 DEED REFERENCE _____ PAGE _____

**RESIDENTIAL
LAND SERVICES, PLLC.**

1917 Evans Road
Cary, North Carolina 27513
Phone (919) 378-9316
Firm License # P-0873

DRAWN BY: JLA

DATE: MARCH 23, 2022