

# Harnett County Department of Public Health

PERMIT # SFD2203-0098

## Operation Permit

New Installation  Septic Tank  Nitrification Line  Repair  Expansion

PROPERTY LOCATION: 30 McINTOSH CT

Name: (owner) KB HOMES RALEIGH SUBDIVISION BIRCHWOOD GROVE LOT # 12

System Installer: BRANTLEY & SONS

Basement with plumbing:  Garage  Number of Bedrooms 5

Type of Water Supply:  Community  Public  Well Distance from well \_\_\_\_\_ feet

System Type: III g Types V and VI Systems expire in 5 years.

(In accordance with Table V a)

Owner must contact Health Department 6 months prior to expiration for permit renewal.

This system has been installed in compliance with applicable North Carolina General Statutes, Rules for Sewage Treatment and Disposal, and all conditions of the Improvement Permit and Construction Authorization.

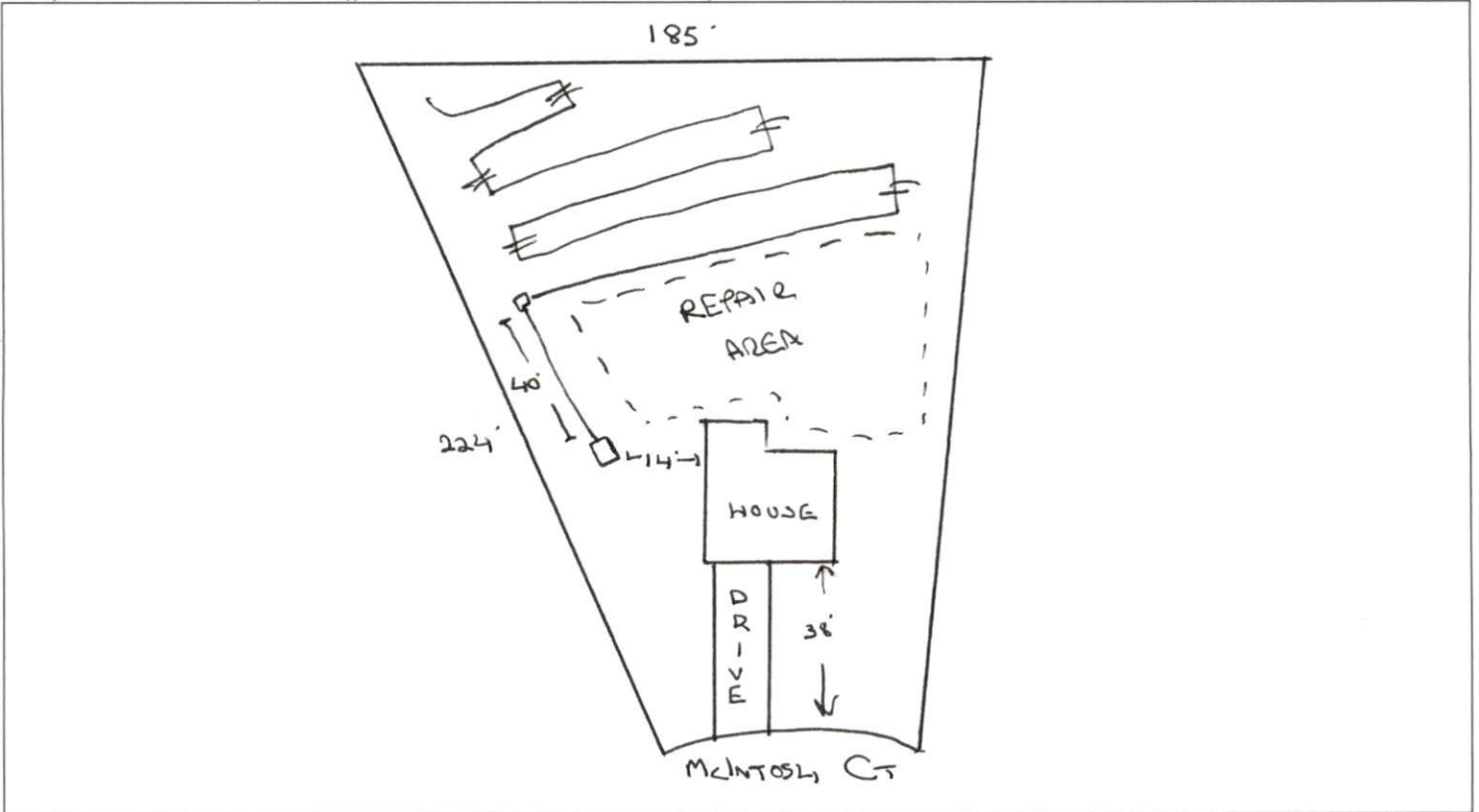

**PERMIT CONDITIONS:**

- I. Performance: System shall perform in accordance with Rule .1961.
- II. Monitoring: As required by Rule .1961.
- III. Maintenance: As required by Rule .1961. Other: \_\_\_\_\_  
 Subsurface system operator required? Yes  No   
 If yes, see attached sheet for additional operation conditions, maintenance and reporting.

IV. Operation: \_\_\_\_\_  
 V. Other: \_\_\_\_\_

\_\_\_\_\_ D-Box  \_\_\_\_\_ Pump  \_\_\_\_\_ Alarm  \_\_\_\_\_ H2O Line  \_\_\_\_\_ PWR Line

Following are the specifications for the sewage disposal system on the above captioned property.

Type of system:  Conventional  Other E2FLOW Septic Tank: 1250 gallons Pump Tank: \_\_\_\_\_ gallons  
 Subsurface No. of exact length width of depth of  
 Drainage Field ditches 1 of each ditch 430 feet ditches 3 feet ditches 18 inches  
 French Drain Required: \_\_\_\_\_ Linear feet

Authorized State Agent REHJ Date 7/27/22