

Harnett County Department of Public Health

Improvement Permit

A building permit cannot be issued with only an Improvement Permit

ISSUED TO: KB Homes Raleigh PROPERTY LOCATION: John Stark Dr
 SUBDIVISION Birchwood Grove LOT # 114

NEW REPAIR EXPANSION Site Improvements required prior to Construction Authorization Issuance:

Type of Structure: SFD (37'x48')

Proposed Wastewater System Type: 25% Reduction System

Projected Daily Flow: 360 GPD

Number of bedrooms: 3 Number of Occupants: 6 max

Basement Yes No

Pump Required: Yes No May be required based on final location and elevations of facilities

Type of Water Supply: Community Public Well Distance from well _____ feet

Permit valid for: Five years
 No expiration

Permit conditions: _____

Authorized State Agent: [Signature] Date: 5/10/22 SEE ATTACHED SITE SKETCH

The issuance of this permit by the Health Department in no way guarantees the issuance of other permits. The permit holder is responsible for checking with appropriate governing bodies in meeting their requirements. This site is subject to revocation if the site plan, plat, or the intended use changes. The Improvement Permit shall not be affected by a change in ownership of the site. This permit is subject to compliance with the provisions of the Laws and Rules for Sewage Treatment and Disposal and to conditions of this permit.

Construction Authorization

(Required for Building Permit)

The construction and installation requirements of Rules .1950, .1952, .1954, .1955, .1956, .1957, .1958, and .1959 are incorporated by references into this permit and shall be met. Systems shall be installed in accordance with the attached system layout.

ISSUED TO: KB Homes Raleigh PROPERTY LOCATION: John Stark Dr
 SUBDIVISION Birchwood Grove LOT # 114

Facility Type: SFD (37'x48') New Expansion Repair

Basement? Yes No Basement Fixtures? Yes No

Type of Wastewater System** 25% Reduction System (pump) (Initial) Wastewater Flow: 360 GPD

(See note below, if applicable)

25% Reduction System (pump) (Repair)

<u>Installation Requirements/Conditions</u>	Number of trenches <u>1</u>	
Septic Tank Size <u>1000</u> gallons	Exact length of each trench <u>225</u> feet	Trench Spacing: <u>9</u> Feet on Center
Pump Tank Size <u>1000</u> gallons	Trenches shall be installed on contour at a Maximum Trench Depth of: <u>18</u> inches (Trench bottoms shall be level to +/-1/4" in all directions)	Soil Cover: <u>6</u> inches (Maximum soil cover shall not exceed 36" above the trench bottom)
Pump Requirements: _____ ft. TDH vs. _____ GPM		Aggregate Depth: _____ inches below pipe _____ inches above pipe _____ inches total
Conditions: _____		

**WATER LINES (INCLUDING IRRIGATION) MUST BE 10FT. FROM ANY PART OF SEPTIC SYSTEM OR REPAIR AREA.
 NO UTILITIES ALLOWED IN INITIAL OR REPAIR DRAIN FIELD AREA.**

***If applicable: I understand the system type specified is different from the type specified on the application. I accept the specifications of this permit.*

Owner/Legal Representative Signature: _____ Date: _____

This Construction Authorization is subject to revocation if the site plan, plat, or the intended use changes. The Construction Authorization shall not be transferred when there is a change in ownership of the site. This Construction Authorization is subject to compliance with the provisions of the Laws and Rules for Sewage Treatment and Disposal and to the conditions of this permit. SEE ATTACHED SITE SKETCH

Authorized State Agent: [Signature] Date: 5/10/22
 Construction Authorization Expiration Date: 5/10/27

Application # SFD2203-0097

Harnett County Department of Public Health Site Sketch

Property Location: John Stark Dr
Issued To: KB Homes Raleigh Subdivision Birchwood Grove Lot # 114

Authorized State Agent: RENS (OLIVER TOLKSDORF) Date: 5/10/22

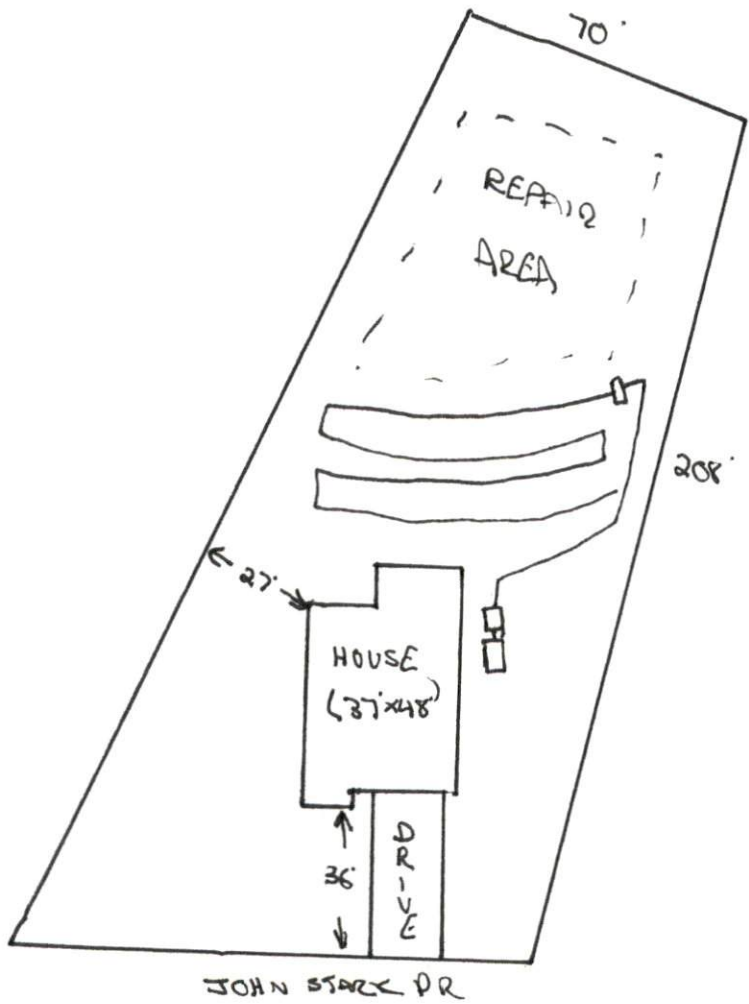

This drawing is for illustrative purposes only. System installation must meet all pertinent laws, rules, and regulations.

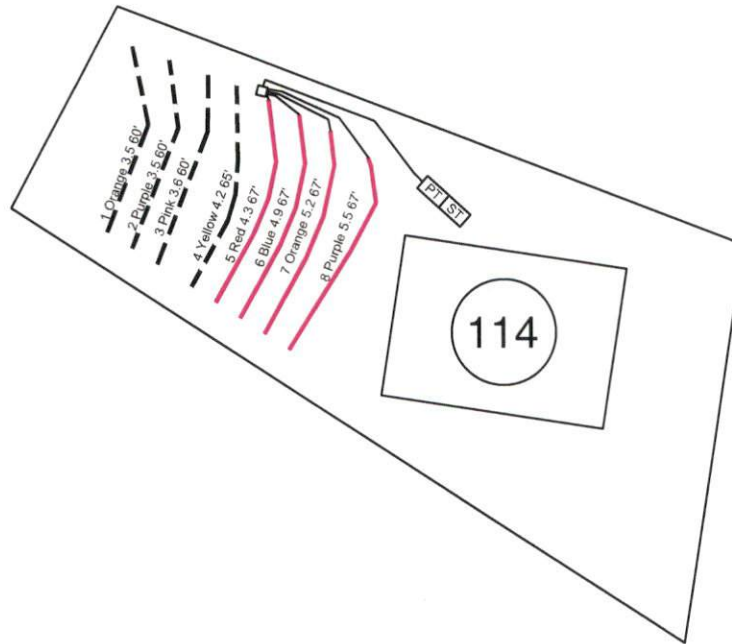

System: ———
 Repair: - - - -

- *Keep tanks and drain lines 10' from property lines.
- *Not a survey.
- *Not a guarantee of a septic permit.
- *Keep supply lines >5' from property lines.
- *Some lines are flagged longer in the field than lengths indicate.
- *No grading septic area.

System: Pump to D-Box
 Lines: 1-4, (4x67'x3')
 EZ Flow
 0.4 Soil LTAR
 24" Trench Bottom

Repair: Pressure Manifold
 Lines: 5-9, (245')
 T&J Panel
 0.4 Soil LTAR
 24" Trench Bottom

GRAPHIC SCALE
 1" = 60'



Central Carolina Soil Consulting, PLLC
 1900 South Main Street, Suite 110
 Wake Forest, North Carolina 27587
 Phone (919)569-6704 Fax (919)569-6703

3-Bedroom Septic Layout
 Lot 114, Birchwood Subdivision
 Wake County, North Carolina

Job# : 3753
 Drawn By : LW
 Date : 08/17/2021
 Revision: