

HARNETT DEPARTMENT OF PUBLIC HEALTH PERMIT
TO CONSTRUCT A DRINKING WATER SUPPLY WELL

PIN #: 1506-47-1807.000 Parcel #: 061506 0067 05 Application #: SFD2203-0068 Subdivision: _____ Lot #: _____

Applicant Name: CUMBERLAND HOMES INC
Address: 64 OLD HAMILTON RD DUNN, NC 28334

Type of Facility Served by Well: SFD

Sewage System: At- System

Permit Conditions: 64 Old Hamilton Road (SR 1776)

General Permit Conditions:

- Drinking water supply well construction must meet 15A NCAC 02C.100 rules
- The permitted drinking water supply well shall be located in accordance with the **SITE PLAN**
- **ANY ALTERATION** of the site of the site (including location of structures and appurtenance) or modification in use of the well, may subject this Permit to revocation

Authorized State Agent [Signature] Date 04/09/2022

Grouting Inspection Witnessed _____ Date _____
 Grouting self-certified by driller GW-1 provided? Yes No

See attachment for construction sketch

WELL CERTIFICATE OF COMPLETION

Date: _____ Application #: SFD2203-0068 Well Contractor: _____

Applicant Name: CUMBERLAND HOMES INC
Address: 64 OLD HAMILTON RD DUNN, NC 28334
Directions to Site: 64 OLD HAMILTON RD (SR 1776)

Use of Well: _____ Date Drilled: _____ Total Depth: _____ Replacement Well? Yes No
Static Water Level: _____ Top of Casing is _____ in. above surface. Yield: _____ gpm at _____ ft.
Disinfection: Type _____ Amount _____

<u>Water Zone (depth)</u>	<u>Casing</u>	<u>Grout</u>
From _____ To _____	From _____ To _____	From 0 To _____
From _____ To _____	Diameter: _____ Material: _____ Thickness: _____	Material: _____ Method: _____
From _____ To _____	From _____ To _____	From _____ To _____
	Diameter: _____ Material: _____ Thickness: _____	Material: _____ Method: _____
	From _____ To _____	From _____ To _____
	Diameter: _____ Material: _____ Thickness: _____	Material: _____ Method: _____

Inspector: _____ On Hold Date: _____ Release Date: _____

Remarks: _____

Well Head Information

Casing Height: 10" (above finished grade) Access Port: Vent Stack:
Well ID Tag: Pump ID Tag: Sampling Tap: Backflow Preventer:
Sample Taken? Yes No Well Head properly sealed:

Remarks: _____

Authorized State Agent [Signature] Date 12-19-22

See Attachment for completion sketch

Well Construction Sketch

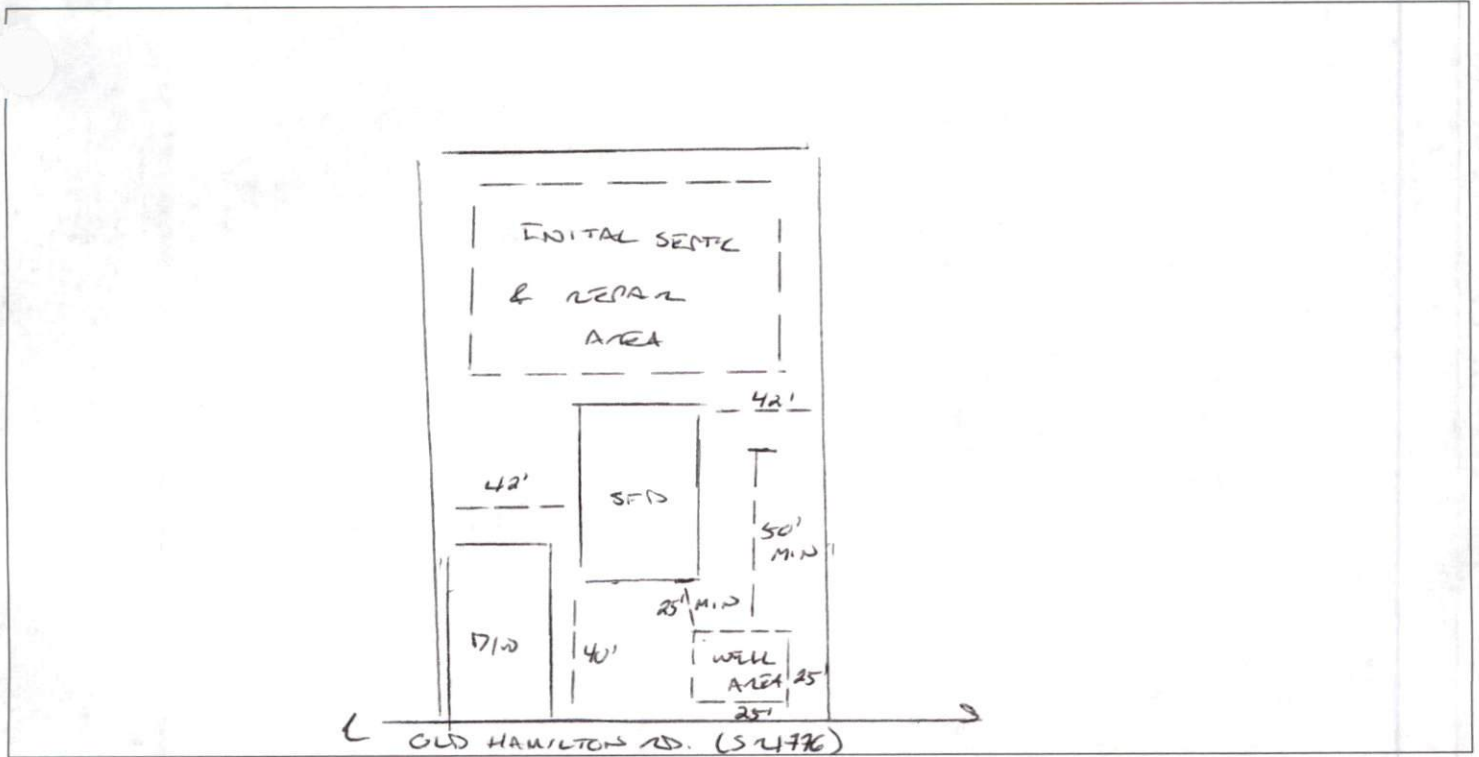

Completion Sketch

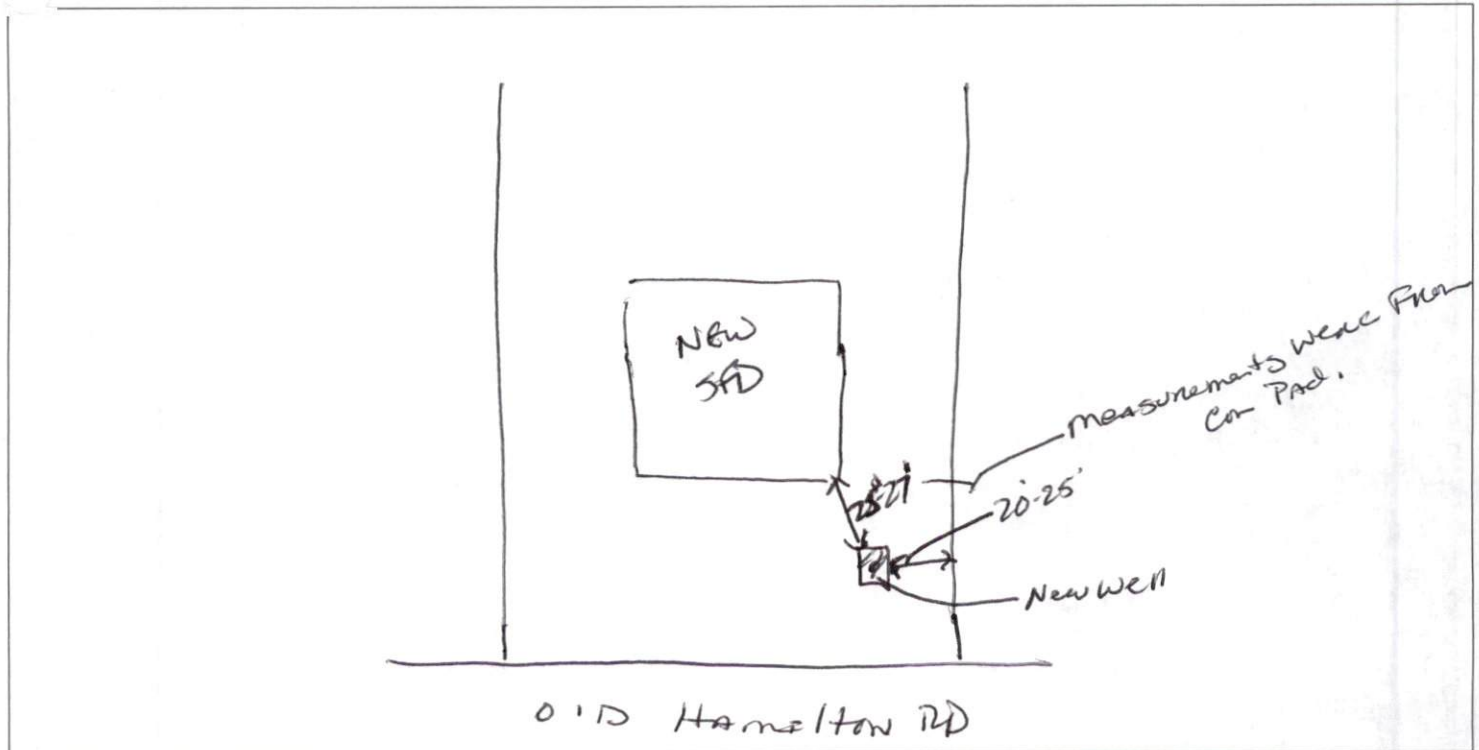

SFD 2203-0068



WELL CONSTRUCTION RECORD (GW-1)

Form GW-1 Well Construction Electronic Form
North Carolina Department of Environmental Quality
Division of Water Resources
November 18, 2021

Submission ID#

GW1-2022-10271

Are you submitting a scanned form? *

- Yes
- No

CONTACT INFORMATION

Contact Name *

Jonathan Kamionka

Email Address *

office@billswelldrilling.com

Is this a revision to the form you have previously submitted? *

- Yes
- No

WELL CONSTRUCTION INFORMATION

1. Who is installing these wells? *

- Owner
- Well Contractor

1. Well Contractor Information:

Certificate #	Cert Level	First Name	Last Name	Company Name
3465	A	JONATHAN	KAMIONKA	BILLS WELL DRILLING CO, INC.

2. Well Construction Permit #:

SFD2203-0068

List all applicable well construction permits (i.e. Monitoring Wells, UIC- Underground Injection Control, CCPCUA-Central Coastal Plain Capacity Use Area, County, etc.)

What type of well is this? *

- Injection Well
- Water Supply Well (includes irrigation wells)
- Non-Water Supply Well

3. Water Supply Well *

- Geothermal (Heating/Cooling Supply)
- Irrigation
- Residential Water Supply (single)
- Wells > 100,000 GPD
- Industrial/Commercial
- Municipal/Public/Community
- Residential Water Supply (shared)

4. Date well was completed and ID#

Date Well Completed *	Well ID#	Well Yield
-----------------------	----------	------------

11/21/2022

20

(gallons per minute)*

5. Well Location

Facility/Owner Name *

Cumberland Homes

(Required)

Facility ID#

(If applicable)

County *

Harnett

Parcel Identification No. (PIN)

061506006705

Physical Address *

Street Address

64 Old Hamilton Road

Address Line 2

City

Dunn

Postal / Zip Code

28334-7148

State / Province / Region

NC

Country

US

Latitude * 35.3098420000

Decimal degrees

Longitude * 78.6510263000

Decimal degrees

6. Is(are) the well(s): * Permanent Temporary

7. Is this a repair to an existing well: * Yes No

If this is a repair, fill out known well construction information and explain the nature of the repair under #21 remarks section or on the back of this form.

For multiple Geoprobe/DPT or Closed-Loop Geothermal Wells having the same construction, only 1 GW-1 is needed.

8a. Indicate TOTAL NUMBER of wells drilled: 1

9. Total well depth below land surface: (ft.)

280

For multiple wells list all depths if different
(example- 3@200' and 2@100')

9a. What is the depth of the casing from ground surface?

148

in feet

10. Static water level below top of casing: (ft.)

85

If water level is above casing, use "+"

11. Borehole diameter:

5.75

in inches

12. Well construction method:

Auger

Direct Push

Other

Air Rotary

Mud Rotary

Cable Tool

Rotosonic

13. FOR WATER SUPPLY WELLS ONLY:

13a. Yield (gpm)

20

If applicable

13a. Method of test:

blow

13b. Disinfection type: *

HTH

13b. Amount: *

1 cup

14. WATER BEARING/FRACTURE ZONES

From	To	Description
260 <small>in feet</small>	280 <small>in feet</small>	

15. OUTER CASING (for multi-cased wells) OR LINER (if applicable)

From	To	Diameter	Thickness	Material
1.00 <small>in feet</small>	148.00 <small>in feet</small>	6.25 <small>in inches</small>	SDR21	PVC

17. SCREEN

From	To	Diameter	Thickness	Material
<small>in feet</small>	<small>in feet</small>	<small>in inches</small>		

18. GROUT

From	To	Material	Emplacement Method & Amount
0.00 <small>in feet</small>	25.00 <small>in feet</small>	bentonite	poured

19. SAND/GRAVEL PACK (if applicable)

From	To	Material	Emplacement Method
<small>in feet</small>	<small>in feet</small>		

20. DRILLING LOG

From	To	Description (color, hardness, soil/rock type, grain size, etc.)
0.00 <small>in feet</small>	7.00 <small>in feet</small>	Clay
7.00 <small>in feet</small>	9.00 <small>in feet</small>	Gravel & Sandstone
9.00 <small>in feet</small>	135.00 <small>in feet</small>	Mixed Clay
135.00 <small>in feet</small>	160.00 <small>in feet</small>	Green Rock
160.00 <small>in feet</small>	280.00 <small>in feet</small>	Dark Gray & Black Rock

21. Remarks

22. Site diagram or additional well details:

You may upload additional well construction information here.
pdf only

CERTIFICATION INFORMATION

* By signing this form, I hereby certify that the well(s) was (were) constructed in accordance with 15A NCAC 02C .0100 or 15A NCAC 02C .0200 Well Construction Standards and that a copy of this record has been provided to the well owner.

23. Certification

Jonathan Kamionka

Signature of Certified Well Contractor