

**VICINITY MAP**  
Not To Scale

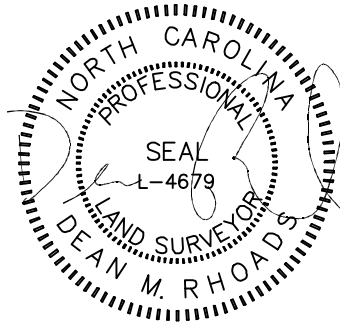

IMPERVIOUS SURFACE AREA	
DESCRIPTION	AREA
HOUSE & PORCH	1,863 S.F.
SCREEN PORCH/HVAC	171 S.F.
DRIVEWAY & WALKS	639 S.F.
TOTAL =	2,673 S.F.
LOT AREA =	17,633 S.F.
% IMPERVIOUS AREA	=15.2%

SETBACKS: (PB 2021 PB 567)

FRONT-35'  
REAR -20'  
SIDE-10'  
CORNER LOT SIDE - 10'

N/F  
OAK CREEK S/D  
PC#C, SLIDE 83D

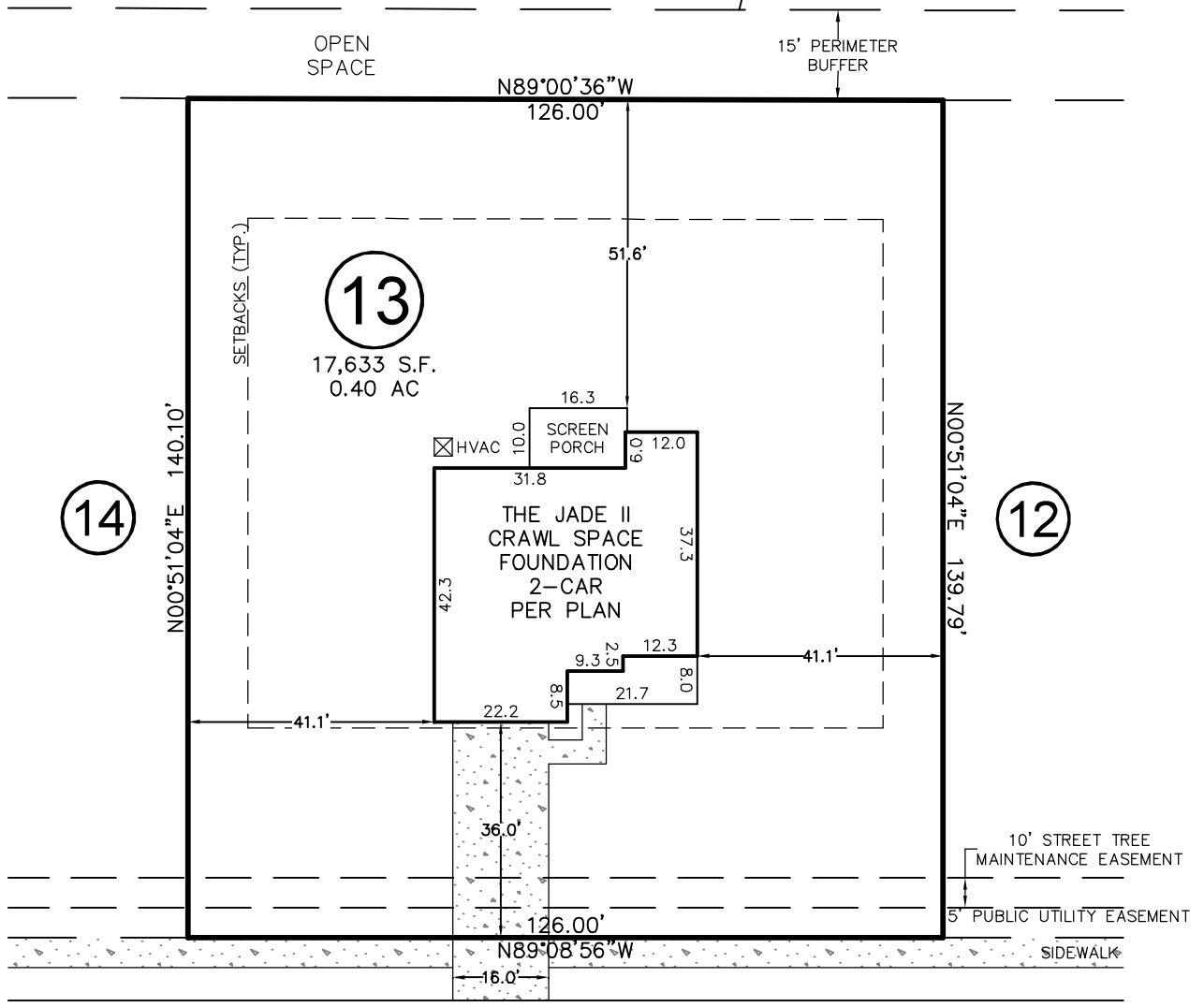
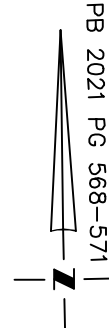

# LAMBERT LANE

50' PUBLIC R/W

THIS DRAWING DOES NOT REFLECT AS-BUILT INFORMATION

**PRELIMINARY PLAT**  
NOT FOR RECORDATION, CONVEYANCES, OR SALES.

THIS PROPERTY MAY BE SUBJECT TO ANY AND ALL APPLICABLE DEED RESTRICTIONS, EASEMENTS, RIGHT-OF-WAY, UTILITIES AND RESTRICTIVE COVENANTS WHICH MAY BE OF RECORD OR IMPLIED

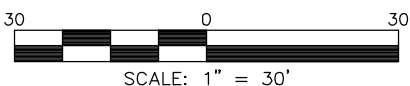

SCALE: 1" = 30'

## HOUSE LOCATION PLOT PLAN

FOR #294 LAMBERT LANE

LOT 13, PURFOY PLACE SUBDIVISION

Hector's Creek Township, Harnett County, North Carolina

PROPERTY OF: GEMSTONE HOMES

MAP BOOK 2021 PAGE 569 DEED REFERENCE \_\_\_\_\_ PAGE \_\_\_\_\_

DRAWN BY: ADP

DATE: MARCH 10, 2022

### RESIDENTIAL LAND SERVICES, PLLC.

1917 Evans Road  
Cary, North Carolina 27513  
Phone (919) 378-9316  
Firm License # P-0873