

HARNETT DEPARTMENT OF PUBLIC HEALTH PERMIT  
TO CONSTRUCT A DRINKING WATER SUPPLY WELL

PIN #: 1506-47-0999.000 Parcel #: 061506 0067 04 Application #: SFD2203-0066 Subdivision: \_\_\_\_\_ Lot #: \_\_\_\_\_

Applicant Name: CUMBERLAND HOMES INC  
Address: 40 OLD HAMILTON RD DUNN, NC 28334

Type of Facility Served by Well: SFD

Sewage System: At- System

Permit Conditions: 40 Old Hamilton Road (SR 1776)

General Permit Conditions:

- Drinking water supply well construction must meet 15A NCAC 02C.100 rules
- The permitted drinking water supply well shall be located in accordance with the **SITE PLAN**
- **ANY ALTERATION** of the site of the site (including location of structures and appurtenance) or modification in use of the well, may subject this Permit to revocation

Authorized State Agent [Signature] Date 04/07/2022

Grouting Inspection Witnessed \_\_\_\_\_ Date \_\_\_\_\_  
 Grouting self-certified by driller GW-1 provided?  Yes  No

See attachment for construction sketch

WELL CERTIFICATE OF COMPLETION

Date: \_\_\_\_\_ Application #: SFD2203-0066 Well Contractor: \_\_\_\_\_

Applicant Name: CUMBERLAND HOMES INC  
Address: 40 OLD HAMILTON RD DUNN, NC 28334  
Directions to Site: 40 OLD HAMILTON RD (SR 1776)

Use of Well: \_\_\_\_\_ Date Drilled: \_\_\_\_\_ Total Depth: \_\_\_\_\_ Replacement Well?  Yes  No  
Static Water Level: \_\_\_\_\_ Top of Casing is \_\_\_\_\_ in. above surface. Yield: \_\_\_\_\_ gpm at \_\_\_\_\_ ft.  
Disinfection: Type \_\_\_\_\_ Amount \_\_\_\_\_

Water Zone (depth)	Casing	Grout
From _____ To _____	From _____ To _____	From 0 To _____
From _____ To _____	Diameter: _____ Material: _____ Thickness: _____	Material: _____ Method: _____
From _____ To _____	From _____ To _____	From _____ To _____
	Diameter: _____ Material: _____ Thickness: _____	Material: _____ Method: _____
	From _____ To _____	From _____ To _____
	Diameter: _____ Material: _____ Thickness: _____	Material: _____ Method: _____

Inspector: \_\_\_\_\_ On Hold Date: \_\_\_\_\_ Release Date: \_\_\_\_\_

Remarks: \_\_\_\_\_

Well Head Information

Casing Height: 12" (above finished grade) Access Port:  Vent Stack:   
Well ID Tag:  Pump ID Tag:  Sampling Tap:  Backflow Preventer: \_\_\_\_\_  
Sample Taken?  Yes  No Well Head properly sealed:

Remarks: \_\_\_\_\_

Authorized State Agent [Signature] Date 12-19-22

See Attachment for completion sketch

Well Construction Sketch

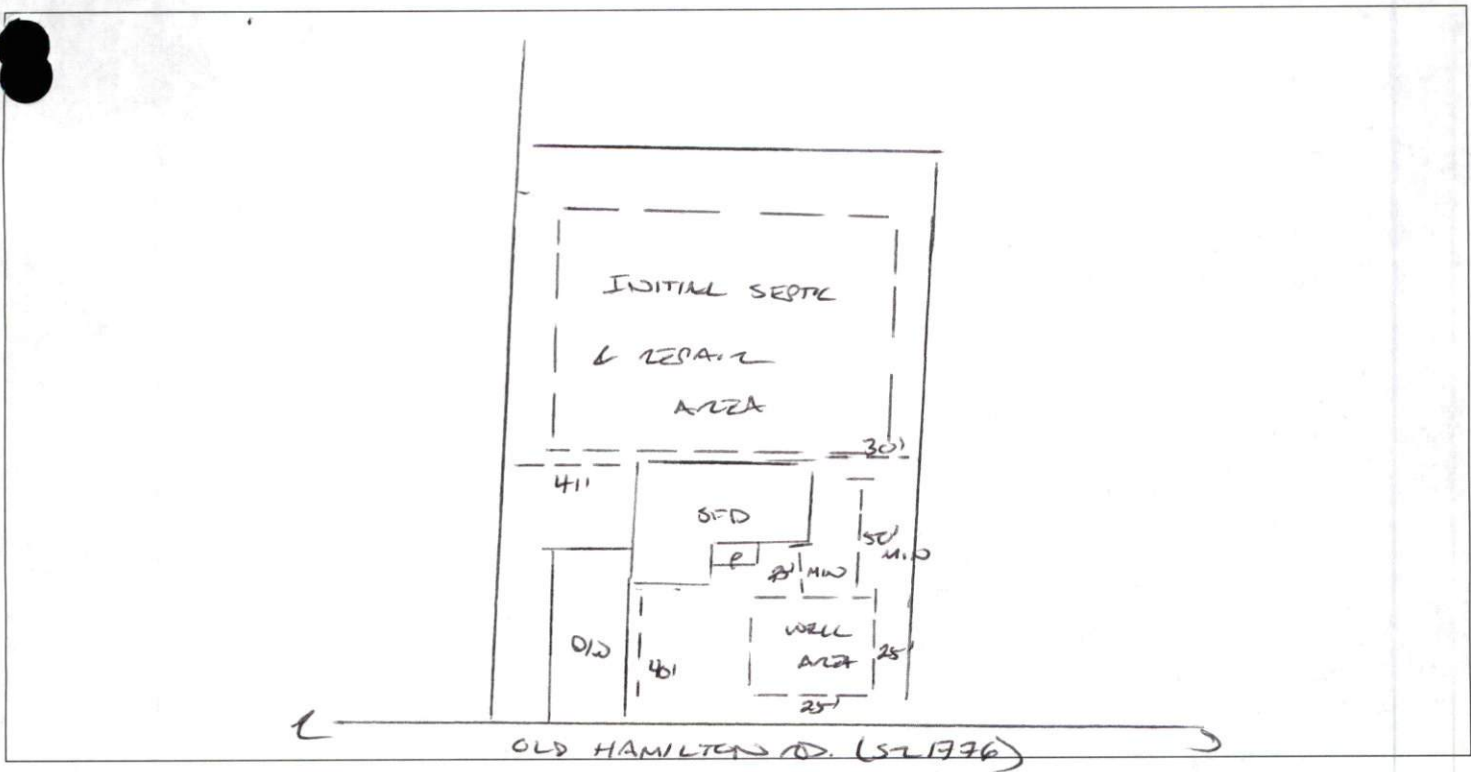

Completion Sketch

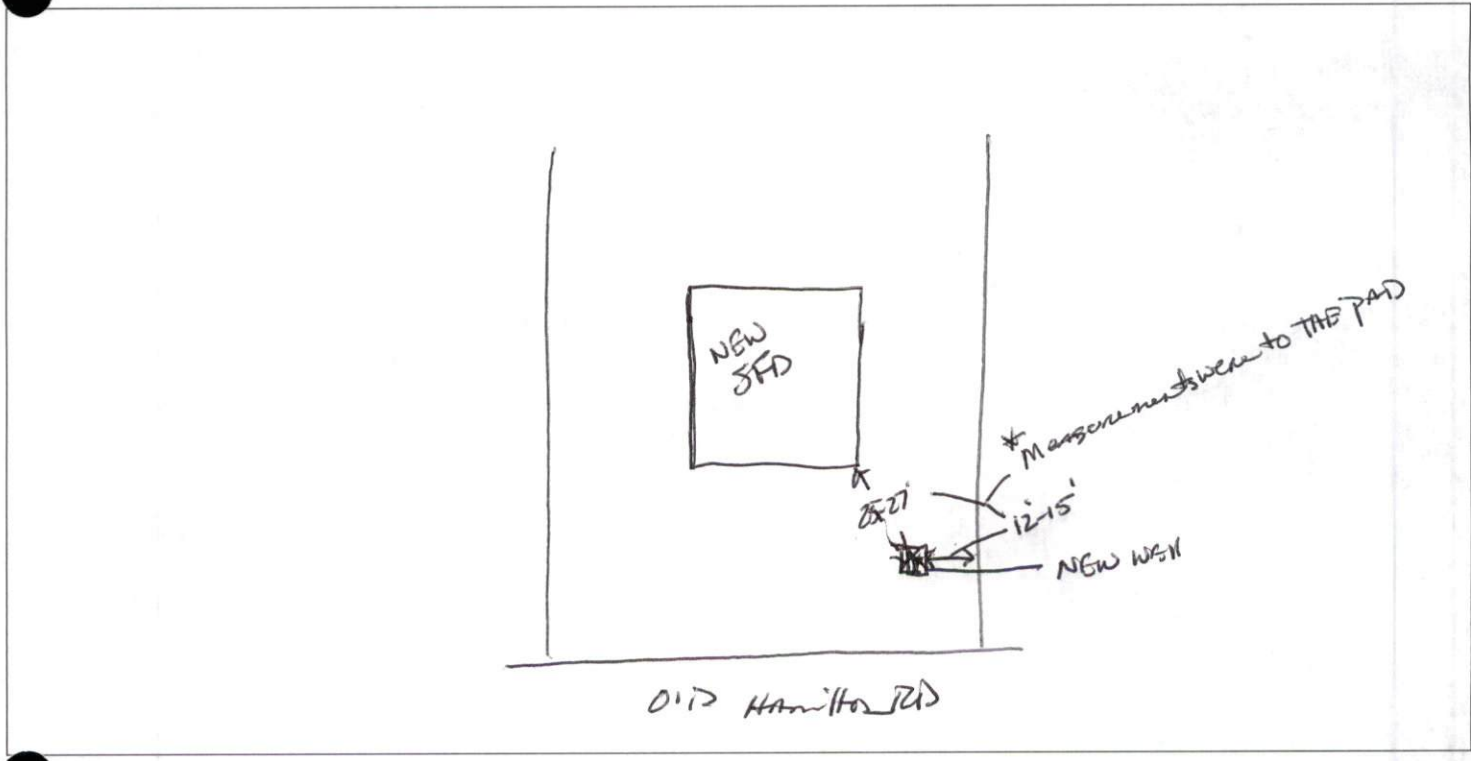

SFD 2203-0066



# WELL CONSTRUCTION RECORD (GW-1)

Form GW-1 Well Construction Electronic Form  
North Carolina Department of Environmental Quality  
Division of Water Resources  
November 18, 2021

Submission ID#

GW1-2022-10272

Are you submitting a scanned form? \*  
 Yes  
 No

## CONTACT INFORMATION

Contact Name \* Jonathan Kamionka  
Email Address \* office@billswelldrilling.com

Is this a revision to the form you have previously submitted? \*  
 Yes  No

## WELL CONSTRUCTION INFORMATION

1. Who is installing these wells? \*  
 Owner  Well Contractor

### 1. Well Contractor Information:

Certificate #	Cert Level	First Name	Last Name	Company Name
3465	A	JONATHAN	KAMIONKA	BILLS WELL DRILLING CO, INC.

### 2. Well Construction Permit #:

SFD2203-0066

List all applicable well construction permits (i.e. Monitoring Wells, UIC- Underground Injection Control, CCPCUA-Central Coastal Plain Capacity Use Area, County, etc.)

What type of well is this? \*  
 Injection Well  
 Water Supply Well (includes irrigation wells)  
 Non-Water Supply Well

3. Water Supply Well \*  
 Geothermal (Heating/Cooling Supply)  
 Irrigation  
 Residential Water Supply (single)  
 Wells > 100,000 GPD  
 Industrial/Commercial  
 Municipal/Public/Community  
 Residential Water Supply (shared)

### 4. Date well was completed and ID#

Date Well Completed \* Well ID# Well Yield

11/21/2022

4

(gallons per minute)\*

5. Well Location

Facility/Owner Name\*

Cumberland Homes  
(Required)

Facility ID#

(If applicable)

County\*

Harnett

Parcel Identification No. (PIN)

0561506006704

Physical Address\*

Street Address

40 Old Hamilton Rd

Address Line 2

City

Dunn

Postal / Zip Code

28334

State / Province / Region

NC

Country

US

Latitude\* 0.0000000000

Decimal degrees

Longitude\* 0.0000000000

Decimal degrees

6. Is(are) the well(s):\*  Permanent  Temporary

7. Is this a repair to an existing well:\*  Yes  No

If this is a repair, fill out known well construction information and explain the nature of the repair under #21 remarks section or on the back of this form.

For multiple Geoprobe/DPT or Closed-Loop Geothermal Wells having the same construction, only 1 GW-1 is needed.

8a. Indicate TOTAL NUMBER of wells drilled: 1

9. Total well depth below land surface: (ft.)

320

For multiple wells list all depths if different  
(example- 3@200' and 2@100')

9a. What is the depth of the casing from ground surface?

138

in feet

10. Static water level below top of casing: (ft.)

85

If water level is above casing, use "+"

11. Borehole diameter:

5.75

in inches

12. Well construction method:

Auger

Direct Push

Other

Air Rotary

Mud Rotary

Cable Tool

Rotosonic

13. FOR WATER SUPPLY WELLS ONLY:

13a. Yield (gpm)

4

If applicable

13a. Method of test:

blow

13b. Disinfection type:\*

HTH

13b. Amount:\*

1 cup

**14. WATER BEARING/FRACTURE ZONES**

From	To	Description
200 in feet	320 in feet	

**15. OUTER CASING (for multi-cased wells) OR LINER (if applicable)**

From	To	Diameter	Thickness	Material
1.00 in feet	138.00 in feet	6.25 in inches	SDR21	PVC

**17. SCREEN**

From	To	Diameter	Thickness	Material
in feet	in feet	in inches		

**18. GROUT**

From	To	Material	Emplacement Method & Amount
0.00 in feet	25.00 in feet	bentonite	poured

**19. SAND/GRAVEL PACK (if applicable)**

From	To	Material	Emplacement Method
in feet	in feet		

**20. DRILLING LOG**

From	To	Description (color, hardness, soil/rock type, grain size, etc.)
0.00 in feet	7.00 in feet	Clay
7.00 in feet	8.00 in feet	Gravel & Sandstone
8.00 in feet	125.00 in feet	Mixed Clay
125.00 in feet	160.00 in feet	Green Rock
160.00 in feet	320.00 in feet	Dark Gray & Black Rock

**21. Remarks****22. Site diagram or additional well details:**

You may upload additional well construction information here.

pdf only

**CERTIFICATION INFORMATION**

\*  By signing this form, I hereby certify that the well(s) was (were) constructed in accordance with 15A NCAC 02C .0100 or 15A NCAC 02C .0200 Well Construction Standards and that a copy of this record has been provided to the well owner.

**23. Certification**

*Jonathan Kamionka*

Signature of Certified Well Contractor