

VICINITY MAP
Not To Scale

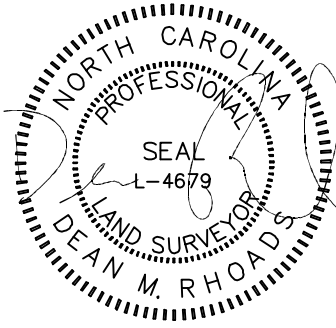

IMPERVIOUS SURFACE AREA	
DESCRIPTION	AREA
HOUSE & PORCH	1,863 S.F.
SC PORCH/HVAC	167 S.F.
DRIVEWAY & WALKS	647 S.F.
TOTAL =	2,677 S.F.
LOT AREA =	17,554 S.F.
% IMPERVIOUS AREA	=15.3%

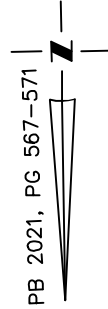

SETBACKS: (PB 2021, PG 567-571)

FRONT - 35'
REAR - 20'
SIDE - 10'
CORNER SIDE - 10'

N/F
JAMES C. TUTOR &
DEBRA D. TUTOR
DB 3481, PG 503

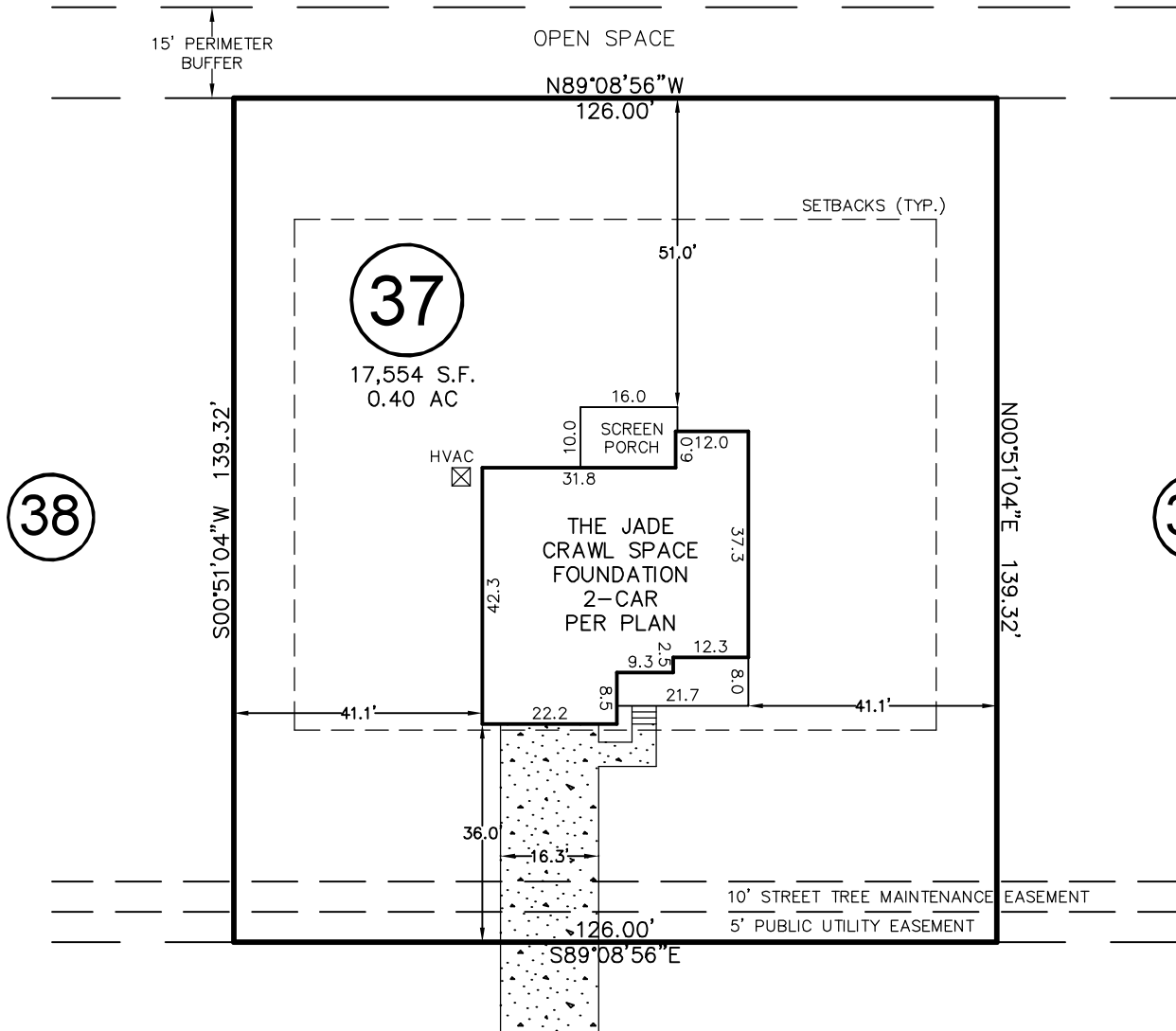

LAMBERT LANE
50' PUBLIC R/W & UTILITY EASEMENT

THIS DRAWING DOES NOT
REFLECT AS-BUILT INFORMATION

PRELIMINARY PLAT
NOT FOR RECORDATION, CONVEYANCES, OR SALES.

THIS PROPERTY MAY BE SUBJECT TO ANY AND ALL APPLICABLE DEED
RESTRICTIONS, EASEMENTS, RIGHT-OF-WAY, UTILITIES AND
RESTRICTIVE COVENANTS WHICH MAY BE OF RECORD OR IMPLIED

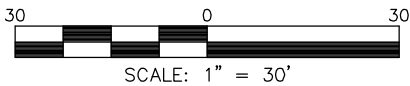

**RESIDENTIAL
LAND SERVICES, PLLC.**

1917 Evans Road
Cary, North Carolina 27513
Phone (919) 378-9316
Firm License # P-0873

HOUSE LOCATION PLOT PLAN

FOR
#337 LAMBERT LANE
LOT 37, PURFOY PLACE SUBDIVISION
Hector's Creek Township, Harnett County, North Carolina
PROPERTY OF: GEMSTONE HOMES
MAP BOOK 2021 PAGE 568-571 DEED REFERENCE _____ PAGE _____

DRAWN BY: SMB

DATE: MARCH 10, 2022