

**SOIL/SITE EVALUATION  
 for ON-SITE WASTEWATER SYSTEM**

Owner: **KMB** Applicant: \_\_\_\_\_  
 Address: **694 Manor Hills** Date Evaluated: **3-25-22**  
 Proposed Facility: **36x47' SFD** Design Flow (.1949): **360 GPD** Property Size: \_\_\_\_\_  
 Location of Site: \_\_\_\_\_ Property Recorded: \_\_\_\_\_  
 Water Supply:  Public  Individual  Well  Spring  Other  
 Evaluation Method:  Auger Boring  Pit  Cut  
 Type of Wastewater:  Sewage  Industrial Process  Mixed

P R O F I L E #	.1940 Landscape Position/ Slope %	Horizon Depth (In.)	SOIL MORPHOLOGY .1941		OTHER PROFILE FACTORS				Profile Class & LTAR
			.1941 Structure/ Texture	.1941 Consistence Mineralogy	.1942 Soil Wetness/ Color	.1943 Soil Depth (IN.)	.1956 Sapro Class	.1944 Restr Horiz	
Pit 1	L	0-32	LS Gr	Fr/hs/wp/np	>48"	>48"	—	—	PS.5
	5-7%	32-48	sci SBlk	Fr/ss/sp/np					Group III
Pit 2	L	0-22	LS Gr	Fr/hs/wp/np	10yr 7/1	>48"	—	—	PS.5
	5-7%	22-48	sci SBlk	Fr/ss/sp/np	≥ 42"				Group III

Description	Initial System	Repair System	Other Factors (.1946): Site Classification (.1948): Evaluated By: Others Present:
Available Space (.1945)	✓	✓	
System Type(s)	25% ml	25% ml	
Site LTAR	.5	.5	

PS  
 MML — RCH

COMMENTS: \_\_\_\_\_

LANDSCAPE POSITIONS	GROUP	TEXTURES	.1955 LTAR	CONSISTENCE MOIST	WET
R-RIDGE	I	S-SAND	1.2 - 0.8	VFR-VERY FRIABLE	NS-NON-STICKY
S-SHOULDER SLOPE		LS-LOAMY SAND		FR-FRIABLE	SS-SLIGHTLY STICKY
L-LINEAR SLOPE	II	SL-SANDY LOAM	0.8 - 0.6	FI-FIRM	S-STICKY
FS-FOOT SLOPE		L-LOAM		VFI-VERY FIRM	VS-VERY STICKY
N-NOSE SLOPE	III	SI-SILT	0.6 - 0.3	EFI-EXTREMELY FIRM	NP-NON-PLASTIC
H-HEAD SLOPE		SIL-SILT LOAM			SP-SLIGHTLY STICKY
CC-CONCLAVE SLOPE		CL-CLAY LOAM			P-PLASTIC
CV-CONVEX SLOPE		SCL-SANDY CLAY LOAM			VP-VERY PLASTIC
T-TERRACE	IV	SIC-SILTY CLAY	0.4 - 0.1		
FP-FLOOD PLAN		C-CLAY			
		SC-SANDY CLAY			

STRUCTURE

- SG-SINGLE GRAIN
- M- MASSIVE
- CR-CRUMB
- GR-GRANULAR
- SBK-SUBANGULAR BLOCKY
- ABK-ANGULAR BLOCKY
- PL-PLATY
- PR-PRISMATIC

MINERALOGY

- SLIGHTLY EXPANSIVE
- EXPANSIVE

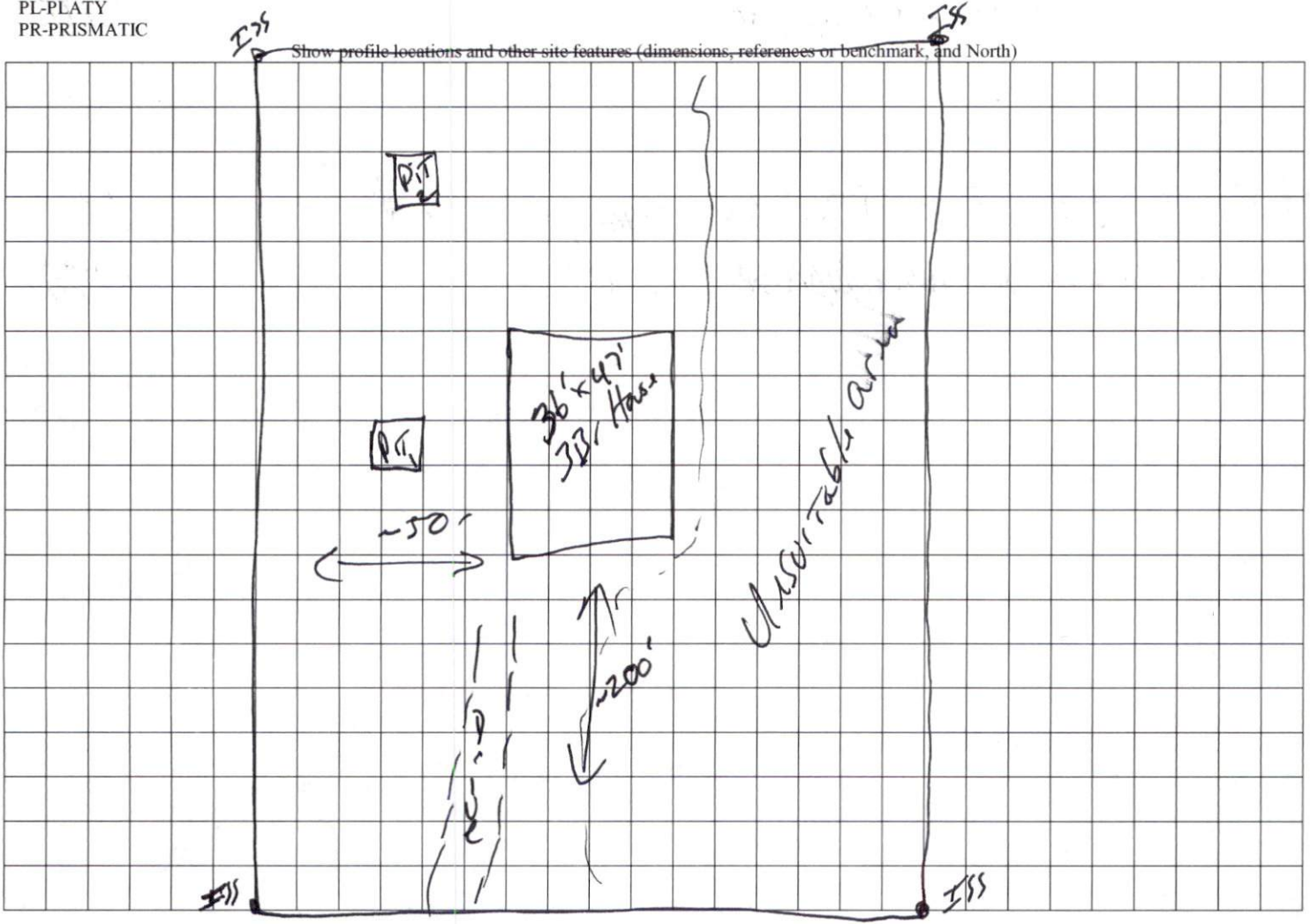

Manor Hills