

Harnett County Department of Public Health

Improvement Permit

A building permit cannot be issued with only an Improvement Permit

PROPERTY LOCATION: 50 Artemas Ward

ISSUED TO: KB Home Raleigh

SUBDIVISION Birchwood Grove

LOT # 102

NEW REPAIR EXPANSION

Site Improvements required prior to Construction Authorization Issuance:

Type of Structure: SFD (56'x43')

Proposed Wastewater System Type: Pump to 25% Red Svs

Projected Daily Flow: 480 GPD

Number of bedrooms: 4 Number of Occupants: 8 max

Basement Yes No

Pump Required: Yes No May be required based on final location and elevations of facilities

Type of Water Supply: Community Public Well Distance from well _____ feet

Permit valid for: Five years
 No expiration

Permit conditions:

Authorized State Agent: _____

RGAS

Date: 4/6/22

SEE ATTACHED SITE SKETCH

The issuance of this permit by the Health Department in no way guarantees the issuance of other permits. The permit holder is responsible for checking with appropriate governing bodies in meeting their requirements. This site is subject to revocation if the site plan, plat, or the intended use changes. The Improvement Permit shall not be affected by a change in ownership of the site. This permit is subject to compliance with the provisions of the Laws and Rules for Sewage Treatment and Disposal and to conditions of this permit.

Construction Authorization

(Required for Building Permit)

The construction and installation requirements of Rules .1950, .1952, .1954, .1955, .1956, .1957, .1958, and .1959 are incorporated by references into this permit and shall be met. Systems shall be installed in accordance with the attached system layout.

ISSUED TO: KB Homes Raleigh

PROPERTY LOCATION: 50 Artemas Ward

SUBDIVISION Birchwood Grove

LOT # 102

Facility Type: SFD (56'x43') New Expansion Repair

Basement? Yes No Basement Fixtures? Yes No

Type of Wastewater System** Pump to 25% Reduction System (Initial) Wastewater Flow: 480 GPD

(See note below, if applicable)

Pump to 25% Reduction System (Repair)

Installation Requirements/Conditions

Septic Tank Size 1000 gallons

Pump Tank Size 1000 gallons

Number of trenches 4

Exact length of each trench 85 feet

Trenches shall be installed on contour at a

Maximum Trench Depth of: 18 inches

(Trench bottoms shall be level to +/-1/4"

in all directions)

Trench Spacing: 9 Feet on Center

Soil Cover: 6 inches

(Maximum soil cover shall not exceed

36" above the trench bottom)

Pump Requirements: _____ ft. TDH vs. _____ GPM

_____ inches below pipe

Aggregate Depth: _____ inches above pipe

_____ inches total

WATER LINES (INCLUDING IRRIGATION) MUST BE 10FT. FROM ANY PART OF SEPTIC SYSTEM OR REPAIR AREA.

NO UTILITIES ALLOWED IN INITIAL OR REPAIR DRAIN FIELD AREA.

**If applicable: I understand the system type specified is different from the type specified on the application. I accept the specifications of this permit.

Owner/Legal Representative Signature: _____

Date: _____

This Construction Authorization is subject to revocation if the site plan, plat, or the intended use changes. The Construction Authorization shall not be transferred when there is a change in ownership of the site. This Construction Authorization is subject to compliance with the provisions of the Laws and Rules for Sewage Treatment and Disposal and to the conditions of this permit.

SEE ATTACHED SITE SKETCH

Authorized State Agent: _____

RGAS

Date: 4/6/22

Construction Authorization Expiration Date: 4/6/27

Application # SFD2203-0035

Harnett County Department of Public Health Site Sketch

Property Location: 50 Artemas Ward

Issued To: KB Homes Subdivision Birchwood Grove Lot # 102

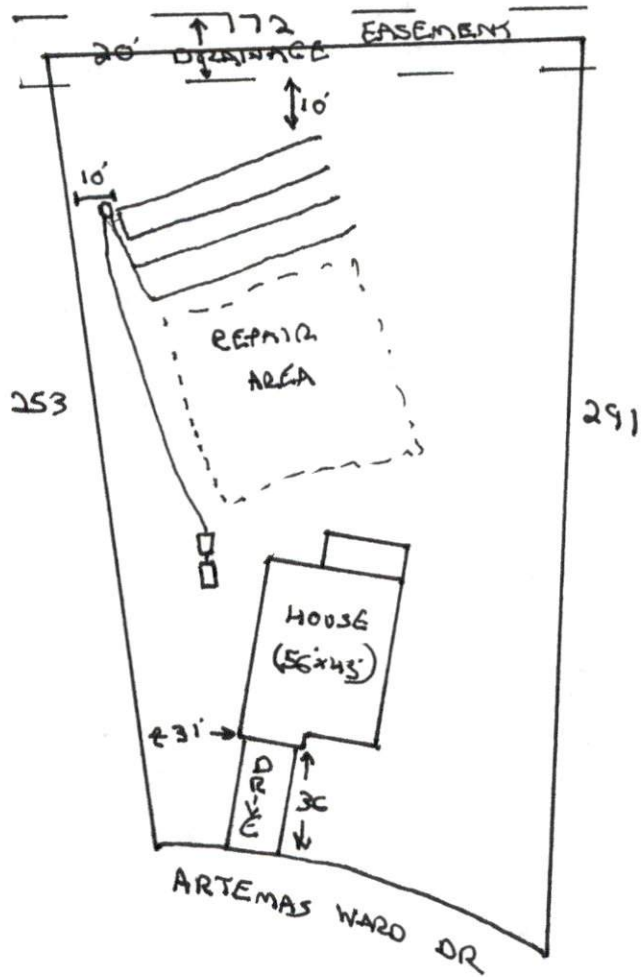

Authorized State Agent: RENS (OLIVER TOLKSDORF) Date: 4/6/22



*CALL WITH ANY
QUESTIONS PRIOR
TO INSTALLATION

This drawing is for illustrative purposes only. System installation must meet all pertinent laws, rules, and regulations.



System: 
 Repair: 

- *Keep tanks and drain lines 10' from property lines.
- *Not a survey.
- *Not a guarantee of a septic permit.
- *Keep supply lines >5' from property lines.
- *Some lines are flagged longer in the field than lengths indicate.
- *No grading septic area.

System: Pump to Mani-T
 Lines: 2-5, (360')
 Accepted Status System
 0.35 Soil LTAR
 24" Trench Bottom

Repair: Pressure Manifold
 Lines: 1,6-9, (370')
 Accepted Status System
 0.35 Soil LTAR

GRAPHIC SCALE
 1" = 60'



Central Carolina Soil Consulting, PLLC
 1900 South Main Street, Suite 110
 Wake Forest, North Carolina 27587
 Phone (919)569-6704 Fax (919)569-6703

3-Bedroom Septic Layout
 Lot 102, Birchwood Subdivision
 Harnett County, North Carolina

Job# : 3753
Drawn By : LW
Date : 09/22/2021
Revision: