

# Harnett County Department of Public Health Improvement Permit

A building permit cannot be issued with only an Improvement Permit

ISSUED TO: KB Home Raleigh

PROPERTY LOCATION: 50 Artemas Ward

SUBDIVISION Birchwood Grove

LOT # 102

NEW  REPAIR  EXPANSION

Site Improvements required prior to Construction Authorization Issuance:

Type of Structure: SFD (56'x43')

Proposed Wastewater System Type: Pump to 25% Red Sys

Projected Daily Flow: 480 GPD

Number of bedrooms: 4 Number of Occupants: 8 max

Basement  Yes  No

Pump Required:  Yes  No  May be required based on final location and elevations of facilities

Type of Water Supply:  Community  Public  Well Distance from well \_\_\_\_\_ feet

Permit valid for:  Five years  
 No expiration

Permit conditions:

Authorized State Agent: \_\_\_\_\_

RGAS

Date: 4/6/22

SEE ATTACHED SITE SKETCH

The issuance of this permit by the Health Department in no way guarantees the issuance of other permits. The permit holder is responsible for checking with appropriate governing bodies in meeting their requirements. This site is subject to revocation if the site plan, plat, or the intended use changes. The Improvement Permit shall not be affected by a change in ownership of the site. This permit is subject to compliance with the provisions of the Laws and Rules for Sewage Treatment and Disposal and to conditions of this permit.

## Construction Authorization

(Required for Building Permit)

The construction and installation requirements of Rules .1950, .1952, .1954, .1955, .1956, .1957, .1958, and .1959 are incorporated by references into this permit and shall be met. Systems shall be installed in accordance with the attached system layout.

ISSUED TO: KB Homes Raleigh

PROPERTY LOCATION: 50 Artemas Ward

SUBDIVISION Birchwood Grove

LOT # 102

Facility Type: SFD (56'x43')  New  Expansion  Repair

Basement?  Yes  No Basement Fixtures?  Yes  No

Type of Wastewater System\*\* Pump to 25% Reduction System (Initial Wastewater Flow: ~~480~~ 600 GPD)

(See note below, if applicable )

Pump to 25% Reduction System (Repair)

### Installation Requirements/Conditions

Septic Tank Size ~~1000~~ 1250 gallons 5

Pump Tank Size ~~1000~~ 1250 gallons

Number of trenches 4

Exact length of each trench 85 feet

Trenches shall be installed on contour at a Maximum Trench Depth of: 18 inches

(Trench bottoms shall be level to +/-1/4" in all directions)

Trench Spacing: 9 Feet on Center

Soil Cover: 6 inches

(Maximum soil cover shall not exceed 36" above the trench bottom)

Pump Requirements: \_\_\_\_\_ ft. TDH vs. \_\_\_\_\_ GPM \_\_\_\_\_ inches below pipe

Aggregate Depth: \_\_\_\_\_ inches above pipe

Conditions: Flow Reduction Based On Session Plan \_\_\_\_\_ inches total

2014-130 & 2013-413

**WATER LINES (INCLUDING IRRIGATION) MUST BE 10FT. FROM ANY PART OF SEPTIC SYSTEM OR REPAIR AREA.  
NO UTILITIES ALLOWED IN INITIAL OR REPAIR DRAIN FIELD AREA.**

\*\*If applicable: I understand the system type specified is different from the type specified on the application. I accept the specifications of this permit.

Owner/Legal Representative Signature: \_\_\_\_\_ Date: \_\_\_\_\_

This Construction Authorization is subject to revocation if the site plan, plat, or the intended use changes. The Construction Authorization shall not be transferred when there is a change in ownership of the site. This Construction Authorization is subject to compliance with the provisions of the Laws and Rules for Sewage Treatment and Disposal and to the conditions of this permit. SEE ATTACHED SITE SKETCH

Authorized State Agent: \_\_\_\_\_

Date: 4/6/22

Construction Authorization Expiration Date: 4/6/27

REVISED 7/7/22

# Harnett County Department of Public Health Site Sketch

Property Location: 50 Artemas Ward

Issued To: KB Homes

Subdivision Birchwood Grove

Lot # 102

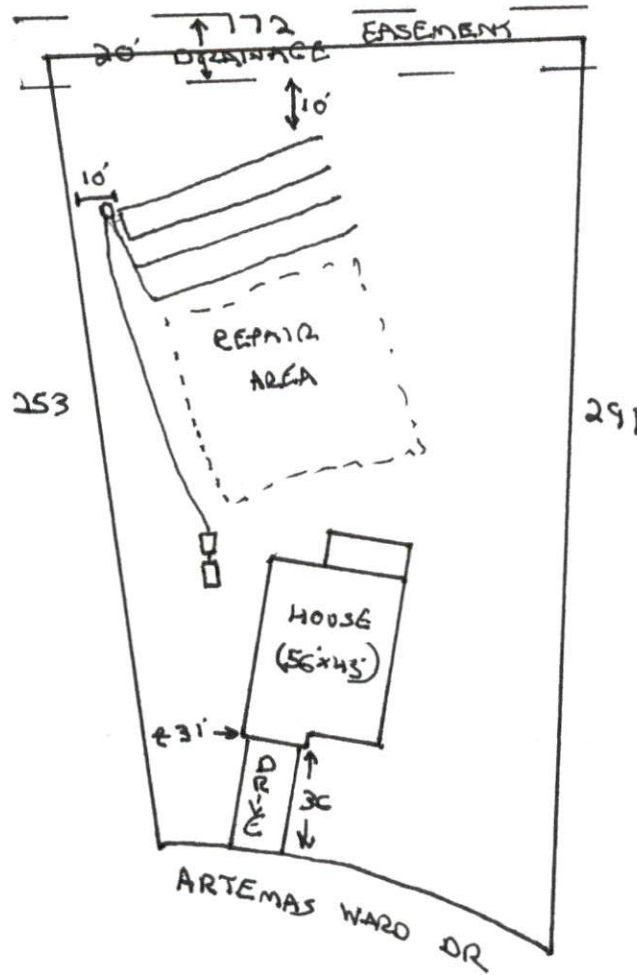

Authorized State Agent: RENS (OLIVER TOLKSDORF)

Date: 4/6/22

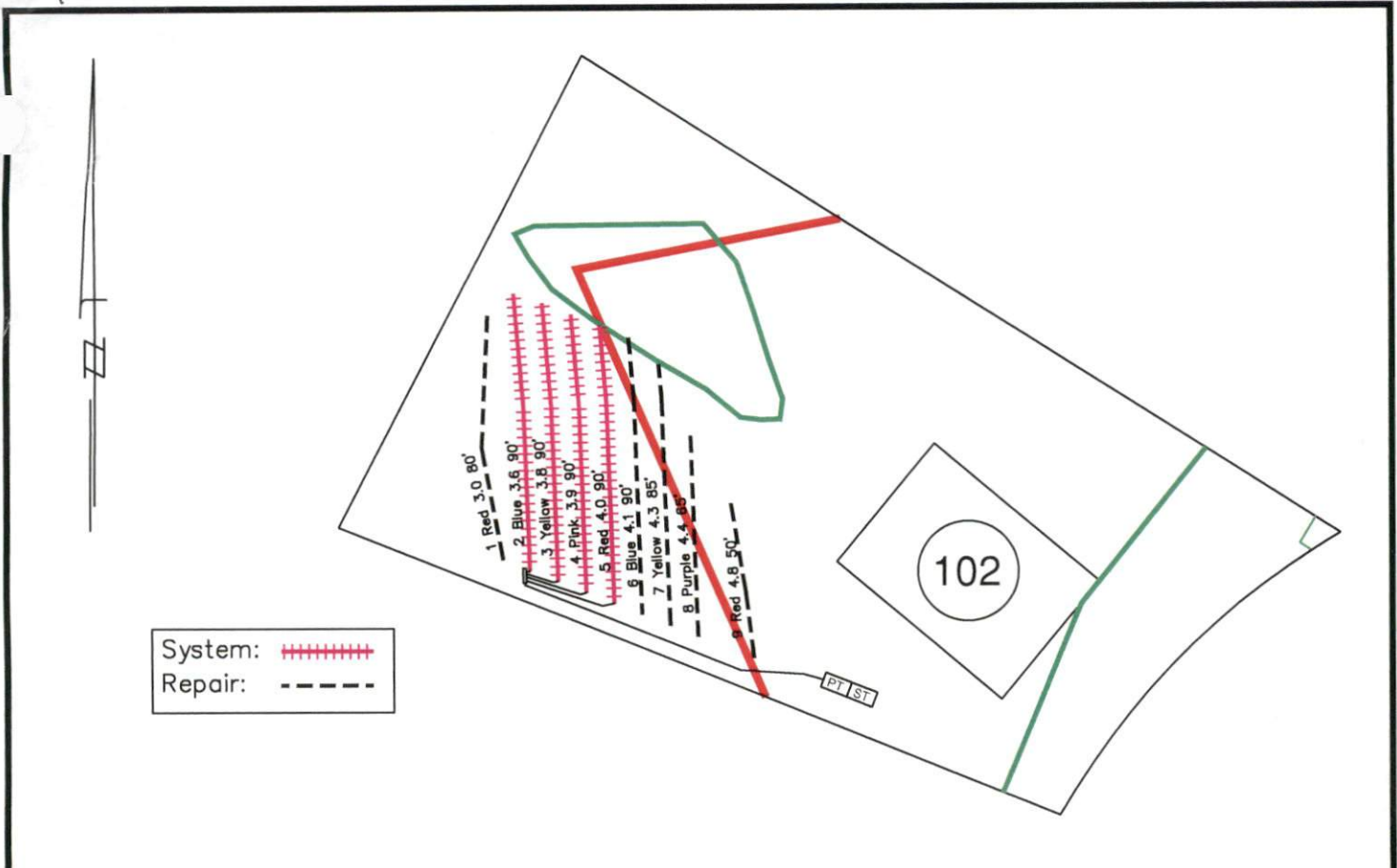

\*CALL WITH ANY  
QUESTIONS PRIOR  
TO INSTALLATION



System:   
 Repair: 

- \*Keep tanks and drain lines 10' from property lines.
- \*Not a survey.
- \*Not a guarantee of a septic permit.
- \*Keep supply lines >5' from property lines.
- \*Some lines are flagged longer in the field than lengths indicate.
- \*No grading septic area.

System: Pump to Mani-T Lines: 2-5, (360') Accepted Status System 0.35 Soil LTAR 24" Trench Bottom
Repair: Pressure Manifold Lines: 1,6-9, (370') Accepted Status System 0.35 Soil LTAR

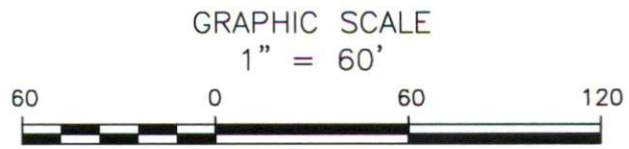

Central Carolina Soil Consulting, PLLC  
 1900 South Main Street, Suite 110  
 Wake Forest, North Carolina 27587  
 Phone (919)569-6704 Fax (919)569-6703

3-Bedroom Septic Layout  
 Lot 102, Birchwood Subdivision  
 Harnett County, North Carolina

Job# : 3753
Drawn By : LW
Date : 09/22/2021
Revision: