

# Harnett County Department of Public Health

## Improvement Permit

A building permit cannot be issued with only an Improvement Permit

ISSUED TO: KB Home Raleigh PROPERTY LOCATION: 259 Jon Stark Dr  
 SUBDIVISION Birchwood Grove LOT # 111  
 NEW  REPAIR  EXPANSION   
 Type of Structure: SFD (50'x51') Site Improvements required prior to Construction Authorization Issuance:  
 Proposed Wastewater System Type: Pump to 25% Red Sys  
 Projected Daily Flow: 360 GPD  
 Number of bedrooms: 3 Number of Occupants: 6 max  
 Basement  Yes  No  
 Pump Required:  Yes  No  May be required based on final location and elevations of facilities  
 Type of Water Supply:  Community  Public  Well Distance from well \_\_\_\_\_ feet Permit valid for:  Five years  
 Permit conditions:  No expiration

Authorized State Agent: *[Signature]* Date: 4/6/22 SEE ATTACHED SITE SKETCH  
 The issuance of this permit by the Health Department in no way guarantees the issuance of other permits. The permit holder is responsible for checking with appropriate governing bodies in meeting their requirements. This site is subject to revocation if the site plan, plat, or the intended use changes. The Improvement Permit shall not be affected by a change in ownership of the site. This permit is subject to compliance with the provisions of the Laws and Rules for Sewage Treatment and Disposal and to conditions of this permit.

## Construction Authorization

(Required for Building Permit)

The construction and installation requirements of Rules .1950, .1952, .1954, .1955, .1956, .1957, .1958, and .1959 are incorporated by references into this permit and shall be met. Systems shall be installed in accordance with the attached system layout.

ISSUED TO: KB Homes Raleigh PROPERTY LOCATION: 259 John Stark Dr  
 SUBDIVISION Birchwood Grove LOT # 111  
 Facility Type: SFD (50'x51')  New  Expansion  Repair  
 Basement?  Yes  No Basement Fixtures?  Yes  No  
 Type of Wastewater System\*\* Pump to 25% Reduction System (Initial) Wastewater Flow: ~~360~~ 480 GPD  
 (See note below, if applicable )

Pump to 25% Red Sys T+J Panel (Repair)

**Installation Requirements/Conditions**

Septic Tank Size <u>1000</u> gallons	Number of trenches <u>1</u>	Exact length of each trench <u>225.291</u> feet	Trench Spacing: <u>9</u> Feet on Center
Pump Tank Size <u>1000</u> gallons	Trenches shall be installed on contour at a	Maximum Trench Depth of: <u>18</u> inches	Soil Cover: <u>6</u> inches
	(Trench bottoms shall be level to +/-1/4" in all directions)	(Maximum soil cover shall not exceed 36" above the trench bottom)	

Pump Requirements: \_\_\_\_\_ ft. TDH vs. \_\_\_\_\_ GPM Aggregate Depth: \_\_\_\_\_ inches below pipe  
 \_\_\_\_\_ inches above pipe  
 \_\_\_\_\_ inches total

Conditions: FLOW REDUCTION BASED ON SL 2014-120 & 2013-413

**WATER LINES (INCLUDING IRRIGATION) MUST BE 10FT. FROM ANY PART OF SEPTIC SYSTEM OR REPAIR AREA.  
 NO UTILITIES ALLOWED IN INITIAL OR REPAIR DRAIN FIELD AREA.**

*\*\*If applicable: I understand the system type specified is different from the type specified on the application. I accept the specifications of this permit.*

Owner/Legal Representative Signature: \_\_\_\_\_ Date: \_\_\_\_\_  
 This Construction Authorization is subject to revocation if the site plan, plat, or the intended use changes. The Construction Authorization shall not be transferred when there is a change in ownership of the site. This Construction Authorization is subject to compliance with the provisions of the Laws and Rules for Sewage Treatment and Disposal and to the conditions of this permit. SEE ATTACHED SITE SKETCH  
 Authorized State Agent: *[Signature]* Date: 4/6/22  
 Construction Authorization Expiration Date: 4/6/27

*REVIS REVIS 7/21/22*

Application # SFD2203-0034

## Harnett County Department of Public Health Site Sketch

Property Location: 259 John Stark Dr

Issued To: KB Homes

Subdivision Birchwood Grove

Lot # 111

Authorized State Agent: 

OLIVER TOLKSDORF

Date: 7/26/22

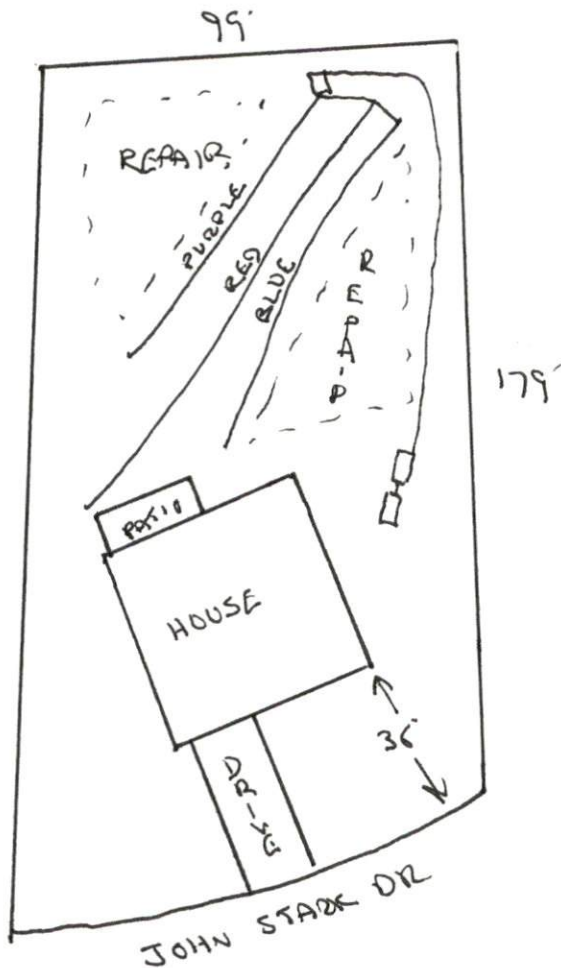

This drawing is for illustrative purposes only. System installation must meet all pertinent laws, rules, and regulations.