

# Harnett County Department of Public Health

## Improvement Permit

A building permit cannot be issued with only an Improvement Permit

ISSUED TO: KB Home Raleigh PROPERTY LOCATION: 259 Jon Stark Dr  
 SUBDIVISION Birchwood Grove LOT # 111

NEW  REPAIR  EXPANSION  Site Improvements required prior to Construction Authorization Issuance:

Type of Structure: SFD (50'x51')

Proposed Wastewater System Type: Pump to 25% Red Sys

Projected Daily Flow: 360 GPD

Number of bedrooms: 3 Number of Occupants: 6 max

Basement  Yes  No

Pump Required:  Yes  No  May be required based on final location and elevations of facilities

Type of Water Supply:  Community  Public  Well Distance from well \_\_\_\_\_ feet

Permit valid for:  Five years  No expiration

Permit conditions: \_\_\_\_\_

Authorized State Agent:  Date: 4/6/22 SEE ATTACHED SITE SKETCH

The issuance of this permit by the Health Department in no way guarantees the issuance of other permits. The permit holder is responsible for checking with appropriate governing bodies in meeting their requirements. This site is subject to revocation if the site plan, plat, or the intended use changes. The Improvement Permit shall not be affected by a change in ownership of the site. This permit is subject to compliance with the provisions of the Laws and Rules for Sewage Treatment and Disposal and to conditions of this permit.

## Construction Authorization

(Required for Building Permit)

The construction and installation requirements of Rules .1950, .1952, .1954, .1955, .1956, .1957, .1958, and .1959 are incorporated by references into this permit and shall be met. Systems shall be installed in accordance with the attached system layout.

ISSUED TO: KB Homes Raleigh PROPERTY LOCATION: 259 John Stark Dr  
 SUBDIVISION Birchwood Grove LOT # 111

Facility Type: SFD (50'x51')  New  Expansion  Repair

Basement?  Yes  No Basement Fixtures?  Yes  No

Type of Wastewater System\*\* Pump to 25% Reduction System (Initial) Wastewater Flow: 360 GPD

(See note below, if applicable ) Pump to 25% Red Sys (Repair)

<u>Installation Requirements/Conditions</u>		Number of trenches <u>1</u>
Septic Tank Size <u>1000</u> gallons	Exact length of each trench <u>225</u> feet	Trench Spacing: <u>9</u> Feet on Center
Pump Tank Size <u>1000</u> gallons	Trenches shall be installed on contour at a Maximum Trench Depth of: <u>18</u> inches (Trench bottoms shall be level to +/-1/4" in all directions)	Soil Cover: <u>6</u> inches (Maximum soil cover shall not exceed 36" above the trench bottom)
Pump Requirements: _____ ft. TDH vs. _____ GPM		Aggregate Depth: _____ inches below pipe _____ inches above pipe _____ inches total
Conditions: _____		

**WATER LINES (INCLUDING IRRIGATION) MUST BE 10FT. FROM ANY PART OF SEPTIC SYSTEM OR REPAIR AREA.**  
**NO UTILITIES ALLOWED IN INITIAL OR REPAIR DRAIN FIELD AREA.**

*\*\*If applicable: I understand the system type specified is different from the type specified on the application. I accept the specifications of this permit.*

Owner/Legal Representative Signature: \_\_\_\_\_ Date: \_\_\_\_\_

This Construction Authorization is subject to revocation if the site plan, plat, or the intended use changes. The Construction Authorization shall not be transferred when there is a change in ownership of the site. This Construction Authorization is subject to compliance with the provisions of the Laws and Rules for Sewage Treatment and Disposal and to the conditions of this permit. SEE ATTACHED SITE SKETCH

Authorized State Agent:  Date: 4/6/22  
 Construction Authorization Expiration Date: 4/6/27

Application # SFD2203-0034

## Harnett County Department of Public Health Site Sketch

Property Location: 259 John Stark Dr

Issued To: KB Homes Subdivision Birchwood Grove Lot # 111

Authorized State Agent: ~~REMS (OLIVER TOLKSDORF)~~ Date: 4/6/22

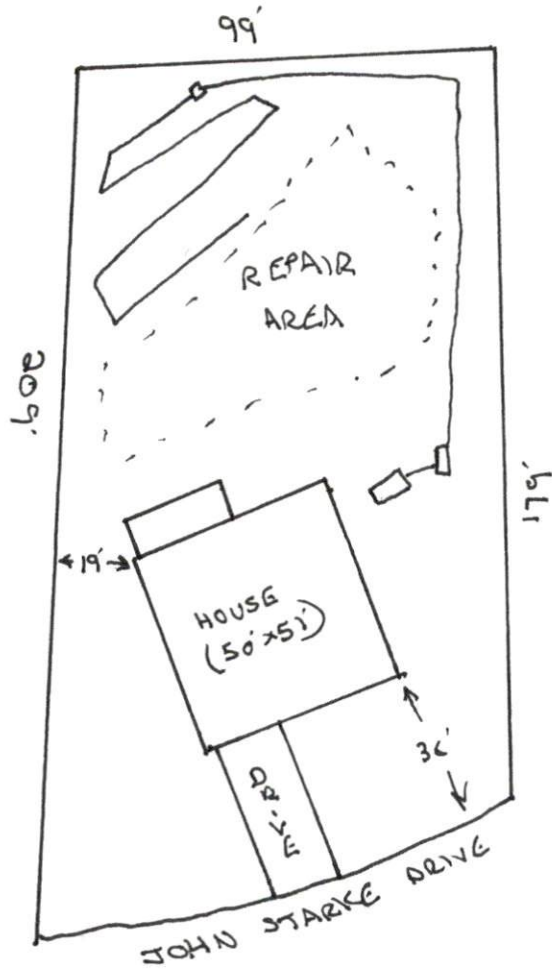

This drawing is for illustrative purposes only. System installation must meet all pertinent laws, rules, and regulations.

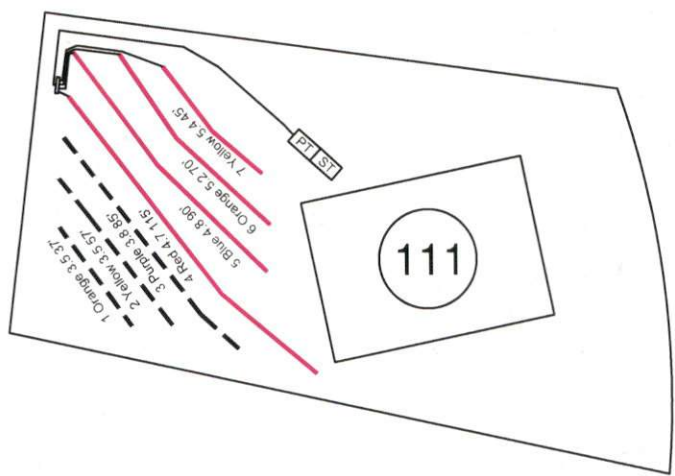

System: ———  
 Repair: - - - -

- \*Keep tanks and drain lines 10' from property lines.
- \*Not a survey.
- \*Not a guarantee of a septic permit.
- \*Keep supply lines >5' from property lines.
- \*Some lines are flagged longer in the field than lengths indicate.
- \*No grading septic area.

System: Pressure Manifold Lines: 4-7, (320') EZ Flow 0.45 Soil LTAR 24" Trench Bottom
Repair: Pressure Manifold Lines: 1-3, (179') T&J Panel 0.45 Soil LTAR 24" Trench Bottom

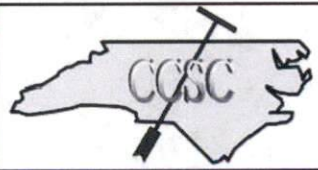
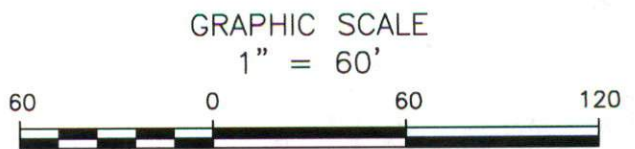

Central Carolina Soil Consulting, PLLC  
 1900 South Main Street, Suite 110  
 Wake Forest, North Carolina 27587  
 Phone (919)569-6704 Fax (919)569-6703

3-Bedroom Septic Layout  
 Lot 111, Birchwood Subdivision  
 Wake County, North Carolina

Job# : 3753
Drawn By : LW
Date : 08/17/2021
Revision: