

Harnett County Department of Public Health Improvement Permit

A building permit cannot be issued with only an Improvement Permit

ISSUED TO: KB Home Raliegh Durham PROPERTY LOCATION: John Stark Drive
 SUBDIVISION Birchwood Grove LOT # 1102
 NEW REPAIR EXPANSION Site Improvements required prior to Construction Authorization Issuance:
 Type of Structure: SFD (38'x41.5')
 Proposed Wastewater System Type: 25% Reduction (Pump)
 Projected Daily Flow: 480 GPD
 Number of bedrooms: 4 Number of Occupants: 8 max
 Basement Yes No
 Pump Required: Yes No May be required based on final location and elevations of facilities
 Type of Water Supply: Community Public Well Distance from well _____ feet Permit valid for: Five years
 No expiration
 Permit conditions: _____

Authorized State Agent: *RGNS* Date: 2/23/22 SEE ATTACHED SITE SKETCH
 The issuance of this permit by the Health Department in no way guarantees the issuance of other permits. The permit holder is responsible for checking with appropriate governing bodies in meeting their requirements. This site is subject to revocation if the site plan, plat, or the intended use changes. The Improvement Permit shall not be affected by a change in ownership of the site. This permit is subject to compliance with the provisions of the Laws and Rules for Sewage Treatment and Disposal and to conditions of this permit.

Construction Authorization

(Required for Building Permit)

The construction and installation requirements of Rules .1950, .1952, .1954, .1955, .1956, .1957, .1958, and .1959 are incorporated by references into this permit and shall be met. Systems shall be installed in accordance with the attached system layout.

ISSUED TO: KB Home Raliegh Durham PROPERTY LOCATION: John Stark Drive
 SUBDIVISION Birchwood Grove LOT # 112
 Facility Type: SFD (38'x41.5') New Expansion Repair
 Basement? Yes No Basement Fixtures? Yes No
 Type of Wastewater System** ~~25% Reduction (Pump)~~ PUMP T+S PANEL (Initial) Wastewater Flow: 480 GPD
 (See note below, if applicable) ~~25% Reduction (Pump)~~ PUMP T+S PANEL (Repair)
 Installation Requirements/Conditions
 Septic Tank Size 1000 gallons Exact length of each trench ~~100~~ 857 feet Trench Spacing: 9 Feet on Center
 Pump Tank Size 1000 gallons Trenches shall be installed on contour at a Soil Cover: 6 inches
 Maximum Trench Depth of: 18 inches (Maximum soil cover shall not exceed 36" above the trench bottom)
 (Trench bottoms shall be level to +/-1/4" in all directions)
 Pump Requirements: _____ ft. TDH vs. _____ GPM _____ inches below pipe
 Aggregate Depth: _____ inches above pipe
 Conditions: FLOW REDUCTION BASED ON SL 2014-120 & 2013-413 _____ inches total

**WATER LINES (INCLUDING IRRIGATION) MUST BE 10FT. FROM ANY PART OF SEPTIC SYSTEM OR REPAIR AREA.
 NO UTILITIES ALLOWED IN INITIAL OR REPAIR DRAIN FIELD AREA.**

***If applicable: I understand the system type specified is different from the type specified on the application. I accept the specifications of this permit.*

Owner/Legal Representative Signature: _____ Date: _____
 This Construction Authorization is subject to revocation if the site plan, plat, or the intended use changes. The Construction Authorization shall not be transferred when there is a change in ownership of the site. This Construction Authorization is subject to compliance with the provisions of the Laws and Rules for Sewage Treatment and Disposal and to the conditions of this permit. SEE ATTACHED SITE SKETCH
 Authorized State Agent: *RGNS* Date: 3/23/22
 Construction Authorization Expiration Date: 3/23/27

SITE SKETCH FOR LOT 112

RENS 7/29/22

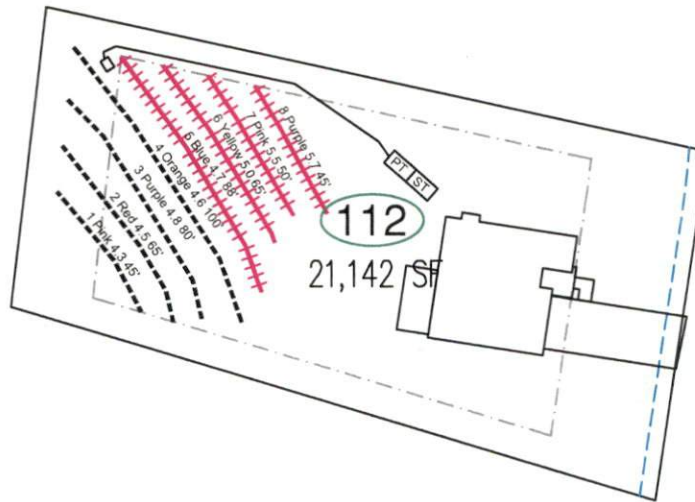

System: ++++++
 Repair: - - - - -

- *Keep tanks and drain lines 10' from property lines.
- *Not a survey.
- *Not a guarantee of a septic permit.
- *Keep supply lines >5' from property lines.
- *Some lines are flagged longer in the field than lengths indicate.
- *No grading septic area.

System: Pressure Manifold
 Lines: 5-8, (257')
 T&J Panel 50% reduction
 0.35 Soil LTAR

Repair: Pressure Manifold
 Lines: 1-4, (290')
 T&J Panel 50% reduction
 0.35 Soil LTAR

GRAPHIC SCALE

1" = 60'



Central Carolina Soil Consulting, PLLC
 1900 South Main Street, Suite 110
 Wake Forest, North Carolina 27587
 Phone (919)569-6704 Fax (919)569-6703

4-Bedroom Septic Layout
 Engineered Flow Reduction
 90gal/BR/Day
 Lot 112, Birchwood Subdivision
 Harnett County, North Carolina

Job# : 3753
Drawn By : LW
Date : 07/02/2021
Revision: 4/26/22