

SOIL/SITE EVALUATION
for ON-SITE WASTEWATER SYSTEM

Owner: *MRH Land Holding*
 Applicant:

Address: *122 Fox Run*
 Proposed Facility: *50x50*

Date Evaluated: *3-8-22*
 Design Flow (.1949): *360 GPD*

Property Size:

Location of Site:

Property Recorded:

- Water Supply: Public Individual Well Spring Other
 Evaluation Method: Auger Boring Pit Cut
 Type of Wastewater: Sewage Industrial Process Mixed

P R O F I L E #	.1940 Landscape Position/ Slope %	Horizon Depth (In.)	SOIL MORPHOLOGY		OTHER PROFILE FACTORS				Profile Class & LTAR
			.1941		.1942 Soil Wetness/ Color	.1943 Soil Depth (IN.)	.1956 Sapro Class	.1944 Restr Horiz	
			.1941 Structure/ Texture	.1941 Consistence Mineralogy					
<i>42 3,4</i>	<i>L</i>	<i>0-24</i>	<i>LS</i>	<i>G-Fr</i>	<i>>48"</i>	<i>>48"</i>	<i>-</i>	<i>-</i>	<i>PS-6</i>
	<i>5-7%</i>	<i>24-48</i>	<i>SC1</i>	<i>SBlk</i>	<i>Fi</i>				<i>Group TII</i>

Description	Initial System	Repair System	Other Factors (.1946): Site Classification (.1948): <i>PS</i> Evaluated By: <i>ML REHS</i> Others Present:
Available Space (.1945)	<i>L</i>	<i>L</i>	
System Type(s)	<i>258 rhd</i>	<i>258 rhd</i>	
Site LTAR	<i>.6</i>	<i>.6</i>	



COMMENTS: _____

LANDSCAPE POSITIONS	GROUP	TEXTURES	.1955 LTAR	CONSISTENCE MOIST	WET
R-RIDGE	I	S-SAND	1.2 - 0.8	VFR-VERY FRIABLE FR-FRIABLE	NS-NON-STICKY SS-SLIGHTLY STICKY
S-SHOULDER SLOPE L-LINEAR SLOPE		LS-LOAMY SAND			
FS-FOOT SLOPE	II	SL-SANDY LOAM	0.8 - 0.6	FI-FIRM VFI-VERY FIRM EFI-EXTREMELY FIRM	S-STICKY VS-VERY STICKY NP-NON-PLASTIC SP-SLIGHTLY STICKY
N-NOSE SLOPE H-HEAD SLOPE		L-LOAM			
CC-CONCLAVE SLOPE	III	SI-SILT	0.6 - 0.3		P-PLASTIC VP-VERY PLASTIC
CV-CONVEX SLOPE		SIL-SILT LOAM			
T-TERRACE		CL-CLAY LOAM			
FP-FLOOD PLAN	IV	SCL-SANDY CLAY LOAM	0.4 - 0.1		
		SIC-SILTY CLAY			
		C-CLAY SC-SANDY CLAY			

STRUCTURE

- SG-SINGLE GRAIN
- M- MASSIVE
- CR-CRUMB
- GR-GRANULAR
- SBK-SUBANGULAR BLOCKY
- ABK-ANGULAR BLOCKY
- PL-PLATY
- PR-PRISMATIC

MINERALOGY

- SLIGHTLY EXPANSIVE
- EXPANSIVE

Show profile locations and other site features (dimensions, references or benchmark, and North)

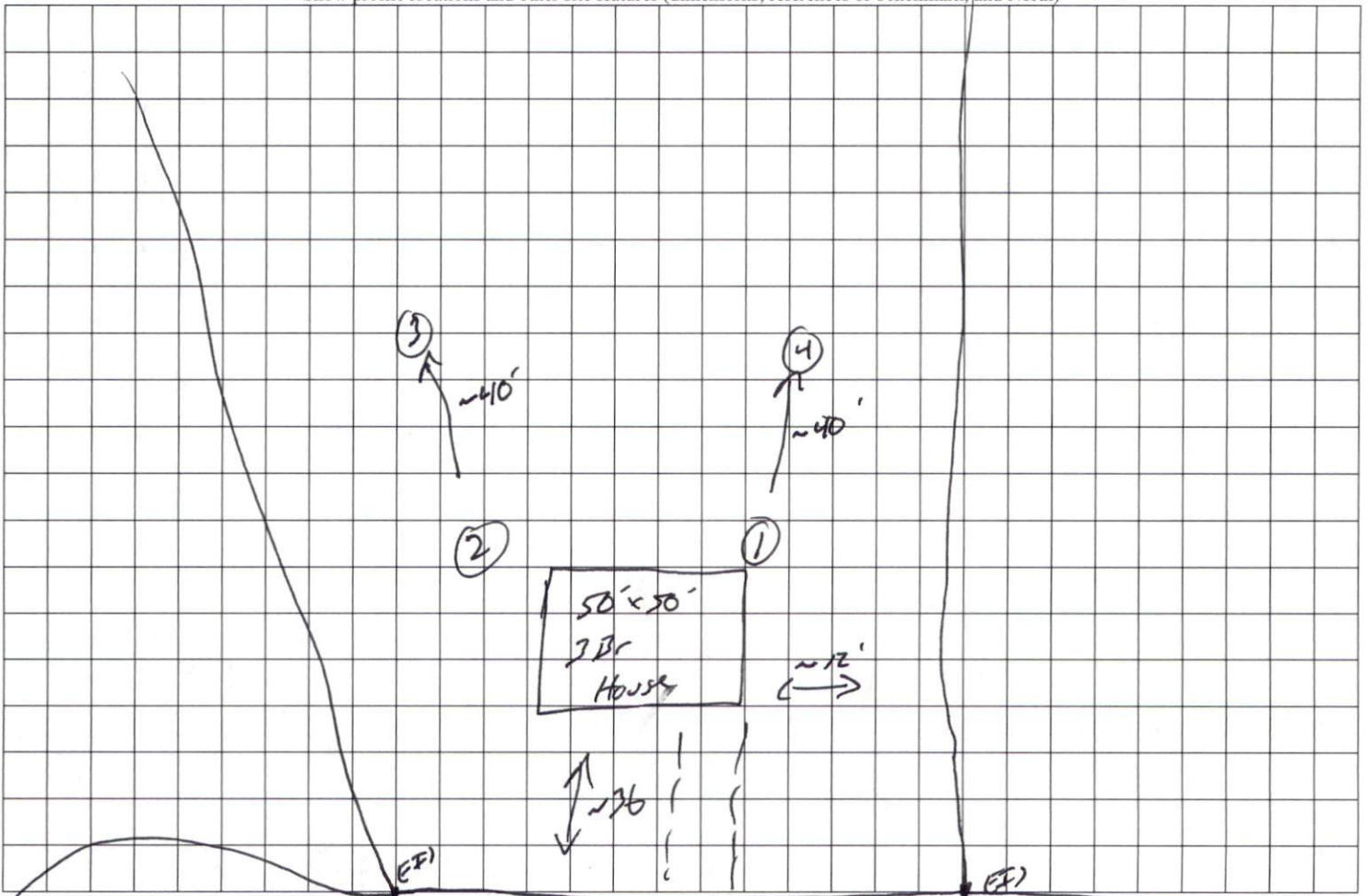

Cul de sac

Fox Run