

# Harnett County Department of Public Health

PERMIT # SFD2202-0057

## Operation Permit

New Installation    Septic Tank    Nitrification Line    Repair    Expansion

PROPERTY LOCATION: 1196 HAYES RD

Name: (owner) WEAVER HOMES SUBDIVISION \_\_\_\_\_ LOT # \_\_\_\_\_

System Installer: YELLOW DOG

Basement with plumbing:  Garage  Number of Bedrooms 3

Type of Water Supply:  Community    Public    Well   Distance from well \_\_\_\_\_ feet

System Type: III Types V and VI Systems expire in 5 years.

(In accordance with Table V a)

Owner must contact Health Department 6 months prior to expiration for permit renewal.

This system has been installed in compliance with applicable North Carolina General Statutes, Rules for Sewage Treatment and Disposal, and all conditions of the Improvement Permit and Construction Authorization.

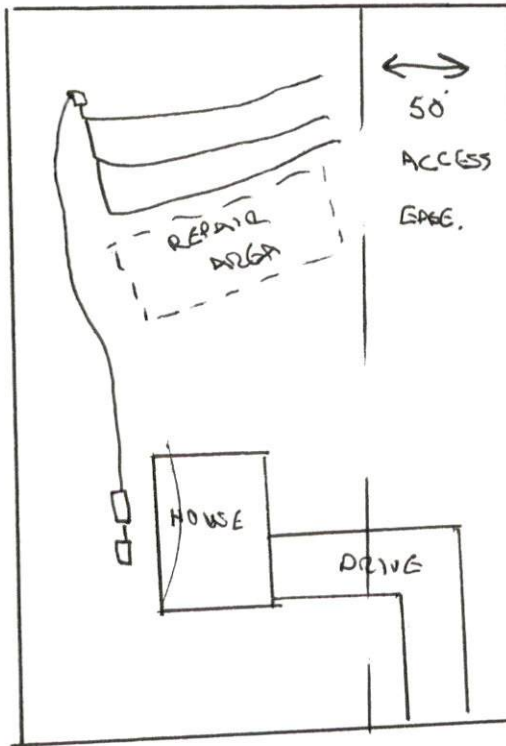

**PERMIT CONDITIONS:**

- I. Performance: System shall perform in accordance with Rule .1961.
- II. Monitoring: As required by Rule .1961.
- III. Maintenance: As required by Rule .1961. Other: \_\_\_\_\_  
 Subsurface system operator required? Yes  No   
 If yes, see attached sheet for additional operation conditions, maintenance and reporting.

IV. Operation: \_\_\_\_\_  
 \_\_\_\_\_  
 V. Other: \_\_\_\_\_

\_\_\_\_\_ D-Box    \_\_\_\_\_ Pump    \_\_\_\_\_ Alarm    \_\_\_\_\_ H2O Line    \_\_\_\_\_ PWR Line

Following are the specifications for the sewage disposal system on the above captioned property.

Type of system:  Conventional    Other Pump To Chamber (PT)   Septic Tank: 1000 gallons   Pump Tank: 1000 gallons  
 Subsurface   No. of   exact length   width of   depth of  
 Drainage Field   ditches 1   of each ditch 225 feet   ditches 3 feet   ditches 18 inches  
 French Drain Required: \_\_\_\_\_ Linear feet

Authorized State Agent Mohd A. REHS Date 8-24-22