

SL2018-114
Submission Package

Marks Road
Lot 4
Cameron, NC
Harnett County

Prepared For: Carlos Llamas, Owner
Prepared By: Sloan Griffin, SanLee Environmental, LLC
Report Date: January 2, 2022

“The LSS Evaluation attached to this application is to be used to produce design and construction features for permitting in accordance with SL 2018-114 11.(c).”

Sloan Griffin, Legal Representative

“This LSS Evaluation is being submitted pursuant to and meets the requirements of SL 2018-114 section 11.(c).”

Sloan Griffin, LSS #1333

SanLee Environmental, LLC

Project: Marks Road Subdivision - Lot 4 Date: 1/2/2022

Address: TBD Marks Road, Cameron, NC

County: Harnett PIN# TBD Water Source: Public

of Bedrooms: 4 Design Daily Flow: 480 Waste Strength: Domestic

Initial System

LTAR: 0.6 Trench Width: 3 Trench Depth: 30"

Min. ft of Drainfield: 267 Adjusted ft of Drainfield: 200

Septic Tank Size: 1000 Gallons Pump Tank Size: NA Gallons

Distribution Method: Serial Specified Product: Infiltrator Quick4 Plus Standard

Pretreatment Required? No Amount of Soil Cover Required NA

Notes

- 1) Stub plumbing out shallow, else a pump system may be required
- 2) Maintain all applicable setbacks to septic system components
- 3) Property Lines/corners shall be clearly marked prior to system installation
- 4) Owner is responsible for maintaining flagging identifyinh approved soil area and component location
- 5) Unapproved grading, filling, or compaction of approved soil may result in permit revocation
- 6) Keep construction materials and equipment off of approved soils area during all phases of construction

Repair System

LTAR: 0.6 Trench Width: 3 Trench Depth: 30"

Min. ft of Drainfield: 267 Adjusted ft of Drainfield: 200

Septic Tank Size: 1000 Gallons Pump Tank Size: 1000 Gallons

Distribution Method: Serial Specified Product: Infiltrator Quick4 Plus Standard

Pretreatment Required? No Amount of Soil Cover Required NA

Notes

- 1) A pump system may not be necessary if gravity fall can be maintained

SanLee Environmental, LLC

Project: Marks Road Subdivision - Lot 4 Date: 1/2/2022

Address: TBD Marks Road, Cameron, NC

County: Harnett PIN# TBD Water Source: Public

Layout

| Line # | Flag Color | Elevation | Line Length | Primary System | Repair System |
|-------------|------------|-----------|-------------|----------------|---------------|
| Septic Tank | | | | | |
| Line 1 | Blue | | 87 | 54 | |
| Line 2 | White | | 111 | 82 | |
| Line 3 | Green | | 71 | 66 | |
| Line 4 | Yellow | | 73 | | 70 |
| Line 5 | Pink | | 75 | | 70 |
| Line 6 | Purple | | 68 | | 62 |
| | | | 485 | 202 | 202 |

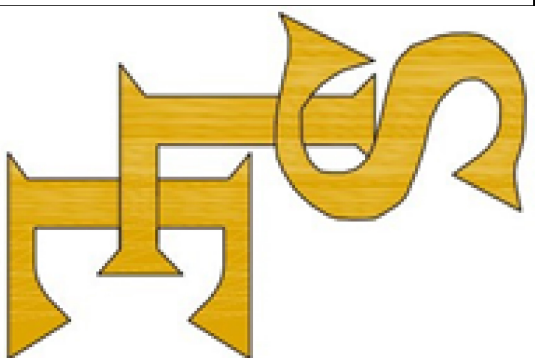

SanLee
Environmental, LLC
919-842-6263

Project:
Marks Road
Subdivision
Lot 4

Date:
December 21, 2021

Drawn By:
Sloan Griffin

1" = 40'

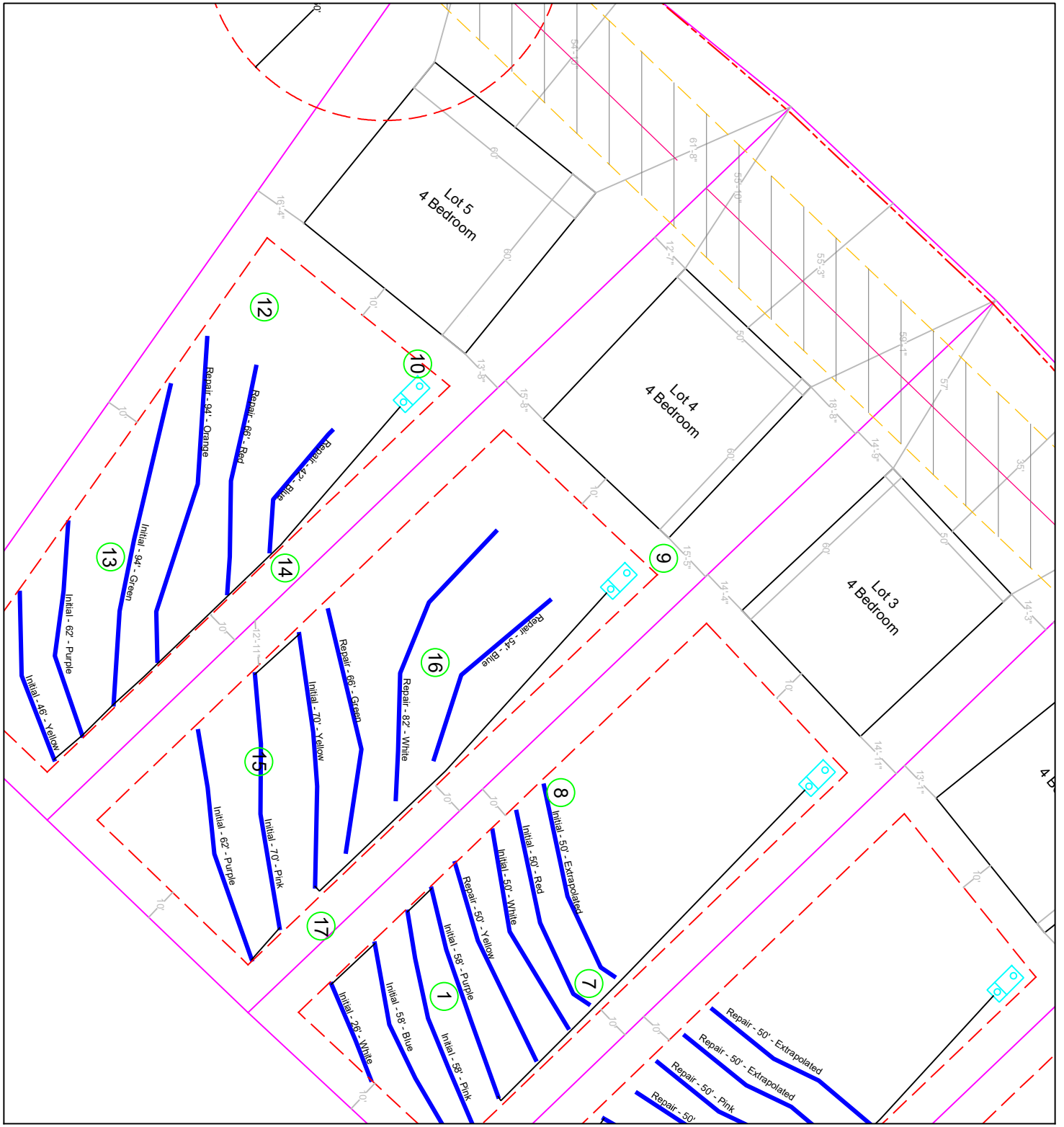

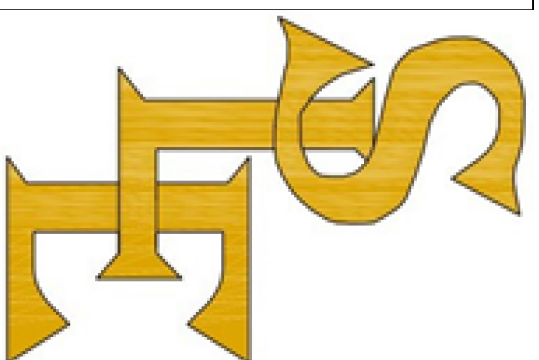

SanLee
Environmental, LLC
919-842-6263

Project:
Marks Road
Subdivision
Lot 4

Date:
December 21, 2021

Drawn By:
Sloan Griffin

1" = 20'

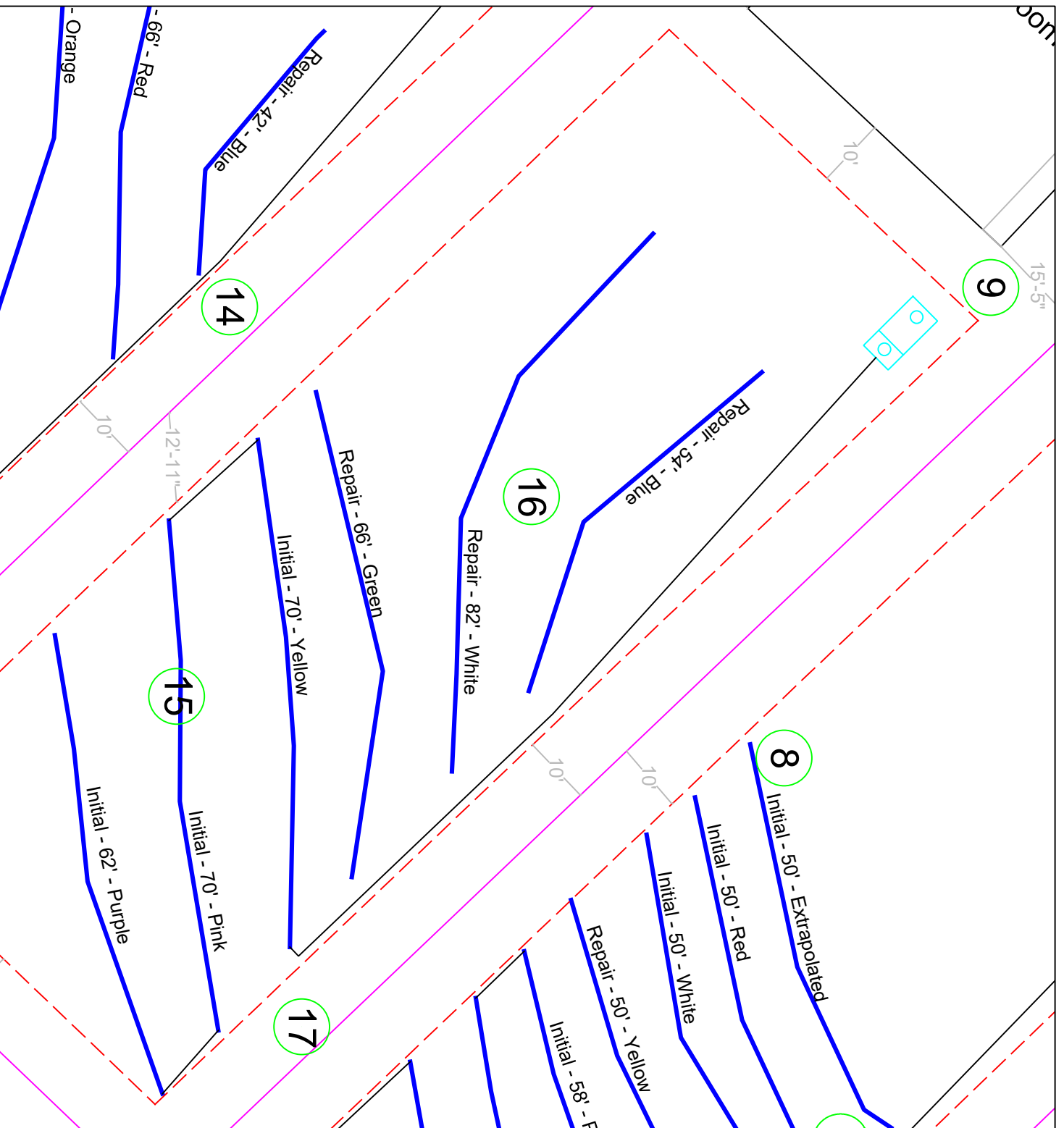

Soil Notes

| Name | Horizon 1 | Horizon 2 | Horizon 3 | Horizon 4 |
|--------|------------------------|--------------------------|-----------------------------|-----------|
| WPT 19 | 0-14 l gr fr nsnp sexp | 14-37 sl gr fr nsnp sexp | 37-48 scl wsbk fr sssp sexp | |
| WPT 18 | 0-8 l gr fr nsnp sexp | 8-48 sl gr fr nsnp sexp | | |
| WPT 17 | 0-7 sl gr fr nsnp sexp | 7-48 LS gr fr nsnp sexp | | |
| WPT 16 | 0-14 l gr fr nsnp sexp | 14-48 sl gr fr nsnp sexp | | |
| WPT 15 | 0-11 l gr fr nsnp sexp | 11-48 sl gr fr nsnp sexp | | |
| WPT 14 | 0-10 l gr fr nsnp sexp | 10-48 sl gr fr nsnp sexp | | |
| WPT 13 | 0-13 l gr fr nsnp sexp | 13-48 sl gr fr nsnp sexp | | |
| WPT 12 | 0-9 l gr fr nsnp sexp | 9-48 LS gr vfr nsnp sexp | | |
| WPT 10 | 0-6 l gr fr nsnp sexp | 6-48 sl gr fr nsnp sexp | | |
| WPT 9 | 0-11 l gr fr nsnp sexp | 11-35 LS gr fr nsnp sexp | 35-48 sl gr fr nsnp sexp | |
| WPT 8 | 0-12 l gr fr nsnp sexp | 12-48 sl gr fr nsnp sexp | | |
| WPT 7 | 0-13 l gr fr nsnp sexp | 13-48 sl gr fr nsnp sexp | | |
| WPT 6 | 0-8 l gr fr nsnp sexp | 8-44 sl gr fr nsnp sexp | 44-48 scl wsbk fr sssp sexp | |
| WPT 5 | 0-9 l gr fr nsnp sexp | 9-48 sl gr fr nsnp sexp | | |
| WPT 4 | 0-8 l gr fr nsnp sexp | 8-48 sl gr fr nsnp sexp | | |
| WPT 3 | 0-9 l gr fr nsnp sexp | 9-41 sl gr fr nsnp sexp | 41-48 scl wsbk fr sssp sexp | |
| WPT 2 | 0-12 l gr fr nsnp sexp | 12-48 sl gr fr nsnp sexp | | |
| WPT 1 | 0-13 l gr fr nsnp sexp | 13-48 sl gr fr nsnp sexp | | |

| Name | LTAR | Restrictive Layer | Slope | Soil Depth |
|--------|------|-------------------|-------|------------|
| WPT 19 | 0.6 | | 3 | 48 |
| WPT 18 | 0.7 | | 3 | 48 |
| WPT 17 | 0.8 | | 3 | 48 |
| WPT 16 | 0.7 | | 3 | 48 |
| WPT 15 | 0.7 | | 3 | 48 |
| WPT 14 | 0.7 | | 3 | 48 |
| WPT 13 | 0.7 | | 3 | 48 |
| WPT 12 | 0.8 | | 3 | 48 |
| WPT 10 | 0.7 | | 2 | 48 |
| WPT 9 | 0.7 | | 2 | 48 |
| WPT 8 | 0.7 | | 2 | 48 |
| WPT 7 | 0.7 | | 3 | 48 |
| WPT 6 | 0.6 | | 3 | 48 |
| WPT 5 | 0.7 | | 3 | 48 |
| WPT 4 | 0.7 | | 3 | 48 |
| WPT 3 | 0.7 | | 2 | 41 |
| WPT 2 | 0.7 | | 3 | 48 |
| WPT 1 | 0.6 | | 4 | 48 |