

SL2018-114
Submission Package

Marks Road
Lot 1
Cameron, NC
Harnett County

Prepared For: Carlos Llamas, Owner
Prepared By: Sloan Griffin, SanLee Environmental, LLC
Report Date: January 2, 2022

“The LSS Evaluation attached to this application is to be used to produce design and construction features for permitting in accordance with SL 2018-114 11.(c).”

Sloan Griffin, Legal Representative

“This LSS Evaluation is being submitted pursuant to and meets the requirements of SL 2018-114 section 11.(c).”

Sloan Griffin, LSS #1333

SanLee Environmental, LLC

Project: Marks Road Subdivision - Lot 1 Date: 1/2/2022

Address: TBD Marks Road, Cameron, NC

County: Harnett PIN# TBD Water Source: Public

of Bedrooms: 4 Design Daily Flow: 480 Waste Strength: Domestic

Initial System

LTAR: 0.6 Trench Width: 3 Trench Depth: 30"

Min. ft of Drainfield: 267 Adjusted ft of Drainfield: 200

Septic Tank Size: 1000 Gallons Pump Tank Size: NA Gallons

Distribution Method: Serial Specified Product: Infiltrator Quick4 Plus Standard

Pretreatment Required? No Amount of Soil Cover Required NA

Notes

- 1) Stub plumbing out shallow, else a pump system may be required
- 2) Maintain all applicable setbacks to septic system components
- 3) Property Lines/corners shall be clearly marked prior to system installation
- 4) Owner is responsible for maintaining flagging identifying approved soil area and component location
- 5) Unapproved grading, filling, or compaction of approved soil may result in permit revocation
- 6) Keep construction materials and equipment off of approved soils area during all phases of construction

Repair System

LTAR: 0.6 Trench Width: 3 Trench Depth: 29"

Min. ft of Drainfield: 267 Adjusted ft of Drainfield: 200

Septic Tank Size: 1000 Gallons Pump Tank Size: 1000 Gallons

Distribution Method: Serial Specified Product: Infiltrator Quick4 Plus Standard

Pretreatment Required? No Amount of Soil Cover Required NA

Notes

- 1) A pump system may not be necessary if gravity fall can be maintained

SanLee Environmental, LLC

Project: Marks Road Subdivision - Lot 1 Date: 12/20/2021

Address: TBD Marks Road, Cameron, NC

County: Harnett PIN# TBD Water Source: Public

Line #	Flag Color	Elevation	Layout		
			Line Length	Primary System	Repair System
Septic Tank					
Line 1	Red		72		66
Line 2	Pink		74		70
Line 3	Purple		69		66
Line 4	Yellow		70	54	
Line 5	White		68	50	
Line 6	Green		56	50	
Line 7	Red		49	46	
			458	200	202

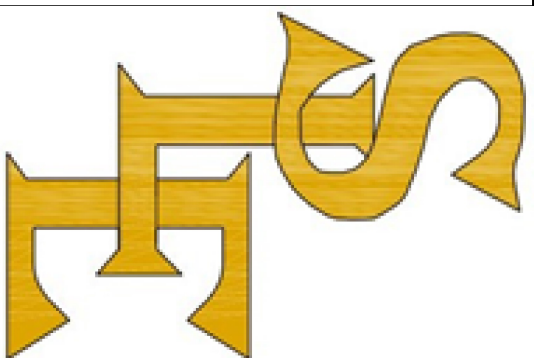

SanLee
Environmental, LLC
919-842-6263

Project:
Marks Road
Subdivision
Lot 1

Date:
December 21, 2021

Drawn By:
Sloan Griffin

1" = 40'

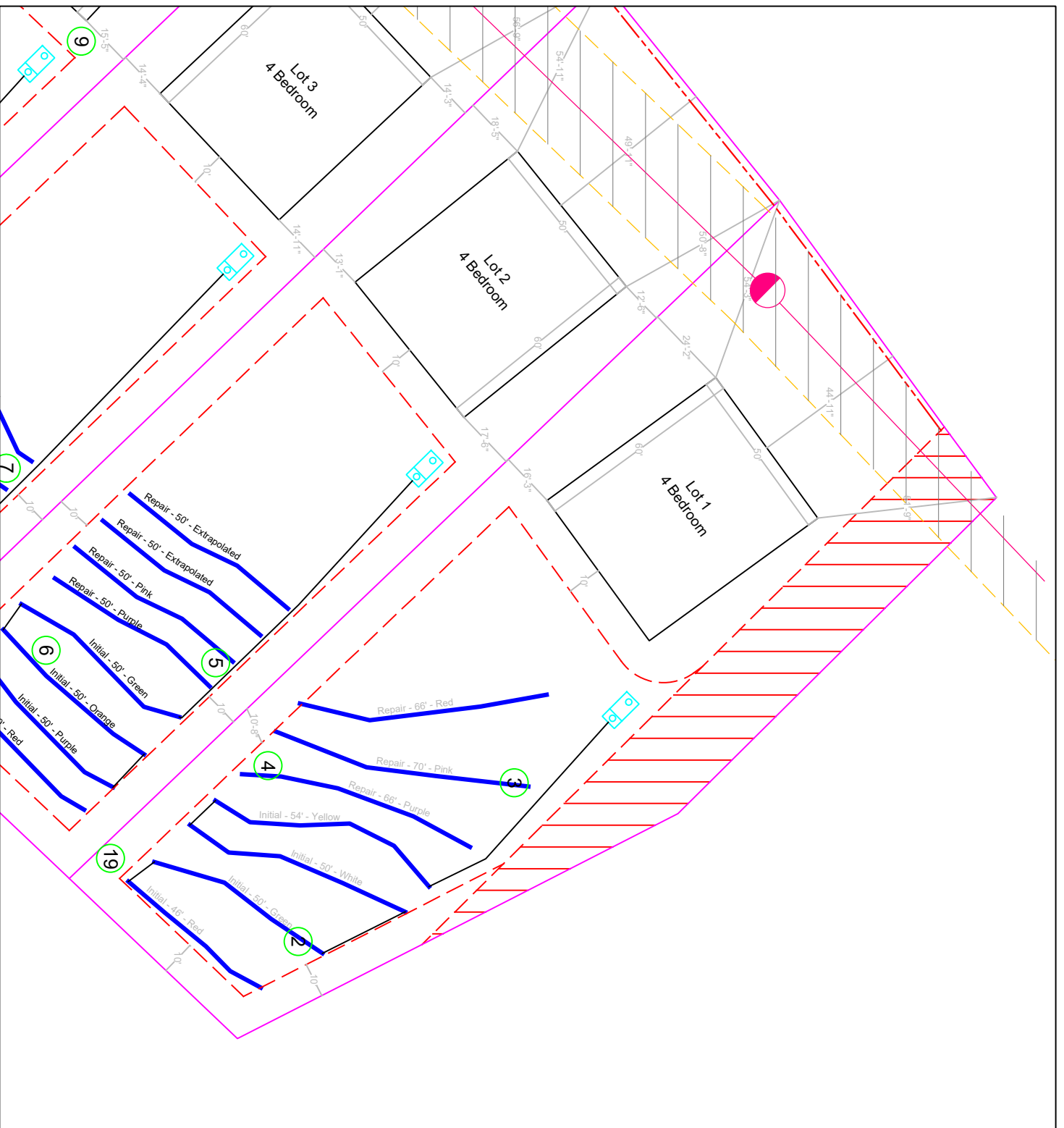

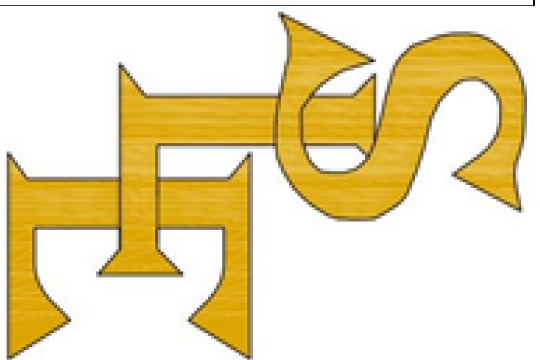

SanLee
Environmental, LLC
919-842-6263

Project:
Marks Road
Subdivision
Lot 1

Date:
December 21, 2021

Drawn By:
Sloan Griffin

1" = 20'

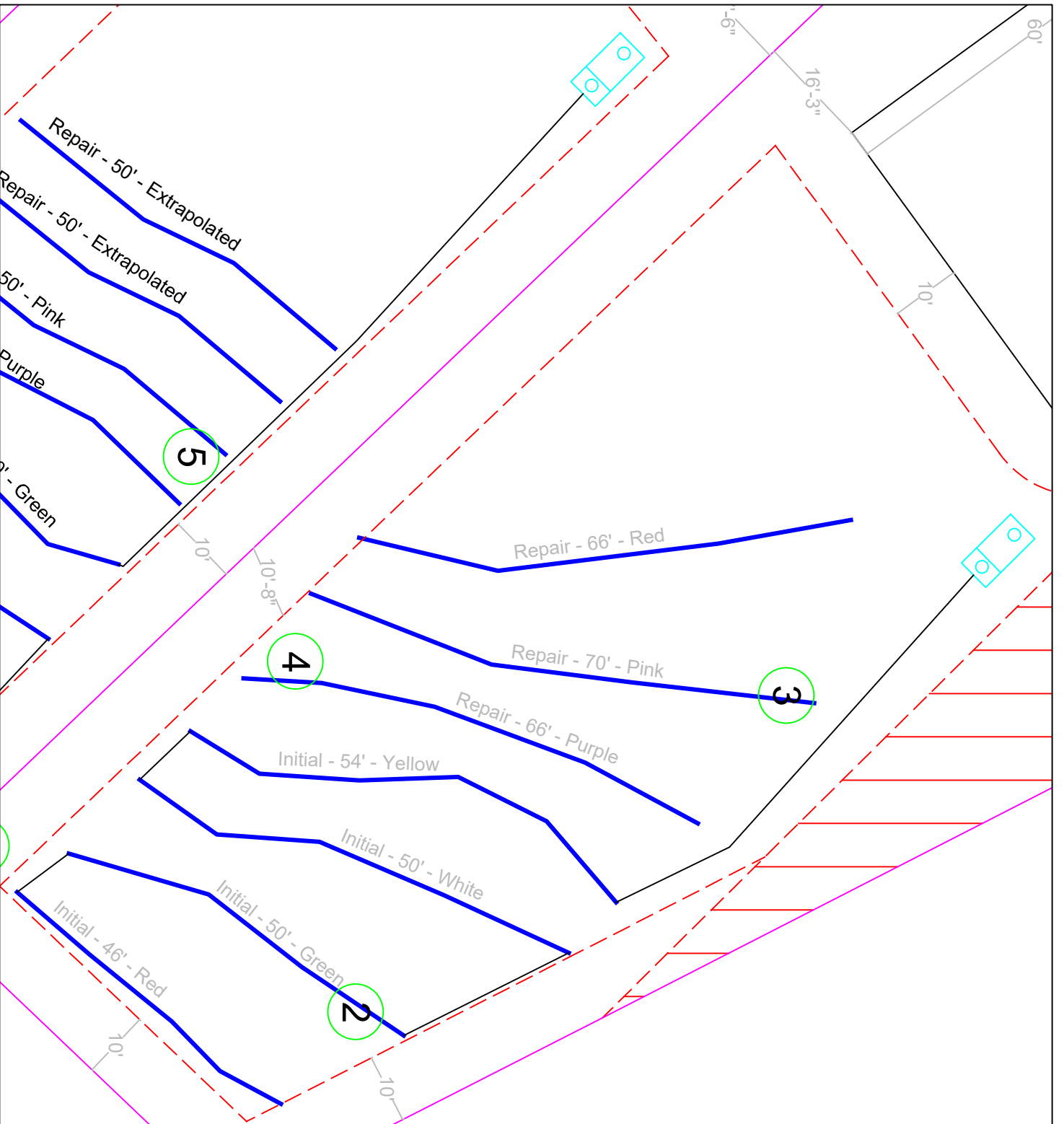

Soil Notes

Name	Horizon 1	Horizon 2	Horizon 3	Horizon 4
WPT 19	0-14 l gr fr nsnp sexp	14-37 sl gr fr nsnp sexp	37-48 scl wsbk fr sssp sexp	
WPT 18	0-8 l gr fr nsnp sexp	8-48 sl gr fr nsnp sexp		
WPT 17	0-7 sl gr fr nsnp sexp	7-48 LS gr fr nsnp sexp		
WPT 16	0-14 l gr fr nsnp sexp	14-48 sl gr fr nsnp sexp		
WPT 15	0-11 l gr fr nsnp sexp	11-48 sl gr fr nsnp sexp		
WPT 14	0-10 l gr fr nsnp sexp	10-48 sl gr fr nsnp sexp		
WPT 13	0-13 l gr fr nsnp sexp	13-48 sl gr fr nsnp sexp		
WPT 12	0-9 l gr fr nsnp sexp	9-48 LS gr vfr nsnp sexp		
WPT 10	0-6 l gr fr nsnp sexp	6-48 sl gr fr nsnp sexp		
WPT 9	0-11 l gr fr nsnp sexp	11-35 LS gr fr nsnp sexp	35-48 sl gr fr nsnp sexp	
WPT 8	0-12 l gr fr nsnp sexp	12-48 sl gr fr nsnp sexp		
WPT 7	0-13 l gr fr nsnp sexp	13-48 sl gr fr nsnp sexp		
WPT 6	0-8 l gr fr nsnp sexp	8-44 sl gr fr nsnp sexp	44-48 scl wsbk fr sssp sexp	
WPT 5	0-9 l gr fr nsnp sexp	9-48 sl gr fr nsnp sexp		
WPT 4	0-8 l gr fr nsnp sexp	8-48 sl gr fr nsnp sexp		
WPT 3	0-9 l gr fr nsnp sexp	9-41 sl gr fr nsnp sexp	41-48 scl wsbk fr sssp sexp	
WPT 2	0-12 l gr fr nsnp sexp	12-48 sl gr fr nsnp sexp		
WPT 1	0-13 l gr fr nsnp sexp	13-48 sl gr fr nsnp sexp		

Name	LTAR	Restrictive Layer	Slope	Soil Depth
WPT 19	0.6		3	48
WPT 18	0.7		3	48
WPT 17	0.8		3	48
WPT 16	0.7		3	48
WPT 15	0.7		3	48
WPT 14	0.7		3	48
WPT 13	0.7		3	48
WPT 12	0.8		3	48
WPT 10	0.7		2	48
WPT 9	0.7		2	48
WPT 8	0.7		2	48
WPT 7	0.7		3	48
WPT 6	0.6		3	48
WPT 5	0.7		3	48
WPT 4	0.7		3	48
WPT 3	0.7		2	41
WPT 2	0.7		3	48
WPT 1	0.6		4	48