

VICINITY MAP
Not To Scale

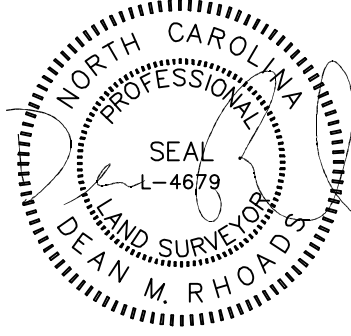

IMPERVIOUS SURFACE AREA	
DESCRIPTION	AREA
HOUSE & PORCH	2,106 S.F.
SCREEN PORCH/HVAC	129 S.F.
DRIVEWAY & WALKS	739 S.F.
TOTAL =	2,974 S.F.
LOT AREA =	17,532 S.F.
% IMPERVIOUS AREA	=17.0%

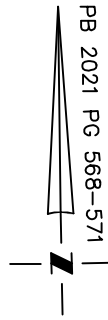

SETBACKS; (PB 2021, 567)

FRONT-35'
REAR -20'
SIDE-10'
CORNER LOT SIDE - 10'

OAK CREEK S/D
PC#C, SLIDE 83D

OPEN SPACE/
15' PERIMETER BUFFER

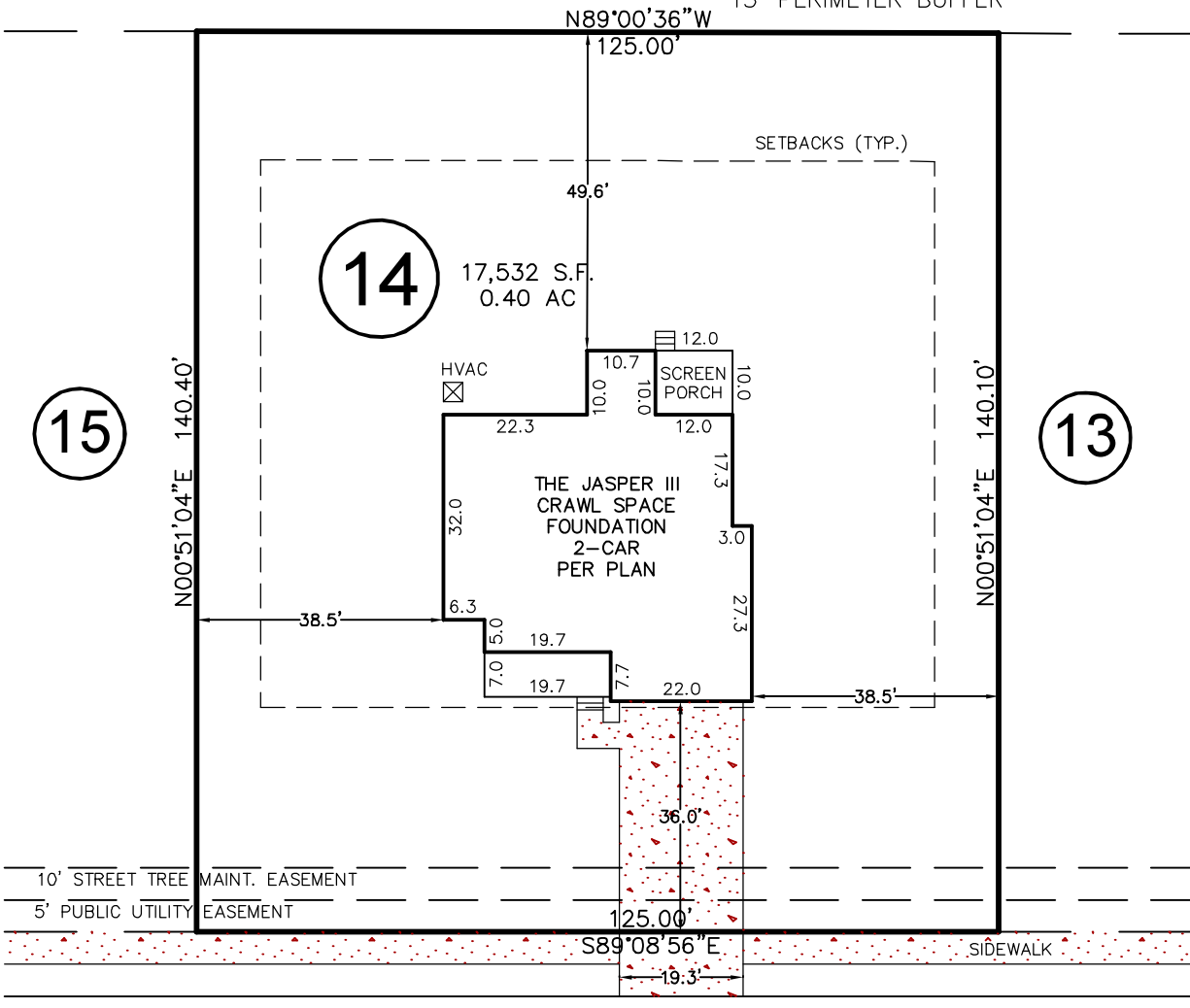

LAMBERT LANE
50' PUBLIC R/W

THIS PROPERTY MAY BE SUBJECT TO ANY AND ALL APPLICABLE DEED RESTRICTIONS, EASEMENTS, RIGHT-OF-WAY, UTILITIES AND RESTRICTIVE COVENANTS WHICH MAY BE OF RECORD OR IMPLIED

THIS DRAWING DOES NOT REFLECT AS-BUILT INFORMATION

PRELIMINARY PLAT
NOT FOR RECORDATION, CONVEYANCES, OR SALES.

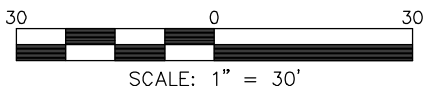

RESIDENTIAL LAND SERVICES, PLLC.

1917 Evans Road
Cary, North Carolina 27513
Phone (919) 378-9316
Firm License # P-0873

HOUSE LOCATION PLOT PLAN

FOR
#318 LAMBERT LANE
LOT 14, PURFOY PLACE SUBDIVISION
Hectors Creek Township, Harnett County, North Carolina

PROPERTY OF: _____ GEMSTONE HOMES _____
MAP BOOK 2021 PAGE 569 DEED REFERENCE _____ PAGE _____

DRAWN BY: JLS

DATE: MARCH 10, 2022