

**SOIL/SITE EVALUATION  
 for ON-SITE WASTEWATER SYSTEM**

Owner: HOWARTH Applicant: GIBALTAN CONT.  
 Address: 9356 OSLEY 421 Date Evaluated: 02/08/2023  
 Proposed Facility: Design Flow (.1949): 306PD Property Size:  
 Location of Site: 302 SFD Property Recorded:  
 Water Supply:  Public  Individual  Well  Spring  Other  
 Evaluation Method:  Auger Boring  Pit  Cut  
 Type of Wastewater:  Sewage  Industrial Process  Mixed

P R O F I L E #	.1940 Landscape Position/ Slope %	Horizon Depth (In.)	SOIL MORPHOLOGY .1941		OTHER PROFILE FACTORS				Profile Class & LTAR
			.1941 Structure/ Texture	.1941 Consistence Mineralogy	.1942 Soil Wetness/ Color	.1943 Soil Depth (IN.)	.1956 Sapro Class	.1944 Restr Horiz	
1213	L 4%	0-12	GL LS	MZ WSM					CS
		12-48	M SL	F1 SP		4E			O-3

Description	Initial System	Repair System	Other Factors (.1946):
Available Space (.1945)	<input checked="" type="checkbox"/>	<input checked="" type="checkbox"/>	Site Classification (.1948): PROVISIONALLY SUITABLE
System Type(s)	250 TES	250 TES	Evaluated By: ANDREW CORRINEH
Site LTAR	0.3	0.3	Others Present:

COMMENTS: \_\_\_\_\_

LANDSCAPE POSITIONS	GROUP	TEXTURES	.1955 LTAR	CONSISTENCE MOIST	WET
R-RIDGE	I	S-SAND LS-LOAMY SAND	1.2 - 0.8	VFR-VERY FRIABLE FR-FRIABLE	NS-NON-STICKY SS-SLIGHTLY STICKY
S-SHOULDER SLOPE	II	SL-SANDY LOAM L-LOAM	0.8 - 0.6	FI-FIRM VFI-VERY FIRM EFI-EXTREMELY FIRM	S-STICKY VS-VERY STICKY NP-NON-PLASTIC SP-SLIGHTLY STICKY
L-LINEAR SLOPE					
FS-FOOT SLOPE	III	SI-SILT SIL-SILT LOAM CL-CLAY LOAM SCL-SANDY CLAY LOAM	0.6 - 0.3		P-PLASTIC VP-VERY PLASTIC
N-NOSE SLOPE					
H-HEAD SLOPE					
CC-CONCLAVE SLOPE	IV	SIC-SILTY CLAY C-CLAY SC-SANDY CLAY	0.4 - 0.1		
CV-CONVEX SLOPE					
T-TERRACE					
FP-FLOOD PLAN					

STRUCTURE  
 SG-SINGLE GRAIN  
 M- MASSIVE  
 CR-CRUMB  
 GR-GRANULAR  
 SBK-SUBANGULAR BLOCKY  
 ABK-ANGULAR BLOCKY  
 PL-PLATY  
 PR-PRISMATIC

MINERALOGY  
 SLIGHTLY EXPANSIVE  
 EXPANSIVE

Show profile locations and other site features (dimensions, references or benchmark, and North)

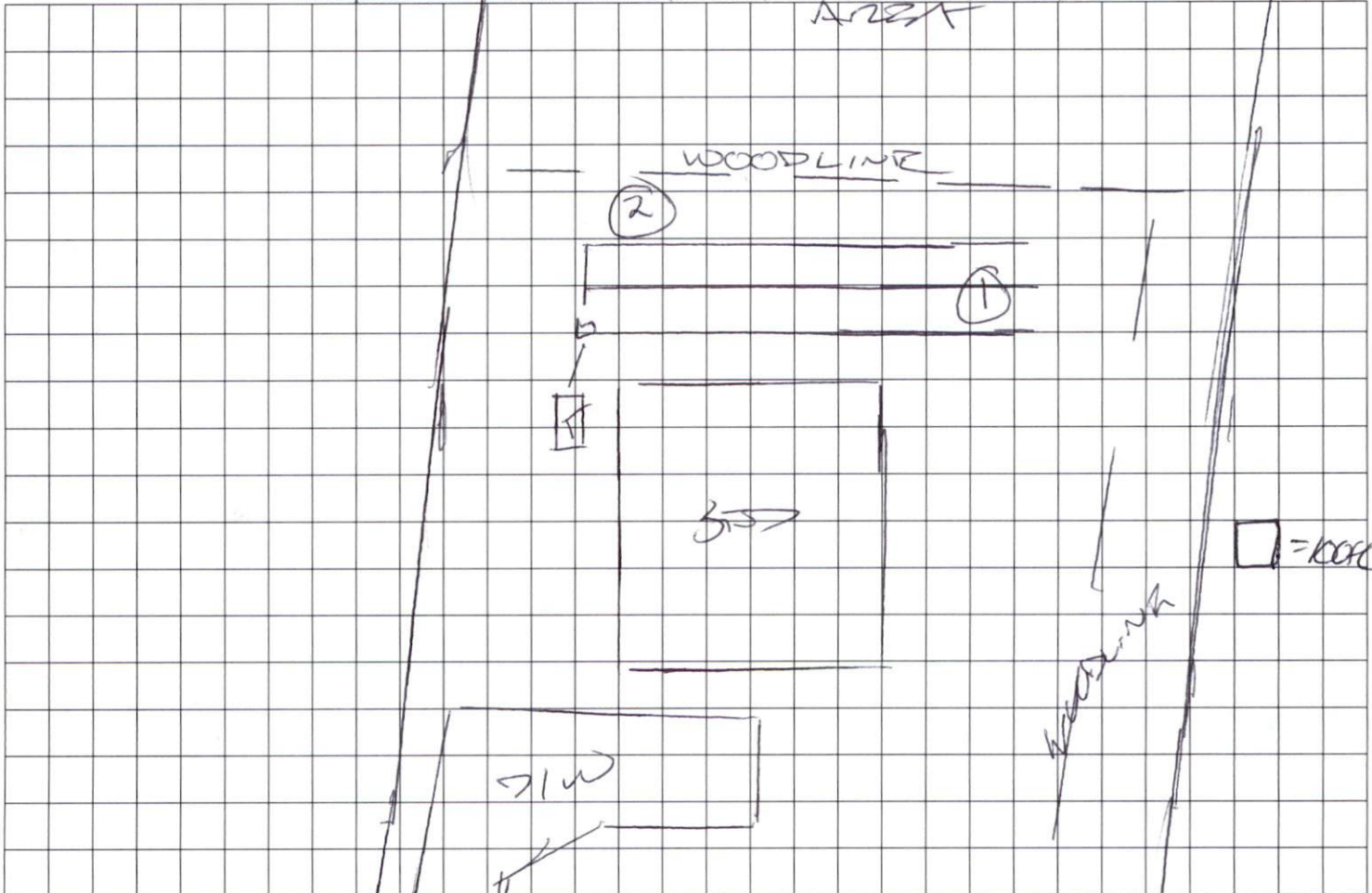

③

RESTAURANT

AREA

α