

I, hereby certify that the development depicted hereon has been granted final approval from Harnett County E-911 Addressing, Environmental Health, Planning, Public Utilities, and the North Carolina Department of Transportation. This plat is subject to any and all conditions stated below and is eligible for recordation in the Harnett County Register of Deeds within thirty days of the date below.

E-911 Addressing - not
Public Utilities (Not for Construction) - water is available
NCDOT - Change of use requires review and permit
Invesco 10-7-21
Subdivision Administrator Date

CERTIFICATE OF OWNERSHIP, DEDICATION AND JURISDICTION

I (WE) HEREBY CERTIFY THAT I AM (WE ARE) THE OWNER(S) OR AGENT OF THE PROPERTY SHOWN AND DESCRIBED HEREON AND THAT I (WE) HEREBY ADOPT THIS PLAN OF SUBDIVISION WITH MY (OUR) FREE CONSENT, ESTABLISH THE MINIMUM BUILDING SETBACK LINES AND DEDICATE ALL STREETS, ALLEYS, WALKS, PARKS AND OTHER SITES AND EASEMENTS TO PUBLIC OR PRIVATE USE AS NOTED, ALL OF THE LAND SHOWN HEREON IS WITHIN THE SUBDIVISION REGULATION JURISDICTION OF HARNETT COUNTY EXCEPT:

Table with columns: CURVE, RADIUS, LENGTH, DELTA, CHORD, CH. BEARING. Lists curves C-1 through C-7 with their respective measurements.

Table with columns: COURSE, BEARING, DISTANCE. Lists courses L-1 through L-16 with their respective bearings and distances.

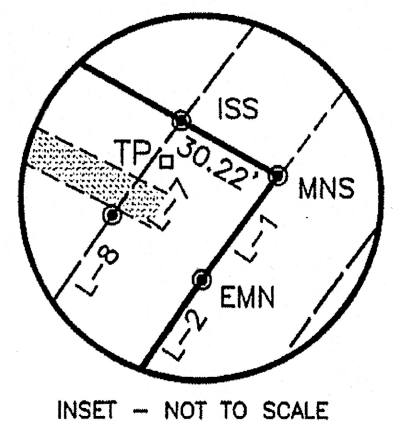
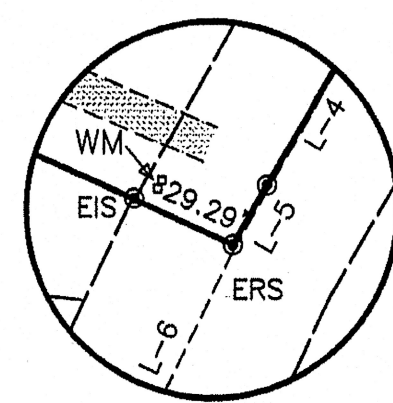

15.985 ACRES TOTAL
-0.145 AC. IN R/W
-1.502 AC. IN 50' ESMT.
14.338 ACRES NET

BOBBY JOE & JANE LONG
PIN #0671-25-2648.000
D.B. 3370 PG. 122
MAP #2003-1157

REFERENCES
MAP #2005-257
MAP #2002-1149
MAP #2003-1157
D.B. 3368 PG. 463
OTHERS AS SHOWN

NC GRID COORDINATES OBTAINED USING RTK GPS OBSERVATIONS USING A SPECTRA PRECISION SP 80 GPS UNIT, REFERENCED TO NAD 83 (2012B).

SITE ADDRESS
543 OLD BUIES CREEK ROAD
LILLINGTON, NC 27546

LOT 4 AREA SUMMARY
1.995 ACRES TOTAL
-0.337 AC. IN ESMT.
-0.145 AC. IN R/W
1.513 ACRES NET

NOTES
AREA BY COORDINATES
NO HORIZONTAL CONTROL FOUND WITHIN 2000'
THIS SURVEY DID NOT HAVE THE BENEFIT OF A TITLE REPORT AND IS SUBJECT TO ANY MATTERS ONE MAY DISCLOSE.
PROPERTY SUBJECT TO BOTH ABOVE AND/OR BELOW GROUND UTILITIES AND/OR EASEMENTS.
WATERSHED - CAPE FEAR RIVER(DUNN) CLASS-WS-IV
PROPERTY ZONED RA-30
SETBACKS
FRONT - 35'
SIDE - 10'
REAR - 25'
CORNER - 20'
THIS PROPERTY IS NOT LOCATED IN A FLOOD HAZARD AREA PER F.E.M.A. MAP #372006000J EFF. DATE: 10/3/2006 ZONE X

REVIEW OFFICER'S CERTIFICATE
STATE OF NORTH CAROLINA
COUNTY OF Harnett
I, Sheila K. Bennett REVIEW OFFICER OF Harnett COUNTY,
CERTIFY THAT THE MAP OR PLAT TO WHICH THIS CERTIFICATION IS AFFIXED MEETS ALL STATUTORY REQUIREMENTS FOR RECORDING.
Sheila K. Bennett
REVIEW OFFICER
DATE 10-7-21

I, BENTON W. DEWAR, CERTIFY THAT THIS PLAT WAS PREPARED UNDER MY SUPERVISION FROM AN ACTUAL FIELD SURVEY OF DESCRIPTION(S) AS RECORDED IN 3368 PAGE 463 THAT THE BOUNDARIES NOT SURVEYED ARE CLEARLY INDICATED AS SUCH AND WERE PLOTTED FROM INFORMATION AS REFERENCED HEREON; THAT THE RATIO OF PRECISION AS CALCULATED WAS 1:15,000+ AND THAT THE GLOBAL NAVIGATIONAL SATELLITE SYSTEM(GNSS) WAS USED TO PERFORM A PORTION OF THIS SURVEY AND THE FOLLOWING INFORMATION WAS USED:

CLASS OF SURVEY A
POSITIONAL ACCURACY 0.02'
TYPE OF GPS FIELD PROCEDURE RTK
DATUM/EPOCH NAD 83
DATES OF SURVEY JULY 2021
PUBLISHED/FIXED-CONTROL USE YES
GEOID MODEL 2012 B
COMBINED GRID FACTOR 0.9998711
UNITS US SURVEY FOOT

I, BENTON W. DEWAR, PROFESSIONAL LAND SURVEYOR NO. 3040, CERTIFY THAT THIS PLAT IS OF A SURVEY THAT CREATES A SUBDIVISION OF LAND, THAT IS REGULATED BY COUNTY OR MUNICIPALITY ORDINANCE THAT REGULATES PARCELS OF LAND.
Benton W. Dewar
BENTON W. DEWAR NCPLS - 3040

I, BENTON W. DEWAR CERTIFY THAT THIS PLAT WAS DRAWN UNDER MY SUPERVISION FROM AN ACTUAL SURVEY MADE UNDER MY SUPERVISION DEED BOOK 3368 PAGE 463 MAP # 2005 PAGE 257; THAT THE BOUNDARIES NOT SURVEYED ARE CLEARLY INDICATED AS DRAWN FROM INFORMATION FOUND IN BOOK 3368 PAGE 463; THAT THE RATIO OF PRECISION OR POSITIONAL ACCURACY AS CALCULATED IS 1:15,000+, THAT THIS PLAT WAS PREPARED IN ACCORDANCE WITH G.S. 47-30 AS AMENDED. WITNESS MY ORIGINAL SIGNATURE, LICENSE NUMBER AND SEAL THIS 7th DAY OF OCTOBER, A.D. 20 21.

Benton W. Dewar
BENTON W. DEWAR, NCPLS - 3040

RECORDED IN MAP #2021-458 HARNETT COUNTY REG.



FOR REGISTRATION
Matthew S. Hillis
REGISTER OF DEEDS
Harnett County, NC
2021 OCT 12 03:41:47 PM
BK: 2021 PG: 458-458
FEE: \$21.00
INSTRUMENT # 2021024043
KCORE



ROAD MAINTENANCE AGREEMENT
RECORDED IN DEED BOOK
4059 PAGE 232-233
HARNETT COUNTY REGISTER OF DEEDS

BENTON W. DEWAR AND ASSOCIATES
PROFESSIONAL LAND SURVEYOR
5920 HONEYCUTT ROAD
HOLLY SPRINGS, NC 27540
PH. # (919) 552-9813
FAX # (919) 557-2255



MINOR SUBDISION FOR:
DAVID & GAIL WADDELL
543 OLD BUIES CREEK ROAD - LILLINGTON, NC 27546
JERRY & ELIZABETH MILTON PROPERTY
MAP #2005-257
DEED BOOK 3368 PAGE 463
NEILL'S CREEK TOWNSHIP
HARNETT COUNTY - NORTH CAROLINA

PIN #0671-25-1096.000
PID #110671 0040
DATE: 5/28/2021
SCALE: 1" = 100'
ZONED RA-30
HARNETT COUNTY
21-51L
WADDELL/21/650