

THIS IS TO CERTIFY THAT ON THE 9th DAY OF FEBRUARY 2022 AN ACTUAL SURVEY WAS DONE UNDER MY SUPERVISION OF THE PROPERTY SHOWN HEREON, THIS MAP IS NOT INTENDED TO MEET GS 47-30 RECORDING REQUIREMENTS.

Dean M. Rhoads

SIGNED _____
DEAN M. RHOADS, PLS (L-4679)

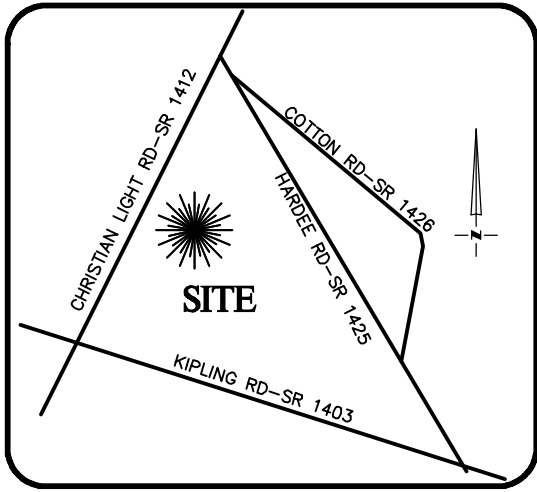

VICINITY MAP
Not To Scale

LEGEND

- PROPERTY LINE
- ADJACENT PROPERTY LINES
- CLOSURE EXCEEDS 1 INCH IN 10,000 FT.
- IPS ● - IRON PIN SET
- EIP ○ - EXISTING IRON PIPE
- CP ○ - COMPUTED POINT
- DB - DEED BOOK
- PB - BOOK OF MAPS/PLAT BOOK
- PG - PAGE
- #24 STREET ADDRESS



SETBACKS: (PB 2021 PG 372-373)

FRONT: 35' FROM R/W
REAR: 25'
SIDE: 10'
CORNER LOT SIDE: 20'

N/F
BARBARA H. FORE
DB 635, PG 381

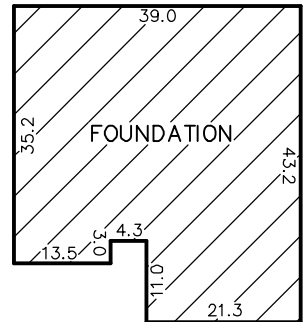

INSET
N.T.S.



PRINCE PLACE DRIVE
50' PUBLIC R/W & UTILITY EASEMENT

CURVE	RADIUS	ARC LENGTH	CH LENGTH	CH BEARING
C1	940.29'	72.65'	72.63'	S30°49'54"W

THIS PROPERTY MAY BE SUBJECT TO ANY AND ALL APPLICABLE DEED RESTRICTIONS, EASEMENTS, RIGHT-OF-WAY, UTILITIES AND RESTRICTIVE COVENANTS WHICH MAY BE OF RECORD OR IMPLIED

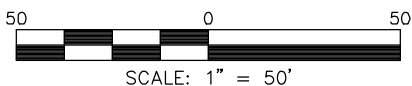

RESIDENTIAL LAND SERVICES, PLLC.

1917 Evans Road
Cary, North Carolina 27513
Phone (919) 378-9316
Firm License # P-0873

FOUNDATION SURVEY

FOR
#24 PRINCE PLACE DRIVE
LOT 69, PRINCE PLACE, PHASE 1

Hectors Creek Township, Harnett County, North Carolina

PROPERTY OF: DAVIDSON HOMES

PLAT BOOK 2021 PAGE 372-373 DEED REFERENCE _____

DRAWN BY: SMB

DATE: FEBRUARY 9, 2022