

SID 2111-0067
GAKHARU SID
LOT 28

**SOIL/SITE EVALUATION
for ON-SITE WASTEWATER SYSTEM**

Owner: - Applicant: CUMBERLAND HOMES INC.
Address: 137 BUCKHARD Date Evaluated: 01/25/2022
Proposed Facility: 432 SID Design Flow (.1949): 480 GPD
Location of Site: 432 SID Property Recorded: 480 GPD
Water Supply: Public Individual Well Spring Other
Evaluation Method: Auger Boring Pit Cut
Type of Wastewater: Sewage Industrial Process Mixed

Property Size:

P R O F I L E #	.1940 Landscape Position/ Slope %	Horizon Depth (In.)	SOIL MORPHOLOGY		OTHER PROFILE FACTORS				Profile Class & LTAR
			.1941		.1942 Soil Wetness/ Color	.1943 Soil Depth (IN.)	.1956 Sapro Class	.1944 Restr Horiz	
			.1941 Structure/ Texture	.1941 Consistence Mineralogy					
1213	2 4%	0-12	CL LS	VM sand					PS
		12-40	MW SU	FI SL		40			0.35
		40+	SILL						

Description	Initial System	Repair System	Other Factors (.1946):
Available Space (.1945)	<input checked="" type="checkbox"/>	<input checked="" type="checkbox"/>	Site Classification (.1948): <u>PROVISIONALLY SUITABLE</u>
System Type(s)	<u>25% RED</u>	<u>25% RED</u>	Evaluated By: <u>ANDREW CORBIN, PEH</u>
Site LTAR	<u>0.35</u>	<u>0.35</u>	Others Present:

COMMENTS:

LANDSCAPE POSITIONS

- R-RIDGE
- S-SHOULDER SLOPE
- L-LINEAR SLOPE
- FS-FOOT SLOPE
- N-NOSE SLOPE
- H-HEAD SLOPE
- CC-CONCLAVE SLOPE
- CV-CONVEX SLOPE
- T-TERRACE
- FP-FLOOD PLAN

STRUCTURE

- SG-SINGLE GRAIN
- M-MASSIVE
- CR-CRUMB
- GR-GRANULAR
- SBK-SUBANGULAR BLOCKY
- ABK-ANGULAR BLOCKY
- PL-PLATY
- PR-PRISMATIC

GROUP

- I S-SAND
LS-LOAMY SAND
- II SL-SANDY LOAM
L-LOAM
- III SI-SILT
SIL-SILT LOAM
CL-CLAY LOAM
SCL-SANDY CLAY LOAM
- IV SIC-SILTY CLAY
C-CLAY
SC-SANDY CLAY

MINERALOGY

- SLIGHTLY EXPANSIVE
- EXPANSIVE

1955 LTAR

- 1.2 - 0.8
- 0.8 - 0.6
- 0.6 - 0.3
- 0.4 - 0.1

CONSISTENCE MOIST

- VFR-VERY FRIABLE
- FR-FRIABLE
- FI-FIRM
- VFI-VERY FIRM
- EFI-EXTREMELY FIRM

WET

- NS-NON-STICKY
- SS-SLIGHTLY STICKY
- S-STICKY
- VS-VERY STICKY
- NP-NON-PLASTIC
- SP-SLIGHTLY STICKY
- P-PLASTIC
- VP-VERY PLASTIC

HIGH
LOW

Show profile locations and other site features (dimensions, references or benchmark, and North)

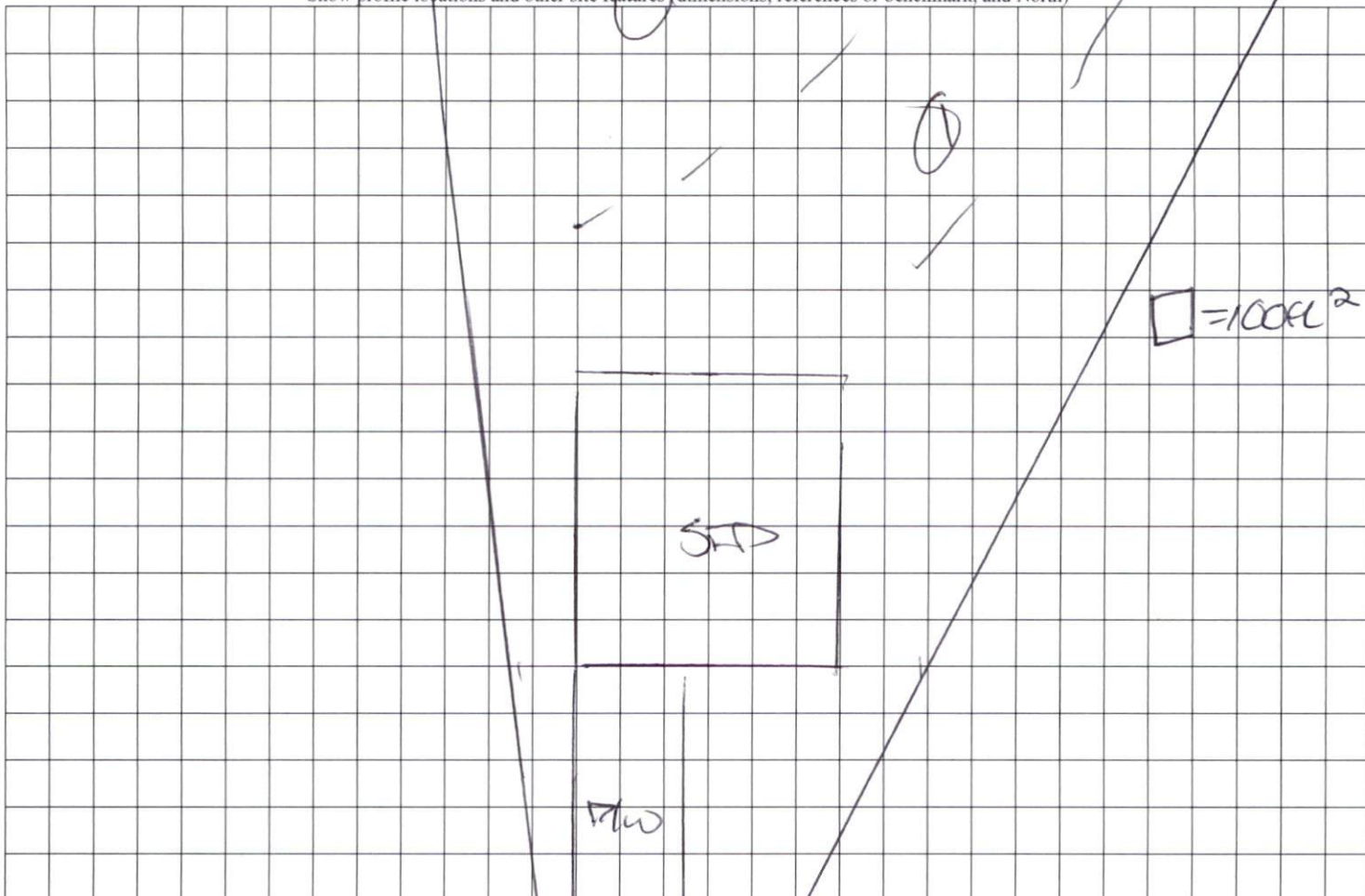

BUCKHAUSEN DRIVE