

### Truss Placement Plan SCALE: NTS

▲ = Denotes Left End of Truss  
(Reference Engineered Truss Drawing)

- = HUS410 (Qty. 16)
- = THD410 (Qty. 1)

*All Truss Reactions are Less than 3,000 lbs. Unless Noted Otherwise.*

○ -- Denotes Reaction Greater than 3,000 lbs.  
*Reaction / # of Studs*

Products					
PlotID	Length	Product	Plies	Net Qty	Fab Type
GDH (Dropped)	20' 0"	1-3/4"x 11-7/8" LVL Kerto-S	2	2	FF
BM1 (Flush)	15' 0"	1-3/4"x 16" LVL Kerto-S	2	2	FF
BM2 (Flush)	11' 0"	1-3/4"x 16" LVL Kerto-S	2	2	FF

**LOAD CHART FOR JACK STUDS**

REACTION (LBS)	SPACING (IN)	NO. OF STUDS
1700	1	2550
3400	2	5100
5100	3	7650
6800	4	10200
8500	5	12750
10200	6	15300
11900	7	
13600	8	
15300	9	

BUILDER	Southern Touch Homes	CITY / CO.	Sanford / Lee
JOB NAME	1 Microtower Road	ADDRESS	1 Microtower Road
PLAN	Magnolia II "C"	MODEL	Floor
SEAL DATE	Seal Date	DATE REV.	/ /
QUOTE #	Quote #	DRAWN BY	Christine Shivy
JOB #	J0921-5768	SALES REP.	Lenny Norris

THIS IS A TRUSS PLACEMENT DIAGRAM ONLY. These trusses are designed as individual building components to be incorporated into the building design at the specification of the building designer. See individual design sheets for each truss design identified on the placement drawing. The building designer is responsible for temporary and permanent bracing of the roof and floor system and for the overall structure. The design of the truss support structure including headers, beams, walls, and columns is the responsibility of the building designer. For general guidance regarding bracing, consult BCSH-B1 and BCSH-B3 provided with the truss delivery package or online @ sbcindustry.com

Bearing reactions less than or equal to 3000# are deemed to comply with the prescriptive Code requirements. The contractor shall refer to the attached Tables (derived from the prescriptive Code requirements) to determine the minimum foundation size and number of wood studs required to support reactions greater than 3000# but not greater than 15000#. A registered design professional shall be retained to design the support system for any reaction that exceeds those specified in the attached Tables. A registered design professional shall be retained to design the support system for all reactions that exceed 15000#.

Signature: Christine Shivy  
Christine Shivy



**ROOF & FLOOR TRUSSES & BEAMS**

Reilly Road Industrial Park  
Fayetteville, N.C. 28309  
Phone: (910) 864-8787  
Fax: (910) 864-4444

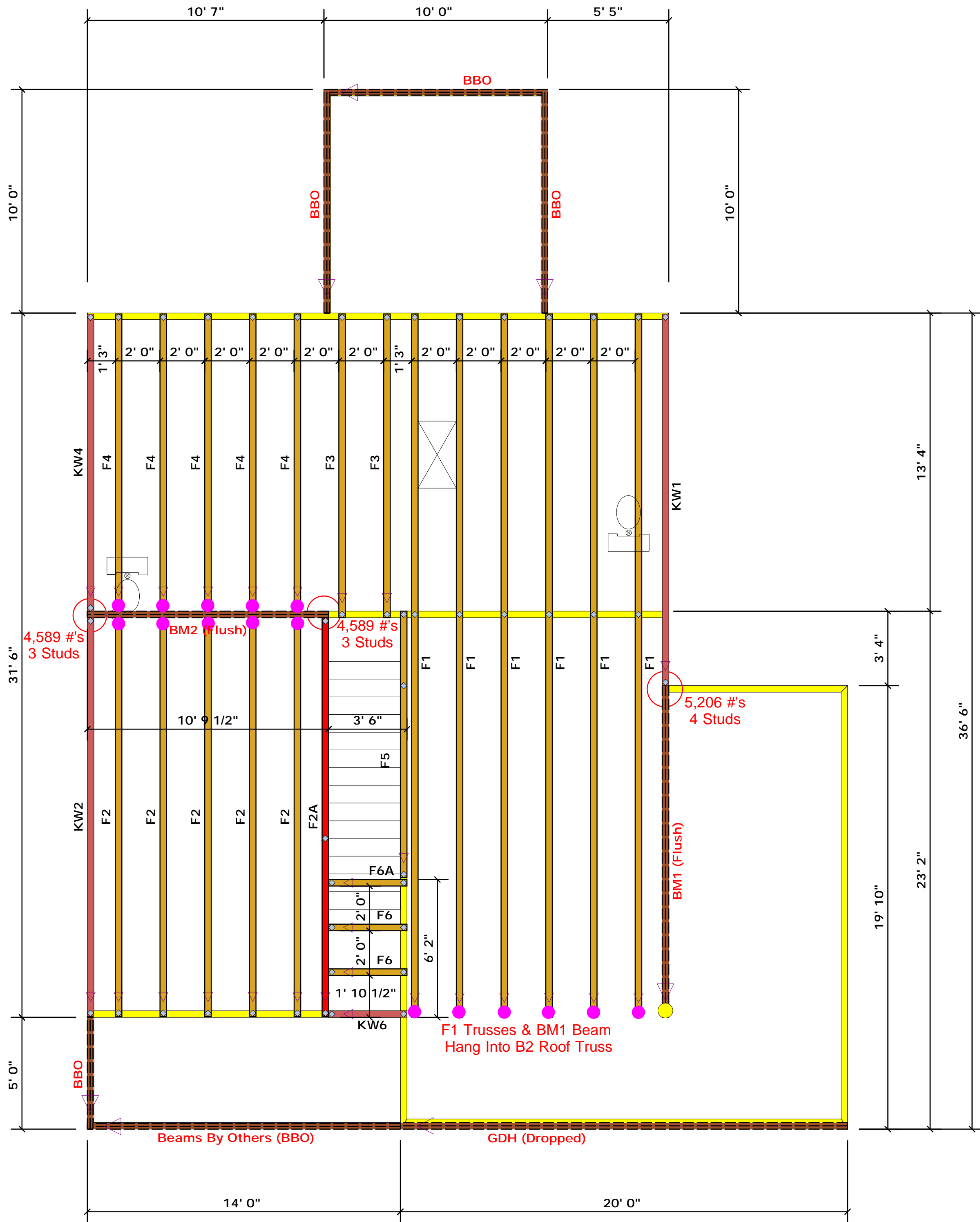

### Truss Placement Plan SCALE: NTS

▲ = Denotes Left End of Truss  
(Reference Engineered Truss Drawing)

- = HUS410 (Qty. 16)
- = THD410 (Qty. 1)

*All Truss Reactions are Less than 3,000 lbs. Unless Noted Otherwise.*

○ -- Denotes Reaction Greater than 3,000 lbs.  
Reaction / # of Studs

Products					
PlotID	Length	Product	Plies	Net Qty	Fab Type
GDH (Dropped)	20' 0"	1-3/4"x 11-7/8" LVL Kerto-S	2	2	FF
BM1 (Flush)	15' 0"	1-3/4"x 16" LVL Kerto-S	2	2	FF
BM2 (Flush)	11' 0"	1-3/4"x 16" LVL Kerto-S	2	2	FF

**LOAD CHART FOR JACK STUDS**

REACTION (LBS)	SPACING (IN)	NO. OF STUDS
1700	1	2550
3400	2	5100
5100	3	7650
6800	4	10200
8500	5	12750
10200	6	15300
11900	7	
13600	8	
15300	9	

BUILDER	Southern Touch Homes	CITY / CO.	Sanford / Lee
JOB NAME	1 Microwtower Road	ADDRESS	1 Microwtower Road
PLAN	Magnolia II "C"	MODEL	Floor
SEAL DATE	Seal Date	DATE REV.	/ /
QUOTE #	Quote #	DRAWN BY	Christine Shivy
JOB #	J0921-5768	SALES REP.	Lenny Norris

THIS IS A TRUSS PLACEMENT DIAGRAM ONLY. These trusses are designed as individual building components to be incorporated into the building design at the specification of the building designer. See individual design sheets for each truss design identified on the placement drawing. The building designer is responsible for temporary and permanent bracing of the roof and floor system and for the overall structure. The design of the truss support structure including headers, beams, walls, and columns is the responsibility of the building designer. For general guidance regarding bracing, consult BCSH-B1 and BCSH-B3 provided with the truss delivery package or online @ sbcindustry.com

Bearing reactions less than or equal to 3000# are deemed to comply with the prescriptive Code requirements. The contractor shall refer to the attached Tables (derived from the prescriptive Code requirements) to determine the minimum foundation size and number of wood studs required to support reactions greater than 3000# but not greater than 15000#. A registered design professional shall be retained to design the support system for any reaction that exceeds those specified in the attached Tables. A registered design professional shall be retained to design the support system for all reactions that exceed 15000#.

Signature: Christine Shivy  
Christine Shivy

**comtech**  
ROOF & FLOOR TRUSSES & BEAMS  
Reilly Road Industrial Park  
Fayetteville, N.C. 28309  
Phone: (910) 864-8787  
Fax: (910) 864-4444