

Harnett County Department of Public Health

PERMIT # SFD2116-0095

Operation Permit

521427

New Installation Septic Tank Nitrification Line Repair Expansion

PROPERTY LOCATION: 210 LONG MEADOW LN. (BAPTIST GROVE RD)

Name: (owner) D. Z. HOLTON INC. SUBDIVISION LAFAYETTE MEADOWS LOT # 10

System Installer: JASON MATTHEWS

Basement with plumbing: Garage Number of Bedrooms 3

Type of Water Supply: Community Public Well Distance from well NA feet

System Type: 25% REDUCTION SYSTEM III B Types V and VI Systems expire in 5 years.

(In accordance with Table V a)

Owner must contact Health Department 6 months prior to expiration for permit renewal.

This system has been installed in compliance with applicable North Carolina General Statutes, Rules for Sewage Treatment and Disposal, and all conditions of the Improvement Permit and Construction Authorization.

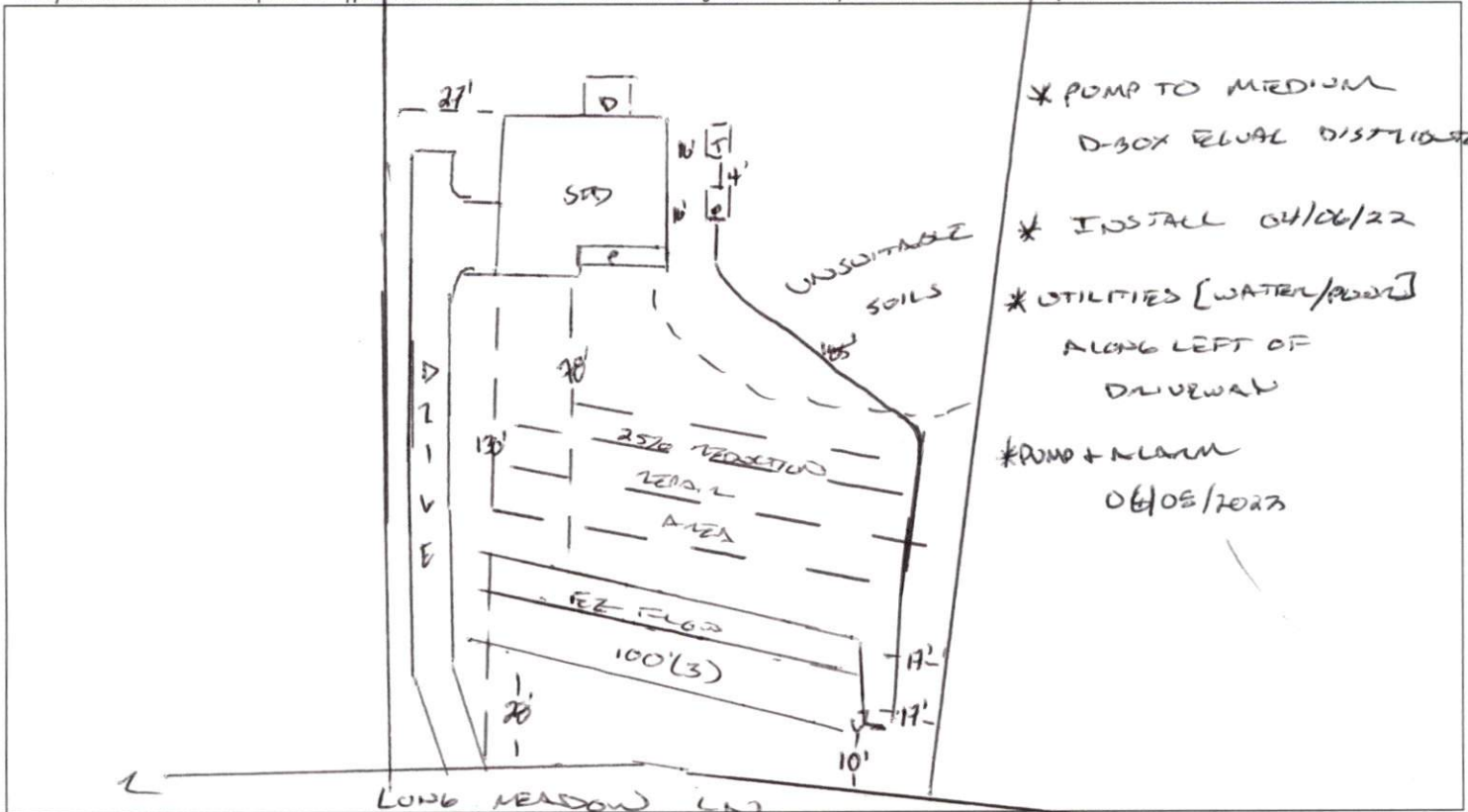

PERMIT CONDITIONS:

- I. Performance: System shall perform in accordance with Rule .1961.
- II. Monitoring: As required by Rule .1961.
- III. Maintenance: As required by Rule .1961. Other: _____
 Subsurface system operator required? Yes No
 If yes, see attached sheet for additional operation conditions, maintenance and reporting.
- IV. Operation: _____
- V. Other: _____

D-Box Pump Alarm H2O Line PWR Line

Following are the specifications for the sewage disposal system on the above captioned property.

Type of system: Conventional Other FE FLOW III B Septic Tank: 1000 gallons Pump Tank: 1000 gallons
 Subsurface No. of exact length width of depth of
 Drainage Field ditches 3 of each ditch 100 feet ditches 3 feet ditches 18-24 inches
 French Drain Required: _____ Linear feet

Authorized State Agent [Signature] Date 06/08/2022