

Harnett County Department of Public Health Improvement Permit

Revised
- Location of
Bed rooms

A building permit cannot be issued with only an Improvement Permit

PROPERTY LOCATION: 1683 Josey Williams Rd (SR 2027)

ISSUED TO: Alberto Santoni

SUBDIVISION _____

LOT # _____

NEW REPAIR EXPANSION

Site Improvements required prior to Construction Authorization Issuance: _____

Type of Structure: 59' x 66' SFD

Proposed Wastewater System Type: Pump to 25% reduction

Projected Daily Flow: 480 GPD

Number of bedrooms: 4 Number of Occupants: 8 max

Basement Yes No

Pump Required: Yes No May be required based on final location and elevations of facilities

Type of Water Supply: Community Public Well Distance from well _____ feet

Permit valid for: Five years
 No expiration

Permit conditions: _____

Authorized State Agent: [Signature]

Date: 04-12-22

SEE ATTACHED SITE SKETCH

The issuance of this permit by the Health Department in no way guarantees the issuance of other permits. The permit holder is responsible for checking with appropriate governing bodies in meeting their requirements. This site is subject to revocation if the site plan, plat, or the intended use changes. The Improvement Permit shall not be affected by a change in ownership of the site. This permit is subject to compliance with the provisions of the Laws and Rules for Sewage Treatment and Disposal and to conditions of this permit.

Construction Authorization

(Required for Building Permit)

The construction and installation requirements of Rules .1950, .1952, .1954, .1955, .1956, .1957, .1958, and .1959 are incorporated by references into this permit and shall be met. Systems shall be installed in accordance with the attached system layout.

ISSUED TO: Alberto Santoni

PROPERTY LOCATION: 1683 Josey Williams Rd (SR 2027)

SUBDIVISION _____

LOT # _____

Facility Type: 59' x 66' SFD New Expansion Repair

Basement? Yes No Basement Fixtures? Yes No

Type of Wastewater System** Pump to 25% reduction (Initial) Wastewater Flow: 480 GPD

(See note below, if applicable)

Pump to 25% reduction (Repair)

Installation Requirements/Conditions

Septic Tank Size 1000 gallons

Pump Tank Size 1000 gallons

Number of trenches 3

Exact length of each trench 100 feet

Trenches shall be installed on contour at a

Maximum Trench Depth of: 18 - 22 inches

(Trench bottoms shall be level to +/-1/4"

in all directions)

Trench Spacing: 9 Feet on Center

Soil Cover: 6 inches

(Maximum soil cover shall not exceed

36" above the trench bottom)

Pump Requirements: _____ ft. TDH vs. _____ GPM

_____ inches below pipe

Aggregate Depth: _____ inches above pipe

Conditions: _____ inches total

**WATER LINES (INCLUDING IRRIGATION) MUST BE 10FT. FROM ANY PART OF SEPTIC SYSTEM OR REPAIR AREA.
NO UTILITIES ALLOWED IN INITIAL OR REPAIR DRAIN FIELD AREA.**

**If applicable: I understand the system type specified is different from the type specified on the application. I accept the specifications of this permit.

Owner/Legal Representative Signature: _____ Date: _____

This Construction Authorization is subject to revocation if the site plan, plat, or the intended use changes. The Construction Authorization shall not be transferred when there is a change in ownership of the site. This

Construction Authorization is subject to compliance with the provisions of the Laws and Rules for Sewage Treatment and Disposal and to the conditions of this permit.

SEE ATTACHED SITE SKETCH

Authorized State Agent: [Signature]

Date: 04-12-22

Construction Authorization Expiration Date: 04-12-27

Application # SFD2110-0084 *Revised*

Harnett County Department of Public Health Site Sketch

Property Location: 1683 Josey Williams Rd (SR 2027)

Issued To: Alberto Santoni Subdivision _____ Lot # _____

Authorized State Agent: Mah [Signature] REHS Date: 4-12-22

* 1000 Gallon Septic Tank
1000 Gallon Pump Tank
~300' of 2" sch 40 PVC
Supply Line

(3) 100' Lines of
25% reduction
material
with 9' centers
and max trench
depth of 22"

↳ Red, white + Blue
Flags mark the
Drain field

* IF you have a question
OR a problem on site,
CALL for Clarification
OR TO MEET at Job

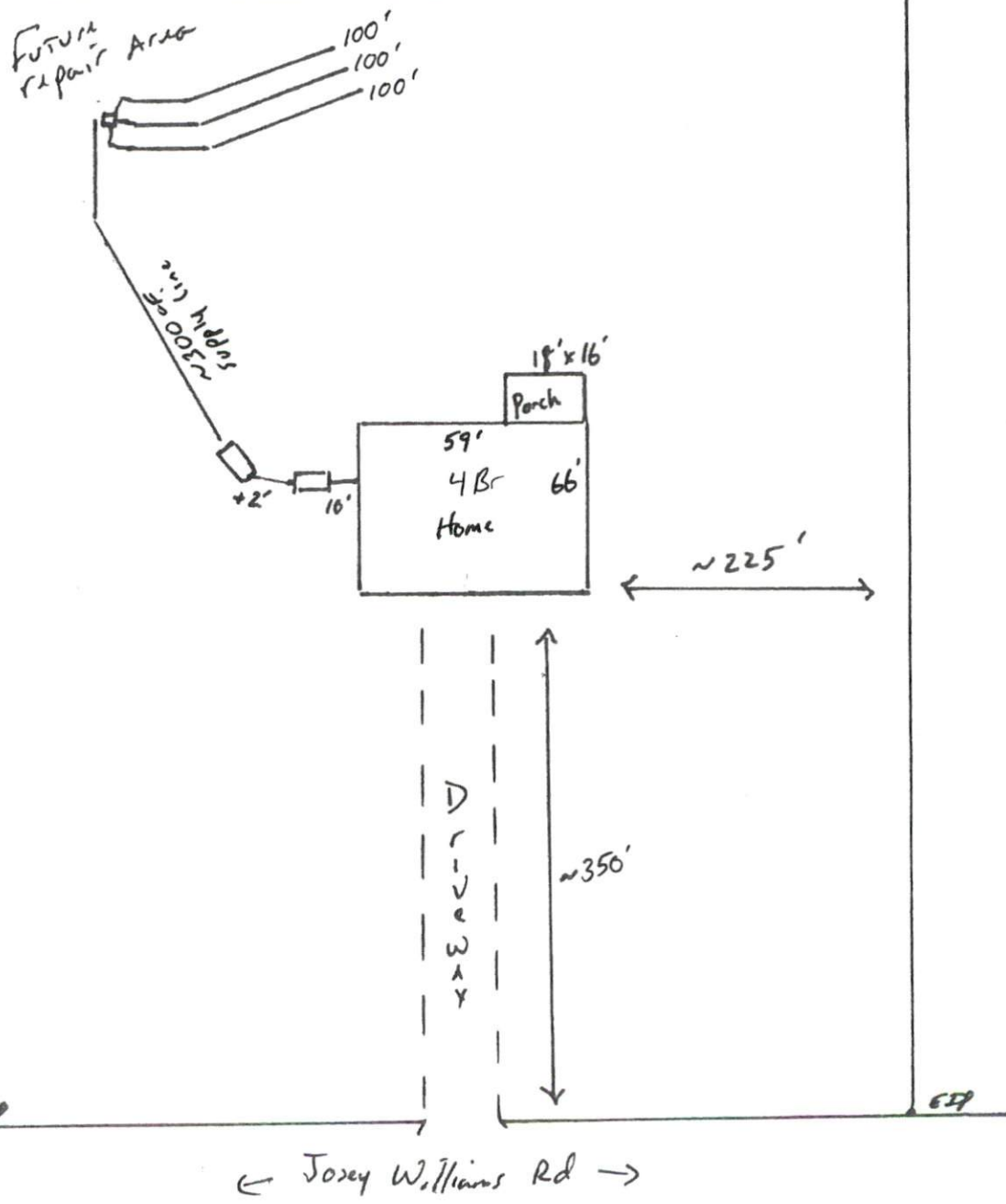

This drawing is for illustrative purposes only. System installation must meet all pertinent laws, rules, and regulations.