

PART 3: Authorization to Operate (ATO)

Except for date received, the Section below is to be completed by the Owner or by the PE designated to act as their legal representative for the EOP.

LHD USE ONLY: Initial submittal of request for ATO received: <u>2/24/23</u> by <u>OT</u> <small style="margin-left: 150px;">Date</small> <small style="margin-left: 100px;">Initials</small>
Date of Post-construction Conference: _____

The following items are included in this submittal for an Authorization to Operate under an EOP:

- | | | |
|--|-------------------------------------|---------------------------------|
| 1. Signed and sealed copy of the Engineer's report that includes: | | |
| a. Signed and sealed evaluation of soil conditions and site features | <input checked="" type="checkbox"/> | Yes <input type="checkbox"/> No |
| b. Drawings, specifications, plans | <input checked="" type="checkbox"/> | Yes <input type="checkbox"/> No |
| c. Reports on special inspections and final inspection | <input checked="" type="checkbox"/> | Yes <input type="checkbox"/> No |
| d. Management Program manual | <input checked="" type="checkbox"/> | Yes <input type="checkbox"/> No |
| e. On-site Wastewater Contractor's signed statement | <input checked="" type="checkbox"/> | Yes <input type="checkbox"/> No |
| f. Signed and sealed statement pursuant to 15A NCAC 18A .1938(h) | <input checked="" type="checkbox"/> | Yes <input type="checkbox"/> No |
| 2. Fee (as applicable) | <input checked="" type="checkbox"/> | Yes <input type="checkbox"/> No |
| 3. Notarized letter documenting Owner's acceptance of the system from the PE | <input checked="" type="checkbox"/> | Yes <input type="checkbox"/> No |

Attestation by the Owner or the PE for Authorization to Operate

I, ATHAN M. PARKER, PE hereby attest that all items indicated above have been provided to the
Print name of Owner or Professional Engineer

HARNETT County LHD and the system shall meet applicable federal, State, and local laws, regulations, rules and ordinances in accordance with G.S. 130A-336-.1(e)(6).

Digitally signed by ATHAN M. PARKER, PE
 DN: cn=ATHAN M. PARKER, PE, c=US, ou=AMPD ENGINEERING, PLLC, email=ATHAN.PARKER@AMPDENGINEERING.COM
 Date: 2023.02.24 13:11:48 -05'00'

This section for LHD Use Only.

LHD Review of required information for the ATO

INCOMPLETE
 Based upon review of information submitted by the Owner or PE in the Section above, the following items are missing from the information required for an Authorization to Operate for an EOP: _____

Copies of this signed form were sent to the design PE and the Owner on _____ via _____
Date Email, FAX, USPS, Hand-delivered

<i>Print name of authorized Agent of the LHD</i>	<i>Signature of authorized Agent of the LHD</i>	<i>Date</i>
--	---	-------------

COMPLETE
 Based upon review of information submitted by the Owner or PE in the Section above, this Authorization to Operate is hereby issued in accordance with G.S. 130A-336.1(m).

A copy of this complete NOI/ATO with tracking information was sent to the State on 3/1/23 via EMAIL.
Date Email, FAX, USPS, Hand-delivered

<i>Print name of authorized Agent of the LHD</i>	<i>Signature of authorized Agent of the LHD</i>	<i>Date</i>
--	---	-------------

ISSUANCE OF CERTIFICATE OF OCCUPANCY: Once the LHD determines completeness based upon the PE submission, the owner may apply to the local permitting agency for permanent electrical service to a residence, place of business or place of public assembly pursuant to G.S. 130A-339.



DEPARTMENT OF HEALTH AND HUMAN SERVICES
DIVISION OF PUBLIC HEALTH

ROY COOPER
GOVERNOR

MANDY COHEN, MD, MPH
SECRETARY

DANIEL STALEY
DIRECTOR

COMMON FORM FOR ENGINEERED OPTION PERMIT

See Instructions for Use in Appendix A

Except for "Date received", this Section to be completed by the Professional Engineer licensed in accordance with G.S. 89C

LHD USE ONLY: Initial submittal of this NOI received: _____ by _____ Date Initials

PART 1: Notice of Intent to Construct (NOI)

New Expansion

Repair – LHD Permit Number _____ Repair – EOP Permit Number _____

1. Facility Owner's name: (Owner, Company Name, Utility, Partnership, Individual, etc.): _____

CARROLL CONSTRUCTION HOMES, INC

Mailing address: 63 VERON COURT City: WILLOW SPRING State: NC Zip: 27592

Telephone number: 919-410-5704 E-mail Address: CAMERON.ADAMS1087@GMAIL.COM

2. Professional Engineer (PE) name: ATHAN M PARKER, PE License number: 43250

Mailing address: PO BOX 4580 City: EMERALD ISLE State: NC Zip: 28594

Telephone number: 919-795-9594 E-mail Address: ATHAN.PARKER@AMPDENGINEERING.COM

3. Licensed Soil Scientist (LSS) name: HAYWOOD PITTMAN, LSS License number: 1262

Mailing address: 1073-1 GREGORY FORK RD City: RICHLANDS State: NC Zip: 28574

Telephone number: 910-324-2892 E-mail Address: PITTMANSOIL@YAHOO.COM

4. Licensed Geologist (LG) (if applicable) name: _____ License Number: _____

Mailing address: _____ City: _____ State: _____ Zip: _____

Telephone number: _____ E-mail Address: _____

5. On-site Wastewater Contractor name: HAYWOOD PITTMAN, LSS License number: 3825

1340 TWO CLAUDE RD WILLOW SPRINGS 27592
Mailing address: 1073-1 GREGORY FORK RD City: RICHLANDS State: NC Zip: 28574

919-625-7051 TANORDAN@GMAIL.COM
Telephone number: 910-324-2892 E-mail Address: PITTMANSOIL@YAHOO.COM

6. Proof of Errors and Omissions or other appropriate liability insurance for the following persons is attached

that includes the name of the insurer, name of the insured and the effective dates of coverage:

PE LSS LG On-site Wastewater Contractor



Lot and Subdivision Lot 15 Haven

System Type 25% Reduction

Tank Size 1,000 gal Septic Tank.

Trench Info # Lines 3

Line Lengths 60'

Depth 18" - 20" TB

Installation Date 1-11-23

Final Inspection Date 1-11-23

Installer Signature *[Signature]*

Date 2-16-23

AMP'd Engineering, PLLC

Civil Engineer – Consulting Engineer – Land Development

PO Box 4580
Emerald Isle, NC 28594
(252) 777-0141 ✦ athan.parker@ampdengineering.com
Firm License Number P-1532

CERTIFICATION LETTER
February 24, 2023

To: Mr. Oliver Tolksdorf, REHS
Environmental Health Supervisor
Harnett County Health Dept
307 W Cornelius Harnett Blvd
Lillington, NC 27546

Ref: Haven- Lot 15 EOP
371 Placid Pond Dr.
Broadway, Harnett County, NC

Dear Mr. Tolksdorf,

As a duly licensed registered Professional Engineer in the State of North Carolina, license number 43250, I have inspected the installation of the Engineered Option Permit of the LHD Referenced project SFD21 10-0031 on December 28, 2022. Gene's Backhoe, the on-site wastewater contractor installed 3-60' 25% Reduction (EZ Flow, reduction taken) Type IIIg, lines with 18-20" TB. The system appeared to be in the location permitted on the site plan by Pittman Soil Consulting. This letter also acts as written request to waive the "post-construction conference" requirement as stated in G.S. 130A-336.1(j).

If you have any questions, please feel free to give me a call (252) 777-0141 or email me (athan.parker@ampdengineering.com).

Sincerely,



Digitally signed by ATHAN M. PARKER
, PE
DN: cn=ATHAN M. PARKER, PE, c=US, o=AMP'D ENGINEERING, PLLC,
email=ATHAN.PARKER@AMPDENGINERING.COM
Date: 2023.02.24 13:10:37 -05'00'



Athan M Parker, PE
President
AMP'd Engineering, PLLC
Firm License No. P-1532
ALE

Atch: Owner's acceptance of the system, ATO Sheet, Septic Standards, As-Built and On-site Wastewater Contractors statement & Insurance

AMP'd Engineering, PLLC

Civil Engineer – Consulting Engineer – Land Development

PO Box 4580

Emerald Isle, NC 28594

(252) 777-0141 ✦ athan.parker@ampdengineering.com

Firm License Number P-1532

ACCEPTANCE LETTER

February 20, 2023

To: **Carroll Construction Homes, Inc (the "Owner")**
63 Veron Ct.
Willow Spring, NC 27592

Ref: **Haven- Lot 15 EOP**
371 Placid Pond Dr.
Broadway, Harnett County, NC

Dear Carroll Construction Homes, Inc,

As a duly licensed registered Professional Engineer in the State of North Carolina, license number 43250, I have inspected the installation of the Engineered Option Permit of the LHD Referenced project SFD2110-0031 on December 28, 2022. Gene's Backhoe, the on-site wastewater contractor installed 3-60' 25% Reduction (EZ Flow, reduction taken) Type IIIg, lines with 18-20" TB. The system appeared to be in the location permitted on the site plan by Pittman Soil Consulting. This letter states the Owner's acceptance of the system from the Professional Engineer, Licensed Soil Scientist and the On-Site Wastewater Contractor as permitted with the Harnett County Health Department. This letter also acts as an agreement by the owner to waive the "post-construction conference" requirement as stated in G.S. 130A-336.1(j). Please sign this letter and have notarized on page 2 of 2.

If you have any questions, please feel free to give me a call (252) 777-0141 or email me (athan.parker@ampdengineering.com).

Sincerely,

Digitally signed by ATHAN M. PARKER
DN: cn=ATHAN M. PARKER, PE, o=AMP'D ENGINEERING, PLLC,
email=ATHAN.PARKER@AMP'DENGINEERING.COM
Date: 2023.02.20 09:53:30 -0500

Athan M Parker, PE
President
AMP'd Engineering, PLLC
Firm License No. P-1532
ALE



AMP'd Engineering, PLLC

Civil Engineer – Consulting Engineer – Land Development

Owner: Harold G. Carroll, Jr.

Print Name

Sign Name

2/23/23

Date

North Carolina

Johnston County

I, Stephanie C. Nordan, a Notary Public for said County and State, do hereby certify that Harold G. Carroll, Jr. personally appeared before me this day and acknowledged the due execution of the page 1 of 2 "Acceptance Letter" from the PE.

Witness my hand and official seal, this the 23rd day of February, 2023.



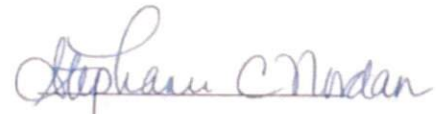

Notary Public

My commission expires August 25, 2025.

Owner: HAVEN S/D
 Address: LOT 15
 Location: PLACID POND DRIVE

PITTMAN SOIL CONSULTING
PO BOX 1387
RICHLANDS, NC 28574
910-330-2784
pittmansoil@yahoo.com

LOT INFORMATION OBTAINED FROM PLAT BY STANCIL AND ASSOCIATES FOR XCESSIVE RISK DEVELOPMENT.

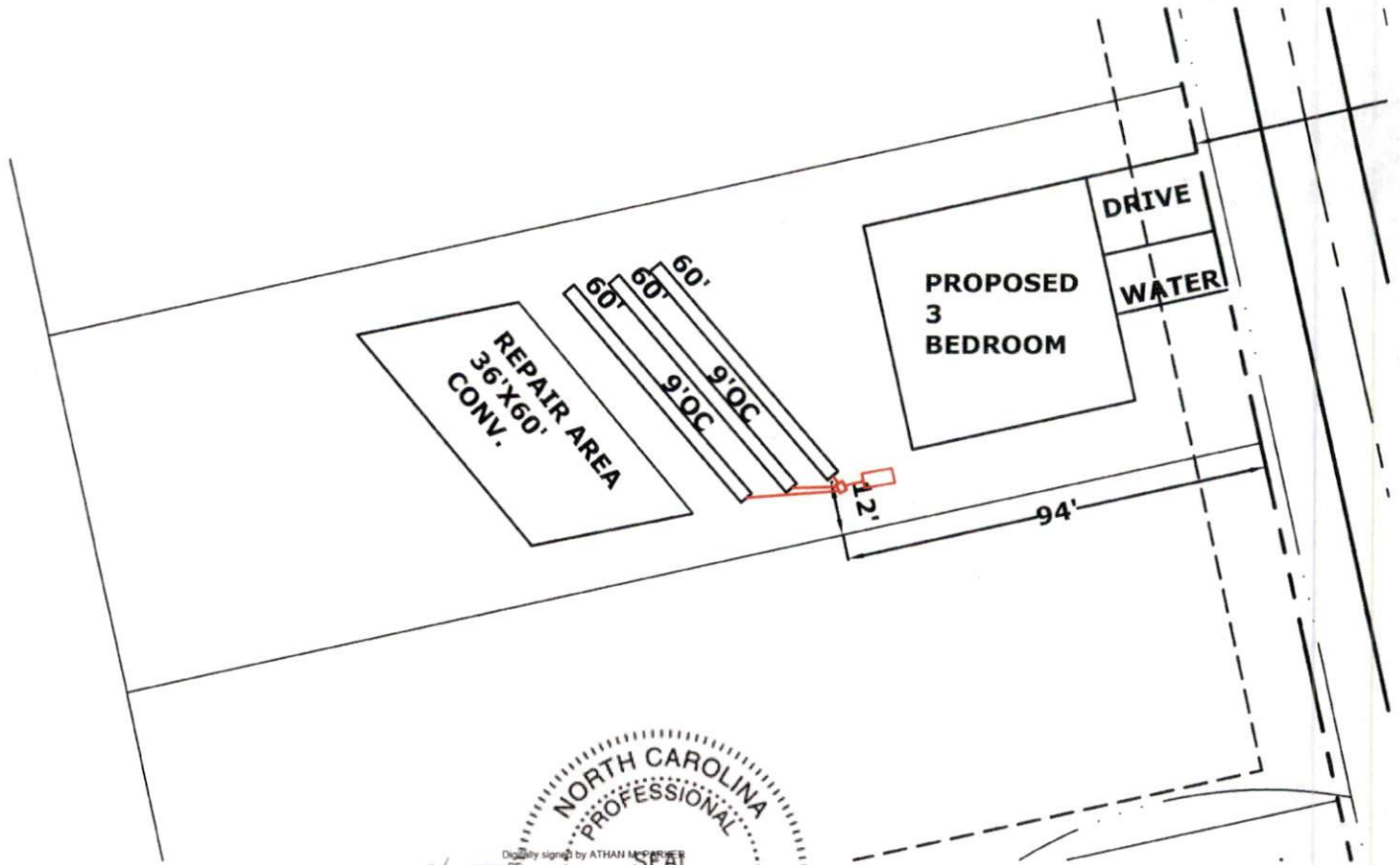

INITIAL
 3 BEDROOM
 LTAR .5 **3-60' 25% REDUCTION (EZ FLOW)**
~~4-60' CONVENTIONAL~~
 18-20" TB
 >6" SOIL COVER REQUIRED OVER SYSTEM AND 5' BEYOND SYSTEM

REPAIR AREA
 3 BEDROOM
 LTAR .5
 4-60' CONVENTIONAL
 18-20" TB
 >6" SOIL COVER REQUIRED OVER SYSTEM AND 5' BEYOND SYSTEM

SCALE 1"=40'

AMP'd Engineering, PLLC

Civil Engineer – Consulting Engineer – Land Development

PO Box 4580

Emerald Isle, NC 28594

(252) 777-0141 ✦ athan.parker@ampdengineering.com

Firm License Number P-1532

Ref: AMP'D Engineering, PLLC Septic Standards

To Whom It May Concern,

Due to unforeseen negligence by previous owners and contractors regarding the Engineered Option Permit ("EOP") process and installation, the following standards have been adopted by AMP'D Engineering, PLLC and are to be strictly followed. If these standards are not followed, AMP'D Engineering, PLLC has the right to void all warranties related to engineering work involved with these EOPs.

- Engineer shall approve septic installer prior to installation.
- Engineer shall be notified at a minimum of 48 hours prior to septic installation.
- No vehicles, equipment, structures, debris, or any other items that may compact the soils or damage the septic lines allowed on the septic location before or after installation. Equipment only allowed over the septic area by a certified septic installer to backfill and grade the septic area after installation.
- All systems are to have a minimum of 6" cover over the system and five feet beyond the system. Only approved soil to be used as cover.
- After installation, the area should be graded to shed water. All drainage should be diverted away from septic area and tanks.
- All drip systems to have a minimum of 12" cover over the system and five feet beyond the system. Only group I soil allowed over system with a cap of topsoil to promote growth of groundcover.
- Groundcover is to be established over every system within 14 days after installation.
- Orange safety fencing with T-Posts to be used to surround the system after installation to prevent any unqualified individuals from entering septic area.

If you have any questions, please feel free to give me a call (252) 777-0141 or email me (athan.parker@ampdengineering.com).

Sincerely,



Digitally signed by ATHAN M. PARKER
: PE
DN: cn=ATHAN M. PARKER, PE, c=US, o=AMP'D ENGINEERING, PLLC, email=ATHAN.PARKER@AMPDENGINERING.COM
Date: 2023.02.24 13:11:34 -0500

Athan M Parker, PE
President
AMP'd Engineering, PLLC
Firm License No. P-1532

