

Harnett County Department of Public Health

PERMIT # SD-2110-0005

Operation Permit

New Installation Septic Tank Nitrification Line Repair Expansion

PROPERTY LOCATION: 4605 CHRISTIAN LIGHT DR. (S21412)

Name: (owner) PETER & SUSANNE EVANS SUBDIVISION _____ LOT # 1

System Installer: CLINT ADAMS

Basement with plumbing: Garage Number of Bedrooms 2

Type of Water Supply: Community Public Well Distance from well NA feet

System Type: 25% REDUCTION SYSTEM III B Types V and VI Systems expire in 5 years.

(In accordance with Table V a)

Owner must contact Health Department 6 months prior to expiration for permit renewal.

This system has been installed in compliance with applicable North Carolina General Statutes, Rules for Sewage Treatment and Disposal, and all conditions of the Improvement Permit and Construction Authorization.

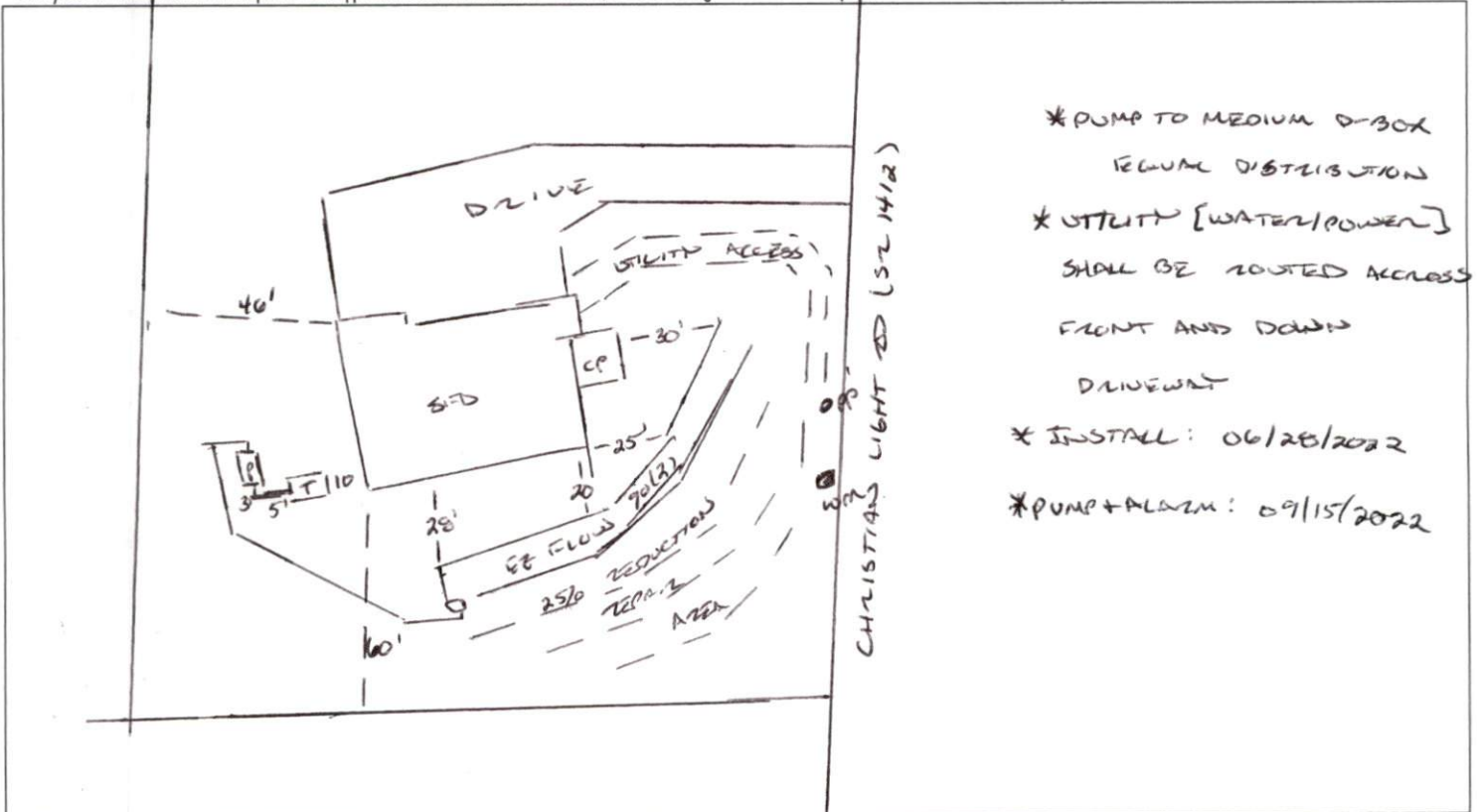

- * PUMP TO MEDIUM D-BOX
EQUAL DISTRIBUTION
- * UTILITY [WATER/POWER]
SHALL BE ROUTED ACROSS
FRONT AND DOWN
DRIVEWAY
- * INSTALL: 06/28/2022
- * PUMP + ALARM: 09/15/2022

PERMIT CONDITIONS:

- I. Performance: System shall perform in accordance with Rule .1961.
- II. Monitoring: As required by Rule .1961.
- III. Maintenance: As required by Rule .1961. Other: _____
Subsurface system operator required? Yes No
If yes, see attached sheet for additional operation conditions, maintenance and reporting.
- IV. Operation: _____
- V. Other: _____

D-Box Pump Alarm H2O Line PWR Line

Following are the specifications for the sewage disposal system on the above captioned property.

Type of system: Conventional Other EE FLOW III B Septic Tank: 1000 gallons Pump Tank: 1000 gallons
Subsurface: No. of exact length width of depth of
Drainage Field ditches 2 of each ditch 90 feet ditches 3 feet ditches 18-20 inches
French Drain Required: _____ Linear feet

Authorized State Agent [Signature] Date 09/15/2022