

SOIL/SITE EVALUATION
 for ON-SITE WASTEWATER SYSTEM

Owner: *Jonathan M. Wertz*
 Applicant: *369 Wertz*
 Address: *369 Wertz*
 Proposed Facility: *5FD*
 Location of Site: *5FD*

Date Evaluated: *10-19-21*
 Design Flow (.1949): *4FD*
 Property Recorded:

- Water Supply: Public Individual Well Spring Other
- Evaluation Method: Auger Boring Pit Cut
- Type of Wastewater: Sewage Industrial Process Mixed

Sheet: _____
 Property ID: _____
 Lot #: _____
 File #: _____
 Code: _____

Profile Class & LTAR	OTHER PROFILE FACTORS				SOIL MORPHOLOGY				Horizon	Depth (In.)	Position/ Landscape	Slope %	#				
	1944 Restr Class	1956 Sapro Class	1943 Soil Depth (IN.)	1942 Soil Wetness/Color	1941 Consistence	1941 Texture/Structure	1941 Mineralogy	1941 Consistence									
PS.4	—	—	>48"	10y2 7/2	fr/ls/np/np	fr/ls/np/np	fr/ls/np/np	fr/ls/np/np	0-30	LS G-	5-78	30-48	5-78	14-48	SCI SCL	5-78	2.3,
PS.4	—	—	>48"	10y2 7/2	fr/ls/np/np	fr/ls/np/np	fr/ls/np/np	fr/ls/np/np	0-14	LS G-	5-78	30-48	5-78	14-48	SCI SCL	5-78	2.3,
PS.4	—	—	>48"	10y2 7/2	fr/ls/np/np	fr/ls/np/np	fr/ls/np/np	fr/ls/np/np	0-30	LS G-	5-78	30-48	5-78	14-48	SCI SCL	5-78	2.3,
PS.4	—	—	>48"	10y2 7/2	fr/ls/np/np	fr/ls/np/np	fr/ls/np/np	fr/ls/np/np	0-30	LS G-	5-78	30-48	5-78	14-48	SCI SCL	5-78	2.3,

Description	Initial System	Repair System	Available Space (.1945)	System Type(s)	Site LTAR
	Initial System	Repair System	Available Space (.1945)	System Type(s)	Site LTAR

Other Factors (.1946): *PS*
 Site Classification (.1948): *PS*
 Evaluated By: *M. Wertz*
 Others Present:

COMMENTS: _____

LANDSCAPE POSITIONS	GROUP	TEXTURES	.1955 LTAR	CONSISTENCE MOIST	WET
R-RIDGE	I	S-SAND	1.2 - 0.8	VFR-VERY FRIABLE	NS-NON-STICKY
S-SHOULDER SLOPE		LS-LOAMY SAND		FR-FRIABLE	SS-SLIGHTLY STICKY
L-LINEAR SLOPE	II	SL-SANDY LOAM	0.8 - 0.6	FI-FIRM	S-STICKY
FS-FOOT SLOPE		L-LOAM		VFI-VERY FIRM	VS-VERY STICKY
N-NOSE SLOPE	III	SI-SILT	0.6 - 0.3	EFI-EXTREMELY FIRM	NP-NON-PLASTIC
H-HEAD SLOPE		SIL-SILT LOAM			SP-SLIGHTLY STICKY
CC-CONCLAVE SLOPE		CL-CLAY LOAM			P-PLASTIC
CV-CONVEX SLOPE		SCL-SANDY CLAY LOAM			VP-VERY PLASTIC
T-TERRACE	IV	SIC-SILTY CLAY	0.4 - 0.1		
FP-FLOOD PLAN		C-CLAY			
		SC-SANDY CLAY			

STRUCTURE

- SG-SINGLE GRAIN
- M-MASSIVE
- CR-CRUMB
- GR-GRANULAR
- SBK-SUBANGULAR BLOCKY
- ABK-ANGULAR BLOCKY
- PL-PLATY
- PR-PRISMATIC

MINERALOGY

- SLIGHTLY EXPANSIVE
- EXPANSIVE

Show profile locations and other site features (dimensions, references or benchmark, and North)

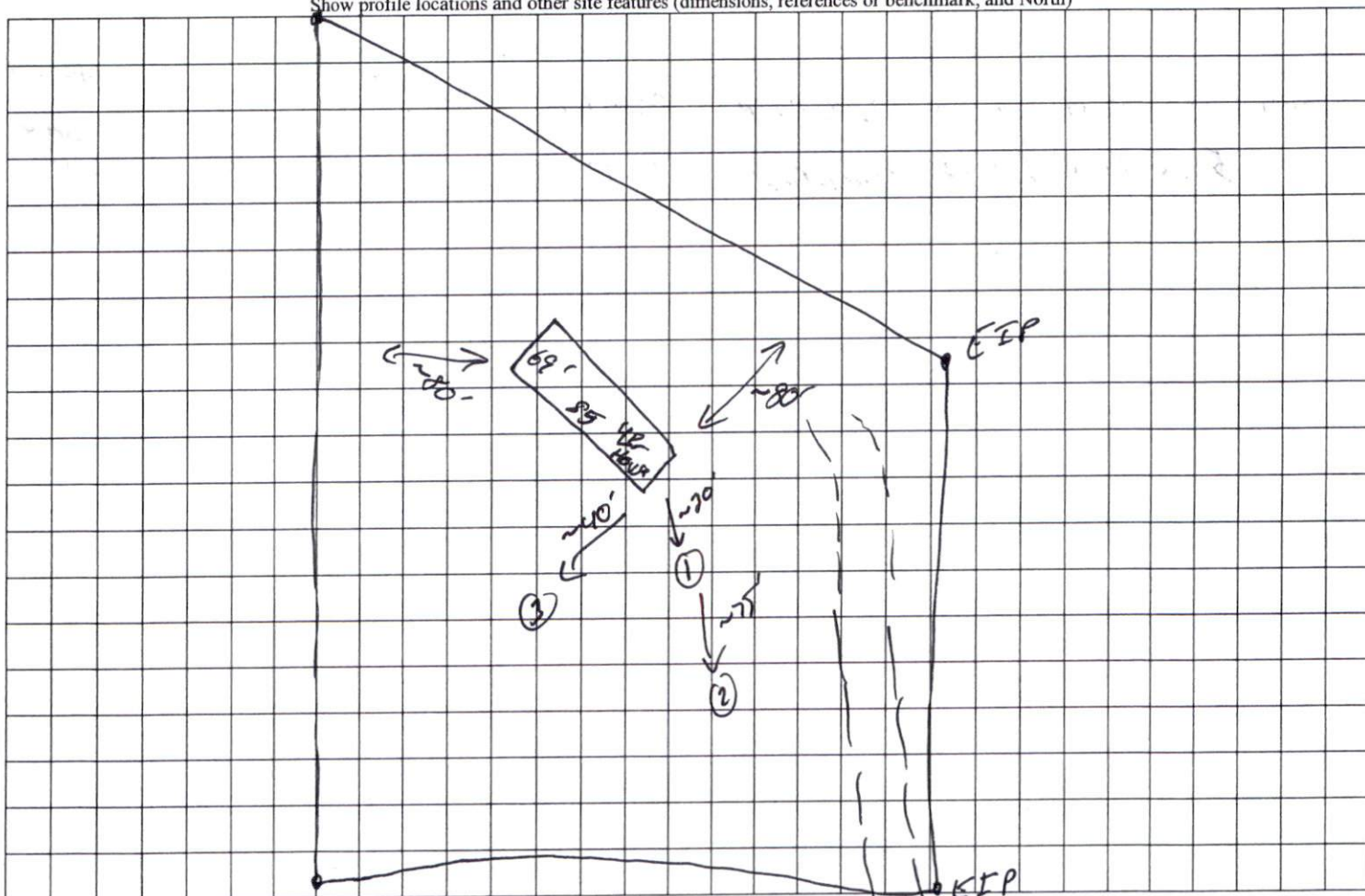

Drive