

SOIL/SITE EVALUATION
 for ON-SITE WASTEWATER SYSTEM

Owner: *Lumco* Applicant:

Address: *53 McArthur Rd*

Proposed Facility:

Location of Site:

Water Supply:

Evaluation Method: Auger Boring

Type of Wastewater:

Date Evaluated: *10-18-21*

Design Flow (.1949): *360*

Property Recorded:

Public Individual

Well

Pit

Cut

Industrial Process

Property Size:

Spring

Other

Mixed

P R O F I L E #	.1940 Landscape Position/ Slope %	Horizon Depth (In.)	SOIL MORPHOLOGY		OTHER PROFILE FACTORS				Profile Class & LTAR
			.1941		.1942 Soil Wetness/ Color	.1943 Soil Depth (IN.)	.1956 Sapro Class	.1944 Restr Horiz	
			.1941 Structure/ Texture	.1941 Consistence Mineralogy					
<i>1,2</i>	<i>L</i>	<i>0-18</i>	<i>LS Gr</i>	<i>Frlw/ug/wxp</i>	<i>10YR7/2</i>	<i>>48"</i>	<i>—</i>	<i>—</i>	<i>PS.5</i>
	<i>5-72</i>	<i>18-52</i>	<i>Sc1 SBlk</i>	<i>F1/SS/SP/SXP</i>	<i>≥ 36"</i>				<i>Group TIL</i>

Description	Initial System	Repair System	Other Factors (.1946): Site Classification (.1948): <i>PS</i> Evaluated By: <i>MHL REHS</i> Others Present:
Available Space (.1945)	<input checked="" type="checkbox"/>	<input checked="" type="checkbox"/>	
System Type(s)	<i>Pump</i>	<i>258 cad</i>	
Site LTAR	<i>.5</i>	<i>.5</i>	

COMMENTS: _____

LANDSCAPE POSITIONS	GROUP	TEXTURES	.1955 LTAR	CONSISTENCE MOIST	WET
R-RIDGE	I	S-SAND	1.2 - 0.8	VFR-VERY FRIABLE FR-FRIABLE	NS-NON-STICKY SS-SLIGHTLY STICKY
S-SHOULDER SLOPE		LS-LOAMY SAND			
L-LINEAR SLOPE	II	SL-SANDY LOAM	0.8 - 0.6	FI-FIRM VFI-VERY FIRM	S-STICKY VS-VERY STICKY
FS-FOOT SLOPE		L-LOAM			
N-NOSE SLOPE	III	SI-SILT	0.6 - 0.3	EFI-EXTREMELY FIRM	NP-NON-PLASTIC SP-SLIGHTLY STICKY P-PLASTIC VP-VERY PLASTIC
H-HEAD SLOPE		SIL-SILT LOAM			
CC-CONCLAVE SLOPE		CL-CLAY LOAM			
CV-CONVEX SLOPE		SCL-SANDY CLAY LOAM			
T-TERRACE	IV	SIC-SILTY CLAY	0.4 - 0.1		
FP-FLOOD PLAN		C-CLAY			
		SC-SANDY CLAY			

STRUCTURE
 SG-SINGLE GRAIN
 M- MASSIVE
 CR-CRUMB
 GR-GRANULAR
 SBK-SUBANGULAR BLOCKY
 ABK-ANGULAR BLOCKY
 PL-PLATY
 PR-PRISMATIC

MINERALOGY
 SLIGHTLY EXPANSIVE
 EXPANSIVE

Show profile locations and other site features (dimensions, references or benchmark, and North)

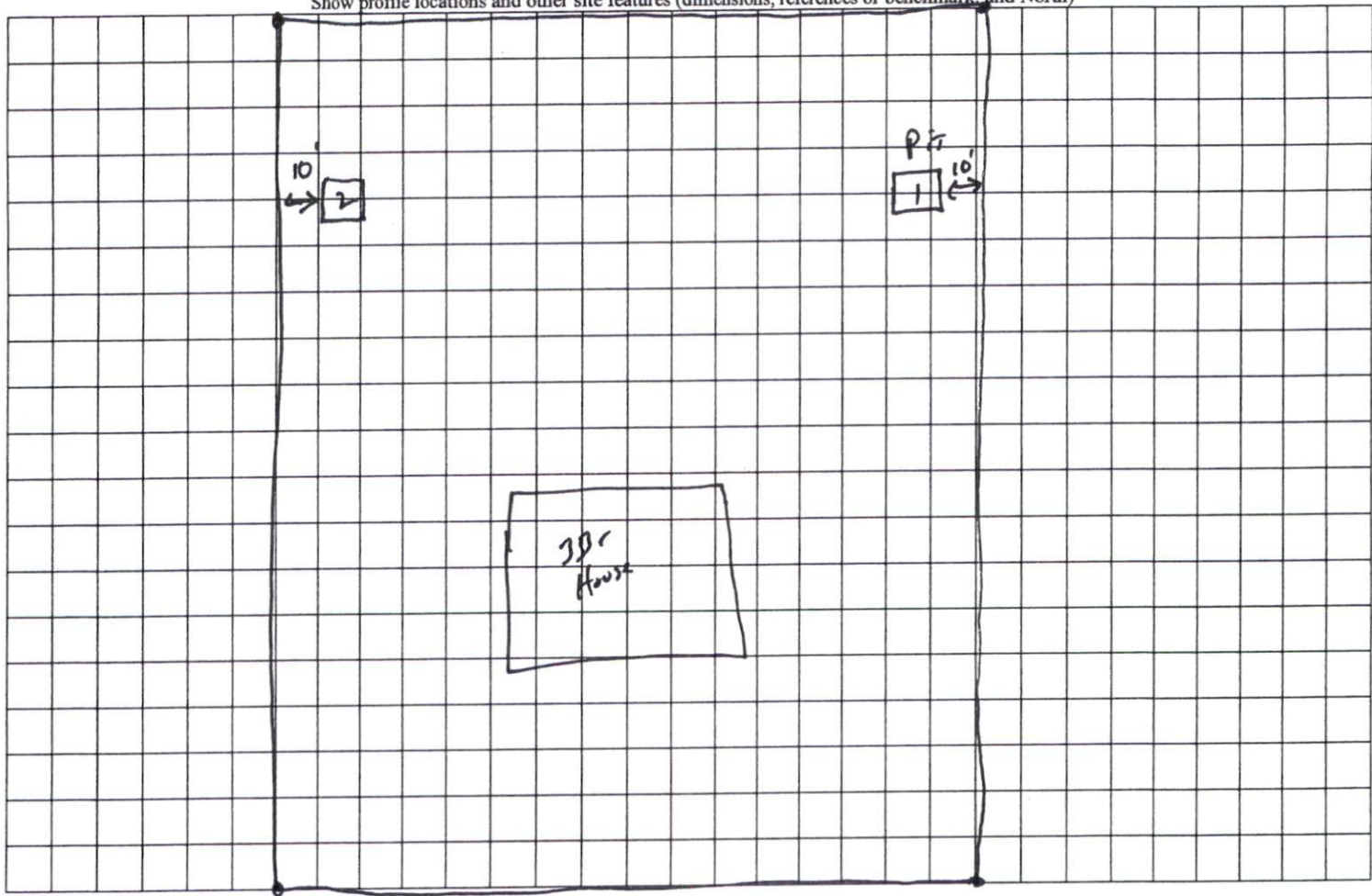

McArthur Rd