

**SOIL/SITE EVALUATION
 for ON-SITE WASTEWATER SYSTEM**

Owner: *Lumco* Applicant: _____
 Address: *571 McArthur Rd* Date Evaluated: *10-18-21*
 Proposed Facility: _____ Design Flow (.1949): *360*
 Location of Site: _____ Property Recorded: _____
 Water Supply: Public Individual Well Spring Other
 Evaluation Method: Auger Boring Pit Cut
 Type of Wastewater: Sewage Industrial Process Mixed

P R O F I L E #	.1940 Landscape Position/ Slope %	Horizon Depth (In.)	SOIL MORPHOLOGY .1941		OTHER PROFILE FACTORS				Profile Class & LTAR
			.1941 Structure/ Texture	.1941 Consistence Mineralogy	.1942 Soil Wetness/ Color	.1943 Soil Depth (IN.)	.1956 Sapro Class	.1944 Restr Horiz	
<i>1, 2</i>	<i>L</i>	<i>0-18</i>	<i>LS Gr</i>	<i>Fc(w)/wq/wxp</i>	<i>10YR 7/2</i>	<i>>48"</i>	<i>—</i>	<i>—</i>	<i>PS. 5</i>
	<i>5-7%</i>	<i>18-52</i>	<i>SCI SBk</i>	<i>Fc/SS/SP/SXP</i>	<i>≥ 36"</i>				<i>Group TTL</i>

Description	Initial System	Repair System	Other Factors (.1946): _____ Site Classification (.1948): <i>PS</i> Evaluated By: <i>M. B. ...</i> Others Present: <i>REHS</i>
Available Space (.1945)	<input checked="" type="checkbox"/>	<input checked="" type="checkbox"/>	
System Type(s)	<i>Pump</i>	<i>25% and 25% and</i>	
Site LTAR	<i>.5</i>	<i>.5</i>	

COMMENTS: _____

LANDSCAPE POSITIONS	GROUP	TEXTURES	.1955 LTAR	CONSISTENCE MOIST	WET
R-RIDGE	I	S-SAND	1.2 - 0.8	VFR-VERY FRIABLE FR-FRIABLE	NS-NON-STICKY SS-SLIGHTLY STICKY
S-SHOULDER SLOPE		LS-LOAMY SAND			
L-LINEAR SLOPE	II	SL-SANDY LOAM	0.8 - 0.6	FI-FIRM VFI-VERY FIRM	S-STICKY VS-VERY STICKY
FS-FOOT SLOPE		L-LOAM			
N-NOSE SLOPE	III	SI-SILT	0.6 - 0.3	EFI-EXTREMELY FIRM	NP-NON-PLASTIC SP-SLIGHTLY STICKY
H-HEAD SLOPE		SIL-SILT LOAM			
CC-CONCLAVE SLOPE		CL-CLAY LOAM			
CV-CONVEX SLOPE		SCL-SANDY CLAY LOAM			
T-TERRACE	IV	SIC-SILTY CLAY	0.4 - 0.1		P-PLASTIC VP-VERY PLASTIC
FP-FLOOD PLAN		C-CLAY SC-SANDY CLAY			

STRUCTURE
 SG-SINGLE GRAIN
 M- MASSIVE
 CR-CRUMB
 GR-GRANULAR
 SBK-SUBANGULAR BLOCKY
 ABK-ANGULAR BLOCKY
 PL-PLATY
 PR-PRISMATIC

MINERALOGY
 SLIGHTLY EXPANSIVE
 EXPANSIVE

Show profile locations and other site features (dimensions, references or benchmark, and North)

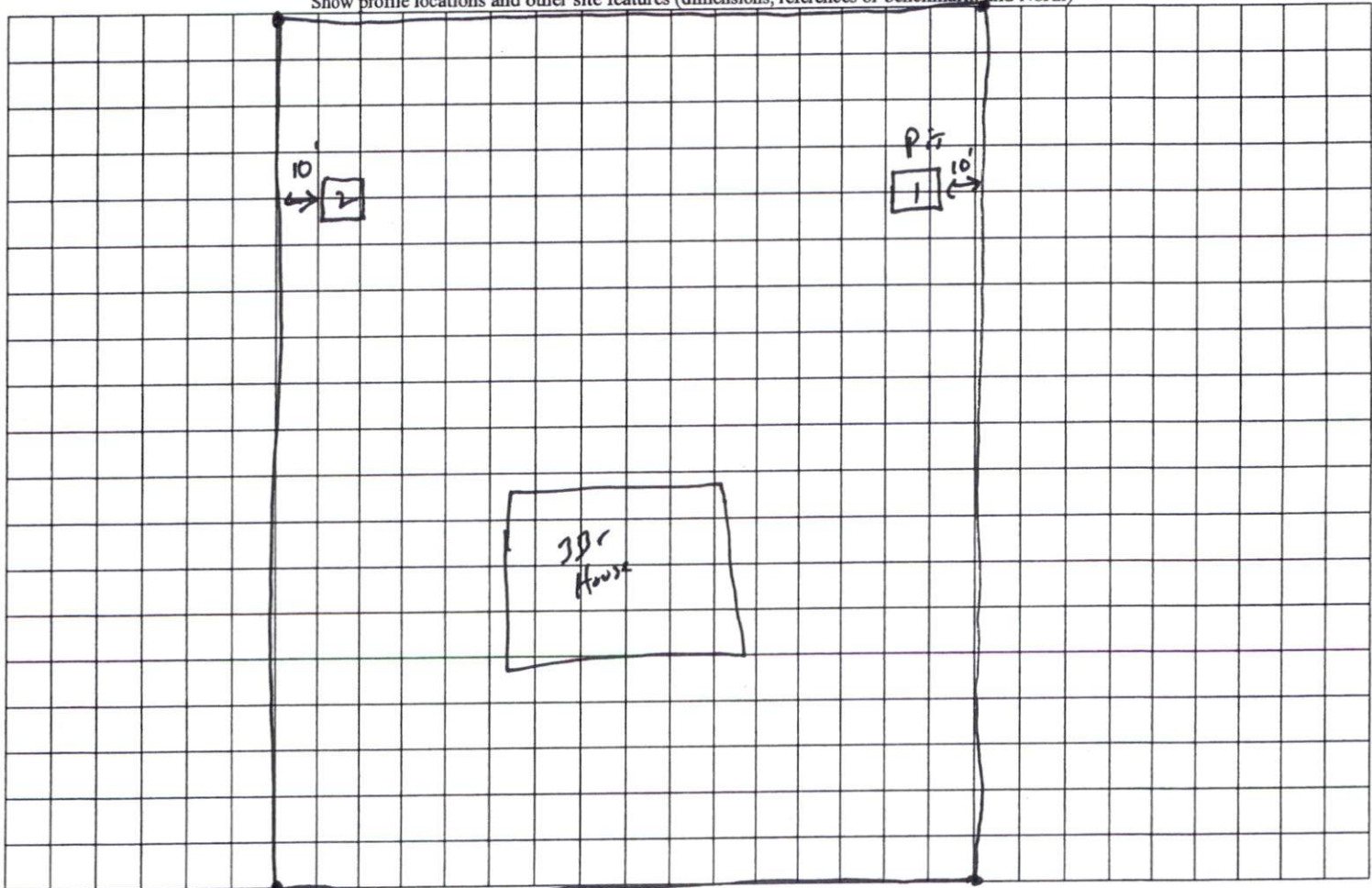

McArthur Rd