

Graphical Illustration - Not To Scale
Member Cut Length - 31-08-12
MemberPitch - 0/12

Design Information:

Building Code: IRC2015	Floor Dead Load: 10.0 lb/ft ²	Roof Dead Load: 10.0 lb/ft ²	Ground Snow Load: 20.0 lb/ft ²
Design Methodology: ASD	Floor Live Load: 40.0 lb/ft ²	Roof Live Load: 20.0 lb/ft ²	
	Unbraced Length Top: 0-00	Bottom: 15-06-04	

Design Results:

	Location	Design	Control	Result	LDF	Load Combination	
Critical Moment (Pos)	6-09-11	1790.48 lb ft	4530.03 lb ft	Passed - 40%	1.00	D + L	
Critical Moment (Neg)	15-10-06	-2478.33 lb ft	4530.03 lb ft	Passed - 55%	1.00	D + L	
Critical Shear	15-08-09	774.78 lb	1730.00 lb	Passed - 45%	1.00	D + L	
Live Load Deflection	7-06-11	0-02	0-12 (L/480)	Passed - L/999	-	L	
Total Load Deflection	7-05-03	0-02	1-00 (L/240)	Passed - L/999	-	D + L	
Max. Reaction			Supported Mtl	Supporting Mtl			
	1-06	551.92 lb	1387.50 lb	5195.31 lb	Passed - 40%	1.00	D + L
	15-10-06	1573.71 lb	3130.00 lb	7656.26 lb	Passed - 50%	1.00	D + L
	31-07-06	551.92 lb	1387.51 lb	5195.45 lb	Passed - 40%	1.00	D + L

Design Notes:

*

Loading:

Type	Start	End	Source	Maximum Load Magnitudes			
				Dead	Floor Live	Roof Live	Snow
Uniform	0-00	31-08-12	FC1 Floor Decking	16 lb/ft	64 lb/ft	-	-

Support Information:

Support	Start	End	Source	Maximum Analysis Reactions			
				Dead	Floor Live	Roof Live	Snow
1	0-00	2-06	W18(i13)	98.00 lb	454.00/-63.00 lb	-	-
2	15-08-10	16-00-02	W19(i19)	315.00 lb	1259.00 lb	-	-
3	31-06-06	31-08-12	W13(i15)	98.00 lb	454.00/-63.00 lb	-	-

Errors, Warnings & Notes:

- * The dead loads used in the design of this member were applied to the structure as projected dead loads.
- * The member graphic, dimensions, and locations shown on this report are based on the centerline of the member.
- * Analysis and Design has been performed using precision loading from actual modeled conditions. Some loads may have been modified to simplify reporting.
- * A load bearing wall is supported by the I-joist at a location where the I-joist is supported by a member below. Please see manufacturer installation guidelines for requirements of blocking/squash blocks.

- Transfer reactions may differ from design results as allowed per building codes and standard load distribution practices.

- This report is based on modeled conditions input by the user. Source information for the loads and supports are provided for reference only. Verify that all loads and support conditions are correct.

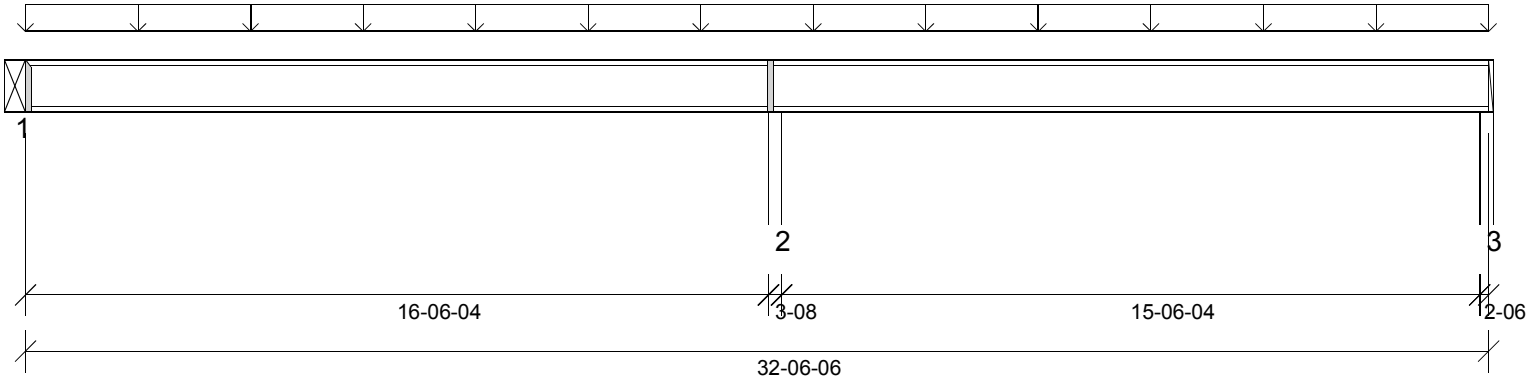

Graphical Illustration - Not To Scale
Member Cut Length - 32-06-06
MemberPitch - 0/12

Design Information:

Building Code:	IRC2015	Floor Dead Load:	10.0 lb/ft ²	Roof Dead Load:	10.0 lb/ft ²	Ground Snow Load:	20.0 lb/ft ²
Design Methodology:	ASD	Floor Live Load:	40.0 lb/ft ²	Roof Live Load:	20.0 lb/ft ²		
		Unbraced Length	Top: 0-00	Bottom:	16-06-04		

Design Results:

	Location	Design	Control	Result	LDF	Load Combination
Critical Moment (Pos)	7-01-00	2004.59 lb ft	4530.03 lb ft	Passed - 44%	1.00	D + L
Critical Moment (Neg)	16-08-00	-2631.36 lb ft	4530.03 lb ft	Passed - 58%	1.00	D + L
Critical Shear	16-06-03	812.04 lb	1730.00 lb	Passed - 47%	1.00	D + L
Live Load Deflection	7-10-04	0-02	0-12 (L/480)	Passed - L/999	-	L
Total Load Deflection	7-08-15	0-03	1-00 (L/240)	Passed - L/999	-	D + L
Max. Reaction			Supported Mt Supporting Mt			
	0-00	577.81 lb	1325.00 lb 0.00 lb	Passed - 44%	1.00	D + L
	16-08-00	1620.68 lb	3130.00 lb 7656.18 lb	Passed - 52%	1.00	D + L
	32-05-00	551.76 lb	1387.50 lb 5195.35 lb	Passed - 40%	1.00	D + L

Design Notes:

- * The required bearing length for this member is the same for both with and without web stiffeners (112)
- *

Loading:

Type	Start	End	Source	Maximum Load Magnitudes			
				Dead	Floor Live	Roof Live	Snow
Uniform	0-00	32-06-06	FC1 Floor Decking	16 lb/ft	64 lb/ft	-	-

Support Information:

Support	Start	End	Source	Maximum Analysis Reactions			
				Dead	Floor Live	Roof Live	Snow
1	0-00	0-00	1BM1-2(i76)	104.00 lb	474.00/-58.00 lb	-	-
2	16-06-04	16-09-12	W19(i19)	324.00 lb	1297.00 lb	-	-
3	32-04-00	32-06-06	W13(i15)	96.00 lb	456.00/-72.00 lb	-	-

Connector Information:

Support	Manufacturer	Model	Nailing Requirements			Min Seal Length	Other Information
			Top	Face	Member		
1		ITS2.56/14	-	-	-	N/A	Connector manually specified by the user.

Errors, Warnings & Notes:

- * The dead loads used in the design of this member were applied to the structure as projected dead loads.
- * The member graphic, dimensions, and locations shown on this report are based on the centerline of the member.
- * Analysis and Design has been performed using precision loading from actual modeled conditions. Some loads may have been modified to simplify reporting.
- * A load bearing wall is supported by the I-joist at a location where the I-joist is supported by a member below. Please see manufacturer installation guidelines for requirements of blocking/squash blocks.

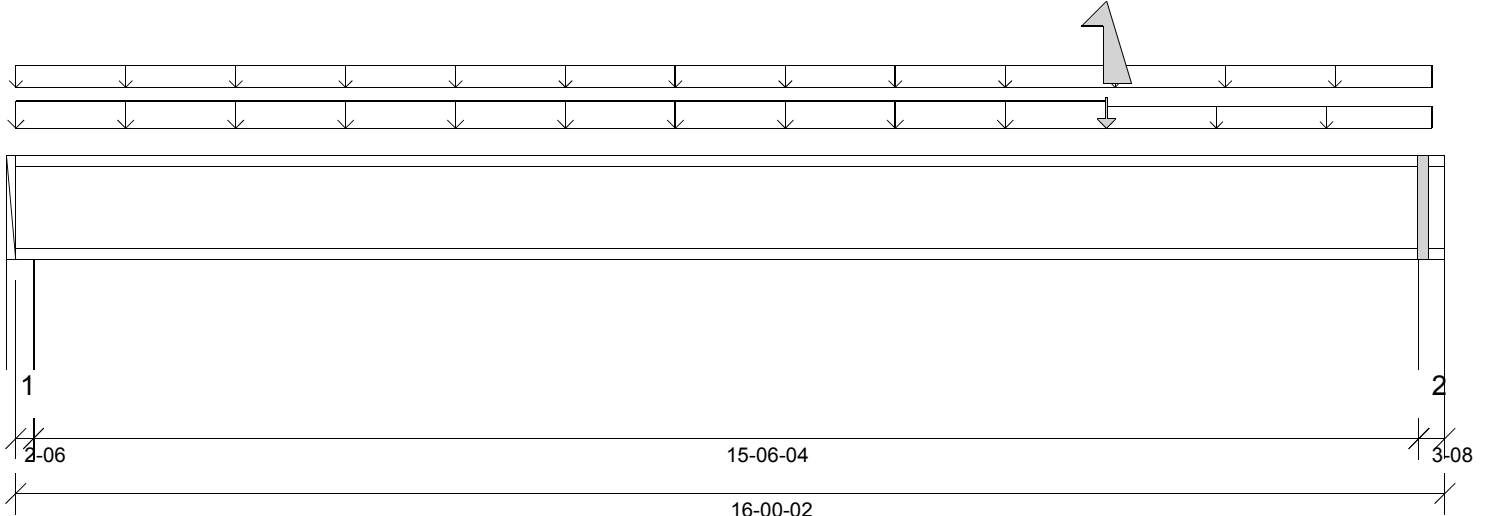

Graphical Illustration - Not To Scale
Member Cut Length - 16-00-02
MemberPitch - 0/12

Design Information:

Building Code:	IRC2015	Floor Dead Load:	10.0 lb/ft ²	Roof Dead Load:	10.0 lb/ft ²	Ground Snow Load:	20.0 lb/ft ²
Design Methodology:	ASD	Floor Live Load:	40.0 lb/ft ²	Roof Live Load:	20.0 lb/ft ²		
		Unbraced Length	Top: 0-00	Bottom:	11-11-00		

Design Results:

	Location	Design	Control	Result	LDF	Load Combination
Critical Moment (Pos)	7-08-04	3435.79 lb ft	9060.05 lb ft	Passed - 38%	1.00	D + L
Critical Moment (Neg)	12-02-10	-1502.86 lb ft	9060.05 lb ft	Passed - 17%	1.00	D + L
Critical Shear	2-07	897.43 lb	3460.00 lb	Passed - 26%	1.00	D + L
Live Load Deflection	7-11-07	0-02	0-12 (L/480)	Passed - L/999	-	L
Total Load Deflection	7-10-07	0-02	1-00 (L/240)	Passed - L/999	-	D + L
Max. Reaction			<u>Supported Mtl</u> <u>Supporting Mtl</u>			
	1-06	933.03 lb	2775.00 lb 10390.63 lb	Passed - 34%	1.00	D + L
	15-09-10	689.25 lb	3000.00 lb 15312.57 lb	Passed - 23%	1.00	D + L
	15-09-10	-404.57 lb	0.00 lb -		1.00	D + L

Design Notes:

* Member design assumed proper ply to ply connection by others. Verify connection between plies according to code specification and follow the manufacturer's installation instruction. Loads assumed to be distributed equally to each ply.
*

Loading:

Type	Start	End	Source	Maximum Load Magnitudes			
				Dead	Floor Live	Roof Live	Snow
Uniform	0-00	15-10-06	FC1 Floor Decking	5 lb/ft	19 lb/ft	-	-
Uniform	0-00	12-02-10	FC1 Floor Decking	19 lb/ft	77 lb/ft	-	-
Uniform	12-02-10	15-10-06	FC1 Floor Decking	3 lb/ft	13 lb/ft	-	-
Point	12-02-10	12-02-10	FJ4(i646)	-117.00 lb	117.00/-586.00 lb	-	-

Support Information:

Support	Start	End	Source	Maximum Analysis Reactions			
				Dead	Floor Live	Roof Live	Snow
1	0-00	2-06	W18(i13)	160.00 lb	773.00/-134.00 lb	-	-
2	15-08-10	16-00-02	W19(i19)	48.00 lb	641.00/-452.00 lb	-	-

Errors, Warnings & Notes:

- * The dead loads used in the design of this member were applied to the structure as projected dead loads.
- * The member graphic, dimensions, and locations shown on this report are based on the centerline of the member.
- * Analysis and Design has been performed using precision loading from actual modeled conditions. Some loads may have been modified to simplify reporting.
- * A load bearing wall is supported by the I-joist at a location where the I-joist is supported by a member below. Please see manufacturer installation guidelines for requirements of blocking/squash blocks.

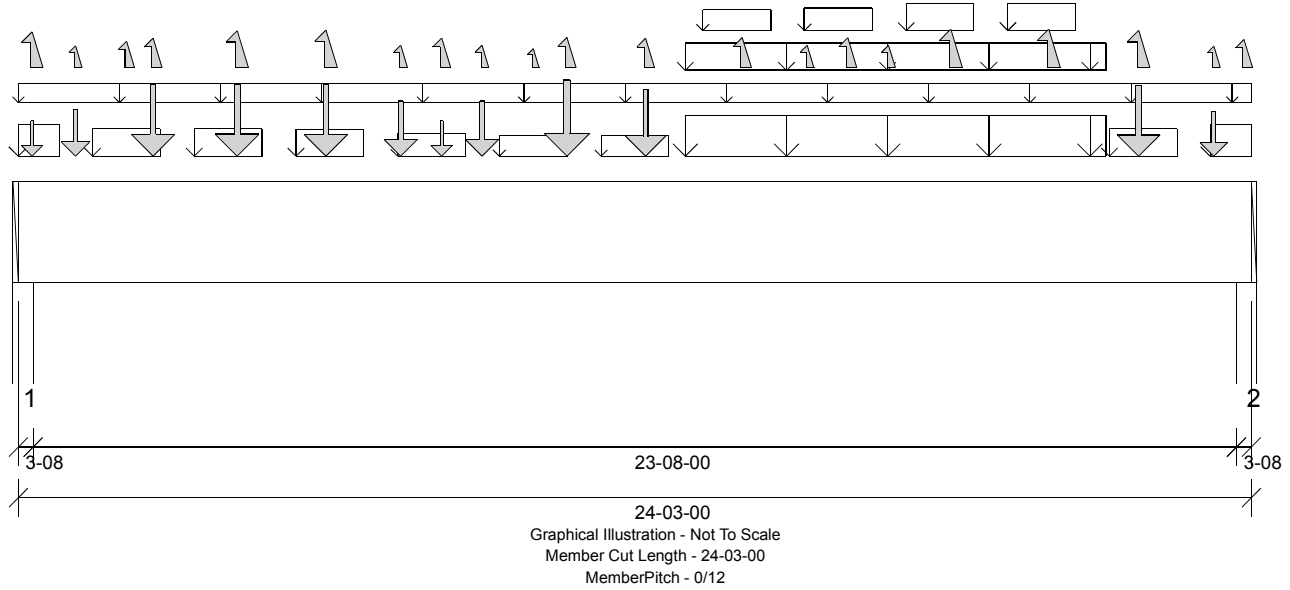

Design Information:

Building Code:	IRC2015	Floor Dead Load:	10.0 lb/ft ²	Roof Dead Load:	10.0 lb/ft ²	Ground Snow Load:	20.0 lb/ft ²
Design Methodology:	ASD	Floor Live Load:	40.0 lb/ft ²	Roof Live Load:	20.0 lb/ft ²		
		Unbraced Length	Top: 0-00	Bottom:	1-04-11		

Design Notes:

- * Member was not designed due to missing strength properties. If possible select a new material or change the orientation of the member.
- *

Loading:

Type	Start	End	Source	Maximum Load Magnitudes			
				Dead	Floor Live	Roof Live	Snow
Self Weight	0-00	24-03-00	Self Weight	24 lb/ft	-	-	-
Uniform	-0-00	24-03-00	FC1 Floor Decking	2 lb/ft	8 lb/ft	-	-
Uniform	-0-00	9-12	W29(i246)	60 lb/ft	-	78 lb/ft	28 lb/ft
Uniform	1-05-08	2-09-08	W29(i246)	52 lb/ft	-	50 lb/ft	15 lb/ft
Uniform	3-05-08	4-09-08	W29(i246)	50 lb/ft	-	49 lb/ft	17 lb/ft
Uniform	5-05-08	6-09-08	W29(i246)	51 lb/ft	-	45 lb/ft	16 lb/ft
Uniform	7-05-08	8-09-08	W29(i246)	37 lb/ft	-	19 lb/ft	-
Uniform	9-05-08	10-09-08	W29(i246)	29 lb/ft	-	-	-
Uniform	11-05-08	12-09-08	W29(i246)	30 lb/ft	-	-	-
Uniform	13-01-07	21-04-12	Smoothed Load	63 lb/ft	286 lb/ft	-	-
Uniform	13-01-07	21-04-12	Smoothed Load	45 lb/ft	-	46 lb/ft	27 lb/ft
Uniform	13-05-08	14-09-08	W29(i246)	29 lb/ft	-	-	-
Uniform	15-05-08	16-09-08	W29(i246)	37 lb/ft	-	19 lb/ft	-
Uniform	17-05-08	18-09-08	W29(i246)	51 lb/ft	-	45 lb/ft	17 lb/ft
Uniform	19-05-08	20-09-08	W29(i246)	50 lb/ft	-	49 lb/ft	17 lb/ft
Uniform	21-05-08	22-09-08	W29(i246)	52 lb/ft	-	50 lb/ft	14 lb/ft
Uniform	23-05-04	24-03-00	W29(i246)	60 lb/ft	-	78 lb/ft	28 lb/ft
Point	3-04	3-04	-	93.00 lb	-	95.00/-5.00 lb	55.00 lb
Point	2-07-13	2-07-13	-	198.00 lb	474.00/-54.00 lb	95.00/-5.00 lb	55.00 lb
Point	8-03-14	8-03-14	-	93.00 lb	-	95.00/-8.00 lb	55.00 lb
Point	12-04-01	12-04-01	-	184.00 lb	417.00/-51.00 lb	95.00/-5.00 lb	55.00 lb
Point	16-03-12	16-03-12	-	-	-	-8.00 lb	-
Point	1-01-08	1-01-08	FJ34(i671)	85.00 lb	363.00/-48.00 lb	-	-
Point	7-06-04	7-06-04	FJ34(i590)	104.00 lb	474.00/-58.00 lb	-	-
Point	9-01-07	9-01-07	FJ34(i591)	104.00 lb	474.00/-58.00 lb	-	-
Point	10-09-08	10-09-08	-	210.00 lb	531.00/-65.00 lb	95.00/-5.00 lb	55.00 lb
Point	15-06-03	15-06-03	FJ34(i647)	-	-58.00 lb	-	-
Point	17-01-06	17-01-06	FJ34(i665)	-	-58.00 lb	-	-
Point	23-06-02	23-06-02	FJ34(i657)	76.00 lb	346.00/-42.00 lb	-	-
Point	2-01-09	2-01-09	W29(i246)	-	-	-	-
Point	4-03-10	4-03-10	-	203.00 lb	474.00/-33.00 lb	95.00/-5.00 lb	55.00 lb
Point	6-00-09	6-00-09	-	197.00 lb	474.00/-58.00 lb	95.00/-5.00 lb	55.00 lb
Point	10-01-09	10-01-09	W29(i246)	-	-	-3.00 lb	-1.00 lb
Point	14-02-14	14-02-14	-	-	-58.00 lb	-8.00 lb	-1.00 lb
Point	18-04-01	18-04-01	-	-	-58.00 lb	-5.00 lb	-
Point	20-03-03	20-03-03	-	-	-58.00 lb	-5.00 lb	-
Point	22-00-06	22-00-06	-	195.00 lb	474.00/-58.00 lb	90.00/-4.00 lb	52.00 lb
Point	24-01-04	24-01-04	W29(i246)	-	-	-	-

Support Information:

Support	Start	End	Source	Maximum Analysis Reactions			
				Dead	Floor Live	Roof Live	Snow
1	0-00	3-08	W17(i114)	2035.00 lb	3516.00/-394.00 lb	886.00/-38.00 lb	444.00 lb

- Transfer reactions may differ from design results as allowed per building codes and standard load distribution practices.

- This report is based on modeled conditions input by the user. Source information for the loads and supports are provided for reference only. Verify that all loads and support conditions are correct.



2

23-11-08

24-03-00

W15(i16)

1966.00 lb

3576.00/-421.00 lb

811.00/-33.00 lb

399.00 lb

Errors, Warnings & Notes:

- * The dead loads used in the design of this member were applied to the structure as projected dead loads.
- * The member graphic, dimensions, and locations shown on this report are based on the centerline of the member.
- * Analysis and Design has been performed using precision loading from actual modeled conditions. Some loads may have been modified to simplify reporting.