



ROOF & FLOOR TRUSSES & BEAMS

Reilly Road Industrial Park
 Fayetteville, N.C. 28309
 Phone: (910) 864-8787
 Fax: (910) 864-4444

Bearing reactions less than or equal to 3000# are deemed to comply with the prescriptive Code requirements. The contractor shall refer to the attached Tables (derived from the prescriptive Code requirements) to determine the minimum foundation size and number of wood studs required to support reactions greater than 3000# but not greater than 15000#. A registered design professional shall be retained to design the support system for any reaction that exceeds those specified in the attached Tables. A registered design professional shall be retained to design the support system for all reactions that exceed 15000#.

Signature Curtis Quick
 Curtis Quick

LOAD CHART FOR JACK STUDS

(BASED ON TABLES R502.5(1) & (b))
 NUMBER OF JACK STUDS REQUIRED @ EA END OF HEADER/GIRDER

END REACTION (UP TO)	REQ'D STUDS FOR (1)PLY HEADER	END REACTION (UP TO)	REQ'D STUDS FOR (2)PLY HEADER	END REACTION (UP TO)	REQ'D STUDS FOR (4)PLY HEADER
1700	1	2550	1	3400	1
3400	2	5100	2	6800	2
5100	3	7650	3	10200	3
6800	4	10200	4	13600	4
8500	5	12750	5	17000	5
10200	6	15300	6		
11900	7				
13600	8				
15300	9				

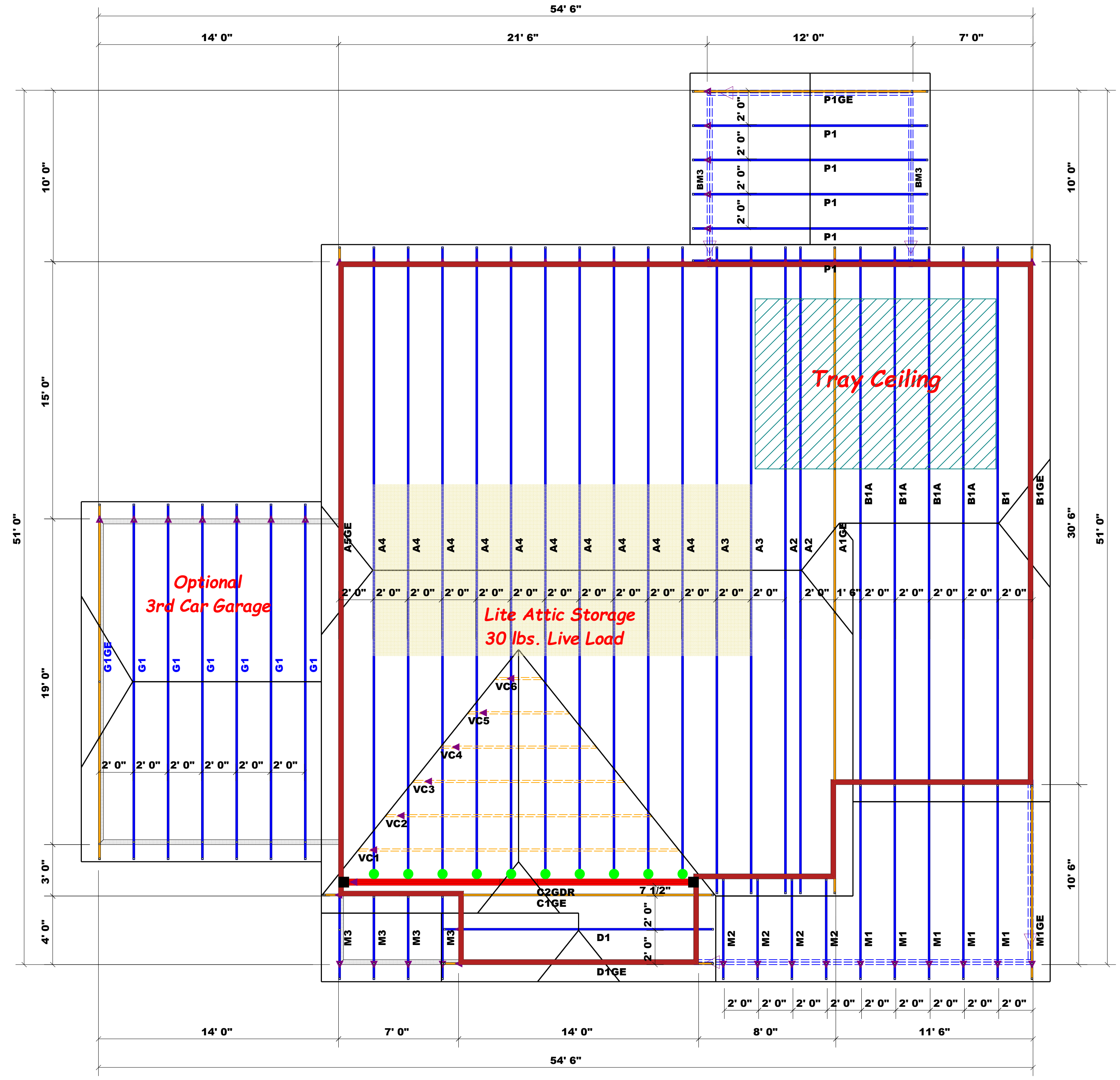

▲ = Denotes Left End of Truss
 (Reference Engineered Truss Drawing)
 Do Not Erect Trusses Backwards

Hatch Legend
 2nd Floor Bearing Walls @ 8' 1-1/2"

Truss Placement Plan
 SCALE: 1/4" = 1'

HANGER LEGEND

	= USP HTW20 x 2 / Tie Down
	= USP HUS26 / Single 2x Hanger

BUILDER	Cates Building, Inc.	CITY / CO.	Cameron / Harnett
JOB NAME	Lot 695 Lexington Plantation	ADDRESS	139 Box Cannon Way
PLAN	CC-2355 / Elev. C / LF2 / RP	MODEL	32000
SEAL DATE	3/24/21	DATE REV.	08/18/21
QUOTE #	Quote #	DRAWN BY	Curtis Quick
JOB #	J0721-4254	SALES REP.	Scot Duncan

THIS IS A TRUSS PLACEMENT DIAGRAM ONLY. These trusses are designed as individual building components to be incorporated into the building design at the specification of the building designer. See individual design sheets for each truss design identified on the placement drawing. The building designer is responsible for temporary and permanent bracing of the roof and floor system and for the overall structure. The design of the truss support structure including headers, beams, walls, and columns is the responsibility of the building designer. For general guidance regarding bracing, consult BCSI-B1 and BCSI-B3 provided with the truss delivery package or online @ sbcindustry.com