



Initial Application Date: 9/2/2021

Application # _____

CU# _____

COUNTY OF HARNETT RESIDENTIAL LAND USE APPLICATION

Central Permitting 420 McKinney Pkwy, Lillington, NC 27546 Phone: (910) 893-7525 ext:1 Fax: (910) 893-2793 www.harnett.org/permits

A RECORDED SURVEY MAP, RECORDED DEED (OR OFFER TO PURCHASE) & SITE PLAN ARE REQUIRED WHEN SUBMITTING A LAND USE APPLICATION

LANDOWNER: XCESSIVE RISK DEVELOPMENT Mailing Address: PO BOX 4580

City: EMERALD ISLE State: NC Zip: 28594 Contact No: 919-795-9594 Email: ATHAN.PARKER@AMPENGINEERING.COM

APPLICANT*: _____ Mailing Address: _____

City: _____ State: _____ Zip: _____ Contact No: _____ Email: _____

*Please fill out applicant information if different than landowner

ADDRESS: HAVEN LOT 22 PIN: 9597-39-7918.000

Zoning: _____ Flood: _____ Watershed: _____ Deed Book / Page: _____

Setbacks - Front: _____ Back: _____ Side: _____ Corner: _____

PROPOSED USE:

[X] SFD: (Size ___x___) # Bedrooms: 4 # Baths: ___ Basement(w/wo bath): ___ Garage: ___ Deck: ___ Crawl Space: ___ Slab: ___ Slab: ___ Monolithic
TOTAL HTD SQ FT GARAGE SQ FT (Is the bonus room finished? () yes () no w/ a closet? () yes () no (if yes add in with # bedrooms)

[] Modular: (Size ___x___) # Bedrooms ___ # Baths ___ Basement (w/wo bath) ___ Garage: ___ Site Built Deck: ___ On Frame ___ Off Frame ___
TOTAL HTD SQ FT (Is the second floor finished? () yes () no Any other site built additions? () yes () no

[] Manufactured Home: ___ SW ___ DW ___ TW (Size ___x___) # Bedrooms: ___ Garage: ___ (site built? ___) Deck: ___ (site built? ___)

[] Duplex: (Size ___x___) No. Buildings: _____ No. Bedrooms Per Unit: _____ TOTAL HTD SQ FT

[] Home Occupation: # Rooms: _____ Use: _____ Hours of Operation: _____ #Employees: _____

[] Addition/Accessory/Other: (Size ___x___) Use: _____ Closets in addition? () yes () no
TOTAL HTD SQ FT GARAGE

Water Supply: [X] County _____ Existing Well _____ New Well (# of dwellings using well _____) *Must have operable water before final
(Need to Complete New Well Application at the same time as New Tank)

Sewage Supply: [X] New Septic Tank _____ Expansion _____ Relocation _____ Existing Septic Tank _____ County Sewer
(Complete Environmental Health Checklist on other side of application if Septic)

Does owner of this tract of land, own land that contains a manufactured home within five hundred feet (500') of tract listed above? () yes ([X]) no

Does the property contain any easements whether underground or overhead ([X]) yes () no

Structures (existing or proposed): Single family dwellings: 1 Manufactured Homes: _____ Other (specify): _____

If permits are granted I agree to conform to all ordinances and laws of the State of North Carolina regulating such work and the specifications of plans submitted. I hereby state that foregoing statements are accurate and correct to the best of my knowledge. Permit subject to revocation if false information is provided.

Signature of Owner or Owner's Agent [Signature] Date

It is the owner/applicants responsibility to provide the county with any applicable information about the subject property, including but not limited to: boundary information, house location, underground or overhead easements, etc. The county or its employees are not responsible for any incorrect or missing information that is contained within these applications.

*This application expires 6 months from the initial date if permits have not been issued**

APPLICATION CONTINUES ON BACK

strong roots • new growth

****This application expires 6 months from the initial date if permits have not been issued****

This application to be filled out when applying for a septic system inspection.

County Health Department Application for Improvement Permit and/or Authorization to Construct

IF THE INFORMATION IN THIS APPLICATION IS FALSIFIED, CHANGED, OR THE SITE IS ALTERED, THEN THE IMPROVEMENT PERMIT OR AUTHORIZATION TO CONSTRUCT SHALL BECOME INVALID. The permit is valid for either 60 months or without expiration depending upon documentation submitted. (Complete site plan = 60 months; Complete plat = without expiration)

Environmental Health New Septic System

- **All property irons must be made visible.** Place "pink property flags" on each corner iron of lot. All property lines must be clearly flagged approximately every 50 feet between corners.
- Place "orange house corner flags" at each corner of the proposed structure. Also flag driveways, garages, decks, out buildings, swimming pools, etc. Place flags per site plan developed at/for Central Permitting.
- Place orange Environmental Health card in location that is easily viewed from road to assist in locating property.
- If property is thickly wooded, Environmental Health requires that you clean out the **undergrowth** to allow the soil evaluation to be performed. Inspectors should be able to walk freely around site. **Do not grade property.**
- **All lots to be addressed within 10 business days after confirmation. \$25.00 return trip fee may be incurred for failure to uncover outlet lid, mark house corners and property lines, etc. once lot confirmed ready.**

Environmental Health Existing Tank Inspections

- Follow above instructions for placing flags and card on property.
- Prepare for inspection by removing soil over **outlet end** of tank as diagram indicates, and lift lid straight up (*if possible*) and then **put lid back in place.** (Unless inspection is for a septic tank in a mobile home park)
- **DO NOT LEAVE LIDS OFF OF SEPTIC TANK**

"MORE INFORMATION MAY BE REQUIRED TO COMPLETE ANY INSPECTION"

SEPTIC

If applying for authorization to construct please indicate desired system type(s): can be ranked in order of preference, must choose one.

{ } Accepted { } Innovative { } Conventional { } Any
 { } Alternative { } Other _____

The applicant shall notify the local health department upon submittal of this application if any of the following apply to the property in question. If the answer is "yes", applicant **MUST ATTACH SUPPORTING DOCUMENTATION**:

- { } YES { } NO Does the site contain any Jurisdictional Wetlands?
- { } YES { } NO Do you plan to have an irrigation system now or in the future?
- { } YES { } NO Does or will the building contain any drains? Please explain. _____
- { } YES { } NO Are there any existing wells, springs, waterlines or Wastewater Systems on this property?
- { } YES { } NO Is any wastewater going to be generated on the site other than domestic sewage?
- { } YES { } NO Is the site subject to approval by any other Public Agency?
- { } YES { } NO Are there any Easements or Right of Ways on this property?
- { } YES { } NO Does the site contain any existing water, cable, phone or underground electric lines?
 If yes please call No Cuts at 800-632-4949 to locate the lines. This is a free service.

I Have Read This Application And Certify That The Information Provided Herein Is True, Complete And Correct. Authorized County And State Officials Are Granted Right Of Entry To Conduct Necessary Inspections To Determine Compliance With Applicable Laws And Rules. I Understand That I Am Solely Responsible For The Proper Identification And Labeling Of All Property Lines And Corners And Making The Site Accessible So That A Complete Site Evaluation Can Be Performed.



DEPARTMENT OF HEALTH AND HUMAN SERVICES
DIVISION OF PUBLIC HEALTH

ROY COOPER
GOVERNOR

MANDY COHEN, MD, MPH
SECRETARY

DANIEL STALEY
DIRECTOR

COMMON FORM FOR ENGINEERED OPTION PERMIT
See Instructions for Use in Appendix A

Except for "Date received", this Section to be completed by the Professional Engineer licensed in accordance with G.S. 89C

LHD USE ONLY: Initial submittal of this NOI received: _____ by _____
Date Initials

PART 1: Notice of Intent to Construct (NOI)

- New Expansion
 Repair – LHD Permit Number _____ Repair – EOP Permit Number _____

1. Facility Owner's name: (Owner, Company Name, Utility, Partnership, Individual, etc.): _____
XCESSIVE RISK DEVELOPMENT

Mailing address: PO BOX 4580 City: EMERALD ISLE State: NC Zip: 28594
Telephone number: 919-795-9594 E-mail Address: ATHAN.PARKER@AMPDENGINEERING.COM

2. Professional Engineer (PE) name: ATHAN M PARKER, PE License number: 43250

Mailing address: PO BOX 4580 City: EMERALD ISLE State: NC Zip: 28594
Telephone number: 919-795-9594 E-mail Address: ATHAN.PARKER@AMPDENGINEERING.COM

3. Licensed Soil Scientist (LSS) name: HAYWOOD PITTMAN, LSS License number: 1262

Mailing address: 1073-1 GREGORY FORK RD City: RICHLANDS State: NC Zip: 28574
Telephone number: 910-324-2892 E-mail Address: PITTMANSOIL@YAHOO.COM

4. Licensed Geologist (LG) (if applicable) name: _____ License Number: _____

Mailing address: _____ City: _____ State: _____ Zip: _____
Telephone number: _____ E-mail Address: _____

5. On-site Wastewater Contractor name: HAYWOOD PITTMAN, LSS License number: 3825

Mailing address: 1073-1 GREGORY FORK RD City: RICHLANDS State: NC Zip: 28574
Telephone number: 910-324-2892 E-mail Address: PITTMANSOIL@YAHOO.COM

6. Proof of Errors and Omissions or other appropriate liability insurance for the following persons is attached that includes the name of the insurer, name of the insured and the effective dates of coverage:

- PE LSS LG On-site Wastewater Contractor

7. Property location (physical address, tax parcel identification number or subdivision lot, block number of the property to be permitted): PIN: 9597-39-7918.000
~~PORTION OF PARCEL: 9597-49-3461.000~~; LOT 22

County Name: HARNETT

8. Type of facility: Place of residence No. Bedrooms: 4 No. Occupants: 8
 Place of business Basis for flow calculation: _____
 Place of public assembly Basis for flow calculation: _____

9. Factors that would affect the wastewater load: NO KNOWN FACTORS TO AFFECT LOADING

10. Type, location, and classification (per Rule .1961) of wastewater system: 4-75' 25% REDUCTION, TYPE IIIg, 12-18" TB; LOCATED 148' FROM EAST BOUNDARY LINE AND 21' FROM THE SOUTH BOUNDARY LINE (LOCATED WEST OF PROPOSED HOME)

11. Design wastewater flow: 480 gpd (For flow > 3,000 gpd and industrial process, duplicate plans shall be sent to the State.)

Design wastewater strength: domestic high strength industrial process

12. A plat as defined in G.S. 130A 334(7a) is attached: Yes No

13. Owner meets requirements of ownership or control of the system per 15A NCAC 18A .1938(j): Yes No

14. Easement, right of way or encroachment agreement required per 15A NCAC 18A .1938(j): Yes No
If yes, documentation filed in _____ County Register of Deeds in Deed book _____ Page _____

15. Multi-party agreements required, as applicable, pursuant to 15A NCAC 18A .1937(h): Yes No
If yes, agreements filed in _____ County Register of Deeds in Deed book _____ Page _____

16. Location of proposed or existing wells (drinking water, irrigation, geothermal, groundwater monitoring, sampling, etc.) and any potable and non-potable water conveyance lines is indicated on attached plans and complies with 15A NCAC 18A .1950: Yes No

This is a saprolite system. Yes No

17. Evaluation(s) of soil conditions and site features in accordance with G.S. 130A-335(a1) signed and sealed by a LSS is attached: Yes No

18. Evaluation of geologic and hydrogeologic conditions signed and sealed by a LG is attached Yes NA

19. Proposed landscape, site, drainage, or soil modifications are attached: Yes NA

Attestation by Professional Engineer licensed in North Carolina pursuant to G.S. 89C

I, ATHAN M PARKER, PE hereby attest that the information required to be included with
Registered Professional Engineer (Print Name)

this Notice of Intent to Construct is accurate and complete to the best of my knowledge and that the proposed system shall meet applicable federal, State, and local laws, regulations, rules and ordinances in accordance with G.S. 130A-336-.1(e)(6).

DN: o=ATHAN M. PARKER, PE, c=US, o=AMPD
ENGINEERING, PLLC,
email=ATHAN.PARKER@AMPDENGINEERING.COM,
Date: 2021.08.12 12:00:56 -0400

Signature of Licensed Professional Engineer

Date



This section is for Owner use to either designate PE as their legal representative or to self-submit the NOI.

Designation of Registered Professional Engineer as legal representative of Owner for this Notice of Intent:

I, ATHAN PARKER FOR XCESSIVE RISK DEVELOPMENT hereby designate ATHAN M PARKER, PE

Print Name of Owner

Print Name of Registered Professional Engineer

as my legal representative for purposes of this Notice of Intent pursuant to G.S. 130A-336.1.

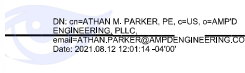
Signature of Owner   _____
Date

Owner self-submittal of NOI:

I, _____ hereby submit this NOI prepared by _____

Print Name of Owner

Print Name of Licensed PE

pursuant to G.S. 130A-336.1.

Signature of Owner _____
Date

NOTES:

LIABILITY: *The Department, the Department’s authorized agents or local health departments shall have no liability for wastewater systems designed, constructed and installed pursuant to an Engineered Option Permit. [(NC General Statute 130A-336.1(f))]*

RIGHT OF ENTRY: *The submittal of this Notice of Intent to Construct grants right of entry to the Local Health Department and the State to the referenced property.*

ISSUANCE OF BUILDING PERMIT: Once the LHD deems that the Notice of Intent to Construct is complete via signature in the section above, the owner may apply to the local permitting agency for a permit for electrical, plumbing, heating, air conditioning or other construction, location or relocation activity under any provision of general or special law pursuant to G.S. 130A-338.

This section for Local Health Department use only.

PART 2: LHD Completeness Review of the Notice of Intent to Construct

“(c) Completeness Review for Notice of Intent to Construct. – The local health department shall determine whether a notice of intent to construct, as required pursuant subsection (b) of this section, is complete within 15 business days after the local health department receives the notice of intent to construct. A determination of completeness means that the notice of intent to construct includes all of the required components. If the local health department determines that the notice of intent to construct is incomplete, the department shall notify the owner or the professional engineer of the components needed to complete the notice. The owner or professional engineer may submit additional information to the department to cure the deficiencies in the notice. The local health department shall make a final determination as to whether the notice of intent to construct is complete within 10 business days after the department receives the additional information from the owner or professional engineer. If the department fails to act within any time period set out in this subsection, the owner or professional engineer may treat the failure to act as a determination of completeness.”

The review for completeness of this Notice of Intent was conducted in accordance with G.S. 130A-336.1(c). This NOI is determined to be:

INCOMPLETE (If box is checked, Information in this section is required.)

Based upon review of information submitted by the PE in Part 1, the following items are missing: _____

Copies of this form listing missing items were sent to the design PE and the Owner on _____

via _____ with directions to re-submit missing items using Page 5 of this form.

Email, FAX, USPS, hand-delivered

Print Name of Authorized Agent of the LHD

Signature of Authorized Agent of the LHD

Date

COMPLETE (If box is checked, information in this section is required.)

Based upon review of information submitted by the PE in Part 1 of this form, this NOI is deemed COMPLETE.

Copies of this signed form were sent to the design PE and the Owner on _____ via _____.

A copy of this NOI and tracking information was sent to the State on _____ via _____.

Print Name of Authorized Agent of the LHD

Signature of Authorized Agent of the LHD

Date

Owner: HAVEN S/D
 Address: LOT 22
 Location: PLACID POND DRIVE

PITTMAN SOIL CONSULTING
PO BOX 1387
RICHLANDS, NC 28574
910-330-2784
pittmansoil@yahoo.com

LOT INFORMATION OBTAINED FROM PLAT BY STANCIL AND ASSOCIATES FOR XCESSIVE RISK DEVELOPMENT.

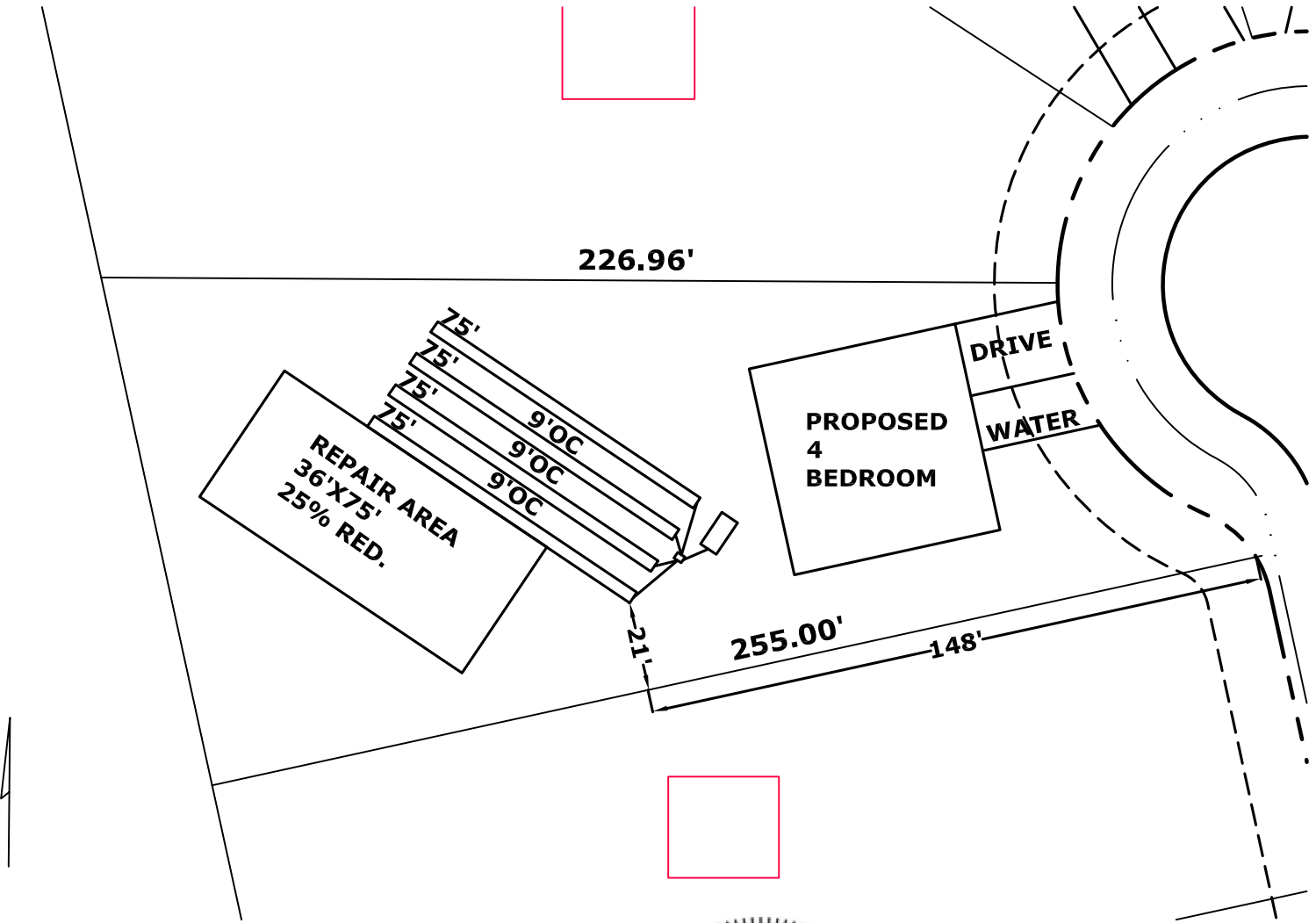

Athan M. Parker

DN: c:\ATHAN M. PARKER, PE, c.US, c.AMP
 ENGINEERING, PLLC.
 email=ATHAN.PARKER@AMPEENGINEERING.COM
 Date: 2021.08.12 12:51:25 -4'00'

- INITIAL**
- 4 BEDROOM
- LTAR .4
- 4-75' 25% REDUCTION
- 12-18" TB
- >6" SOIL COVER REQUIRED OVER SYSTEM AND 5' BEYOND SYSTEM
- REPAIR AREA**
- 4 BEDROOM
- LTAR .4
- 4-75' 25% REDUCTION
- 12-18" TB
- >6" SOIL COVER REQUIRED OVER SYSTEM AND 5' BEYOND SYSTEM



SCALE 1"=40'

Pittman Soil Consulting

*1003 Gregory Fork Road
Richlands, NC 28574
Phone (910)330-2784
pittmansoil@yahoo.com*

JULY 26, 2021

Ref: HAVEN Lot 22, HARNETTCOUNTY

Dear Sir,

A soil evaluation was conducted on the above referenced tract to determine the sites suitability for septic. The current laws and rules of NC was used as guide for this evaluation.

Hand Auger borings on the site were used to characterize the soil texture, and depth to the soil wetness condition. The attached plot plan shows the location of the septic system in the most ideal location on the site. The soil wetness condition was found to be 24-30" from the surface with a clay loam texture. I have assigned an LTAR of 0.4 gpd/sqft for a 480 gpd 4 bedroom residence. This will require the installation of 4-75' 25% reduction lines that shall be installed in accordance with the current rules. The depth to soil wetness of 24-30" would constitute a 12-18" trench bottom. The system will require 6" soil cover that shall extend 5' from the edge of the system. The system will require a 1000 gallon septic tank.

The repair area will require 4-75' 25% reduction lines installed at a depth of 12-18" from the surface (LTAR 0.4).

After installation the site should be landscaped to shed surface water. Any alterations to the site may impact soil conditions.

If you have any questions please feel free to contact me at 910-330-2784. Thank You.

Sincerely,



**R. HAYWOOD
PITTMAN II**

Digitally signed by R. HAYWOOD
PITTMAN II
DN: cn=R. HAYWOOD PITTMAN II,
o=PITTMAN SOIL CONSULTING, ou,
email=pittmansoil@yahoo.com,
c=US
Date: 2021.08.02 05:31:09 -04'00'

R. Haywood Pittman II
NC Licensed Soil Scientist

