



Initial Application Date: 9/2/2021

Application # \_\_\_\_\_

CU# \_\_\_\_\_

**COUNTY OF HARNETT RESIDENTIAL LAND USE APPLICATION**

Central Permitting 420 McKinney Pkwy, Lillington, NC 27546 Phone: (910) 893-7525 ext:1 Fax: (910) 893-2793 www.harnett.org/permits

**\*\*A RECORDED SURVEY MAP, RECORDED DEED (OR OFFER TO PURCHASE) & SITE PLAN ARE REQUIRED WHEN SUBMITTING A LAND USE APPLICATION\*\***

LANDOWNER: XCESSIVE RISK DEVELOPMENT Mailing Address: PO BOX 4580

City: EMERALD ISLE State: NC Zip: 28594 Contact No: 919-795-9594 Email: ATHAN.PARKER@AMPENGINEERING.COM

APPLICANT\*: \_\_\_\_\_ Mailing Address: \_\_\_\_\_

City: \_\_\_\_\_ State: \_\_\_\_\_ Zip: \_\_\_\_\_ Contact No: \_\_\_\_\_ Email: \_\_\_\_\_

\*Please fill out applicant information if different than landowner

ADDRESS: HAVEN LOT 5 PIN: 9597-48-0625.000

Zoning: \_\_\_\_\_ Flood: \_\_\_\_\_ Watershed: \_\_\_\_\_ Deed Book / Page: \_\_\_\_\_

Setbacks – Front: \_\_\_\_\_ Back: \_\_\_\_\_ Side: \_\_\_\_\_ Corner: \_\_\_\_\_

**PROPOSED USE:**

SFD: (Size \_\_\_\_\_ x \_\_\_\_\_) # Bedrooms: 4 # Baths: \_\_\_\_\_ Basement(w/wo bath): \_\_\_\_\_ Garage: \_\_\_\_\_ Deck: \_\_\_\_\_ Crawl Space: \_\_\_\_\_ Slab: \_\_\_\_\_ Slab: \_\_\_\_\_ Monolithic  
**TOTAL HTD SQ FT** **GARAGE SQ FT** (Is the bonus room finished? ( ) yes ( ) no w/ a closet? ( ) yes ( ) no (if yes add in with # bedrooms)

Modular: (Size \_\_\_\_\_ x \_\_\_\_\_) # Bedrooms \_\_\_\_\_ # Baths \_\_\_\_\_ Basement (w/wo bath) \_\_\_\_\_ Garage: \_\_\_\_\_ Site Built Deck: \_\_\_\_\_ On Frame \_\_\_\_\_ Off Frame \_\_\_\_\_  
**TOTAL HTD SQ FT** (Is the second floor finished? ( ) yes ( ) no Any other site built additions? ( ) yes ( ) no

Manufactured Home: \_\_\_\_\_ SW \_\_\_\_\_ DW \_\_\_\_\_ TW (Size \_\_\_\_\_ x \_\_\_\_\_) # Bedrooms: \_\_\_\_\_ Garage: \_\_\_\_\_ (site built? ) Deck: \_\_\_\_\_ (site built? )

Duplex: (Size \_\_\_\_\_ x \_\_\_\_\_) No. Buildings: \_\_\_\_\_ No. Bedrooms Per Unit: \_\_\_\_\_ **TOTAL HTD SQ FT**

Home Occupation: # Rooms: \_\_\_\_\_ Use: \_\_\_\_\_ Hours of Operation: \_\_\_\_\_ #Employees: \_\_\_\_\_

Addition/Accessory/Other: (Size \_\_\_\_\_ x \_\_\_\_\_) Use: \_\_\_\_\_ Closets in addition? ( ) yes ( ) no  
**TOTAL HTD SQ FT** **GARAGE**

Water Supply:  County \_\_\_\_\_ Existing Well \_\_\_\_\_ New Well (# of dwellings using well \_\_\_\_\_) **\*Must have operable water before final (Need to Complete New Well Application at the same time as New Tank)**

Sewage Supply:  New Septic Tank \_\_\_\_\_ Expansion \_\_\_\_\_ Relocation \_\_\_\_\_ Existing Septic Tank \_\_\_\_\_ County Sewer  
**(Complete Environmental Health Checklist on other side of application if Septic)**

Does owner of this tract of land, own land that contains a manufactured home within five hundred feet (500') of tract listed above? ( ) yes (  ) no

Does the property contain any easements whether underground or overhead (  ) yes ( ) no

Structures (existing or proposed): Single family dwellings: 1 Manufactured Homes: \_\_\_\_\_ Other (specify): \_\_\_\_\_

If permits are granted I agree to conform to all ordinances and laws of the State of North Carolina regulating such work and the specifications of plans submitted. I hereby state that foregoing statements are accurate and correct to the best of my knowledge. Permit subject to revocation if false information is provided.

Signature of Owner or Owner's Agent

DN: cn=ATHAN M. PARKER, PE, c=US, o=AMPD ENGINEERING, PLLC, email=ATHAN.PARKER@AMPENGINEERING.COM Date: 2021.09.02 12:45:15 -0400

Date

**\*\*\*It is the owner/applicants responsibility to provide the county with any applicable information about the subject property, including but not limited to: boundary information, house location, underground or overhead easements, etc. The county or its employees are not responsible for any incorrect or missing information that is contained within these applications.\*\*\***

**\*This application expires 6 months from the initial date if permits have not been issued\*\***

**APPLICATION CONTINUES ON BACK**

strong roots • new growth

**\*\*This application expires 6 months from the initial date if permits have not been issued\*\***

**\*This application to be filled out when applying for a septic system inspection.\***

**County Health Department Application for Improvement Permit and/or Authorization to Construct**

IF THE INFORMATION IN THIS APPLICATION IS FALSIFIED, CHANGED, OR THE SITE IS ALTERED, THEN THE IMPROVEMENT PERMIT OR AUTHORIZATION TO CONSTRUCT SHALL BECOME INVALID. The permit is valid for either 60 months or without expiration depending upon documentation submitted. (Complete site plan = 60 months; Complete plat = without expiration)

**Environmental Health New Septic System**

- **All property irons must be made visible.** Place "pink property flags" on each corner iron of lot. All property lines must be clearly flagged approximately every 50 feet between corners.
- Place "orange house corner flags" at each corner of the proposed structure. Also flag driveways, garages, decks, out buildings, swimming pools, etc. Place flags per site plan developed at/for Central Permitting.
- Place orange Environmental Health card in location that is easily viewed from road to assist in locating property.
- If property is thickly wooded, Environmental Health requires that you clean out the **undergrowth** to allow the soil evaluation to be performed. Inspectors should be able to walk freely around site. **Do not grade property.**
- **All lots to be addressed within 10 business days after confirmation. \$25.00 return trip fee may be incurred for failure to uncover outlet lid, mark house corners and property lines, etc. once lot confirmed ready.**

**Environmental Health Existing Tank Inspections**

- Follow above instructions for placing flags and card on property.
- Prepare for inspection by removing soil over **outlet end** of tank as diagram indicates, and lift lid straight up (*if possible*) and then **put lid back in place.** (Unless inspection is for a septic tank in a mobile home park)
- **DO NOT LEAVE LIDS OFF OF SEPTIC TANK**

**"MORE INFORMATION MAY BE REQUIRED TO COMPLETE ANY INSPECTION"**

**SEPTIC**

If applying for authorization to construct please indicate desired system type(s): can be ranked in order of preference, must choose one.

{  } Accepted      {  } Innovative      {  } Conventional      {  } Any  
 {  } Alternative      {  } Other \_\_\_\_\_

The applicant shall notify the local health department upon submittal of this application if any of the following apply to the property in question. If the answer is "yes", applicant **MUST ATTACH SUPPORTING DOCUMENTATION**:

- {  } YES    {  } NO    Does the site contain any Jurisdictional Wetlands?
- {  } YES    {  } NO    Do you plan to have an irrigation system now or in the future?
- {  } YES    {  } NO    Does or will the building contain any drains? Please explain. \_\_\_\_\_
- {  } YES    {  } NO    Are there any existing wells, springs, waterlines or Wastewater Systems on this property?
- {  } YES    {  } NO    Is any wastewater going to be generated on the site other than domestic sewage?
- {  } YES    {  } NO    Is the site subject to approval by any other Public Agency?
- {  } YES    {  } NO    Are there any Easements or Right of Ways on this property?
- {  } YES    {  } NO    Does the site contain any existing water, cable, phone or underground electric lines?  
 If yes please call No Cuts at 800-632-4949 to locate the lines. This is a free service.

**I Have Read This Application And Certify That The Information Provided Herein Is True, Complete And Correct. Authorized County And State Officials Are Granted Right Of Entry To Conduct Necessary Inspections To Determine Compliance With Applicable Laws And Rules. I Understand That I Am Solely Responsible For The Proper Identification And Labeling Of All Property Lines And Corners And Making The Site Accessible So That A Complete Site Evaluation Can Be Performed.**



DEPARTMENT OF HEALTH AND HUMAN SERVICES
DIVISION OF PUBLIC HEALTH

ROY COOPER
GOVERNOR

MANDY COHEN, MD, MPH
SECRETARY

DANIEL STALEY
DIRECTOR

COMMON FORM FOR ENGINEERED OPTION PERMIT
See Instructions for Use in Appendix A

Except for "Date received", this Section to be completed by the Professional Engineer licensed in accordance with G.S. 89C

LHD USE ONLY: Initial submittal of this NOI received: \_\_\_\_\_ by \_\_\_\_\_
Date Initials

PART 1: Notice of Intent to Construct (NOI)

- [X] New [ ] Expansion
[ ] Repair - LHD Permit Number \_\_\_\_\_ [ ] Repair - EOP Permit Number \_\_\_\_\_

1. Facility Owner's name: (Owner, Company Name, Utility, Partnership, Individual, etc.): \_\_\_\_\_
XCESSIVE RISK DEVELOPMENT

Mailing address: PO BOX 4580 City: EMERALD ISLE State: NC Zip: 28594
Telephone number: 919-795-9594 E-mail Address: ATHAN.PARKER@AMPDENGINEERING.COM

2. Professional Engineer (PE) name: ATHAN M PARKER, PE License number: 43250

Mailing address: PO BOX 4580 City: EMERALD ISLE State: NC Zip: 28594
Telephone number: 919-795-9594 E-mail Address: ATHAN.PARKER@AMPDENGINEERING.COM

3. Licensed Soil Scientist (LSS) name: HAYWOOD PITTMAN, LSS License number: 1262

Mailing address: 1073-1 GREGORY FORK RD City: RICHLANDS State: NC Zip: 28574
Telephone number: 910-324-2892 E-mail Address: PITTMANSOIL@YAHOO.COM

4. Licensed Geologist (LG) (if applicable) name: License Number:

Mailing address: City: State: Zip:
Telephone number: E-mail Address:

5. On-site Wastewater Contractor name: HAYWOOD PITTMAN, LSS License number: 3825

Mailing address: 1073-1 GREGORY FORK RD City: RICHLANDS State: NC Zip: 28574
Telephone number: 910-324-2892 E-mail Address: PITTMANSOIL@YAHOO.COM

6. Proof of Errors and Omissions or other appropriate liability insurance for the following persons is attached
that includes the name of the insurer, name of the insured and the effective dates of coverage:

- [X] PE [X] LSS [ ] LG [X] On-site Wastewater Contractor

- 7. Property location (physical address, tax parcel identification number or subdivision lot, block number of the property to be permitted): PIN: 9597-48-0625.000  
~~PORTION OF PARCEL: 9597-49-3461.000~~; LOT 5
- County Name: HARNETT
- 8. Type of facility:  Place of residence No. Bedrooms: 4 No. Occupants: 8  
 Place of business Basis for flow calculation: \_\_\_\_\_  
 Place of public assembly Basis for flow calculation: \_\_\_\_\_
- 9. Factors that would affect the wastewater load: NO KNOWN FACTORS TO AFFECT LOADING
- 10. Type, location, and classification (per Rule .1961) of wastewater system: 6-67' 25% REDUCTION, TYPE IIIG, 12-18" TB; LOCATED 146' FROM EAST PROPERTY CORNER AND 10' FROM THE SOUTH BOUNDARY LINE (LOCATED WEST OF PROPOSED HOME)
- 11. Design wastewater flow: 480 gpd (For flow > 3,000 gpd and industrial process, duplicate plans shall be sent to the State.)  
Design wastewater strength:  domestic  high strength  industrial process
- 12. A plat as defined in G.S. 130A 334(7a) is attached:  Yes  No
- 13. Owner meets requirements of ownership or control of the system per 15A NCAC 18A .1938(j):  Yes  No
- 14. Easement, right of way or encroachment agreement required per 15A NCAC 18A .1938(j):  Yes  No  
If yes, documentation filed in \_\_\_\_\_ County Register of Deeds in Deed book \_\_\_\_\_ Page \_\_\_\_\_
- 15. Multi-party agreements required, as applicable, pursuant to 15A NCAC 18A .1937(h):  Yes  No  
If yes, agreements filed in \_\_\_\_\_ County Register of Deeds in Deed book \_\_\_\_\_ Page \_\_\_\_\_
- 16. Location of proposed or existing wells (drinking water, irrigation, geothermal, groundwater monitoring, sampling, etc.) and any potable and non-potable water conveyance lines is indicated on attached plans and complies with 15A NCAC 18A .1950:  Yes  No  
This is a saprolite system.  Yes  No
- 17. Evaluation(s) of soil conditions and site features in accordance with G.S. 130A-335(a1) signed and sealed by a LSS is attached:  Yes  No
- 18. Evaluation of geologic and hydrogeologic conditions signed and sealed by a LG is attached  Yes  NA
- 19. Proposed landscape, site, drainage, or soil modifications are attached:  Yes  NA

**Attestation by Professional Engineer licensed in North Carolina pursuant to G.S. 89C**

I, ATHAN M PARKER, PE hereby attest that the information required to be included with  
*Registered Professional Engineer (Print Name)*  
this Notice of Intent to Construct is accurate and complete to the best of my knowledge and that the proposed system shall meet applicable federal, State, and local laws, regulations, rules and ordinances in accordance with G.S. 130A-336-.1(e)(6).

   
DN: cn=ATHAN M. PARKER, PE, c=US, o=AMPD  
ENGINEERING, PLLC  
email=ATHAN.PARKER@AMPDENGINEERING.COM  
Date: 2021.08.12 11:21:35 -0400

\_\_\_\_\_  
*Signature of Licensed Professional Engineer*

\_\_\_\_\_  
*Date*



**This section is for Owner use to either designate PE as their legal representative or to self-submit the NOI.**

**Designation of Registered Professional Engineer as legal representative of Owner for this Notice of Intent:**

I, ATHAN PARKER FOR XCESSIVE RISK DEVELOPMENT hereby designate ATHAN M PARKER, PE

*Print Name of Owner*

*Print Name of Registered Professional Engineer*

as my legal representative for purposes of this Notice of Intent pursuant to G.S. 130A-336.1.

\_\_\_\_\_  
*Signature of Owner*   *Date*

**Owner self-submittal of NOI:**

I, \_\_\_\_\_ hereby submit this NOI prepared by \_\_\_\_\_

*Print Name of Owner*

*Print Name of Licensed PE*

pursuant to G.S. 130A-336.1.

\_\_\_\_\_  
*Signature of Owner* *Date*

**NOTES:**

**LIABILITY:** *The Department, the Department’s authorized agents or local health departments shall have no liability for wastewater systems designed, constructed and installed pursuant to an Engineered Option Permit. [(NC General Statute 130A-336.1(f))]*

**RIGHT OF ENTRY:** *The submittal of this Notice of Intent to Construct grants right of entry to the Local Health Department and the State to the referenced property.*

**ISSUANCE OF BUILDING PERMIT:** Once the LHD deems that the Notice of Intent to Construct is complete via signature in the section above, the owner may apply to the local permitting agency for a permit for electrical, plumbing, heating, air conditioning or other construction, location or relocation activity under any provision of general or special law pursuant to G.S. 130A-338.

***This section for Local Health Department use only.***

**PART 2: LHD Completeness Review of the Notice of Intent to Construct**

*“(c) Completeness Review for Notice of Intent to Construct. – The local health department shall determine whether a notice of intent to construct, as required pursuant subsection (b) of this section, is complete within 15 business days after the local health department receives the notice of intent to construct. A determination of completeness means that the notice of intent to construct includes all of the required components. If the local health department determines that the notice of intent to construct is incomplete, the department shall notify the owner or the professional engineer of the components needed to complete the notice. The owner or professional engineer may submit additional information to the department to cure the deficiencies in the notice. The local health department shall make a final determination as to whether the notice of intent to construct is complete within 10 business days after the department receives the additional information from the owner or professional engineer. If the department fails to act within any time period set out in this subsection, the owner or professional engineer may treat the failure to act as a determination of completeness.”*

The review for completeness of this Notice of Intent was conducted in accordance with G.S. 130A-336.1(c). This NOI is determined to be:

INCOMPLETE (If box is checked, Information in this section is required.)

Based upon review of information submitted by the PE in Part 1, the following items are missing: \_\_\_\_\_

Copies of this form listing missing items were sent to the design PE and the Owner on \_\_\_\_\_

via \_\_\_\_\_ with directions to re-submit missing items using Page 5 of this form.

*Email, FAX, USPS, hand-delivered*

\_\_\_\_\_  
*Print Name of Authorized Agent of the LHD*

\_\_\_\_\_  
*Signature of Authorized Agent of the LHD*

\_\_\_\_\_  
*Date*

COMPLETE (If box is checked, information in this section is required.)

Based upon review of information submitted by the PE in Part 1 of this form, this NOI is deemed COMPLETE.

Copies of this signed form were sent to the design PE and the Owner on \_\_\_\_\_ via \_\_\_\_\_.

A copy of this NOI and tracking information was sent to the State on \_\_\_\_\_ via \_\_\_\_\_.

\_\_\_\_\_  
*Print Name of Authorized Agent of the LHD*

\_\_\_\_\_  
*Signature of Authorized Agent of the LHD*

\_\_\_\_\_  
*Date*

**Re-submittal of NOI with missing items included**

*This Section is for use by PE to submit items noted as missing during LHD Completeness Review above.  
Resubmittals must be accompanied by a cover letter from the PE.*

LHD USE ONLY: This NOI resubmittal received: \_\_\_\_\_ by \_\_\_\_\_  
Date Initials

Item # from initial NOI	Resubmittal description

**Attestation by Professional Engineer licensed in North Carolina pursuant to G.S. 89C**

I, \_\_\_\_\_ hereby attest that the information re-submitted for this Notice of  
*Licensed Professional Engineer (Print Name)*  
Intent to Construct is accurate and complete to the best of my knowledge and that the proposed system shall meet applicable federal, State, and local laws, regulations, rules and ordinances in accordance with G.S. 130A-336.1(e)(6).

\_\_\_\_\_  
*Signature of Licensed Professional Engineer*

\_\_\_\_\_  
*Date*

*The section below is for Local Health Department use after submittal of items noted as missing above.*

**LHD Follow-up Completeness Review of Notice of Intent to Construct**

This follow-up review for completeness of this Notice and Intent was conducted in accordance with G.S. 130A-336.1(c). This NOI is determined to be:

INCOMPLETE

Based upon review of information submitted by the PE in the RESUBMITTAL above, this Notice of Intent remains INCOMPETE because the following items from Part 1 of this form remain missing: \_\_\_\_\_

Copies of this signed form were sent to the design PE and the Owner on \_\_\_\_\_ via \_\_\_\_\_  
*Date Email, FAX, USPS, Hand-delivered*

\_\_\_\_\_  
*Print name of authorized Agent of the LHD*

\_\_\_\_\_  
*Signature of authorized Agent of the LHD*

\_\_\_\_\_  
*Date*

COMPLETE

Based upon review of information submitted by the PE in the RESUBMITTAL above in addition to information provided in Part 1 of this form, this NOI is deemed complete.

Copies of this signed form were sent to the PE and the Owner on \_\_\_\_\_ via \_\_\_\_\_  
*Date Email, FAX, USPS, Hand-delivered*

A complete copy of this form with tracking information was sent to the State: \_\_\_\_\_ via \_\_\_\_\_  
*Date Email, FAX, USPS, hand-delivered*

\_\_\_\_\_  
*Print name of authorized Agent of the LHD*

\_\_\_\_\_  
*Signature of authorized Agent of the LHD*

\_\_\_\_\_  
*Date*

**PART 3: Authorization to Operate (ATO)**

*Except for date received, the Section below is to be completed by the Owner or by the PE designated to act as their legal representative for the EOP.*

LHD USE ONLY: Initial submittal of request for ATO received: \_\_\_\_\_ by \_\_\_\_\_  
Date Initials  
 Date of Post-construction Conference: \_\_\_\_\_

The following items are included in this submittal for an Authorization to Operate under an EOP:

1. Signed and sealed copy of the Engineer’s report that includes:
 

a. Signed and sealed evaluation of soil conditions and site features	<input type="checkbox"/> Yes	<input type="checkbox"/> No
b. Drawings, specifications, plans	<input type="checkbox"/> Yes	<input type="checkbox"/> No
c. Reports on special inspections and final inspection	<input type="checkbox"/> Yes	<input type="checkbox"/> No
d. Management Program manual	<input type="checkbox"/> Yes	<input type="checkbox"/> No
e. On-site Wastewater Contractor’s signed statement	<input type="checkbox"/> Yes	<input type="checkbox"/> No
f. Signed and sealed statement pursuant to 15A NCAC 18A .1938(h)	<input type="checkbox"/> Yes	<input type="checkbox"/> No
2. Fee (as applicable)  Yes  No
3. Notarized letter documenting Owner’s acceptance of the system from the PE  Yes  No

**Attestation by the Owner or the PE for Authorization to Operate**

I, \_\_\_\_\_ hereby attest that all items indicated above have been provided to the  
*Print name of Owner or Professional Engineer*

\_\_\_\_\_ County LHD and the system shall meet applicable federal, State, and local laws, regulations, rules and ordinances in accordance with G.S. 130A-336-.1(e)(6).

\_\_\_\_\_  
*Signature of Owner or Professional Engineer* *Date*

*This section for LHD Use Only.*

**LHD Review of required information for the ATO**

INCOMPLETE

Based upon review of information submitted by the Owner or PE in the Section above, the following items are missing from the information required for an Authorization to Operate for an EOP: \_\_\_\_\_  
 \_\_\_\_\_.

Copies of this signed form were sent to the design PE and the Owner on \_\_\_\_\_ via \_\_\_\_\_  
Date Email, FAX, USPS, Hand-delivered

\_\_\_\_\_  
*Print name of authorized Agent of the LHD* *Signature of authorized Agent of the LHD* *Date*

COMPLETE

Based upon review of information submitted by the Owner or PE in the Section above, this Authorization to Operate is hereby issued in accordance with G.S. 130A-336.1(m).

A copy of this complete NOI/ATO with tracking information was sent to the State on \_\_\_\_\_ via \_\_\_\_\_  
Date Email, FAX, USPS, Hand-delivered

\_\_\_\_\_  
*Print name of authorized Agent of the LHD* *Signature of authorized Agent of the LHD* *Date*

**ISSUANCE OF CERTIFICATE OF OCCUPANCY:** Once the LHD determines completeness based upon the PE submission, the owner may apply to the local permitting agency for permanent electrical service to a residence, place of business or place of public assembly pursuant to G.S. 130A-339.



Owner: HAVEN S/D  
 Address: LOT 5  
 Location: PLACID POND DRIVE

**PITTMAN SOIL CONSULTING**  
**PO BOX 1387**  
**RICHLANDS, NC 28574**  
**910-330-2784**  
[pittmansoil@yahoo.com](mailto:pittmansoil@yahoo.com)

LOT INFORMATION OBTAINED FROM PLAT BY STANCIL AND ASSOCIATES FOR XCESSIVE RISK DEVELOPMENT.

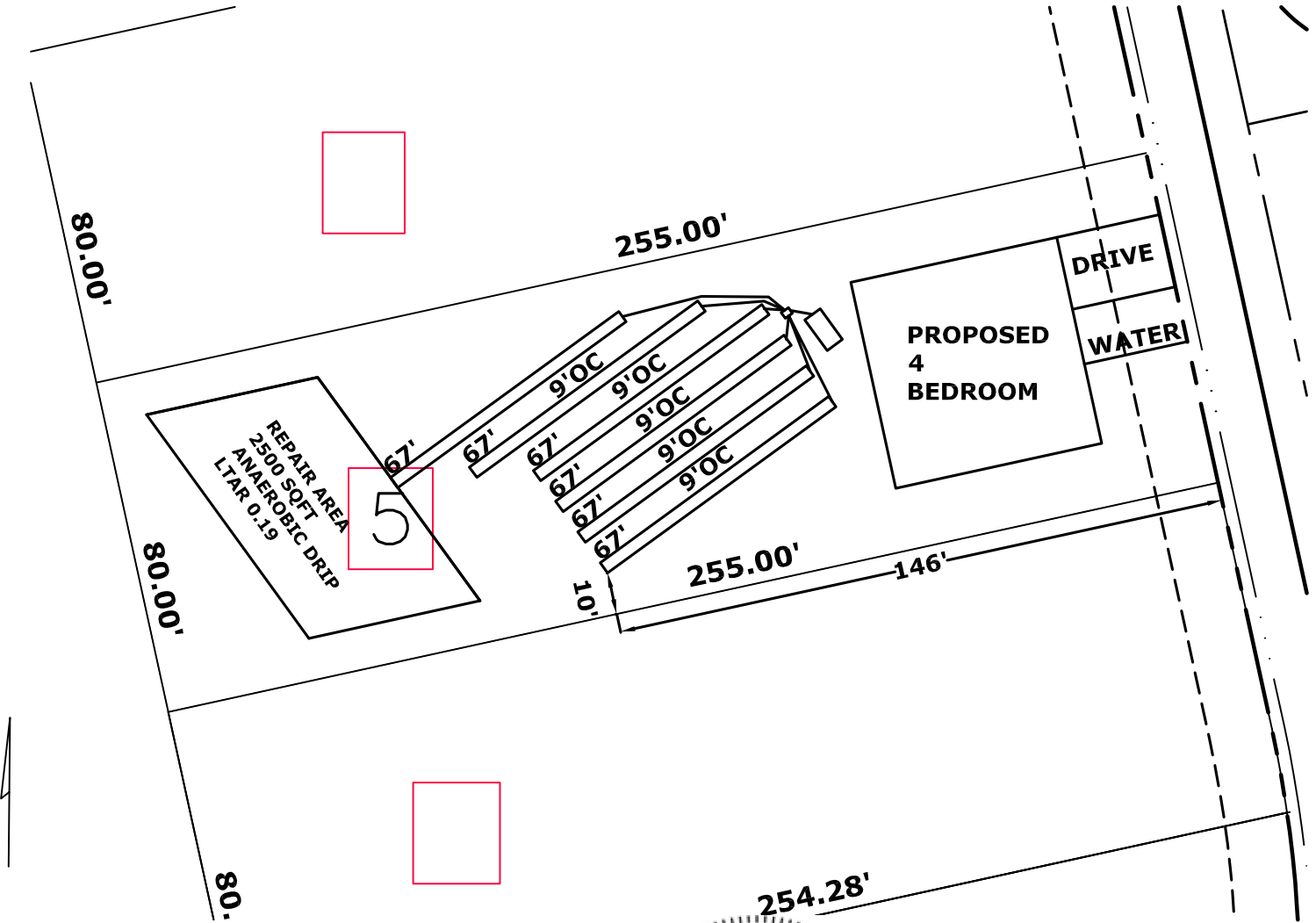

*Handwritten signature*

DN: o=ATHAN M. PARKER, PE, c=US, o=AMPO ENGINEERING, LLC  
 email=ATHAN.PARKER@AMPOENGINEERING.COM  
 Date: 2021.08.13 12:27:00Z



**INITIAL**  
 4 BEDROOM  
 LTAR .3  
 6-67' 25% REDUCTION  
 12-18" TB  
 >6" SOIL COVER REQUIRED OVER SYSTEM AND 5' BEYOND SYSTEM

**REPAIR AREA**  
 4 BEDROOM  
 LTAR .19  
 2500 SQFT ANAEROBIC DRIP  
 6" TB  
 >6" SOIL COVER REQUIRED OVER SYSTEM AND 5' BEYOND SYSTEM



SCALE 1"=40'

# *Pittman Soil Consulting*

1003 Gregory Fork Road  
Richlands, NC 28574  
Phone (910)330-2784  
[pittmansoil@yahoo.com](mailto:pittmansoil@yahoo.com)

---

JULY 26, 2021

Ref: HAVEN Lot 5, HARNETTCOUNTY

Dear Sir,

A soil evaluation was conducted on the above referenced tract to determine the sites suitability for septic. The current laws and rules of NC was used as guide for this evaluation.

Hand Auger borings on the site were used to characterize the soil texture, and depth to the soil wetness condition. The attached plot plan shows the location of the septic system in the most ideal location on the site. The soil wetness condition was found to be 24-30" from the surface with a clay loam texture. I have assigned an LTAR of 0.3 gpd/sqft for a 480 gpd 4 bedroom residence. This will require the installation of 6-67' 25% reduction lines that shall be installed in accordance with the current rules. The depth to soil wetness of 24-30" would constitute a 12-18" trench bottom. The system will require 6" soil cover that shall extend 5' from the edge of the system. The system will require a 1000 gallon septic tank.

The repair area will require a 2500 sqft anaerobic drip installed at a depth of 6" from the surface (LTAR 0.19).

After installation the site should be landscaped to shed surface water. Any alterations to the site may impact soil conditions.

If you have any questions please feel free to contact me at 910-330-2784. Thank You.

Sincerely,



**R. HAYWOOD  
PITTMAN II**

Digitally signed by R. HAYWOOD  
PITTMAN II  
DN: cn=R. HAYWOOD PITTMAN II,  
o=PITTMAN SOIL CONSULTING, ou,  
email=pittmansoil@yahoo.com,  
c=US  
Date: 2021.08.02 05:23:29 -04'00'

R. Haywood Pittman II  
NC Licensed Soil Scientist



# CERTIFICATE OF LIABILITY INSURANCE

DATE (MM/DD/YYYY)

03/02/2021

THIS CERTIFICATE IS ISSUED AS A MATTER OF INFORMATION ONLY AND CONFERS NO RIGHTS UPON THE CERTIFICATE HOLDER. THIS CERTIFICATE DOES NOT AFFIRMATIVELY OR NEGATIVELY AMEND, EXTEND OR ALTER THE COVERAGE AFFORDED BY THE POLICIES BELOW. THIS CERTIFICATE OF INSURANCE DOES NOT CONSTITUTE A CONTRACT BETWEEN THE ISSUING INSURER(S), AUTHORIZED REPRESENTATIVE OR PRODUCER, AND THE CERTIFICATE HOLDER.

**IMPORTANT:** If the certificate holder is an ADDITIONAL INSURED, the policy(ies) must have ADDITIONAL INSURED provisions or be endorsed. If SUBROGATION IS WAIVED, subject to the terms and conditions of the policy, certain policies may require an endorsement. A statement on this certificate does not confer rights to the certificate holder in lieu of such endorsement(s).

<b>PRODUCER</b>		<b>CONTACT NAME:</b> Kira Gibson, SBCS, CBIA	
The Sewell Insurance Agency		<b>PHONE (A/C, No, Ext):</b> (910) 326-5754	<b>FAX (A/C, No):</b> (910) 326-6310
785-1 W Corbett Ave		<b>E-MAIL ADDRESS:</b> kira@thesewellagency.com	
PO Box 835		<b>INSURER(S) AFFORDING COVERAGE</b>	
Swansboro NC 28584		<b>INSURER A:</b> Bankers Insurance Group	<b>NAIC #</b> 33162
<b>INSURED</b>		<b>INSURER B:</b> Progressive Insurance Company	
Ampd Engineering PLLC		<b>INSURER C:</b> NorGUARD Insurance Company	
Po Box 4580		<b>INSURER D:</b> Berkshire Hathaway GUARD Insurance Company	
Emerald Isle NC 28594-4580		<b>INSURER E:</b>	
		<b>INSURER F:</b>	

**COVERAGES**

CERTIFICATE NUMBER: CL213203465

REVISION NUMBER:

THIS IS TO CERTIFY THAT THE POLICIES OF INSURANCE LISTED BELOW HAVE BEEN ISSUED TO THE INSURED NAMED ABOVE FOR THE POLICY PERIOD INDICATED. NOTWITHSTANDING ANY REQUIREMENT, TERM OR CONDITION OF ANY CONTRACT OR OTHER DOCUMENT WITH RESPECT TO WHICH THIS CERTIFICATE MAY BE ISSUED OR MAY PERTAIN, THE INSURANCE AFFORDED BY THE POLICIES DESCRIBED HEREIN IS SUBJECT TO ALL THE TERMS, EXCLUSIONS AND CONDITIONS OF SUCH POLICIES. LIMITS SHOWN MAY HAVE BEEN REDUCED BY PAID CLAIMS.

INSR LTR	TYPE OF INSURANCE	ADDL INSD	SUBR WVD	POLICY NUMBER	POLICY EFF (MM/DD/YYYY)	POLICY EXP (MM/DD/YYYY)	LIMITS		
A	<input checked="" type="checkbox"/> <b>COMMERCIAL GENERAL LIABILITY</b>			32 0040007108 0 01	03/02/2021	03/02/2022	EACH OCCURRENCE	\$ 1,000,000	
	<input type="checkbox"/> CLAIMS-MADE <input checked="" type="checkbox"/> OCCUR						DAMAGE TO RENTED PREMISES (Ea occurrence)	\$ 300,000	
	GEN'L AGGREGATE LIMIT APPLIES PER:							MED EXP (Any one person)	\$ 10,000
	<input checked="" type="checkbox"/> POLICY <input type="checkbox"/> PRO-JECT <input type="checkbox"/> LOC						PERSONAL & ADV INJURY	\$ 1,000,000	
	OTHER:						GENERAL AGGREGATE	\$ 2,000,000	
							PRODUCTS - COMP/OP AGG	\$ 2,000,000	
								\$	
B	<b>AUTOMOBILE LIABILITY</b>			01335494-1	11/05/2020	11/05/2021	COMBINED SINGLE LIMIT (Ea accident)	\$ 1,000,000	
	<input type="checkbox"/> ANY AUTO						BODILY INJURY (Per person)	\$	
	<input type="checkbox"/> OWNED AUTOS ONLY <input checked="" type="checkbox"/> SCHEDULED AUTOS						BODILY INJURY (Per accident)	\$	
	<input type="checkbox"/> HIRED AUTOS ONLY <input type="checkbox"/> NON-OWNED AUTOS ONLY						PROPERTY DAMAGE (Per accident)	\$	
								\$	
	<b>UMBRELLA LIAB</b>						EACH OCCURRENCE	\$	
	<b>EXCESS LIAB</b>						AGGREGATE	\$	
	DED							\$	
	RETENTION \$							\$	
C	<b>WORKERS COMPENSATION AND EMPLOYERS' LIABILITY</b>			AMWC226938	03/01/2021	03/01/2022	<input checked="" type="checkbox"/> PER STATUTE <input type="checkbox"/> OTH-ER		
	ANY PROPRIETOR/PARTNER/EXECUTIVE OFFICER/MEMBER EXCLUDED? (Mandatory in NH)	Y / N					E.L. EACH ACCIDENT	\$ 500,000	
	If yes, describe under DESCRIPTION OF OPERATIONS below	<input type="checkbox"/> Y <input type="checkbox"/> N / A					E.L. DISEASE - EA EMPLOYEE	\$ 500,000	
							E.L. DISEASE - POLICY LIMIT	\$ 500,000	
D	Professional Liability			AMPL201161	03/01/2021	03/01/2022	Per Claim	1,000,000	
							Aggregate	2,000,000	

DESCRIPTION OF OPERATIONS / LOCATIONS / VEHICLES (ACORD 101, Additional Remarks Schedule, may be attached if more space is required)

Engineering Firm

**CERTIFICATE HOLDER****CANCELLATION**

AMP'D Engineering PLLC PO Box 4580  Emerald Isle NC 28594	SHOULD ANY OF THE ABOVE DESCRIBED POLICIES BE CANCELLED BEFORE THE EXPIRATION DATE THEREOF, NOTICE WILL BE DELIVERED IN ACCORDANCE WITH THE POLICY PROVISIONS.
	AUTHORIZED REPRESENTATIVE  

© 1988-2015 ACORD CORPORATION. All rights reserved.



# CERTIFICATE OF LIABILITY INSURANCE

DATE (MM/DD/YYYY)  
07/27/2021

THIS CERTIFICATE IS ISSUED AS A MATTER OF INFORMATION ONLY AND CONFERS NO RIGHTS UPON THE CERTIFICATE HOLDER. THIS CERTIFICATE DOES NOT AFFIRMATIVELY OR NEGATIVELY AMEND, EXTEND OR ALTER THE COVERAGE AFFORDED BY THE POLICIES BELOW. THIS CERTIFICATE OF INSURANCE DOES NOT CONSTITUTE A CONTRACT BETWEEN THE ISSUING INSURER(S), AUTHORIZED REPRESENTATIVE OR PRODUCER, AND THE CERTIFICATE HOLDER.

**IMPORTANT:** If the certificate holder is an ADDITIONAL INSURED, the policy(ies) must have ADDITIONAL INSURED provisions or be endorsed. If SUBROGATION IS WAIVED, subject to the terms and conditions of the policy, certain policies may require an endorsement. A statement on this certificate does not confer rights to the certificate holder in lieu of such endorsement(s).

<b>PRODUCER</b> N.C. Farm Bureau Ins. Agency 5301 Glenwood Avenue (27612) P.O. Box 27427 Raleigh NC 27611		<b>CONTACT NAME:</b> <b>PHONE (A/C, No, Ext):</b> <b>FAX (A/C, No):</b> <b>E-MAIL ADDRESS:</b>	
<b>INSURED</b> Pittman Soil Consulting c/o Ronald H. Pittman, II 1003 Gregory Fork Rd Richlands NC 28574		<b>INSURER(S) AFFORDING COVERAGE</b> <b>INSURER A:</b> Capitol Specially Insurance Corporation <b>INSURER B:</b> <b>INSURER C:</b> <b>INSURER D:</b> <b>INSURER E:</b> <b>INSURER F:</b>	

**COVERAGES**      **CERTIFICATE NUMBER:** CL2172120555      **REVISION NUMBER:**

THIS IS TO CERTIFY THAT THE POLICIES OF INSURANCE LISTED BELOW HAVE BEEN ISSUED TO THE INSURED NAMED ABOVE FOR THE POLICY PERIOD INDICATED. NOTWITHSTANDING ANY REQUIREMENT, TERM OR CONDITION OF ANY CONTRACT OR OTHER DOCUMENT WITH RESPECT TO WHICH THIS CERTIFICATE MAY BE ISSUED OR MAY PERTAIN, THE INSURANCE AFFORDED BY THE POLICIES DESCRIBED HEREIN IS SUBJECT TO ALL THE TERMS, EXCLUSIONS AND CONDITIONS OF SUCH POLICIES. LIMITS SHOWN MAY HAVE BEEN REDUCED BY PAID CLAIMS.

INSR LTR	TYPE OF INSURANCE	ADDL INSD	SUBR WVD	POLICY NUMBER	POLICY EFF (MM/DD/YYYY)	POLICY EXP (MM/DD/YYYY)	LIMITS
A	<input checked="" type="checkbox"/> COMMERCIAL GENERAL LIABILITY <input type="checkbox"/> CLAIMS-MADE <input checked="" type="checkbox"/> OCCUR			EV20182381-04	07/19/2021	07/19/2022	EACH OCCURRENCE \$ 1,000,000
	<input checked="" type="checkbox"/> Professional Liability GEN'L AGGREGATE LIMIT APPLIES PER: <input checked="" type="checkbox"/> POLICY <input type="checkbox"/> PRO-JECT <input type="checkbox"/> LOC OTHER:						DAMAGE TO RENTED PREMISES (Ea occurrence) \$ 50,000
	AUTOMOBILE LIABILITY <input type="checkbox"/> ANY AUTO <input type="checkbox"/> OWNED AUTOS ONLY <input type="checkbox"/> HIRED AUTOS ONLY <input type="checkbox"/> SCHEDULED AUTOS <input type="checkbox"/> NON-OWNED AUTOS ONLY						MED EXP (Any one person) \$ 5,000
	<input type="checkbox"/> UMBRELLA LIAB <input type="checkbox"/> OCCUR <input type="checkbox"/> EXCESS LIAB <input type="checkbox"/> CLAIMS-MADE DED    RETENTION \$						PERSONAL & ADV INJURY \$ 1,000,000
	WORKERS COMPENSATION AND EMPLOYERS' LIABILITY ANY PROPRIETOR/PARTNER/EXECUTIVE OFFICER/MEMBER EXCLUDED? (Mandatory in NH) If yes, describe under DESCRIPTION OF OPERATIONS below	Y/N	N/A				GENERAL AGGREGATE \$ 2,000,000
A	Contractors Pollution Liability - Occurrence Form			EV20182381-04	07/19/2021	07/19/2022	PRODUCTS - COMP/OP AGG \$ 2,000,000 Professional Occ/Agg \$ 1M/2M COMBINED SINGLE LIMIT (Ea accident) \$ BODILY INJURY (Per person) \$ BODILY INJURY (Per accident) \$ PROPERTY DAMAGE (Per accident) \$ \$ EACH OCCURRENCE \$ AGGREGATE \$ \$ PER STATUTE    OTH-ER E.L. EACH ACCIDENT \$ E.L. DISEASE - EA EMPLOYEE \$ E.L. DISEASE - POLICY LIMIT \$
							Each Incident 1,000,000 Aggregate Limit 2,000,000

DESCRIPTION OF OPERATIONS / LOCATIONS / VEHICLES (ACORD 101, Additional Remarks Schedule, may be attached if more space is required)

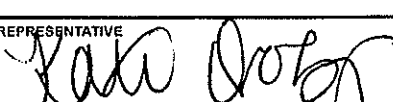
<b>CERTIFICATE HOLDER</b> AMP'd Engineering, PLLC PO Box 4580 Emerald Isle NC 28594	<b>CANCELLATION</b> SHOULD ANY OF THE ABOVE DESCRIBED POLICIES BE CANCELLED BEFORE THE EXPIRATION DATE THEREOF, NOTICE WILL BE DELIVERED IN ACCORDANCE WITH THE POLICY PROVISIONS. AUTHORIZED REPRESENTATIVE 
--	--

© 1988-2015 ACORD CORPORATION. All rights reserved.