

MAP REFERENCE PLAT BOOK 2021, PAGE 361
 DEED REFERENCE DEED BOOK 4011, PAGE 456

FLOOD INFORMATION
 PROPERTY SHOWN ON THIS PLAT LIES IN A
 (ZONE X) MINIMAL FLOOD RISK AS SHOWN ON
 FLOOD MAP NO. 3720060000 J
 EFFECTIVE DATE OCTOBER 3, 2006

EXISTING PARCEL
 ALL INFORMATION SHOWN ON THIS MAP WAS TAKEN
 FROM EXISTING RECORDED SURVEY MAP AND
 NO NEW SURVEY WAS PERFORMED BY BENNETT SURVEYS.

REFERENCE RECORDED PLAT NOTES INFORMATION
 AND RESTRICTIONS.

NORTH CAROLINA HARNETT COUNTY
 Mickey R. Bennett, PLS do hereby certify that this plat was drawn under
 the supervision and direction recorded in Book 4011, Page 456.
 Property lots and boundaries not surveyed are clearly
 indicated as shown from information found in Book 4011, Page 456
 (see ref.) at the date of precision as calculated in 1:10000
 Witness my original signature, registration number and seal this
 12th day of August, A.D. 2021.



Mickey R. Bennett PLS

MICKY R. BENNETT
 L. 1514

I, MICKY R. BENNETT, P.L.S. CERTIFY
 That this survey is of and true to the portion or parcels
 of land and to the surveying instruments and data
 not made a new sheet or change in existing survey.

MINIMUM BUILDING SETBACKS
 FRONT YARD — 35'
 REAR YARD — 35'
 SIDE YARD — 10'
 CORNER LOT SIDE YARD — 20'
 MAXIMUM HEIGHT — 35'

PLOT PLAN

CORNER SET-BK

FRONT SET-BK

REAR SET-BK

LOT 1

S 37°11'12"E 379.46'

10'S/B

263.6'

30'x 30'
JOINT DRIVE

PROPOSED DRIVE

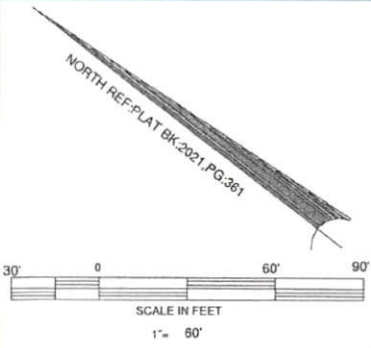

PROPOSED HOUSE LOCATION
 THE LAUREN H(30)(R)

LOT 2
 2.335 AC.

- Side set BK

OVERHEAD POWER
 S 52°48'48"W 214.00'

NCSR 1232 (CAMERON GROVE ROAD) 60'R/W

N 37°11'12"W 571.01'

LOT 3

KEY

MINIMUM BUILDING SETBACKS
 FRONT — 35'
 SIDE — 10'
 REAR — 25'
 MAXIMUM HEIGHT — 35'

OWNERS/DEVELOPERS
 HARRINGTON PROPERTIES OF NC, LLC
 2659 SAN LEE DRIVE
 SANFORD, NC 27330

EXISTING PARCEL(S) (SEE NOTE)

	PLOT PLAN CAMERON ROAD -- LOT 2		BENNETT SURVEYS F-1304 1662 CLARK RD. LILLINGTON N C. 27546 (910) 893-5252	
	TOWNSHIP UPPER LITTLE RIVER	COUNTY HARNETT	SCALE: 1" = 60'	DRAWN BY: MRB&RVB
ZONED PA-20R	PIN 0600-77-8364-000	NORTH CAROLINA	DATE AUGUST 13, 2021	
VICINITY MAP (NTS)	PID 130600 0124	DRAWING NO. 21463		

zoning