



**ROOF & FLOOR TRUSSES & BEAMS**

Reilly Road Industrial Park  
 Fayetteville, N.C. 28309  
 Phone: (910) 864-8787  
 Fax: (910) 864-4444

Bearing reactions less than or equal to 3000# are deemed to comply with the prescriptive Code requirements. The contractor shall refer to the attached Tables ( derived from the prescriptive Code requirements ) to determine the minimum foundation size and number of wood studs required to support reactions greater than 3000# but not greater than 15000#. A registered design professional shall be retained to design the support system for any reaction that exceeds those specified in the attached Tables. A registered design professional shall be retained to design the support system for all reactions that exceed 15000#.

Signature Marshall Naylor  
 Marshall Naylor

**LOAD CHART FOR JACK STUDS**

(BASED ON TABLES R502.5(1) & (b))  
 NUMBER OF JACK STUDS REQUIRED @ EA END OF HEADER/GIRDER

END REACTION (UP TO)	REQ. STUDS FOR (1) 1" X 4" HEADER	END REACTION (UP TO)	REQ. STUDS FOR (1) 1" X 4" HEADER	END REACTION (UP TO)	REQ. STUDS FOR (1) 1" X 4" HEADER
1700	1	2550	1	3400	1
3400	2	5100	2	6800	2
5100	3	7650	3	10200	3
6800	4	10200	4	13600	4
8500	5	12750	5	17000	5
10200	6	15300	6		
11900	7				
13600	8				
15300	9				

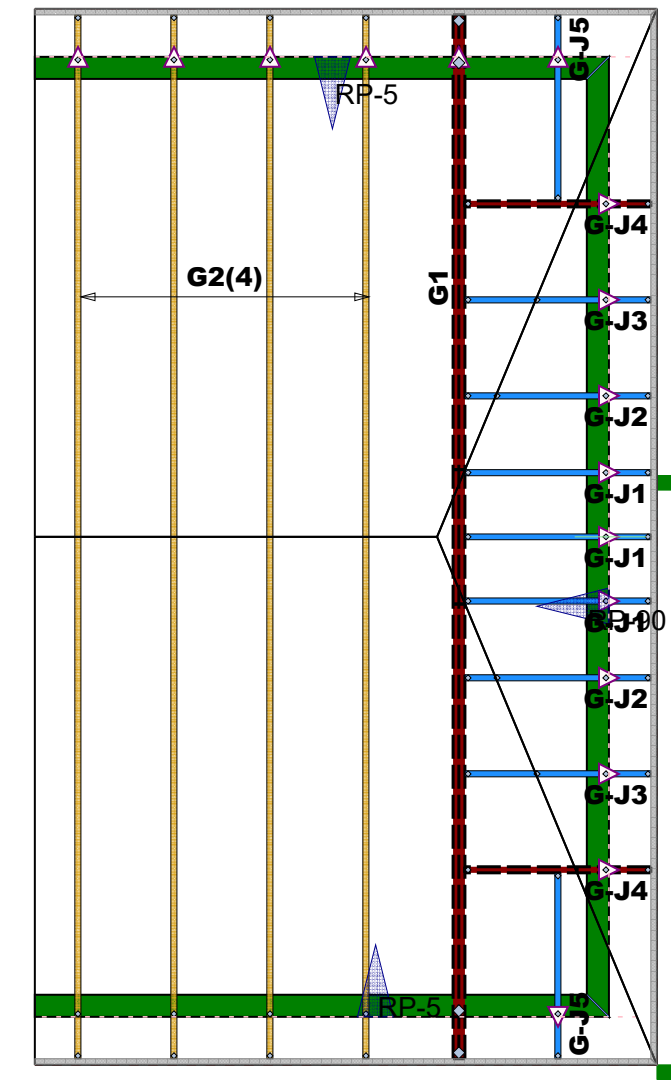
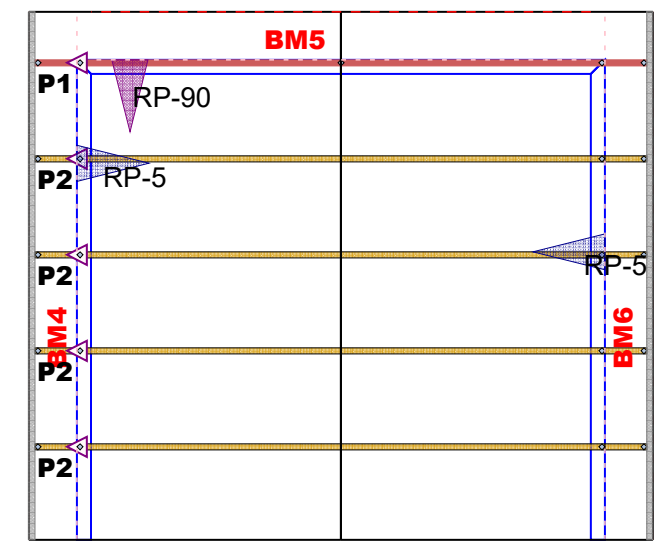
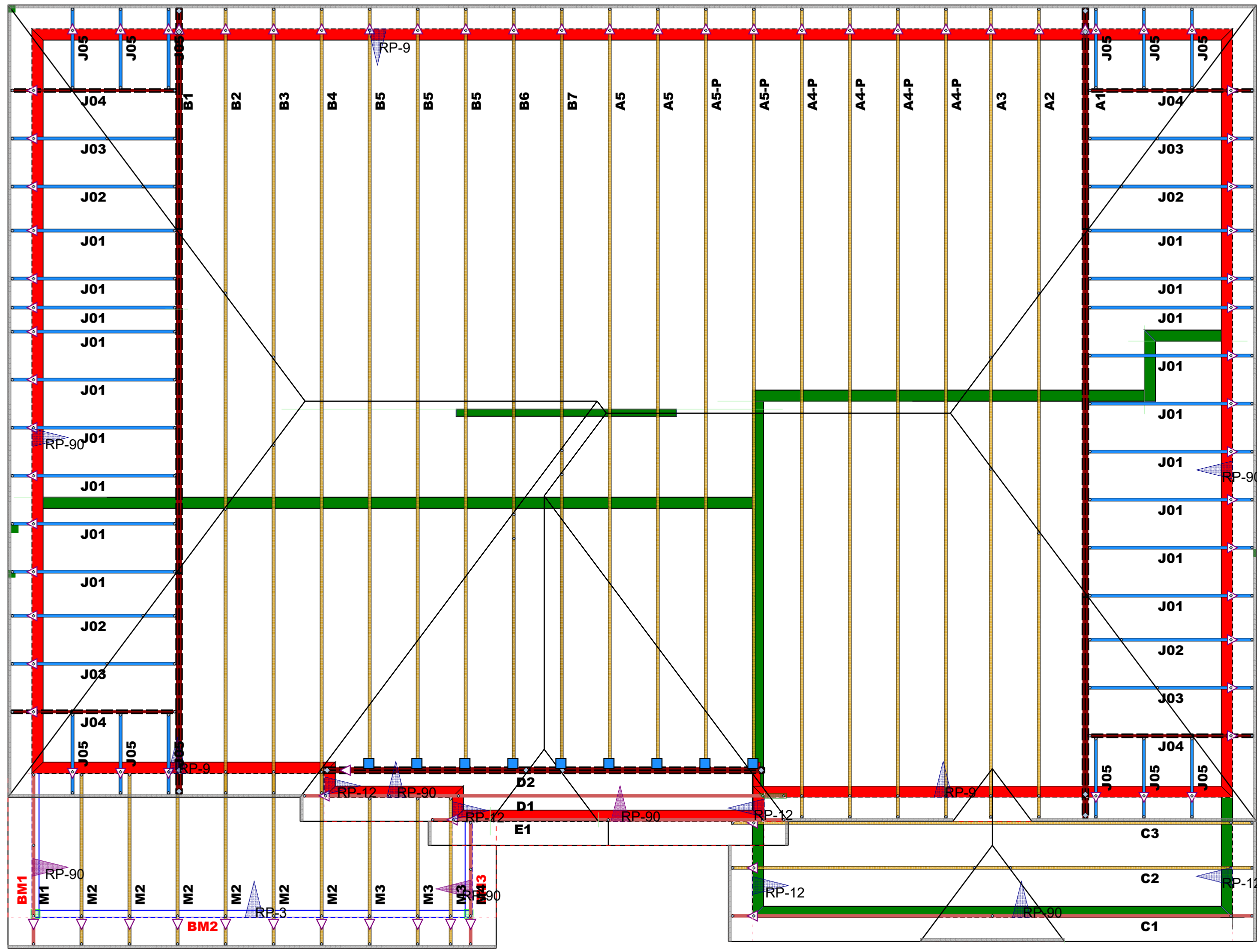

= 1st Level Wall

= 2nd Level Wall

<span style="display:inline-block; width:10px; height:10px; background-color:blue; border:1px solid black;"></span>	HUS26	USP	9	NA	16d/3-1/2"	16d/3-1/2"
---	-------	-----	---	----	------------	------------

Truss Placement Plan  
 SCALE: NTS

▲ = Indicates Left End of Truss  
 (Reference Engineered Truss Drawing )  
 Do NOT Erect Truss Backwards

BUILDER	CITY / CO.	MODEL	DATE REV.	DRAWN BY	SALES REP.
Onsite Homes, LLC	Hampstead / Brunswick	Roof	02/07/20	Marshall Naylor	Marshall Naylor
JOB NAME	ADDRESS	MODEL	DATE REV.	DRAWN BY	SALES REP.
Southport C-E	Lot 286 Weathersbee Drive	Roof	02/07/20	Marshall Naylor	Marshall Naylor
PLAN	ADDRESS	MODEL	DATE REV.	DRAWN BY	SALES REP.
Southport C-E Hip	Lot 286 Weathersbee Drive	Roof	02/07/20	Marshall Naylor	Marshall Naylor
SEAL DATE	ADDRESS	MODEL	DATE REV.	DRAWN BY	SALES REP.
11/12/19	Lot 286 Weathersbee Drive	Roof	02/07/20	Marshall Naylor	Marshall Naylor
QUOTE #	ADDRESS	MODEL	DATE REV.	DRAWN BY	SALES REP.
B0120-0237	Lot 286 Weathersbee Drive	Roof	02/07/20	Marshall Naylor	Marshall Naylor
JOB #	ADDRESS	MODEL	DATE REV.	DRAWN BY	SALES REP.
J0517-2676	Lot 286 Weathersbee Drive	Roof	02/07/20	Marshall Naylor	Marshall Naylor

THIS IS A TRUSS PLACEMENT DIAGRAM ONLY. These trusses are designed as individual building components to be incorporated into the building design at the specification of the building designer. See individual design sheets for each truss design identified on the placement drawing. The building designer is responsible for temporary and permanent bracing of the roof and floor system and for the overall structure. The design of the truss support structure including headers, beams, walls, and columns is the responsibility of the building designer. For general guidance regarding bracing, consult BCSI-B1 and BCSI-B3 provided with the truss delivery package or online @ sbcindustry.com