

Harnett County Department of Public Health Improvement Permit

A building permit cannot be issued with only an Improvement Permit

ISSUED TO: TAYLOR ANN HENDERSON
CHRIS HENDERSON

PROPERTY LOCATION: 1012 E. WIMBERLY ST. (S21502)
SUBDIVISION _____ LOT # _____

NEW REPAIR EXPANSION

Type of Structure: 3-BEDROOM 48'x52' SFD
Proposed Wastewater System Type: 25% REDUCTION SYS.
Projected Daily Flow: 366 GPD

Number of bedrooms: 3 Number of Occupants: 6 max

Basement Yes No

Pump Required: Yes No May be required based on final location and elevations of facilities

Type of Water Supply: Community Public Well Distance from well NA feet

Permit conditions: _____ Permit valid for: Five years No expiration

Authorized State Agent: [Signature] Date: 07/28/2021 SEE ATTACHED SITE SKETCH

The issuance of this permit by the Health Department in no way guarantees the issuance of other permits. The permit holder is responsible for checking with appropriate governing bodies in meeting their requirements. This site is subject to revocation if the site plan, plat, or the intended use changes. The Improvement Permit shall not be affected by a change in ownership of the site. This permit is subject to compliance with the provisions of the Laws and Rules for Sewage Treatment and Disposal and to conditions of this permit.

Construction Authorization (Required for Building Permit)

The construction and installation requirements of Rules .1950, .1952, .1954, .1955, .1956, .1957, .1958, and .1959 are incorporated by references into this permit and shall be met. Systems shall be installed in accordance with the attached system layout.

ISSUED TO: TAYLOR ANN HENDERSON
CHRIS HENDERSON

PROPERTY LOCATION: 1012 E. WIMBERLY ST. (S21502)
SUBDIVISION _____ LOT # _____

Facility Type: 3-BR 48'x52' SFD New Expansion Repair

Basement? Yes No Basement Fixtures? Yes No

Type of Wastewater System** 25% REDUCTION SYSTEM (Initial) Wastewater Flow: 366 GPD
(See note below, if applicable 25% REDUCTION SYSTEM (Repair))

Installation Requirements/Conditions	Number of trenches <u>3</u>	Trench Spacing: <u>9</u> Feet on Center
Septic Tank Size <u>1000</u> gallons	Exact length of each trench <u>90</u> feet	Soil Cover: <u>6</u> inches (MIN)
Pump Tank Size _____ gallons	Trenches shall be installed on contour at a Maximum Trench Depth of: <u>16</u> inches (Trench bottoms shall be level to +/-1/4" in all directions)	(Maximum soil cover shall not exceed 36" above the trench bottom)

Pump Requirements: _____ ft. TDH vs. _____ GPM

Aggregate Depth: NA inches below pipe
NA inches above pipe
NA inches total

Conditions: AT-CURVE INSTALL - ADDITIONAL SOIL COVER
MAY BE REQUIRED

**WATER LINES (INCLUDING IRRIGATION) MUST BE 10FT. FROM ANY PART OF SEPTIC SYSTEM OR REPAIR AREA.
NO UTILITIES ALLOWED IN INITIAL OR REPAIR DRAIN FIELD AREA.**

***If applicable: I understand the system type specified is different from the type specified on the application. I accept the specifications of this permit.*

Owner/Legal Representative Signature: _____ Date: _____

This Construction Authorization is subject to revocation if the site plan, plat, or the intended use changes. The Construction Authorization shall not be transferred when there is a change in ownership of the site. This Construction Authorization is subject to compliance with the provisions of the Laws and Rules for Sewage Treatment and Disposal and to the conditions of this permit. SEE ATTACHED SITE SKETCH

Authorized State Agent: [Signature] Date: 07/28/2021
Construction Authorization Expiration Date: 07/28/2022

Application # SD 02107-0048

Harnett County Department of Public Health Site Sketch

Property Location: 1012 E. WIMBZELL STREET (LN 1502)

Issued To: TAYLOR ANN HENDERSON Subdivision _____ Lot # _____
CHRIS HENDERSON

Authorized State Agent: *[Signature]* Date: 07/28/2021
ANDREW CORBIN

- * GRAVITY TO D-BOX EQUAL OR SERIAL DISTRIBUTION
- * AT-GRADE (16IN) INSTALL + ADDITIONAL SOIL COVER
MAY BE REQUIRED - 6IN COVER MINIMUM
- * TANK SHALL BE PLACED HIGH ON LOT AND PLUMBING
STUBBED @ CURB / SID TRANSITION [HIGH ON HOME]
210'

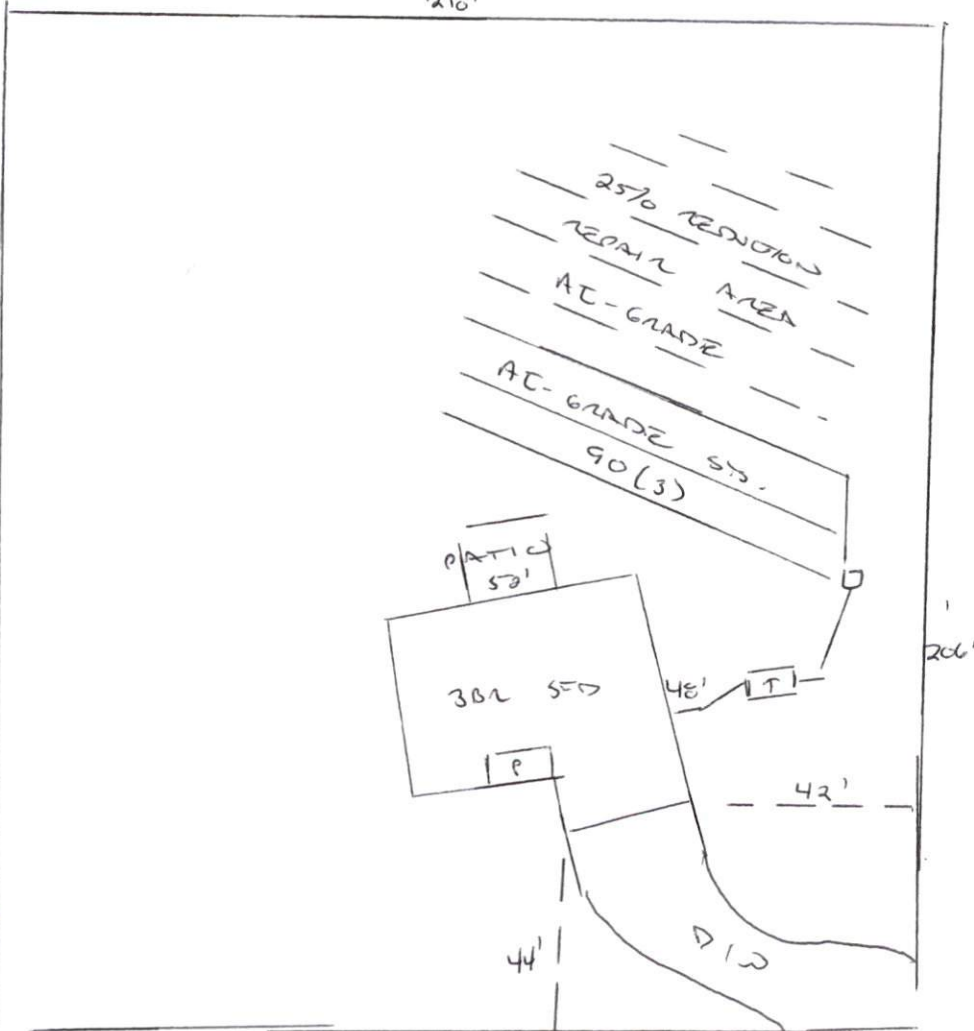

This drawing is for illustrative purposes only. System installation must meet all pertinent laws, rules, and regulations.