

GENERAL ROOF CONSTRUCTION NOTES

- ALL COMPONENTS SHALL MEET THE REQUIREMENTS OF THE CURRENT NORTH CAROLINA RESIDENTIAL BUILDING CODE.
- PROVIDE R-38 BATT INSULATION AT CEILING OR RAFTERS WHERE CEILING IS VAULTED.
- PROVIDE VENT BAFFLES OVER INSULATION, TYP.
- PROVIDE ASPHALT SHINGLES ON (2) LAYERS OF ROOFING FELT, ON 5/8" OSB SHEATHING.
- PROVIDE ICE + WATER SHIELD IN VALLEYS AND DORMER WALL INTERSECTIONS, 12" EACH SIDE. APPLY S.S. APRON FLASHING ON TOP OF ROOFING & STEP FLASHING AT DORMER. INSTALL DRIP EDGE COUNTER-FLASHING OVER STAINLESS.

DRAWN by
CYDNEY CLEMONS, RA
6401 CASTLEBROOK DR
RALEIGH, NC 27604
919-417-8787



11-14-23

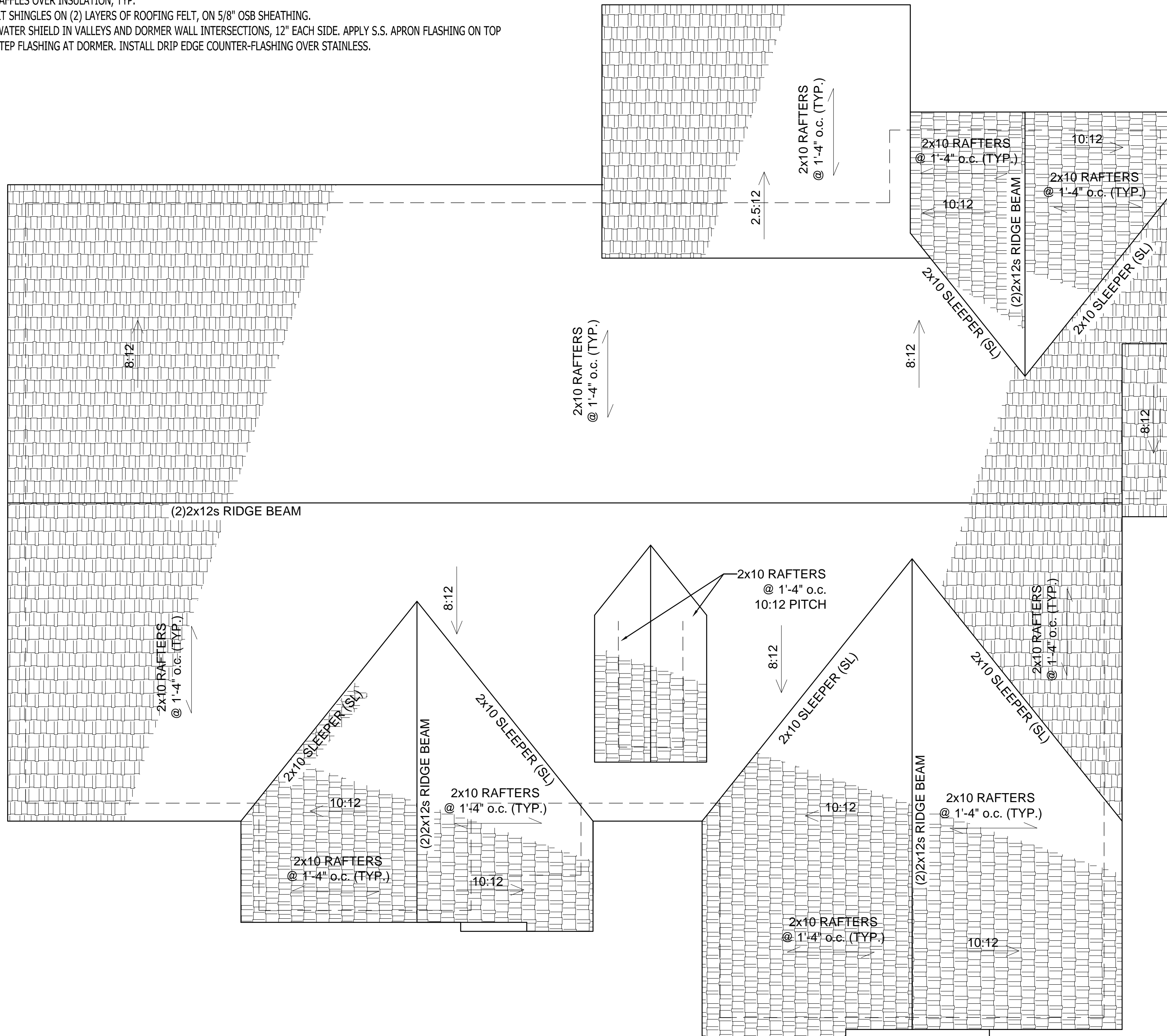

NORTH ↑

SCALE: 1/4" = 1'-0"

New Residence for
L'Tanya Burns
1175 Cobb Road
Benson, North Carolina 27504

REVISED 11/14/23
06/08/22

ROOF PLAN

A103