

GENERAL CONSTRUCTION NOTES

- ALL COMPONENTS SHALL MEET THE REQUIREMENTS OF THE CURRENT NORTH CAROLINA RESIDENTIAL BUILDING CODE.
- ALL WOOD MEMBERS DESIGNED AS SPF No. 2, UNLESS NOTED OTHERWISE.
- ALL LVLs SHALL BE GRADE 26F-1.9E.
- TYPICAL EXTERIOR WALL CONSTRUCTION: 2x4s @ 16" o.c., 1/2" GWB INSIDE, R-15 BATT INSULATION, 3/8" OSB STRUCTURAL SHEATHING (CONTINUOUS w/ CONNECTIONS PER APPLICABLE CODE FOR CS-WSP), SIDING & PAINT COLORS TBD.
- TYPICAL INTERIOR WALL CONSTRUCTION: 2x4s @ 16" o.c., 1/2" GWB BOTH SIDES, UNLESS NOTED OTHERWISE.
- INTERIOR NON-LOAD BEARING WOOD STUD WALL HEADERS >1'-0" BUT <6'-0" SHALL BE (2)2x6s, TYP. NON-LOAD BEARING HEADERS SHALL REST ON (1) KINGSTUD & (2) JACKSTUDS, EACH SIDE.
- PROVIDE SOLID 2x10 BLOCKING @ 32" A.F.F. FOR GRAB BARS AROUND WATER CLOSETS.
- WALLS ARE DIMENSIONED FROM FINISHED FACE, TYP.
- WINDOWS ARE CENTERED w/i THE ROOM, U.N.O.

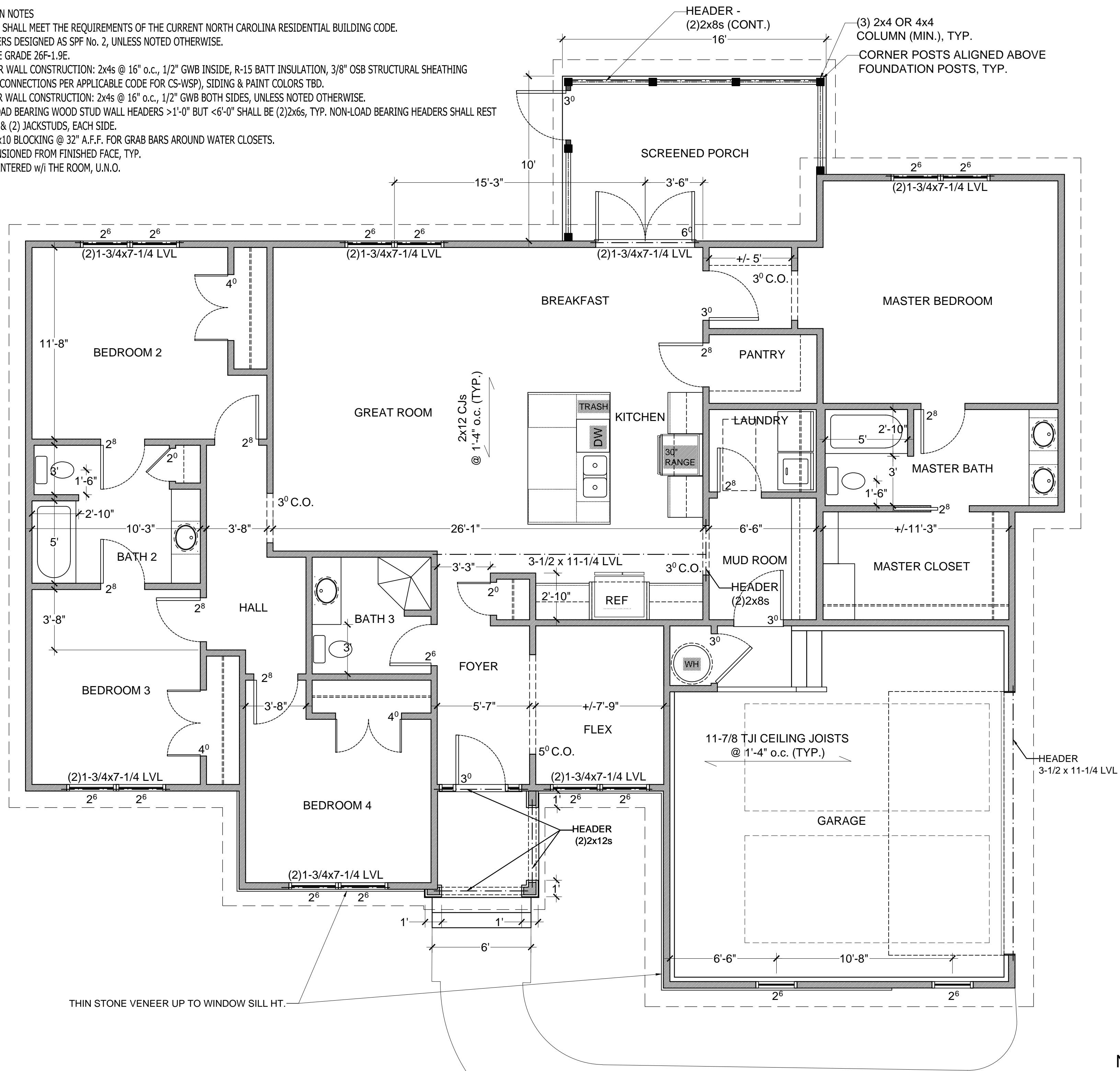

DRAWN by
CYDNEY CLEMONS, RA
6401 CASTLEBROOK DR
RALEIGH, NC 27604
919-417-8787



11-14-23

New Residence for
L'Tanya Burns
1175 Cobb Road
Benson, North Carolina 27504

REVISED 11/14/23
06/08/22

FIRST FLOOR PLAN

A101