

Harnett County Department of Public Health

Improvement Permit

A building permit cannot be issued with only an Improvement Permit

PROPERTY LOCATION: 354 Bunting Dr

SUBDIVISION Oakmont

LOT # 125

ISSUED TO: H&H Constructors

NEW REPAIR EXPANSION

Site Improvements required prior to Construction Authorization Issuance:

Type of Structure: SFD (50'x37')

Proposed Wastewater System Type: Low Profile Chamber

Projected Daily Flow: 480 GPD

Number of bedrooms: 4 Number of Occupants: 8 max

Basement Yes No

Pump Required: Yes No May be required based on final location and elevations of facilities

Type of Water Supply: Community Public Well Distance from well _____ feet

Permit valid for: Five years
 No expiration

Permit conditions: _____

Authorized State Agent: RENS

Date: 12/9/21

SEE ATTACHED SITE SKETCH

The issuance of this permit by the Health Department in no way guarantees the issuance of other permits. The permit holder is responsible for checking with appropriate governing bodies in meeting their requirements. This site is subject to revocation if the site plan, plat, or the intended use changes. The Improvement Permit shall not be affected by a change in ownership of the site. This permit is subject to compliance with the provisions of the Laws and Rules for Sewage Treatment and Disposal and to conditions of this permit.

Construction Authorization

(Required for Building Permit)

The construction and installation requirements of Rules .1950, .1952, .1954, .1955, .1956, .1957, .1958, and .1959 are incorporated by references into this permit and shall be met. Systems shall be installed in accordance with the attached system layout.

ISSUED TO: H&H Constructors

PROPERTY LOCATION: 354 Bunting Dr

SUBDIVISION Oakmont

LOT # 125

Facility Type: SFD (50'x37') New Expansion Repair

Basement? Yes No Basement Fixtures? Yes No

Type of Wastewater System** Low Profile Chamber (Initial) Wastewater Flow: 480 GPD

(See note below, if applicable)

LDP (Repair)

Installation Requirements/Conditions

Septic Tank Size 1200 gallons Number of trenches 2

Pump Tank Size 1200 gallons Exact length of each trench 200 feet Trench Spacing: 9 Feet on Center

Trenches shall be installed on contour at a Soil Cover: 6 inches

Maximum Trench Depth of: 8 inches (Maximum soil cover shall not exceed

(Trench bottoms shall be level to +/-1/4" 36" above the trench bottom)

in all directions)

Pump Requirements: _____ ft. TDH vs. _____ GPM _____ inches below pipe

Aggregate Depth: _____ inches above pipe

Conditions: See conditions on site sketch. _____ inches total

**WATER LINES (INCLUDING IRRIGATION) MUST BE 10FT. FROM ANY PART OF SEPTIC SYSTEM OR REPAIR AREA.
NO UTILITIES ALLOWED IN INITIAL OR REPAIR DRAIN FIELD AREA.**

**If applicable: I understand the system type specified is different from the type specified on the application. I accept the specifications of this permit.

Owner/Legal Representative Signature: _____ Date: _____

This Construction Authorization is subject to revocation if the site plan, plat, or the intended use changes. The Construction Authorization shall not be transferred when there is a change in ownership of the site. This Construction Authorization is subject to compliance with the provisions of the Laws and Rules for Sewage Treatment and Disposal and to the conditions of this permit. SEE ATTACHED SITE SKETCH

Authorized State Agent: RENS Date: 12/9/21

Construction Authorization Expiration Date: 12/9/26

Harnett County Department of Public Health Site Sketch

Property Location: 354 Bunting Dr
Issued To: H&H Constructors Subdivision Oakmont Lot # 125

Authorized State Agent: REHS (OLIVER TOLKSOFF) Date: 12/9/21

* REMAINDER OF
CLEARING TO BE
DONE AT DISCRETION
OF SEPTIC INSTALLER

* MINIMUM OF 6" OF
COVER NEEDED
OVER DRAIN FIELD

* CALL WITH ANY
QUESTIONS PRIOR TO
INSTALLATION

* DIVERT ALL SURFACE
WATER AROUND
SYSTEM

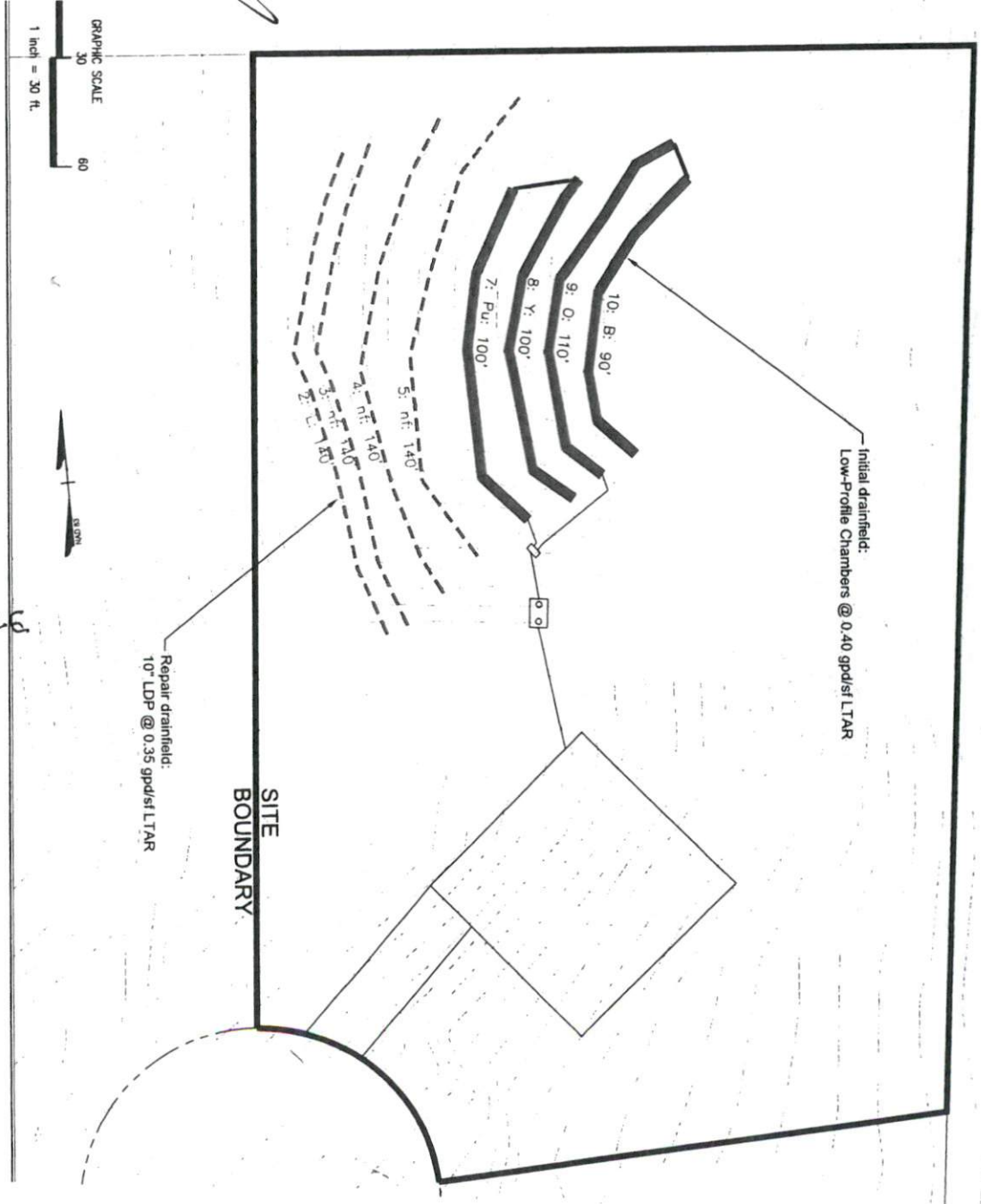

This drawing is for illustrative purposes only. System installation must meet all pertinent laws, rules, and regulations.