

**VICINITY MAP**

NORTH CAROLINA  
HARNETT COUNTY

**Certificate of Ownership and Dedication**  
I hereby certify that I am the owner of the property shown and described hereon, which is located in the subdivision jurisdiction of the Harnett County and that I hereby adopt the plan of subdivision with my free consent, establish minimum building setback lines, and dedicate all streets, alleys, walks, parks, and other sites and easements to public or private use as noted. Furthermore, I hereby dedicate all water lines to the Harnett County.

Owner: Roy A. Campbell Date: 5/26/2021

THIS PLAN AND SURVEY SHOWN HEREON IS EXEMPT FROM THE HARNETT COUNTY SUBDIVISION REGULATIONS  
Shannon 5/26/21  
SUBDIVISION ADMINISTRATOR DATE

NORTH CAROLINA, HARNETT COUNTY  
PRESENTED TO THE SUBDIVISION ON 5/26/21  
OF RECORD AT MAP NUMBER 2021-1052  
REGISTERED AT MAP NUMBER 2021-1052  
Matthew S. Leach  
PLATTEES: Roy A. Campbell, Deputy  
Shannon

State of North Carolina  
County of Harnett  
Shirley K. Bennett Review Officer of Harnett County  
I certify that this map or plat to which this certification is affixed meets all statutory requirements for recording.  
Review Officer: Shirley K. Bennett Date: 5/21/21

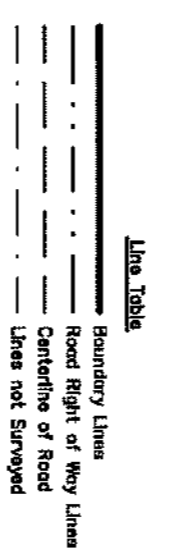

**COORDINATE CONTROL POINTS**

Point	Northing	Easting
A	568053.549	2065703.946
B	567717.441	2065548.505

Zoned: RA-20R  
Setbacks:  
Front-35'  
Rear-25'  
Side-10'

Watershed: Cape Fear River  
(Dunn) Class-- WS-IV  
MLRA: Southern Coastal Plains 133A  
Wetlands: (NONE)  
DFIRM: 37085 C  
Parcel: 0566  
Flood Zone: Minimal Flood Risk

- 9. 0566-58-5722.000
- 10. 0566-58-5201.000
- 11. 0566-58-4382.000
- 12. 0566-58-4374.000

**RECOMBINATION SURVEY OF  
LOTS 9, 10, 11 AND 12  
MAP BOOK 2 PAGE 110  
FOR  
ROY A. CAMPBELL  
TOWN OF BUNNLEVEL**

HARNETT COUNTY  
DATE 05/20/2021  
SURVEYED BY : ROBERT E. LEACH, II  
DRAWING NO. 2021052

FOR REGISTRATION  
RECORDING OFFICE  
HARNETT COUNTY, DEEDS  
2021 MAY 27 09:24:33 AM  
BK: 2021, P: 220-220  
INSTRUMENT # 2021012048  
TUESDAY

**CALL TABLE**

Course	Bearing	Distance
L1	S 19°08'00" E	33.67'
L2	S 19°08'00" E	54.51'
L3	S 20°56'49" E	54.78'
L4	S 23°09'19" E	53.65'
L5	S 23°09'19" E	38.85'
L6	N 20°54'25" W	18.90'
L7	N 20°54'25" W	53.14'
L8	N 24°14'25" W	20.85'
L9	N 24°14'25" W	27.31'
L10	N 27°39'45" W	26.28'

