

**SOIL/SITE EVALUATION  
 for ON-SITE WASTEWATER SYSTEM**

Owner: *Weaver* Applicant: *-* *Layout + 2nd Eval*  
 Address: *5944 Rossier Pittman* Date Evaluated: *8-25-21*  
 Proposed Facility: *SFD* Design Flow (.1949): *360*  
 Location of Site: \_\_\_\_\_ Property Recorded: \_\_\_\_\_  
 Water Supply:  Public  Individual  Well  Spring  Other  
 Evaluation Method:  Auger Boring  Pit  Cut  
 Type of Wastewater:  Sewage  Industrial Process  Mixed

Property Size:

P R O F I L E #	.1940 Landscape Position/ Slope %	Horizon Depth (In.)	SOIL MORPHOLOGY .1941		OTHER PROFILE FACTORS					Profile Class & LTAR
			.1941 Structure/ Texture	.1941 Consistence Mineralogy	.1942 Soil Wetness/ Color	.1943 Soil Depth (IN.)	.1956 Sapro Class	.1944 Restr Horiz		
									<i>1, 2, 3</i>	
	<i>2-5%</i>	<i>20-48</i>	<i>SC1 SB4</i>	<i>F./S/S/SP/IXP</i>						<i>Group III</i>

Description	Initial System	Repair System	Other Factors (.1946): Site Classification (.1948): <i>PS</i> Evaluated By: <i>M. Hol REHS</i> Others Present:
Available Space (.1945)	<i>✓</i>	<i>✓</i>	
System Type(s)	<i>25% rad</i>	<i>25% rad</i>	
Site LTAR	<i>.4</i>	<i>.4</i>	

COMMENTS: \_\_\_\_\_

LANDSCAPE POSITIONS	GROUP	TEXTURES	.1955 LTAR	CONSISTENCE MOIST	WET
R-RIDGE	I	S-SAND	1.2 - 0.8	VFR-VERY FRIABLE FR-FRIABLE	NS-NON-STICKY SS-SLIGHTLY STICKY
S-SHOULDER SLOPE		LS-LOAMY SAND			
L-LINEAR SLOPE	II	SL-SANDY LOAM	0.8 - 0.6	FI-FIRM VFI-VERY FIRM	S-STICKY VS-VERY STICKY
FS-FOOT SLOPE		L-LOAM			
N-NOSE SLOPE	III	SI-SILT	0.6 - 0.3	EFI-EXTREMELY FIRM	NP-NON-PLASTIC SP-SLIGHTLY STICKY P-PLASTIC VP-VERY PLASTIC
H-HEAD SLOPE		SIL-SILT LOAM			
CC-CONCLAVE SLOPE		CL-CLAY LOAM			
CV-CONVEX SLOPE		SCL-SANDY CLAY LOAM			
T-TERRACE	IV	SIC-SILTY CLAY	0.4 - 0.1	C-CLAY SC-SANDY CLAY	
FP-FLOOD PLAN					

STRUCTURE  
 SG-SINGLE GRAIN  
 M- MASSIVE  
 CR-CRUMB  
 GR-GRANULAR  
 SBK-SUBANGULAR BLOCKY  
 ABK-ANGULAR BLOCKY  
 PL-PLATY  
 PR-PRISMATIC

MINERALOGY  
 SLIGHTLY EXPANSIVE  
 EXPANSIVE

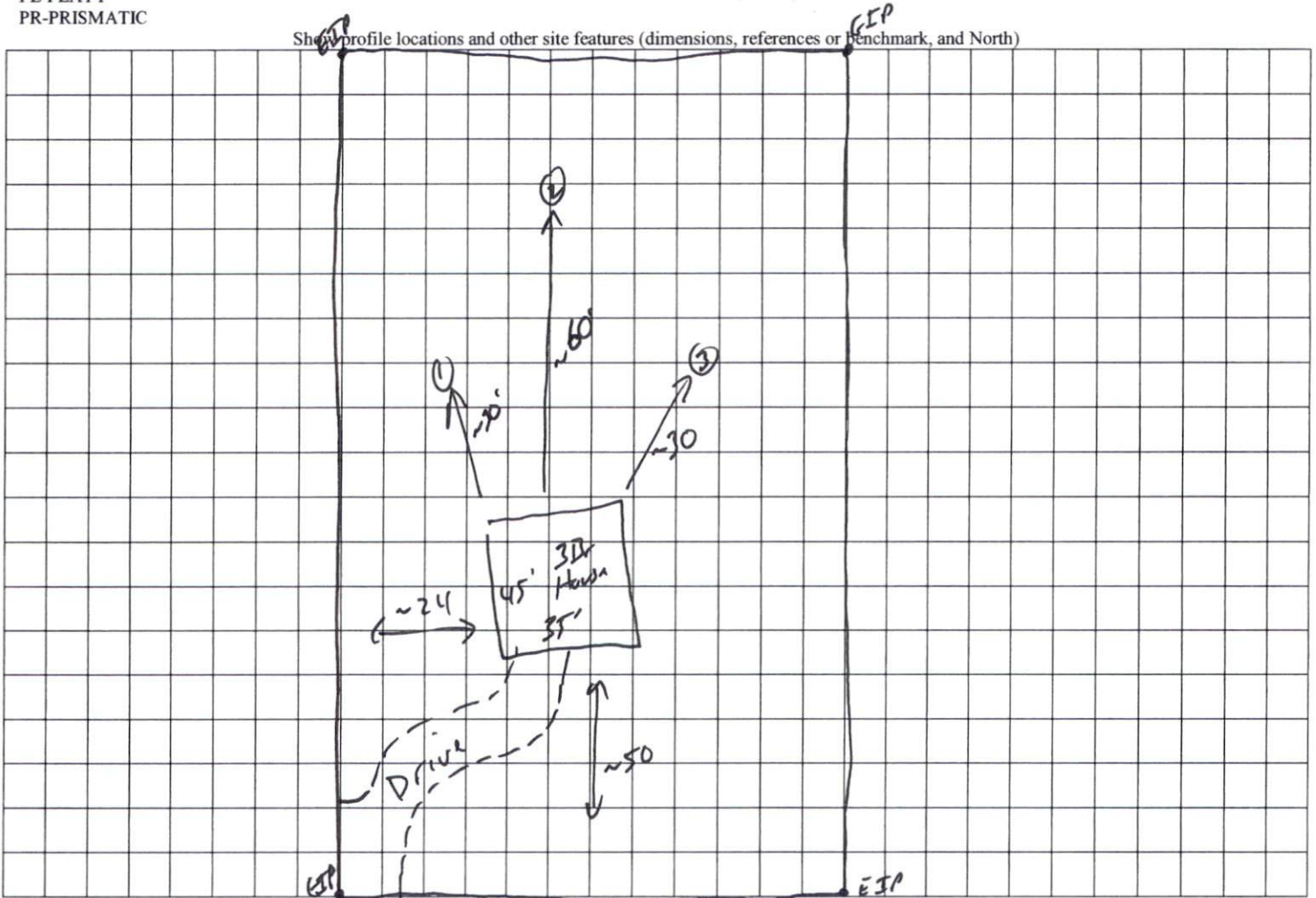

Rosser Pittman