



ECS Southeast, LLP

6151 Raeford Road, Suite A
Fayetteville, NC 28304
9104013288
9103230539

LETTER OF TRANSMITTAL

January 19, 2022
Ivercon, Inc

Fayetteville, NC 28306
ATTN: Troy Iverson

RE: **Starboard Bay Lot**
ECS Job # **33:5859**

Permits:
Location: **172 Starboard Bay**
Sanford, NC 27332

Field Reports For your use As requested

CC:

ENCL: Field Report # 1 1/14/2022 Foundations

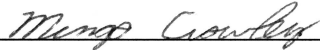

Mingo Crowley
Office Manager

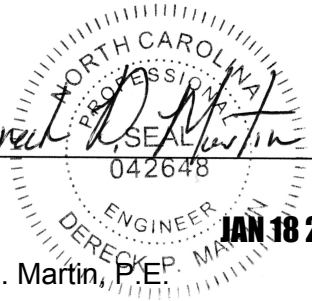
Derek P. Martin, P.E.
Assistant Office Manager

Disclaimer

1. This report (and any attachments) shall not be reproduced except in full without prior written approval of ECS.
2. The information in this report relates only to the activities performed on the report date.
3. Where appropriate, this report includes statements as to compliance with applicable project drawings, and specifications for the activities, performed on this report date.
4. Incomplete or non-conforming work will be reported for future resolution.
5. The results of samples and/or specimens obtained or prepared for subsequent laboratory testing will be presented in separate reports/documents.



ECS Southeast, LLP
 6151 Raeford Road, Suite A
 Fayetteville, NC 28304
 (910) 401-3288 [Phone]
 (910) 323-0539 [Fax]

FIELD REPORT

Project **Starboard Bay Lot**
 Location **Sanford, NC**
 Client **Ivercon, Inc**
 Contractor **None Listed**

Project No. **33:5859**
 Report No. **1**
 Day & Date **Friday 1/14/2022**
 Weather **43 °/ Sunny**
 On-Site Time **1.50**
 Lab Time **0.00**
 Travel Time* **0.00**
 Total **1.50**
 Re Obs Time **0.00**

Remarks **Foundations**

Trip Charges*	Tolls/Parking*	Mileage*	Time of Arrival	Departure
Chargeable Items			9:15A	10:45A

* Travel time and mileage will be billed in accordance with the contract.

Summary of Services Performed (field test data, locations, elevations & depths are estimates) & Individuals Contacted.

ECS Representative arrived on site, as requested, to check the bearing capacity of soils via hand auger/DCP method for foundation footings. Please see the attached sketch and data sheet for details.

A hand auger was used to advance the boreholes to different depths noted on the boring logs. Dynamic Cone Penetrometer (DCP) test were performed in the hand auger boreholes by a 1.5 inch diameter cone driven into the soil by a 15 pound ring weight with a free fall of 20 inches. The number of blows required to drive the cone into the soil a distance of 1.75 inches is termed the DCP Value and is indicated for each test on the hand auger.

A total of 3 hand auger/DCP evaluations were performed to a depth of approximately 3 feet below the current footing sub grade elevation. It is to the opinion of ECS that the materials in place (at the locations and elevations tested) did appear to be suitable to support the design bearing capacity 2000 psf.

Please note that inclement weather will cause soils to be softened. If the bearing soils become wet or damaged, ECS will need to be notified to re-verify the soil conditions.

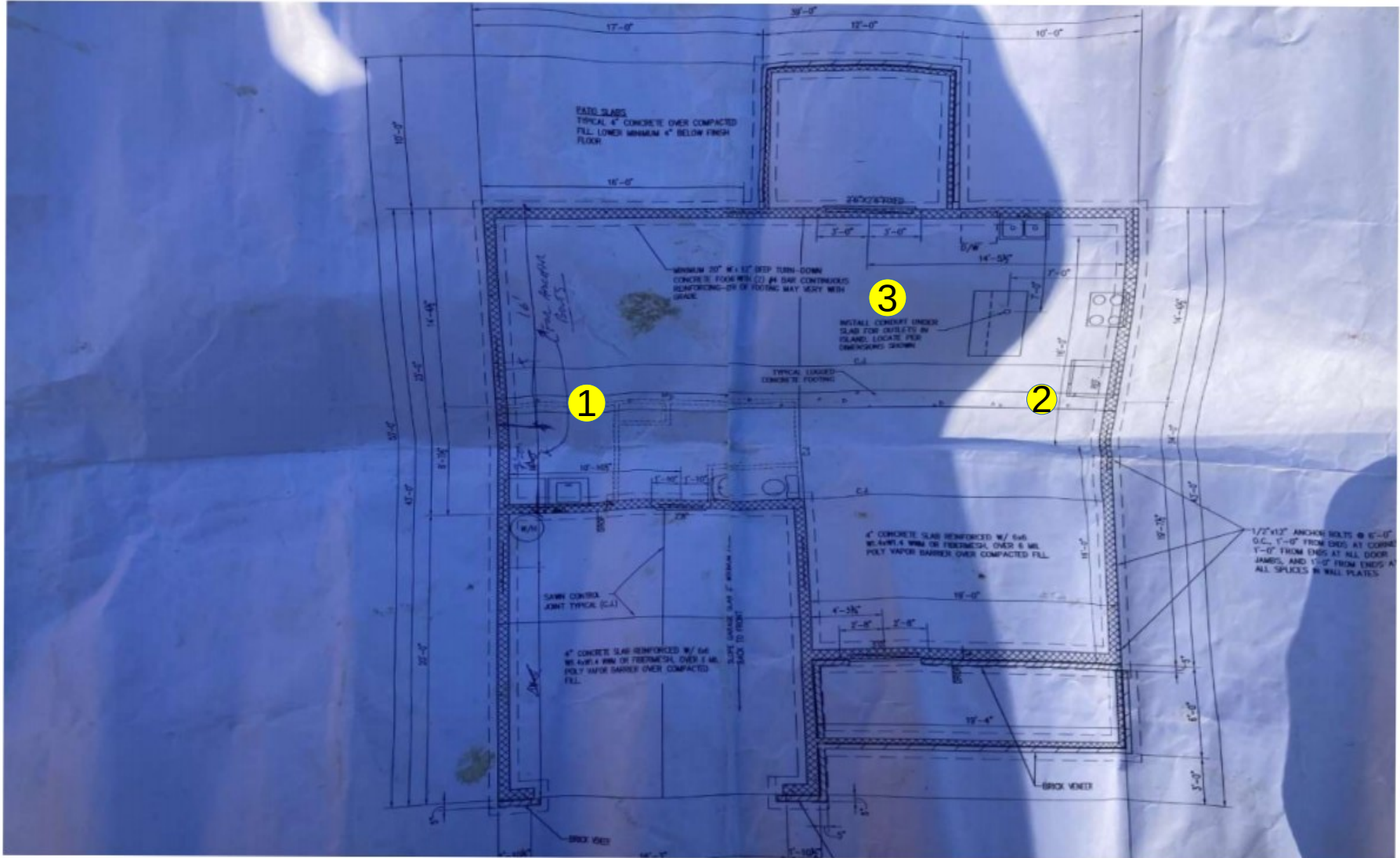

Tyler Mcfayden
 1/14/2022
 172 starboard bay
 Proj # 5859
 W/O # 64956

Key (NTS)

DCP Location #

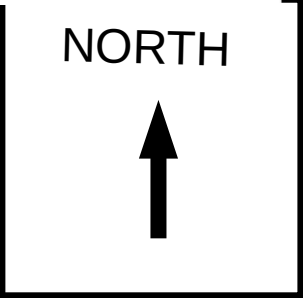



Report of Spread Footing - Foundation Observations

Project: Starboard Bay Lot
 Location: 172 Starboard Bay
 Sanford - Lee - NC - 27332
 Contractor: None Listed

Project No.: 33:5859
 Day/Date: 1/14/2022

Footing Number	Location	Size (W x H x L)		Footing Bottom Elevation		Description of Steel Placed	Description of Subgrade Material	Required Blow Counts	Design Bearing Pressure
		Design	Actual	Design **	Depth of Undercut (in)			# of Blows / Increment	
1	1	x x	x x	N/A	0		sandy clay	6 5,5,5	2000
1	1	x x	x x	N/A	-1		sandy clay	6 4,4,5	2000
1	1	x x	x x	N/A	-2		sandy clay	6 4,5,5	2000
1	1	x x	x x	N/A	-3		sandy clay	6 2,3,2	2000
2	2	x x	x x	N/A	0		sandy clay	6 6,5,5	2000
2	2	x x	x x	N/A	-1		sandy clay	6 6,4,5	2000
2	2	x x	x x	N/A	-2		sandy clay	6 14,7,6	2000
2	2	x x	x x	N/A	-3		sandy clay	6 8,7,5	2000
3	3	x x	x x	N/A	0		sandy clay	6 7,6,7	2000
3	3	x x	x x	N/A	-1		sandy dirt	6 10,10,8	2000
3	3	x x	x x	N/A	-2		sandy dirt	6 10,8,7	2000



Report of Spread Footing - Foundation Observations

Project: Starboard Bay Lot
 Location: 172 Starboard Bay
 Sanford - Lee - NC - 27332
 Contractor: None Listed

Project No.: 33:5859
 Day/Date: 1/14/2022

3	3	x x	x x	N/A	-3		sandy dirt	6 25+	2000
---	---	-----	-----	-----	----	--	------------	----------	------

** SGE: Subgrade Elevation to be determined by surveyor.

By: Tyler McFayden

 ECS Southeast, LLP

WO: 64956