

# Highland Grove 3-Bedroom Septic Proposal Lot #43

This drawing represents a preliminary septic plan made prior to final construction activities. A revised plan may need to be reworked at time of permitting.

\*If plumbing is not sufficient a separate pump and tank may be required.

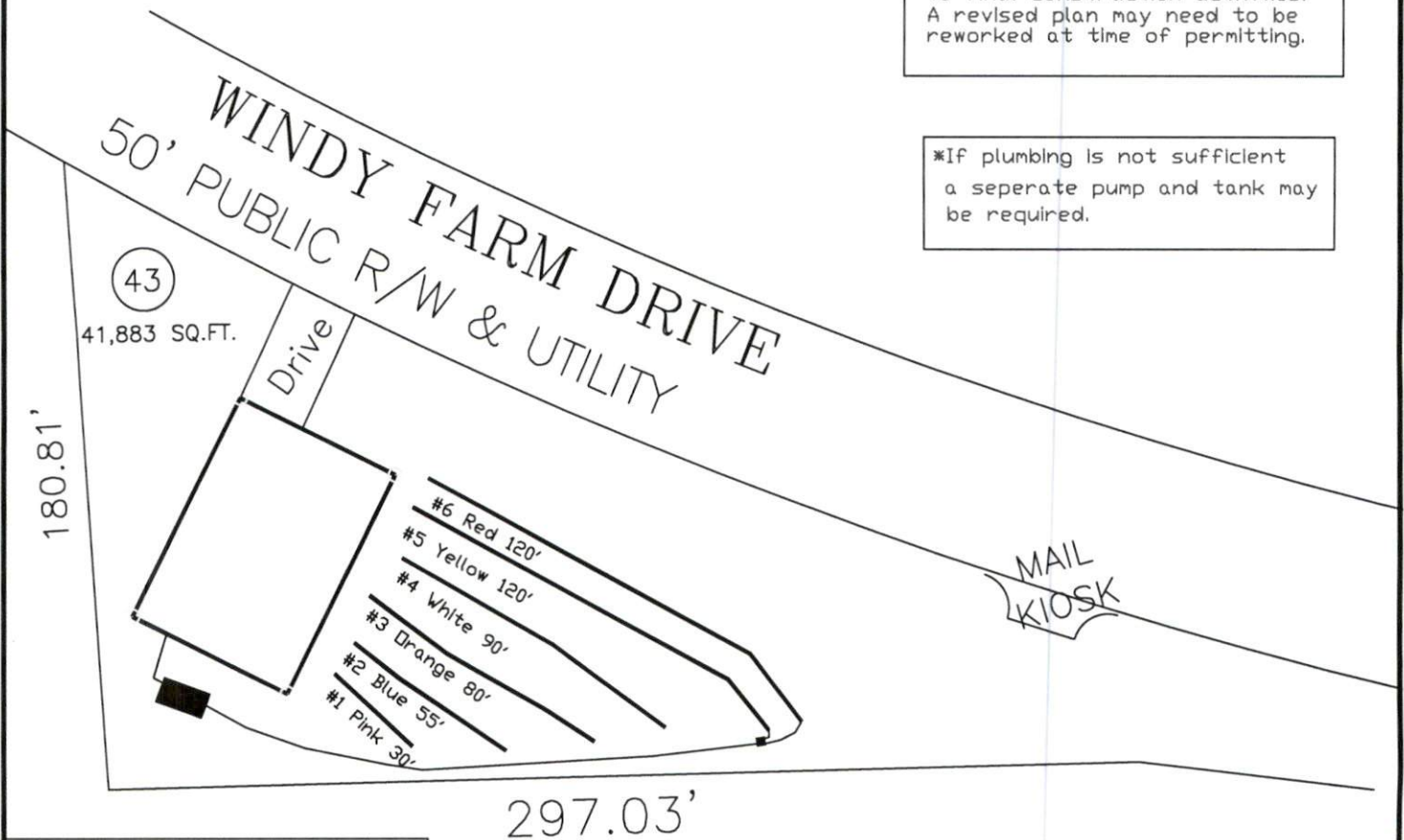

System: Pump to D-Box  
 Lines: 5-6 (240')  
 0.4 LTAR  
 24" Trench Bottom  
 Accepted Status System  
 Repair: Serial Dist.  
 Lines: 1-5 (225')  
 0.4 LTAR  
 24" Trench Bottom  
 Accepted Status System

GRAPHIC SCALE  
 1" = 50'



Adams  
 Soil Consulting  
 919-414-6761  
 Job #561