

**General Notes:**  
 - Per ANSI/TPI 1-2002 all " Truss to Wall" connections are the responsibility of the Building Designer, not the Truss Manufacturer.  
 - Dimensions are Feet-Inches- Sixteenths.

- Trusses are to be 24" o.c. unless noted otherwise (U.N.O.)  
 - Trusses are not designed to support brick U.N.O.

- Do not cut or modify trusses without first contacting Builders FirstSource.  
 - Immediately contact Builders FirstSource if trusses are damaged.

**Connection Notes:**  
 - All hangers are to be Simpson or equivalent U.N.O.  
 - Use Manufacturer's specifications for all hanger connections U.N.O.  
 - Use 10d x 1 1/2" Nails in hanger connections to single ply roof girder trusses.

**Floor Notes:**  
 - Shift truss as required to avoid plumbing traps.  
 - Installation Contractor and/or Field Supervisor are to verify all dimensions, trap locations, and options prior to installation

**Dimension Notes:**  
 - Drawing not to scale. Do not scale dimensions

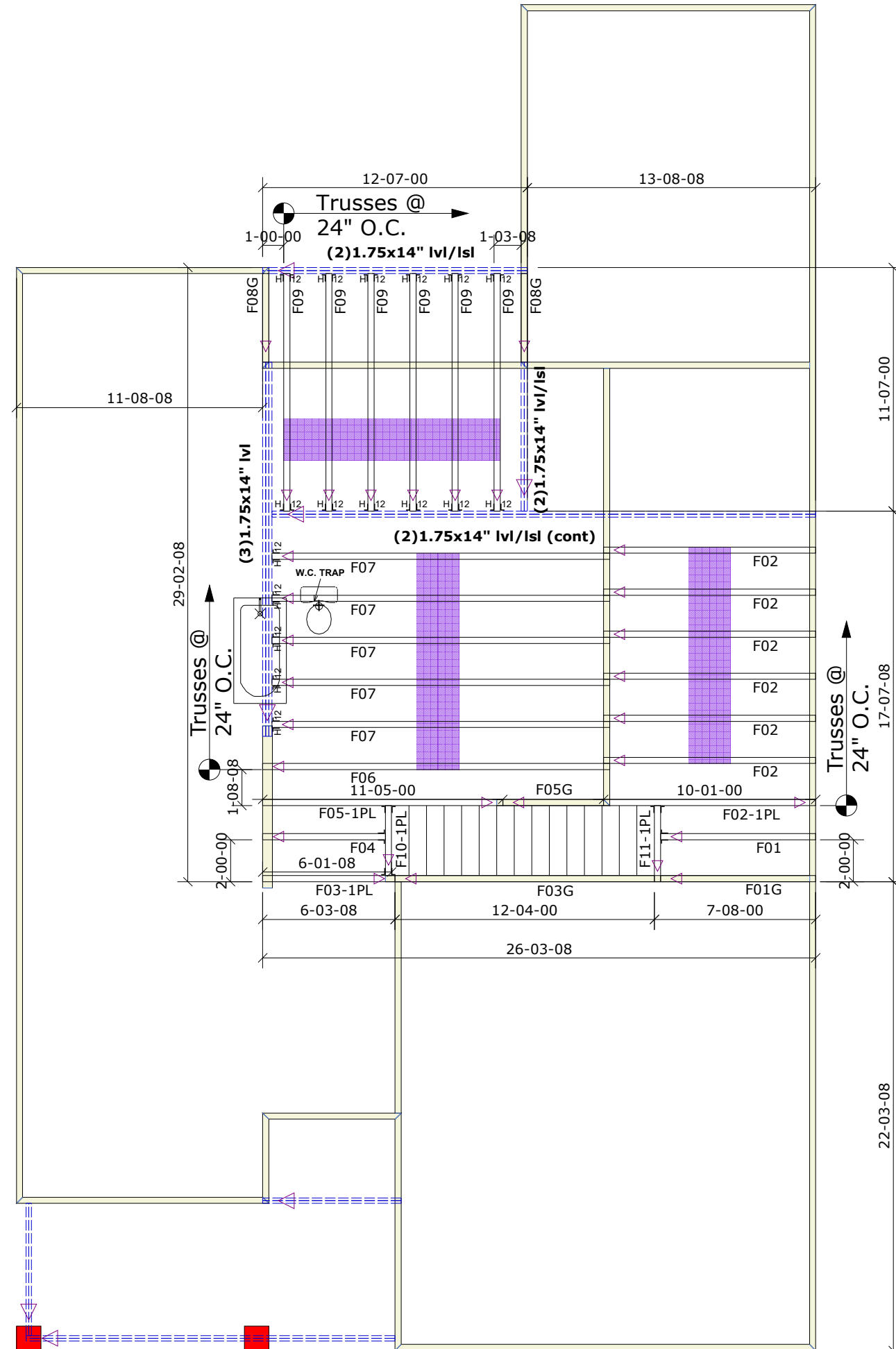

**9'-1-2" 1ST FLOOR  
 14" FLOOR**

**NOTE: LEFT END OF TRUSS AS SHOWN ON TRUSS DETAIL DRAWINGS ARE INDICATED BY TRIANGLE ICONS.**

**NOTE: LEFT END OF TRUSS AS SHOWN ON TRUSS DETAIL DRAWINGS ARE INDICATED BY TRIANGLE ICONS. ▲◀▶▷**

<b>Hanger List</b>		All Tie Downs H2.5A Unless noted	
17	HU412	H1 L12	<b>Special Items List</b>
5	THA422	J L	
<b>Misc Material</b>			
MCKEE			
WINSTON	Elev:	CRAFTSMAN	
Carriage Glen@ Anderson Creek			
-	NC	Lot:	1010
<b>Appwright #</b>			
FLOOR/RH			
<b>Code:</b>		IRC 2015	
<b>Loading:</b>			
T.C.L.L.		40	
T.C.D.L.		10	
<b>Layout:</b>	AG1010	B.C.L.L.	0
<b>L/O Date:</b>	4/14/21	B.C.D.L.	5
<b>Revision History</b>		<b>Wind:</b>	
Rev1:	XXXXX	M.P.H.	130 MPH
Rev2:	XXXXX	Exposure Category	
Rev3:	XXXXX	EXPOSURE B	
<b>Pick Ticket:</b>	-	<b>Job No.:</b>	AG1010
<b>Sales No.:</b>	-	<b>Acct No.:</b>	-

<b>Hatch Legend</b>	
	Attic Room
	Volume Ceiling
	Stick Framing

