

Harnett County Department of Public Health

Improvement Permit

A building permit cannot be issued with only an Improvement Permit

PROPERTY LOCATION: 205 YOUNG FARM DR (US 401 N.)
 SUBDIVISION MORGAN NORTH LOT # 61
 ISSUED TO: D R HORTON INC
 NEW REPAIR EXPANSION
 Type of Structure: 38x40(4bed/3ba)
 Proposed Wastewater System Type: 25% REDUCTION SYS.
 Projected Daily Flow: 480 GPD
 Number of bedrooms: 4 Number of Occupants: 8 max
 Basement Yes No
 Pump Required: Yes No May be required based on final location and elevations of facilities
 Type of Water Supply: Community Public Well Distance from well NA feet
 Permit conditions: _____ Permit valid for: Five years No expiration

Authorized State Agent: [Signature] Date: 05/24/2021 SEE ATTACHED SITE SKETCH
 The issuance of this permit by the Health Department in no way guarantees the issuance of other permits. The permit holder is responsible for checking with appropriate governing bodies in meeting their requirements. This site is subject to revocation if the site plan, plat, or the intended use changes. The Improvement Permit shall not be affected by a change in ownership of the site. This permit is subject to compliance with the provisions of the Laws and Rules for Sewage Treatment and Disposal and to conditions of this permit.

Construction Authorization

(Required for Building Permit)

The construction and installation requirements of Rules .1950, .1952, .1954, .1955, .1956, .1957, .1958, and .1959 are incorporated by references into this permit and shall be met. Systems shall be installed in accordance with the attached system layout.

ISSUED TO: D R HORTON INC PROPERTY LOCATION: 205 YOUNG FARM DR (US 401 N.)
 SUBDIVISION MORGAN NORTH LOT # 61
 Facility Type: 38x40(4bed/3ba) New Expansion Repair
 Basement? Yes No Basement Fixtures? Yes No
 Type of Wastewater System** 25% REDUCTION SYS. (Initial) Wastewater Flow: 480 GPD
 (See note below, if applicable 25% REDUCTION SYS. (Repair)
 Installation Requirements/Conditions
 Septic Tank Size 1000 gallons Exact length of each trench 3 feet Trench Spacing: 9 Feet on Center
 Pump Tank Size _____ gallons Trenches shall be installed on contour at a Soil Cover: 6 inches
 Maximum Trench Depth of: 18 inches (Maximum soil cover shall not exceed 36" above the trench bottom)
 (Trench bottoms shall be level to +/-1/4" in all directions)
 Pump Requirements: _____ ft. TDH vs. _____ GPM Aggregate Depth: NA inches below pipe
 _____ inches above pipe
 Conditions: PROPOSAL BY SOUTHEASTERN SOIL & ENVIRO. ASSOC., INC NA inches total

**WATER LINES (INCLUDING IRRIGATION) MUST BE 10FT. FROM ANY PART OF SEPTIC SYSTEM OR REPAIR AREA.
 NO UTILITIES ALLOWED IN INITIAL OR REPAIR DRAIN FIELD AREA.**

**If applicable: I understand the system type specified is different from the type specified on the application. I accept the specifications of this permit.
 Owner/Legal Representative Signature: _____ Date: _____

This Construction Authorization is subject to revocation if the site plan, plat, or the intended use changes. The Construction Authorization shall not be transferred when there is a change in ownership of the site. This Construction Authorization is subject to compliance with the provisions of the Laws and Rules for Sewage Treatment and Disposal and to the conditions of this permit. SEE ATTACHED SITE SKETCH

Authorized State Agent: [Signature] Date: 05/24/2021
ANJEN CURRIE Construction Authorization Expiration Date: 05/24/2026

Application # SFD2104-0072

Harnett County Department of Public Health Site Sketch

Property Location: 205 YOUNG FARM DR (US 401 N.)

Issued To: D R HORTON INC

Subdivision MORGAN NORTH

Lot # 61

Authorized State Agent: _____

Date: 05/21/2021

- ADDENDUM
- * GRAVITY TO S-BOX EQUAL DISTRIBUTION
 - * PROPOSAL BY SOUTHEASTERN SOIL & ENVIRO. ASSOC.
 - * INSTALL AS CLOSE [10 FT] TO LEFT P.L. AS CONTOUR ALLOWS

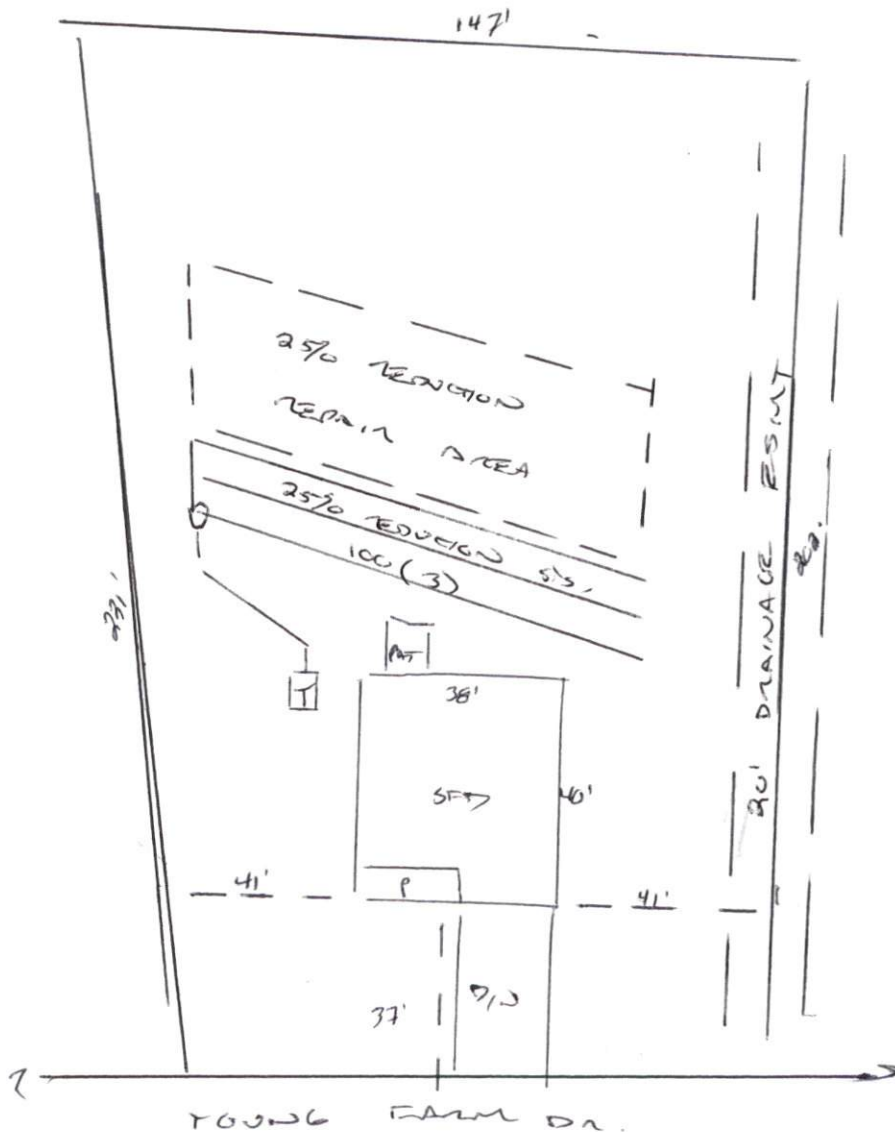

This drawing is for illustrative purposes only. System installation must meet all pertinent laws, rules, and regulations.

SOUTHEASTERN SOIL & ENVIRONMENTAL ASSOC., INC.

PROPOSED SUBSURFACE WASTE DISPOSAL SYSTEM DETAIL SHEET

SUBDIVISION: MORGAN FARMS NORTH

LOT 61

INITIAL SYSTEM: APPROVED 25% REDUCTION

REPAIR APPROVED 25% REDUCTION

DISTRIBUTION: D-Box

DISTRIBUTION D-Box

BENCHMARK: 100.0

LOCATION PC 63/64

NO. BEDROOMS: 4

LTAR 0.4 GPD/FT'

LINE	FLAG COLOR	ELEVATION	LENGTH
Infil system {	1	B	105.84
	2	Y	105.25
	3	B	104.64
	4	Y	104.34
			<u>400' AVAIL</u>
5	B	103.67	100'
6	Y	103.00	100'
7	B	102.00	100'
8	Y	101.25	100'
			<u>400'</u>

BY M EAKER

DATE DECEMBER 2019 / JAN 2020

TYPICAL PROFILE

0-10 W (VF, weel)
10-40+ LCL / F; skel
C L > 36"
INSTAG AT 13"

THERE SHALL BE NO GRADING,
CUTTING, LOGGING OR OTHER SOIL
DISTURBANCE IN SEPTIC AREA

HEALTH DEPARTMENT USE ONLY.

DESIGNS DO NOT GUARANTEE FUNCTIONALITY

Southeastern Soil & Environmental Associates, Inc.

