

Highland Grove
 3-Bedroom Septic Proposal
 Lot #33

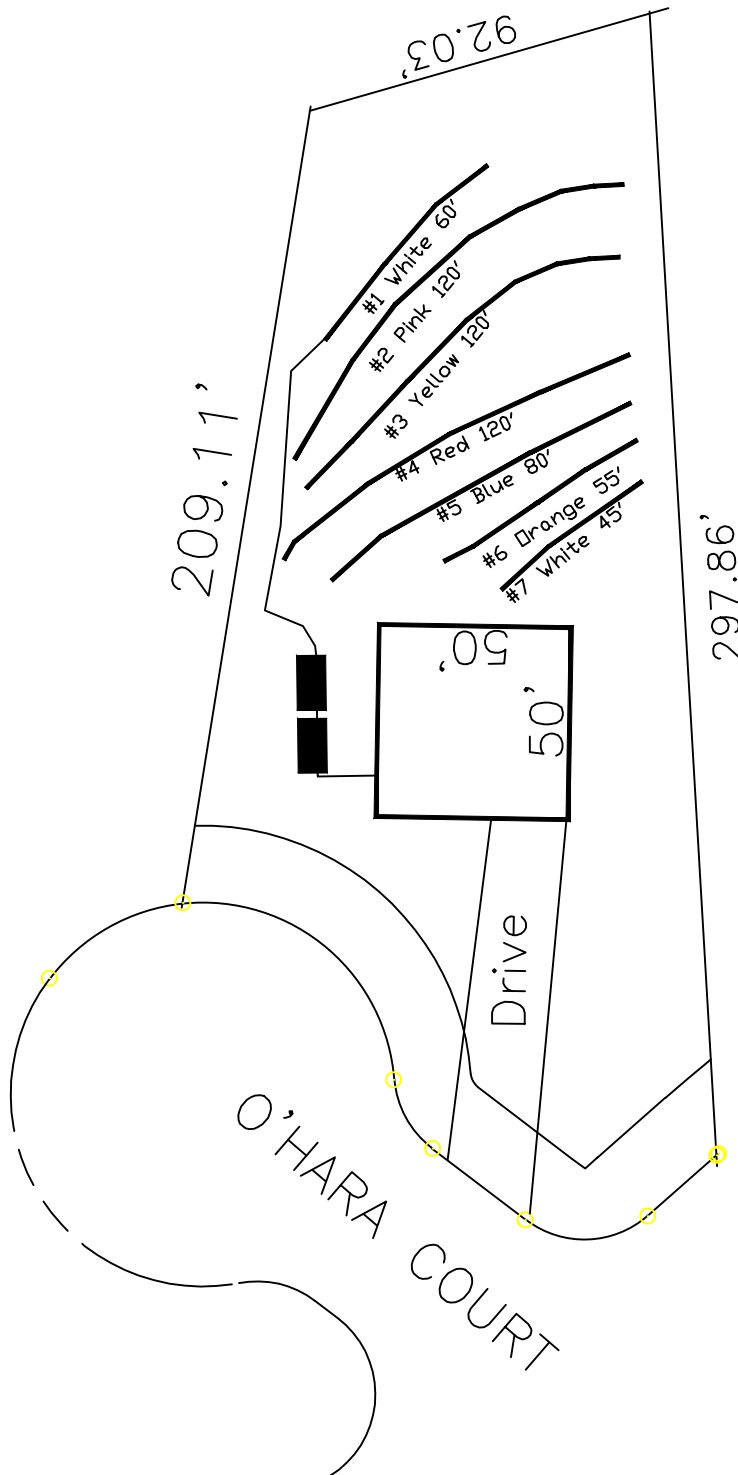

33

32,127 SQ.FT.

This drawing represents a preliminary septic plan made prior to final construction activities. A revised plan may need to be reworked at time of permitting.

System: Pump to Serial Dist.
 Lines: 1-3 (300')
 0.35 LTAR
 24" Trench Bottom
 Accepted Status System
 Repair: Gravity to D-Box
 Lines: 4-7 (300')
 0.35 LTAR
 24 Trench Bottom
 Accepted Status System

*Lot may have potential to upgrade to a 4-bedroom septic system

GRAPHIC SCALE
 1" = 50'



Adams
 Soil Consulting
 919-414-6761
 Job #561