

# Harnett County Department of Public Health

PERMIT # SFD2104-0033  
REVISED

## Operation Permit

New Installation  Septic Tank  Nitrification Line  Repair  Expansion  
 PROPERTY LOCATION: 3695 PONDEROSA RD

Name: (owner) WICKER CONSTRUCTION SUBDIVISION \_\_\_\_\_ LOT # \_\_\_\_\_

System Installer: LARRY SHARPE

Basement with plumbing:  Garage  Number of Bedrooms 4

Type of Water Supply:  Community  Public  Well Distance from well \_\_\_\_\_ feet

System Type: III Types V and VI Systems expire in 5 years.

(In accordance with Table V a)

Owner must contact Health Department 6 months prior to expiration for permit renewal.

This system has been installed in compliance with applicable North Carolina General Statutes, Rules for Sewage Treatment and Disposal, and all conditions of the Improvement Permit and Construction Authorization.

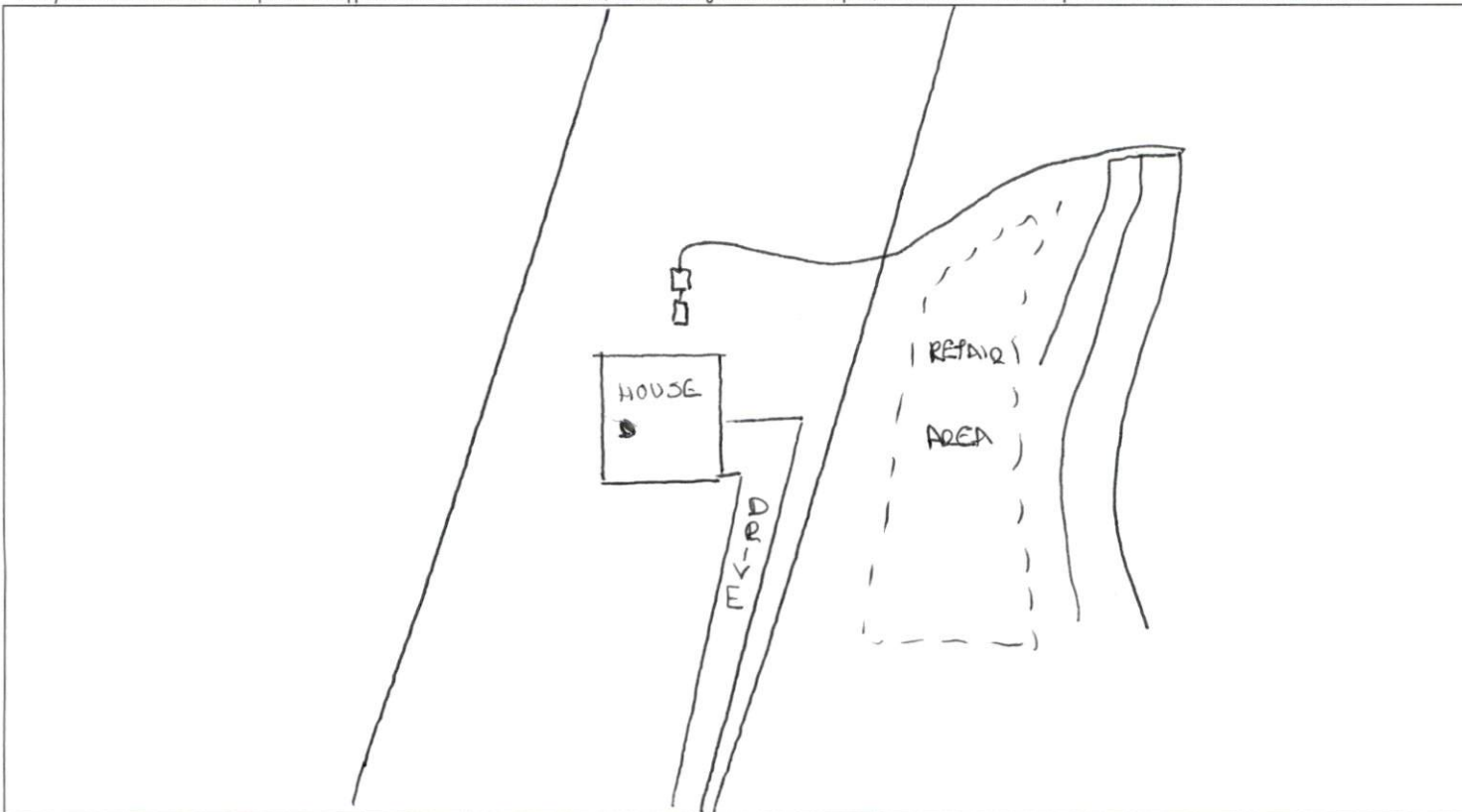

**PERMIT CONDITIONS:**

- I. Performance: System shall perform in accordance with Rule .1961.
- II. Monitoring: As required by Rule .1961.
- III. Maintenance: As required by Rule .1961. Other: \_\_\_\_\_  
 Subsurface system operator required? Yes  No   
 If yes, see attached sheet for additional operation conditions, maintenance and reporting.

IV. Operation: \_\_\_\_\_

V. Other: 140' OF Pump LINE

\_\_\_\_\_ D-Box  \_\_\_\_\_ Pump  \_\_\_\_\_ Alarm  \_\_\_\_\_ H2O Line  \_\_\_\_\_ PWR Line

Following are the specifications for the sewage disposal system on the above captioned property.

Type of system:  Conventional  Other PUMP TO CHAMBER (PH) Septic Tank: 1000 gallons Pump Tank: 1600 gallons  
 Subsurface Drainage Field: No. of ditches 1 exact length of each ditch 300 feet width of ditches 3 feet depth of ditches 14 inches  
 French Drain Required: \_\_\_\_\_ Linear feet

Authorized State Agent REHS Date 6/30/22