

**SOIL/SITE EVALUATION
 for ON-SITE WASTEWATER SYSTEM**

Owner: - Applicant: BITTO ENTERPRISE
 Address: 80 DORRIS ST Date Evaluated: 04/27/2021
 Proposed Facility: W. ST. COLUMB Design Flow (.1949): 480 GPD Property Size:
 Location of Site: REAR Property Recorded:
 Water Supply: Public Individual Well Spring Other
 Evaluation Method: Auger Boring Pit Cut
 Type of Wastewater: Sewage Industrial Process Mixed

P R O F I L E #	.1940 Landscape Position/ Slope %	Horizon Depth (In.)	SOIL MORPHOLOGY .1941		OTHER PROFILE FACTORS				Profile Class & LTAR
			.1941 Structure/ Texture	.1941 Consistence Mineralogy	.1942 Soil Wetness/ Color	.1943 Soil Depth (IN.)	.1956 Sapro Class	.1944 Restr Horiz	
1,2,3	L 3%	0-12	CL LS	WV MSMP					PS
		12-30	WV SL	FN SSSS	7.5% @ 34"	30			G.4
4,5	L 3%	0-12	CL LS	WV MSMP					PS
		12-32	WV SL	FN SSSS	7.5% @ 28"	32			G.4
6	L 3%	0-12	CL LS	WV MSMP					PS
		12-28	WV SL	FN SSSS	7.5% @ 24"	28			G.4
7	L 3%	0-12	CL LS	WV MSMP					PS
		12-20	WV SL	FN SSSS	7.5% @ 18"	20			G.4
8,9,10	L 3%	0-14	CL LS	WV MSMP					PS
		14-38	WV SL	FN SSSS	7.5% @ 38"	38			G.4

Description	Initial System	Repair System	Other Factors (.1946): Site Classification (.1948): <u>PROVISIONALLY SUITABLE</u> Evaluated By: <u>ANDREW COVINO</u> Others Present:
Available Space (.1945)	<input checked="" type="checkbox"/>	<input checked="" type="checkbox"/>	
System Type(s)	<u>250 GPD</u>	<u>250 GPD</u>	
Site LTAR	<u>0.4</u>	<u>0.4</u>	

COMMENTS: _____

LANDSCAPE POSITIONS

- R-RIDGE
- S-SHOULDER SLOPE
- L-LINEAR SLOPE
- FS-FOOT SLOPE
- N-NOSE SLOPE
- H-HEAD SLOPE
- CC-CONCLAVE SLOPE
- CV-CONVEX SLOPE
- T-TERRACE
- FP-FLOOD PLAN

GROUP

TEXTURES

.1955 LTAR

CONSISTENCE MOIST

WET

- | | | | | |
|-----|---|-----------|--|---|
| I | S-SAND
LS-LOAMY SAND | 1.2 - 0.8 | VFR-VERY FRIABLE
FR-FRIABLE
FI-FIRM
VFL-VERY FIRM
EFL-EXTREMELY FIRM | NS-NON-STICKY
SS-SLIGHTLY STICKY
S-STICKY
VS-VERY STICKY
NP-NON-PLASTIC
SP-SLIGHTLY STICKY
P-PLASTIC
VP-VERY PLASTIC |
| II | SL-SANDY LOAM
L-LOAM | 0.8 - 0.6 | | |
| III | SI-SILT
SIL-SILT LOAM
CL-CLAY LOAM
SCL-SANDY CLAY LOAM | 0.6 - 0.3 | | |
| IV | SIC-SILTY CLAY
C-CLAY
SC-SANDY CLAY | 0.4 - 0.1 | | |

□ = 1000ft²

STRUCTURE

- SG-SINGLE GRAIN
- M-MASSIVE
- CR-CRUMB
- GR-GRANULAR
- SBK-SUBANGULAR BLOCKY
- ABK-ANGULAR BLOCKY
- PL-PLATY
- PR-PRISMATIC

MINERALOGY

- SLIGHTLY EXPANSIVE
- EXPANSIVE

Show profile locations and other site features (dimensions, references or benchmark, and North)

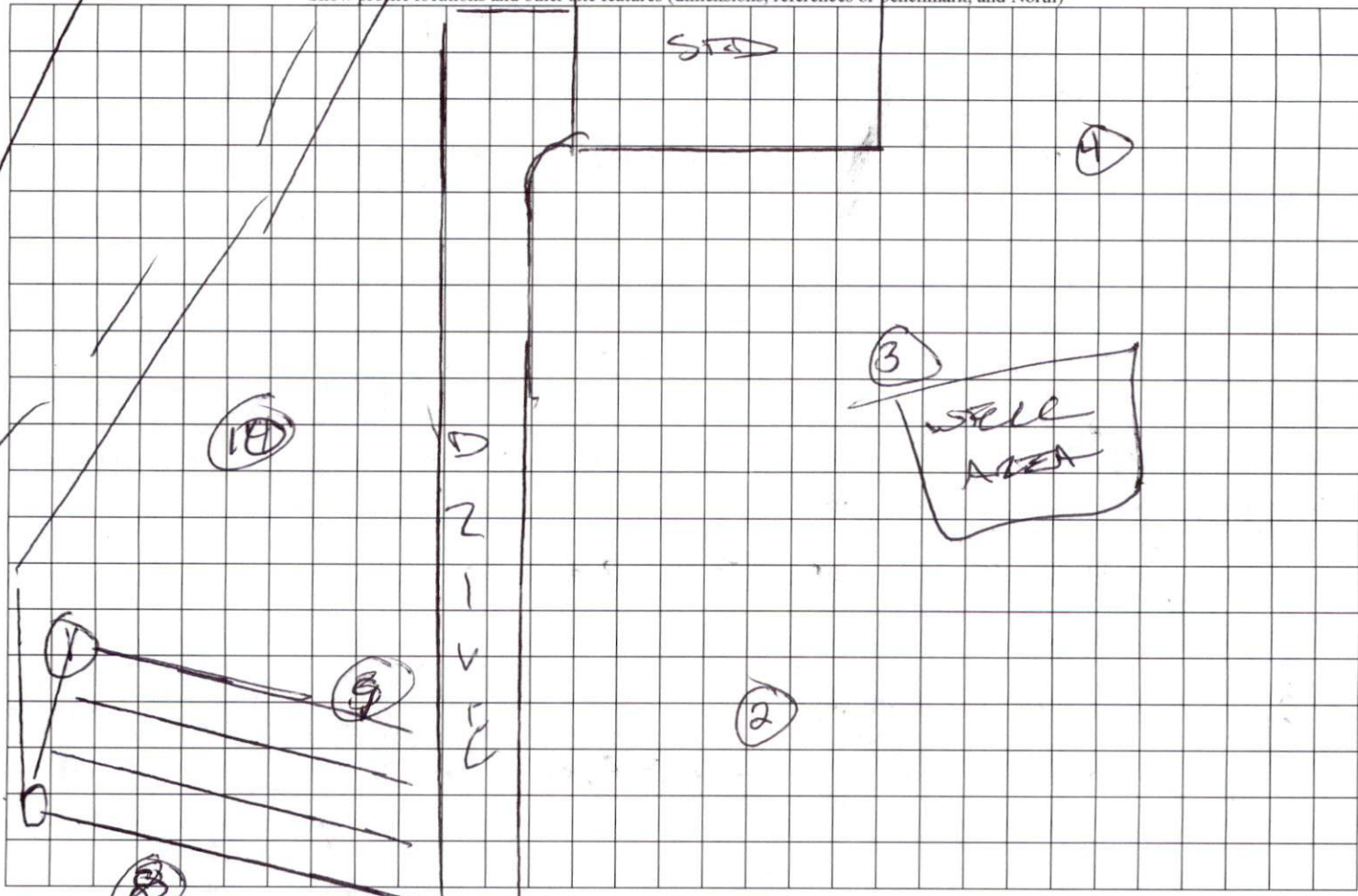

W. STRICKLAND ROAD